

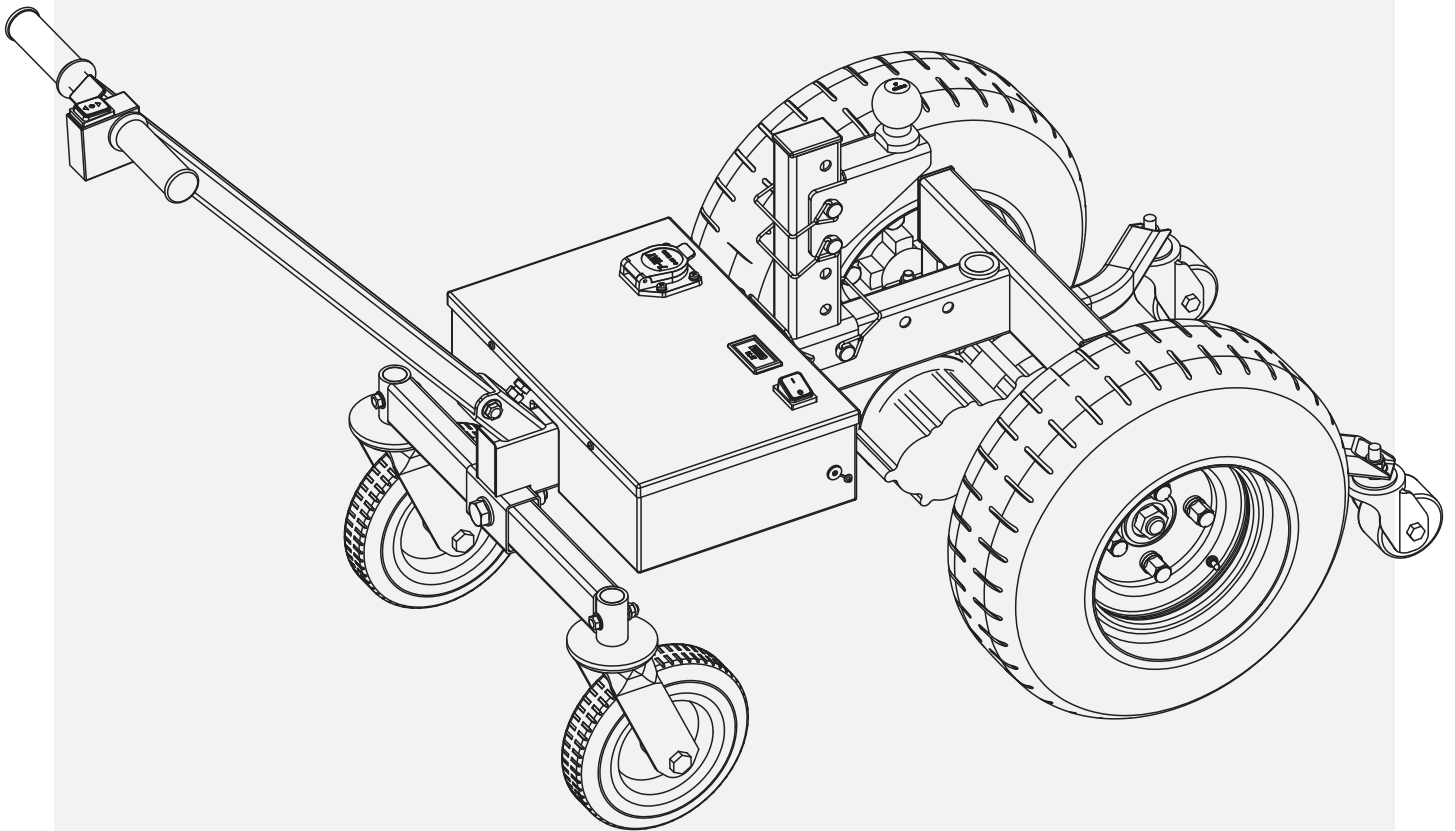

5000 LB Trailer Dolly | GUO158 Operator's Manual



Warning: Please read and thoroughly understand all instructions before operating. Failure to follow safety rules and other basic safety precautions may result in serious personal injury. Keep these instructions in a safe and easily accessible place so that they can be referred to when needed. Retain these instructions to assist in future servicing.

To our valued customers

Your safety and the protection of your equipment are extremely important to us. Please follow the recommended guidelines below to ensure a safe and smooth experience when using your trailer dolly. These safety instructions are critical for proper operation and accident prevention.

Safety in Mind: Requires careful, two-handed operation and following all guidelines, especially when operating on slopes. Always move at slow speeds to stay in control, confirm the trailer is securely connected before moving, and use both hands to keep the dolly steady. Avoid using the dolly on steep slopes or uneven ground where safe operation cannot be guaranteed. Ignoring these precautions may lead to injury or damage.

Get to know the feel of the trailer dolly and its towing capabilities. We recommend practicing how to maneuver the dolly in an open, flat area before connecting a trailer. When preparing for your first tow, select a wide, level surface free of traffic and obstacles. Begin at the lowest speed setting to get comfortable with operation.

IMPORTANT SAFETY AND OPERATIONAL NOTICE

Operate with Care: Always use two hands for maximum control and stability. This is especially important when maneuvering or changing direction—particularly on slopes—so you can maintain full control of the dolly and trailer.

First start-up: When starting in reverse, especially on first use, the dolly may tilt slightly at the front of the handlebar. This is normal—traction force increases shortly after to overcome resistance from the tires.

Keep in mind: Holding the handlebar firmly with both hands and applying steady pressure with your own weight helps keep the dolly stable.

Slow Speeds: Using the dolly at slow speeds is essential for safe operation. It helps you stay in control and respond quickly to uneven terrain or unexpected obstacles.

Secure Connection: Before moving, always confirm the trailer is fully secured to the dolly. A loose or unstable connection can lead to trailer separation and possible accidents.

Slope Considerations: The dolly is designed to handle various surfaces, but steep inclines or declines should be avoided. For safe operation on gentle slopes, follow all operation guidelines—this includes two-handed control and reduced speed. **DO NOT** allow the dolly to lose power or come to a stop on a slope, as this can cause the handlebar to tilt when restarting.

Failure to follow these safety precautions could result in injury or damage. It is your responsibility to operate this equipment safely and with care to prevent accidents and ensure the best experience for all users.

INDEX

Warning	4-5
Safety Symbols	6
Technical Specifications	7
Main Components	8
Parts Overview	9
Assembly	10-13
Operation	14-19
Maintenance	20-23
Storage	24
Warranty	24
Troubleshooting	24-25
Exploded and Parts List	26-27

Warning

- **DO NOT USE THIS PRODUCT TO MOVE TRAILER LOADED OR UNLOADED ACROSS ANYTHING OTHER THAN LEVEL PAVED SURFACES WITH A SLOPE OF LESS THAN 4°.**
- **DO NOT USE ON A LONG SLOPED DRIVEWAY.**
- **DO NOT ATTEMPT TO USE THIS PRODUCT ON A BOAT LAUNCH. THIS PRODUCT IS NOT INTENDED TO REPLACE YOUR VEHICLE.**
- **THE DOLLY MUST ALWAYS BE ON THE LOWER END OF ANY INCLINE. DO NOT PULL UP OR PUSH DOWN AN INCLINE.**

Installation and Operation

- Thoroughly review the "Installation and Operation Guidelines" and familiarize yourself with your electric dolly and its operation.
- DO NOT install or operate the dolly without reading or understanding the operator's manual.
- DO NOT exceed the maximum tow limit of this Trailer Dolly.
- DO NOT operate this dolly if you are under 16 years old.

Connection and Safety Checks

- Check that the hitch ball and the trailer coupler are securely mounted, and that the brake control system of your trailer is in good working order before connecting it to the Trailer Dolly. NEVER pull a RV, yacht or any other trailer which has no brake or has faulty brakes.
- Always use factory approved mounting hardware, components and fittings.

Operating Conditions

- NEVER pull a load with this Trailer Dolly on any steep grade or non-paved road. Always make sure the road surface is paved, level and has a slope of less than 4 degrees.
- DO NOT use the dolly to move people.
- DO NOT operate this dolly under the influence of alcohol or drugs.
- Be sure to remove any objects or obstacles that may hinder the safe operation of the dolly.

Assembly and Maintenance

- When assembling, maintaining or prepping the dolly for storage, be sure to disconnect the power supply from the dolly.
- Never store the battery pack together with nails, screws, keys and other metallic or sharp objects. These items may cause short circuit of the battery terminal resulting in damage to the battery and may cause a fire, endangering personal safety.

Battery Handling Guidelines

- Avoid contact with any fluid that leaks from the battery. Dispose of all batteries in the appropriate manner as these batteries will be dangerous and should no longer be used.
- Be sure to dispose of or recycle the battery according to local regulations.
- Before disposal, be sure to protect the terminal with insulating tape to prevent short circuit.
- DO NOT disassemble or tamper with the battery in any way. Any such tampering will automatically void your product warranty.
- DO NOT attempt to charge a damaged battery pack. Replace it immediately. A damaged battery pack may cause a short circuit or fire.
- Battery packs are covered by the manufacturer's product warranty and will be replaced by the vendor if the product is still under warranty.
- DO NOT burn the battery pack.

Operating Regulations

- DO NOT operate the dolly in an environment containing explosive or combustible materials.
- When the dolly is not in use, be sure to cut off the battery power.
- Be sure to use the charger and lead-acid battery packs provided by manufacturer only. Other types of batteries may burst and cause personal injury.
- DO NOT use chargers with damaged wires or plugs. Chargers with such issues should be replaced immediately.
- DO NOT use the charger provided by manufacturer to charge other batteries.
- DO NOT charge the battery in a humid environment, and do not cover the charger with clothes or other items during charging.
- The use of accessories not recommended or provided by the charger manufacturer may lead to the risk of fire, electric shock or personal injury.

Charging and Storage





- Always charge the battery at a temperature of 32°F-120°F (0°C-49°C).
- Always store the battery at a temperature of 32°F-86°F (0°C-30°C).
- Be sure to disconnect the charger when the battery is fully charged.
- Be sure not to completely discharge the battery. If not in use, be sure to charge the battery every 3 months.

Disclaimer

- Before operation, please read and understand all instructions carefully, and the dolly can only be operated when the safety precautions and other basic safety preventive measures are strictly observed.
- The Company will not be responsible for any personal injury or property loss caused by man-made reasons or abnormal use.

Safety Symbols

Some of the following symbols are used on this product. Please study them and learn their meanings. Proper interpretation of these symbols will help you to operate the product in a safe and responsible manner.

SYMBOL	DEFINITION
	Read Operator's Manual in its entirety. To reduce the risk of injury, user must read and understand operator's manual before using this product.
	Footwear. Always wear safety shoes or work boots when operating the machine. Sandals and slippers or open toe shoes or any type are strongly discouraged.
	Gloves. Always wear nonslip, heavy-duty protective gloves when operating this product.
	Safety Alert. Precautions that involve your safety.
	Open Flame alert. The power cord is extremely flammable. Keep the splitter away from open flames, sparks, pilot lights, heat, and other potential ignition sources.

DANGER

DANGER indicates a hazardous situation which, if not avoided, will result in serious injury and possibly death.

WARNING

WARNING indicates a potential hazardous situation which, if not avoided, could result in serious injury or death.

CAUTION

CAUTION indicates a hazardous situation which, if not avoided, could result in minor or moderate injury.

NOTICE

NOTICE indicates information considered important, but not hazard-related (e.g., messages relating to property damaged).

Technical Specifications

Use Case

The SuperHandy Electric Trailer Dolly is compact, powerful, and easy to operate. It's designed to tow trailers, RVs, and similar equipment with ball hitch couplings. It supports forward and reverse movement, turning, and short-distance repositioning—perfect for navigating tight spaces.

SKU#	GU0158
Ref. No.	PD107.01
Power Supply	DC 24V 9Ah
Motor Power	800 W
Max. Towing Capacity	Trailer Weight: 5,000 lb (2,270 kg) Tongue Weight: 830 lb (370 kg)
Hitch Ball Spe.	2"
Speed	1.0 MPH (1.5 km/h)
Max. Slope	<2.3° (4%) at 5,000 lb (2,270 kg) <4° (7%) at 3,330 lb (1,510 kg)
Ball Height Range (Ball Top From Ground)	17.5" to 26.5" (445-675 mm)
Front Tire Size	Solid Tire 8" (200 mm) Tread width 2" (50 mm)
Rear Tire Size	Pneumatic Tire 16.5" (420 mm) Tread width 7" (180 mm)
Product Dimensions	58"x28"x39" (1474x707x980 mm)
Package Dimensions	38"x30"x23" (965x765x588 mm)
Net Weight/Gross Weight	143/183 lb (65/83 kg)

Main Components

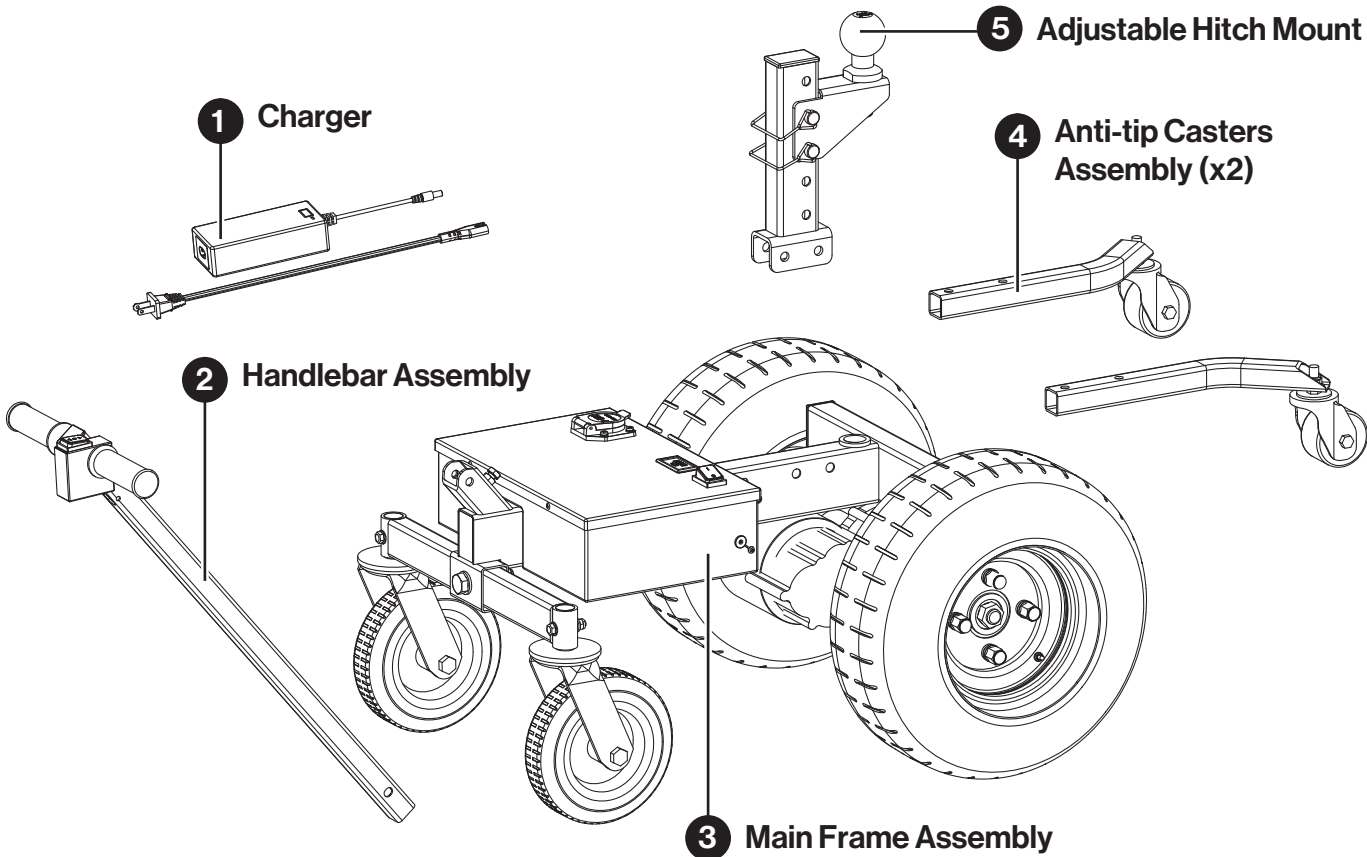

Assembly Hardware



M10 Nut (x5)

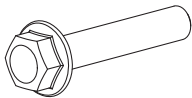

M10x55 Bolt (x5)

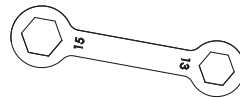

Wrench (x1)

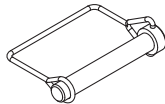

Lock Pin (x2)

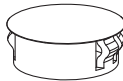

Domed Plug (x1)

Parts Overview

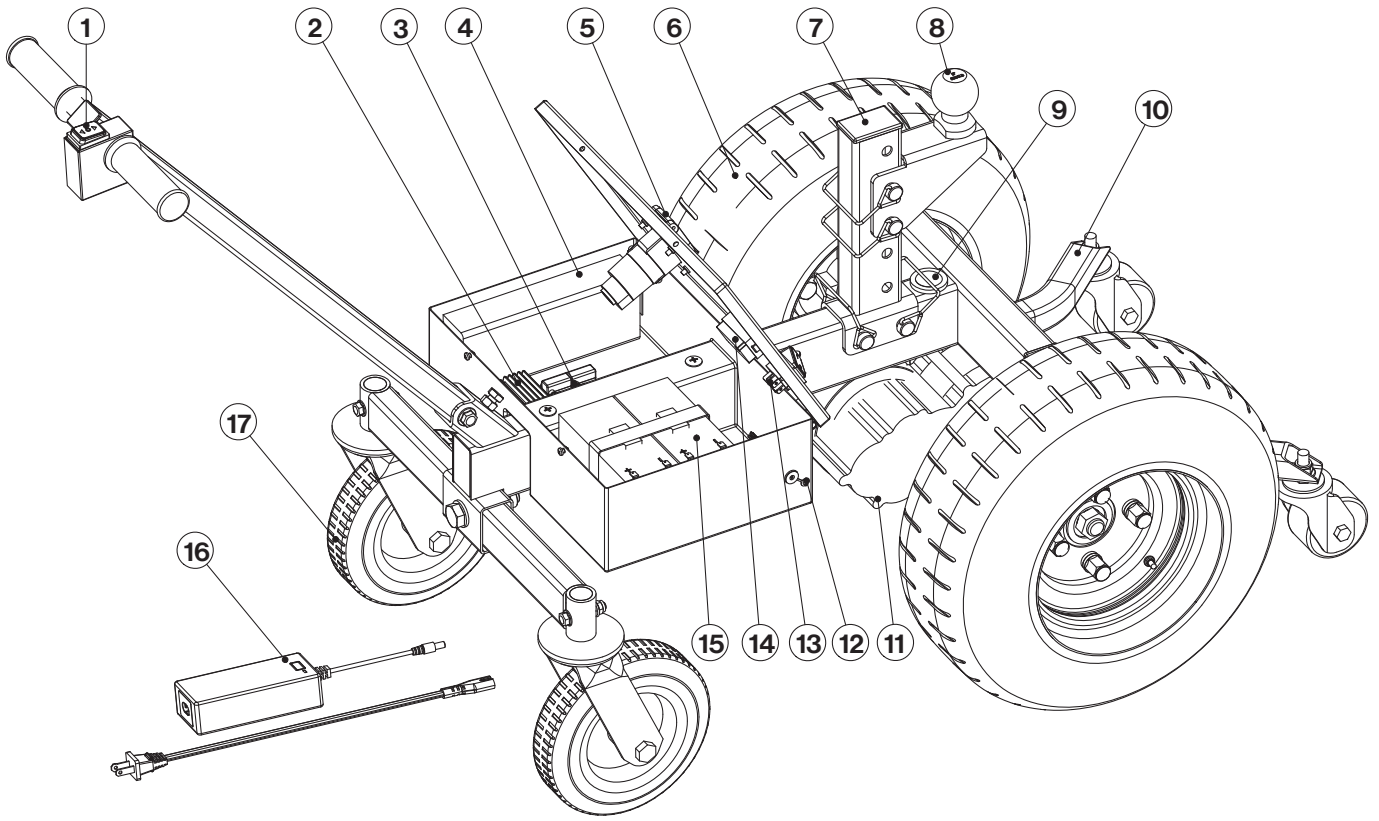

- 1. Start Switch:** Controls the movement direction - press forward (↑) to drive or reverse (↓) to back up.
- 2. Voltage Converter:** Steps down power from 24V to 12V for internal circuits.
- 3. Control Switch:** Control the RV braking system.
- 4. Controller:** Receives user input and manages motor function.
- 5. 7-Pin Connector:** Supplies 12V power to the trailer's electric brake.
- 6. Drive Wheel:** Transfers power from the motor to move the dolly.
- 7. Hitch Height Adjuster:** Raises or lowers the hitch ball to align with your trailer coupler.
- 8. Hitch Ball:** Connects to your trailer's coupler.
- 9. Hitch Mount Frame:** Used when a lower hitch ball position is required.
- 10. Anti-tip Casters Assembly:** Stabilizes the dolly and prevents tipping during use.
- 11. Rear Axle Motor Assembly:** Provides propulsion through the rear drive system.
- 12. DC Charging Port:** Connects the charger to the battery system.
- 13. Power Switch:** Turns the main power on/off. Disconnect when not in use.
- 14. Battery power display:** Displays battery power and voltage readings.
- 15. Lead-Acid Batteries (2x12V 9Ah):** Powers the dolly.
- 16. Charger: Input:** 100-240V AC, Output: 28.8V DC / 2.0A.
- 17. Swivel Caster Wheel:** Provides front-end maneuverability.

Assembly

Recommended tools (NOT Included in Package)

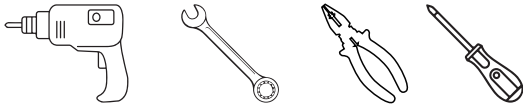

Step-1 Open the Lid of the Battery Case

1. Remove 2 M4x8 screws. **(Fig.01)**
2. Open the lid of the battery case.

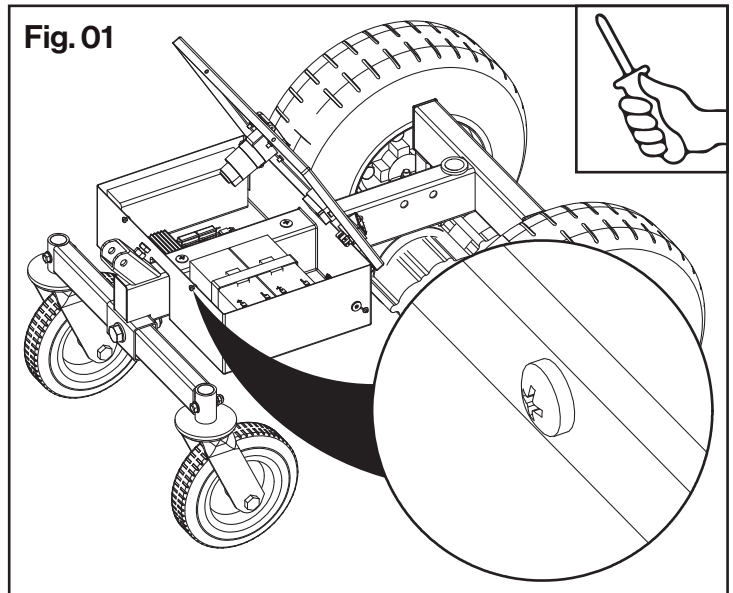

Step-2 Attach the Handle Bar Assembly

1. Loosen the M10x16 bolt. **(Fig.02)**
2. Thread the wire from the handle bar through the square opening at the front of the frame. Lead the wire out through the round hole on the side of the control box.
3. Insert the handle bar into the mounting tube.
4. Insert the M10x55 bolts through the aligned holes. Secure with M10x16 nuts.

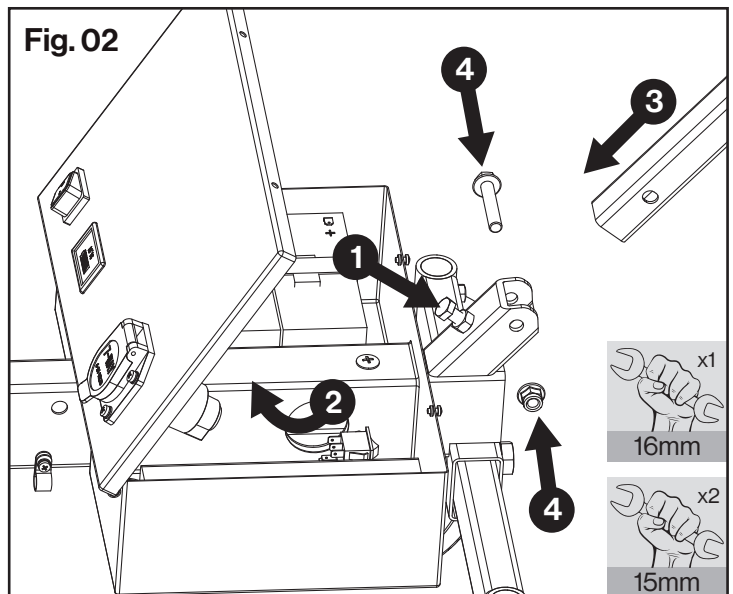

Step-3 Connection Terminals and Battery Cable

1. Before connecting the terminals and battery cable, carefully read the cable schematics diagram placed next to the battery. **(Fig.03)**

⚠ WARNING

Ensure the power switch is in the OFF position during wiring (Fig 03). If the switch is ON, arcing may occur when connecting the terminals, which could damage them.

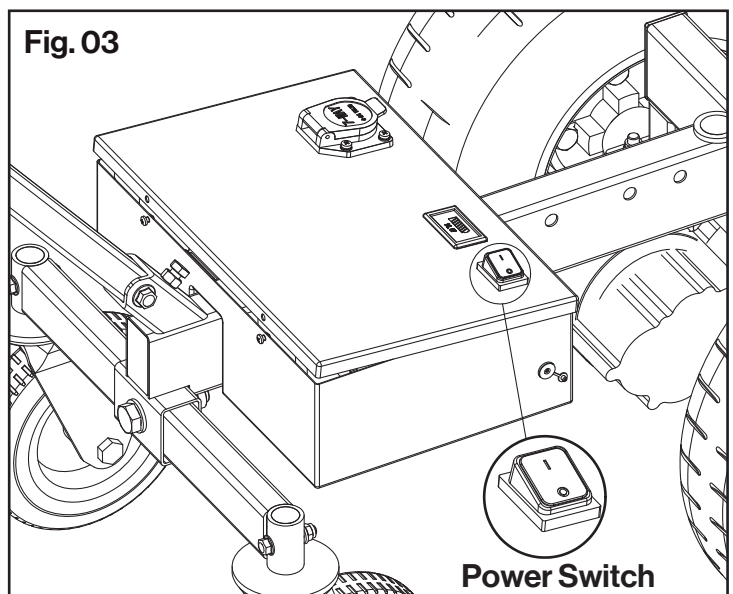

2. Insert the female connector of the red wire into the matching red male terminal on the battery.
(Fig.04)

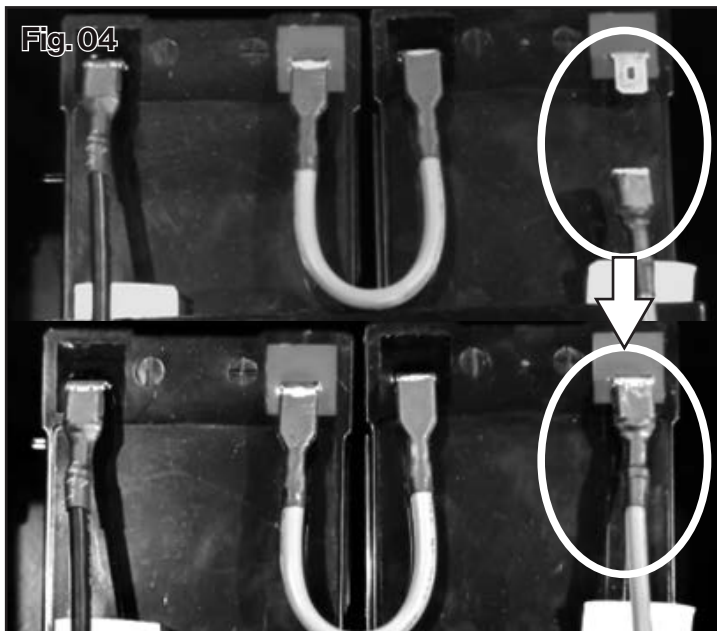

3. Connect the wire terminals from the handle bar to the 2-pin and 3-pin connectors inside the control box.
(Fig.05)

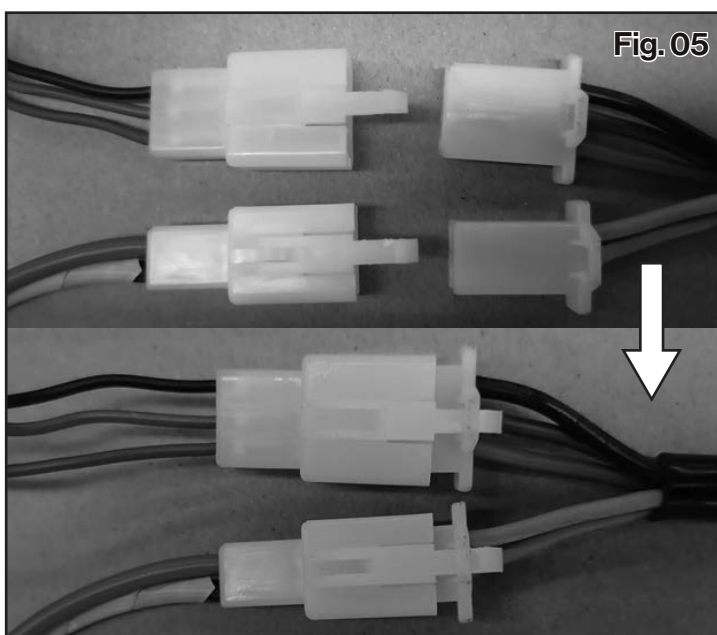

4. Once all terminals are connected, insert the Domed Plug into the hole under the dolly frame.
(Fig.06)

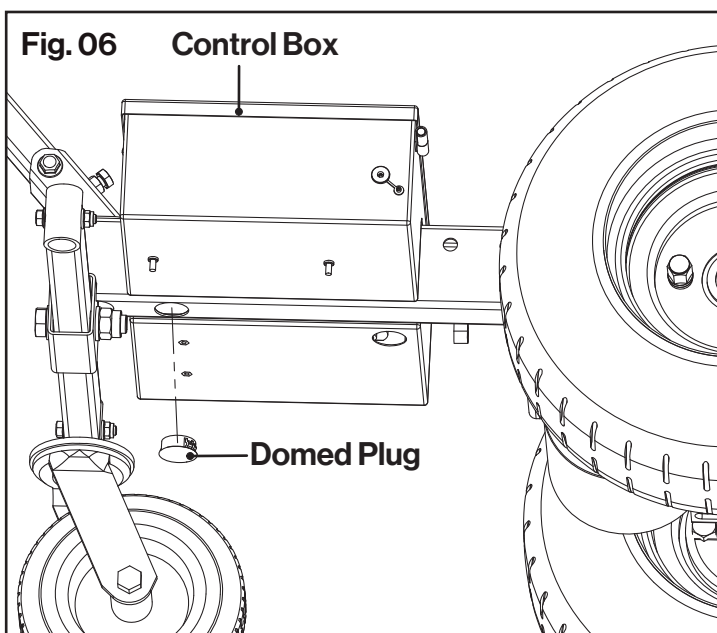

Step-4 Install the Adjustable Hitch Mount

1. Align the base of the Adjustable Hitch Mount with the bracket on the dolly frame and choose the correct height hole. **(Fig.07)**
2. Insert 2 Lock Pins to secure the adjustable hitch mount.

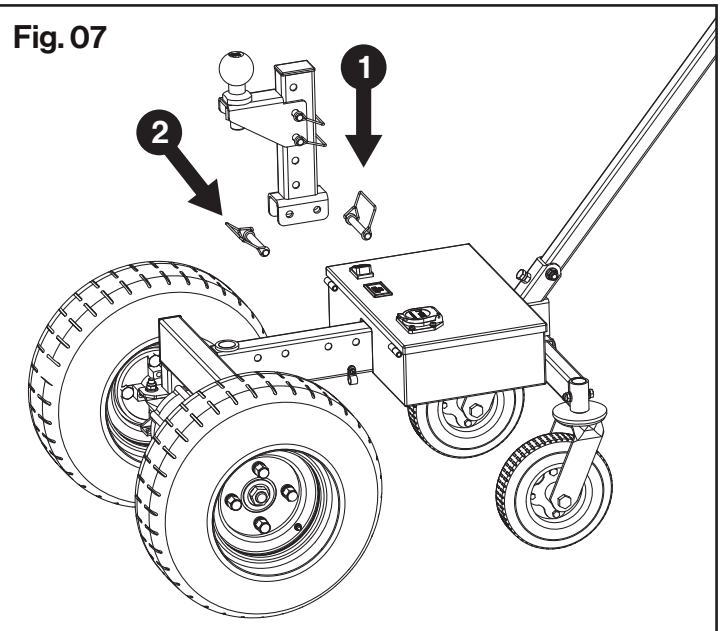

Step-5 Attach the Anti-tip Casters Assembly

1. Align the holes on the Anti-tip Casters Assembly and the Rear Axle Motor Assembly. **(Fig.08)**
2. Insert 4 M10x55 bolts and secure them with 4 M10 nuts.

⚠ WARNING

Tighten the bolts and nuts to prevent the Anti-tip Casters from coming loose or being damaged.

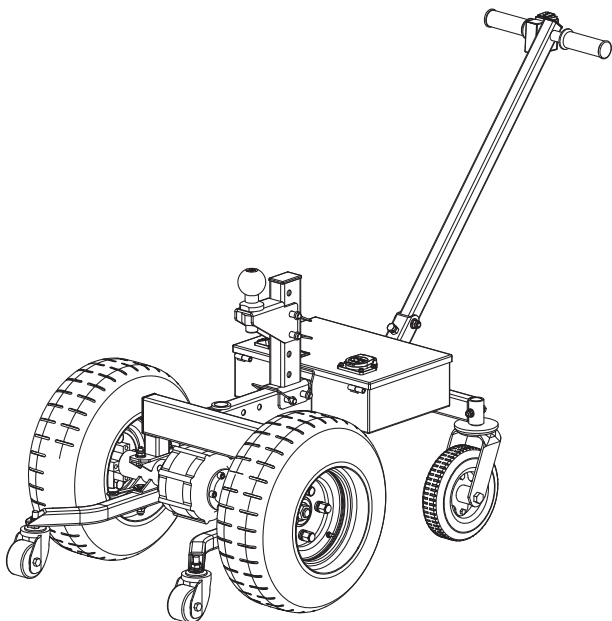
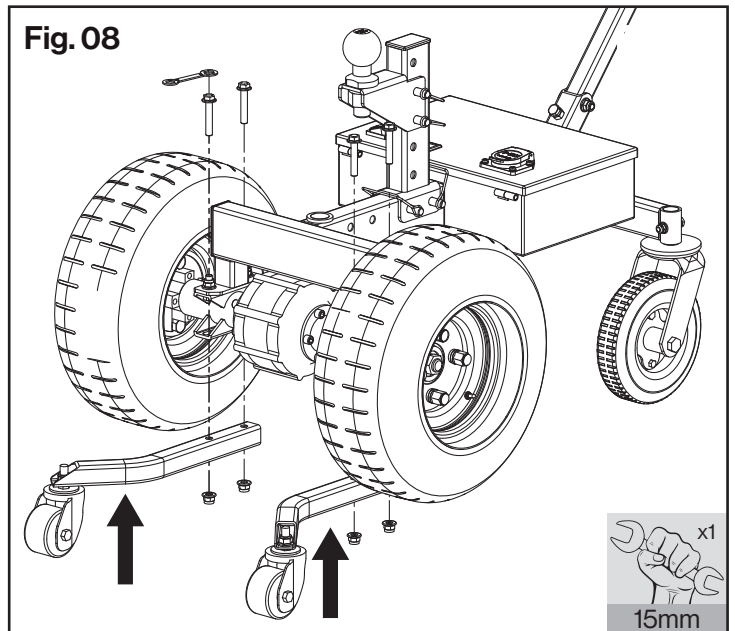

Battery Cable Connection

Connect the battery wires according to the Electrical Schematic Diagram below. Ensure polarity and connections match to avoid damage. **(Fig.09)**

Electrical Schematic Diagram

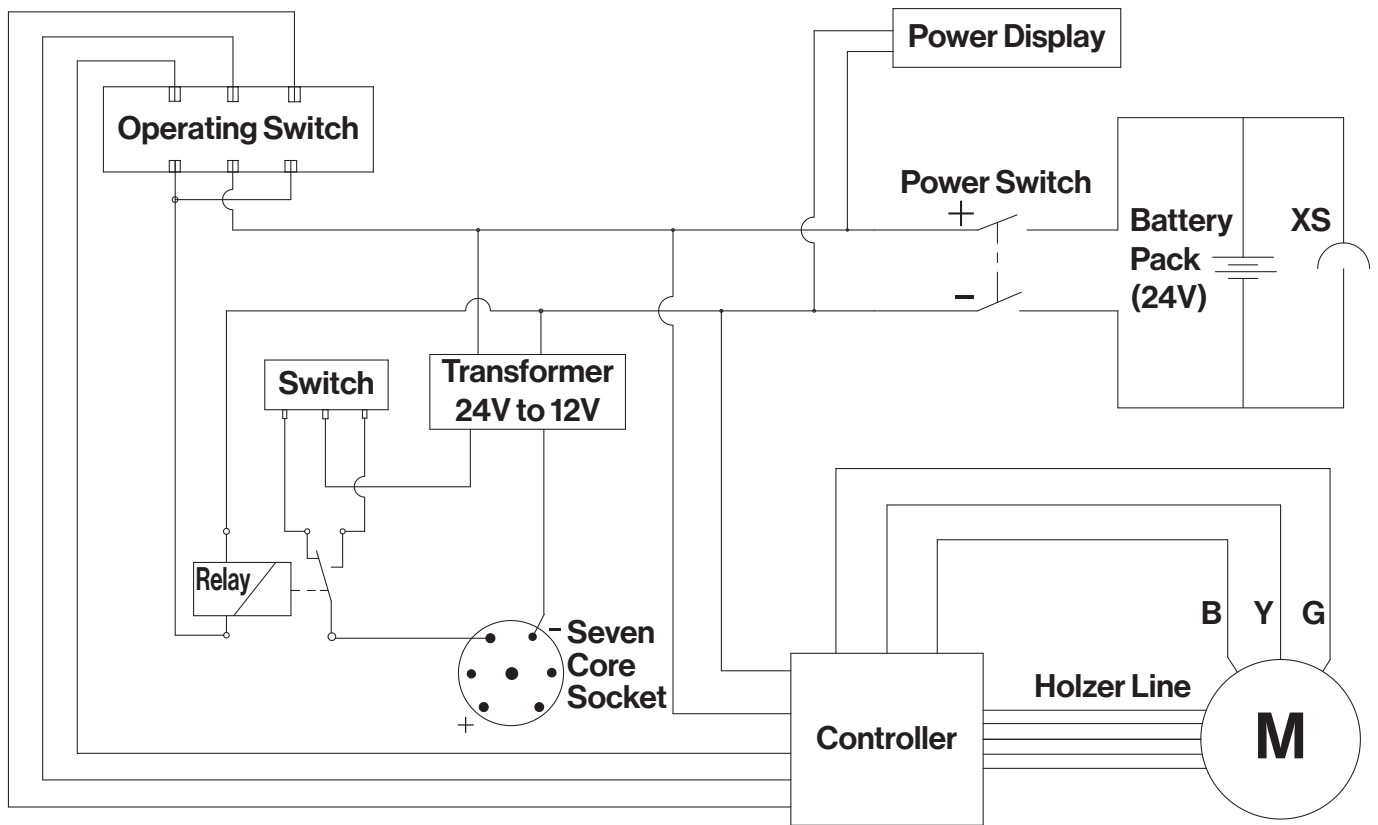
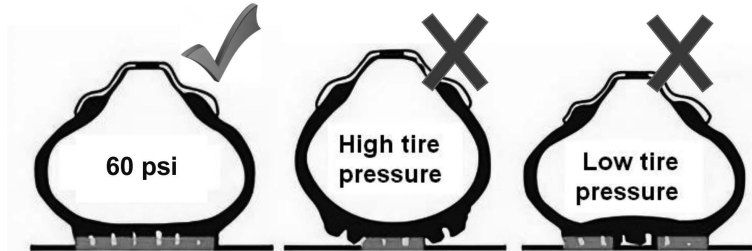

Fig.09

Operation

Preparation Before Operation

1. Before operation, check that all bolts are fastened tightly, and the hitch ball is secured.
2. Be sure that the tires are free of defects such as cracks and bulges, and the tire pressure is kept at 60 ± 2 psi (4.2 ± 0.1 kg/cm²)



3. Ensure the battery is charged in full (**see Step 4**), and check whether all switches are operated effectively.
4. If the battery is not fully charged before use, please charge the dolly by following the steps below.

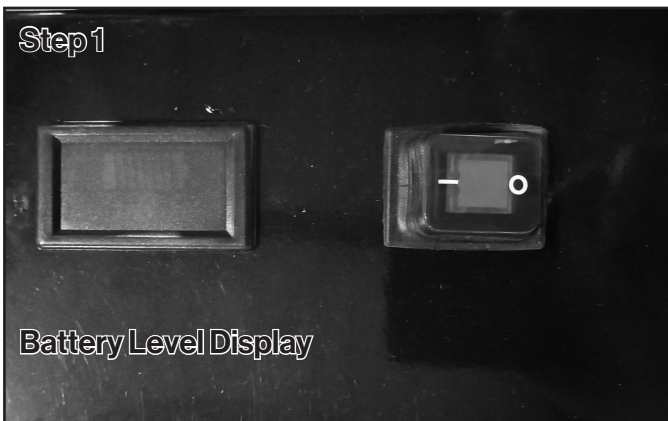

Turn off the power switch before charging.



Insert the charger into the battery charging port.

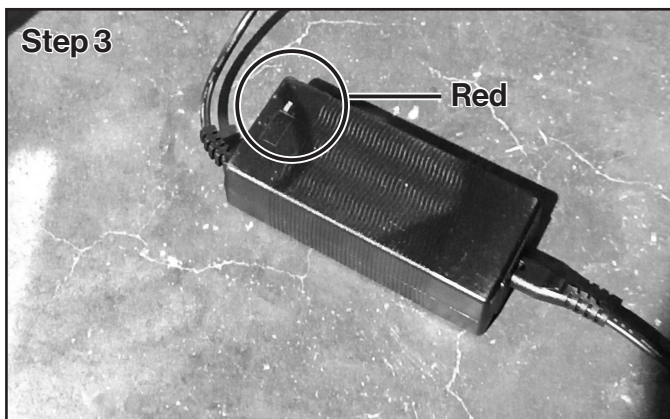

After connecting to power, the charger's red light indicates the charging status.

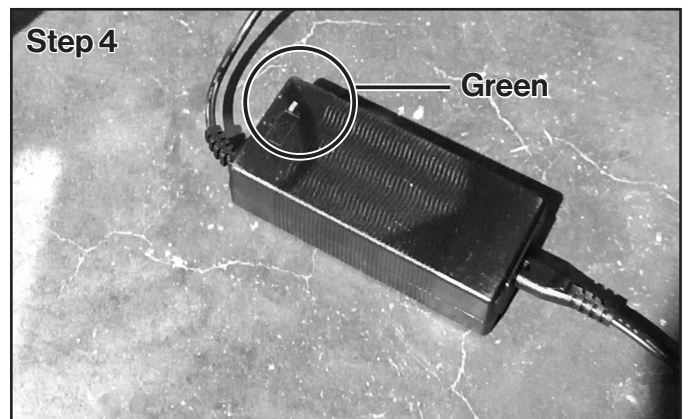

A green light on the charger means charging is finished, and the Battery Level Display should show full bars.

NOTE: Battery Level Display

This indicator has two sections for clear battery status monitoring:

1. Battery Level Segment Gauge

Upper 8-segment gauge shows remaining battery capacity:

All segments light up at full charge, turning off right-to-left as the battery discharges during use.

During operation: Recharge immediately if only the 2 red segments remain lit.

Note: The gauge may show green after use stops due to battery voltage recovery; this does not indicate sufficient charge for continued operation.

2. Digital Voltage Readout

Lower section provides real-time battery voltage readings:

Fully charged: approx. 28V

During operation: Recharge promptly if the reading sustains below 22V

Important Safety Note

Continuous low-battery operation may cause permanent battery damage and shorten service life. Always recharge promptly when the low battery warning triggers.

5. Perform no-load test run, to confirm that the Swivel wheel rotates flexibly and entire unit moves forward and backward freely.

6. Be sure the towed trailer weighs less than 5000 lb / 2270 kg, and tongue weight is less than 830 lb / 370 kg.

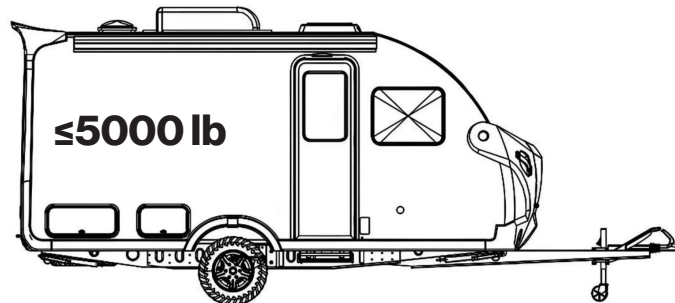

7. The towing road is required to be flat, like concrete, asphalt, etc. At soft surface such as grass and gravel, there will be easier to get the tires stuck and make the dolly block.

8. The towing road must have a slope not exceeding 2.3° (4%) for trailers under 5,000 lb, or 4° (7%) for trailers under 3,330 lb. This equipment lacks a brake system and must not be parked on an incline.

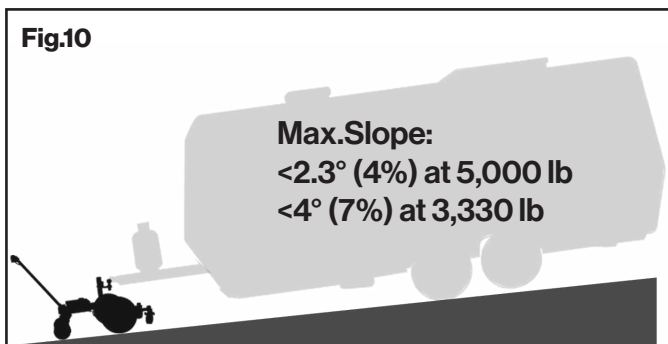

The dolly must always be on the lower end of any incline. DO NOT pull up or push down an incline.

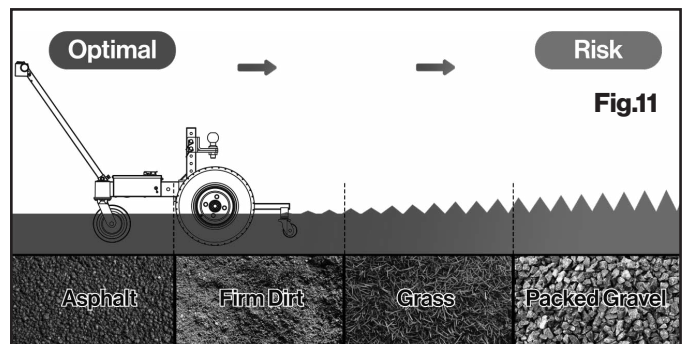

Dolly is better working at flat and firm surface, like concrete, asphalt, etc.. At soft surface such as grass and gravel, there will be easier to stuck the tires and make the dolly block.

⚠ NOTICE

- Grip the handlebar with both hands, and apply pressure while using your own body weight to help stabilize the dolly.
- Avoid losing power or stopping the dolly on slopes to prevent the handlebar from tilting.

Trailer Brake System Control Switch

Important: This trailer dolly is not equipped with a braking system. The trailer dolly is equipped with an electric trailer brake control system. It connects to the trailer via a 7-pin plug, allowing the electric trailer brake to be controlled while operating the trailer dolly. **(Fig.12)**

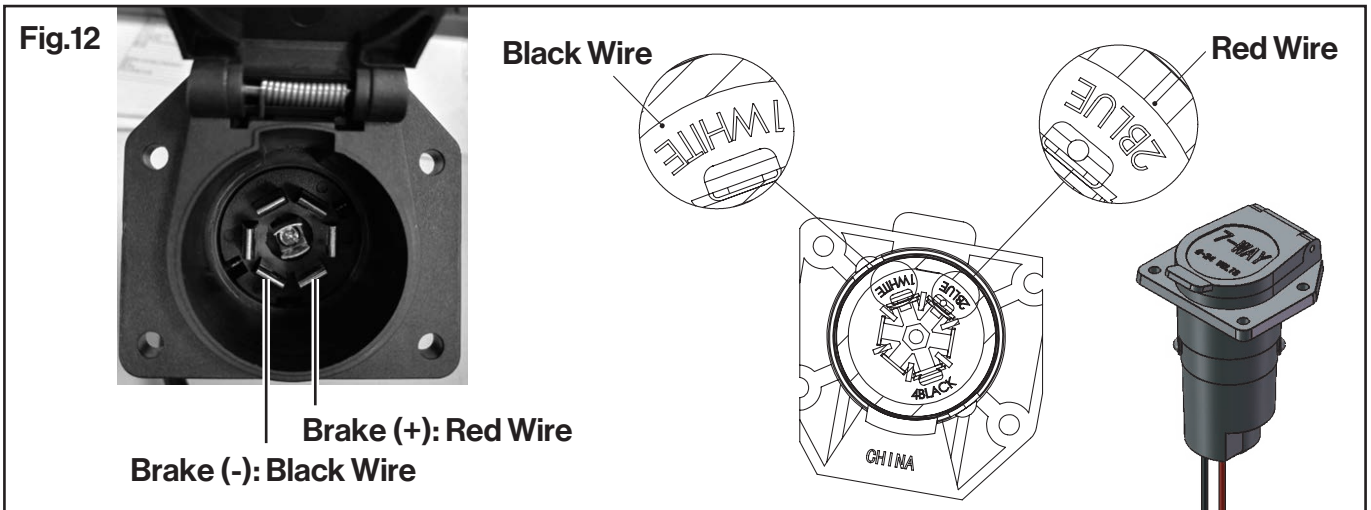

How It Works

1. Connect the trailer's 7-pin plug to the socket on the dolly.
2. Once connected, the dolly outputs a signal that engages the electric trailer brake and keeps it in a braking state
3. When the Forward / Reverse Start Switch is pressed, the electric trailer brake releases, allowing the dolly to drive and move the trailer.

Manual Adjustment (If Needed)

1. When the Forward / Reverse Start Switch is pressed, if the trailer brakes do not disengage automatically:
2. Turn off the main power switch.
3. Open the control box.
4. Locate the Brake Disengage Toggle Switch.
5. Toggle the Brake Disengage Switch to the opposite position ("I" ↔ "II"), then recheck brake operation. **(Fig.13)**
6. Close the control box and recheck brake operation.

Battery Drain Notice

If the dolly will not be used for an extended period, disconnect the 7-pin connector to prevent unnecessary battery drain.

Selection of Hitch Ball Position

To maintain proper traction and ensure stability:

- Select the appropriate hitch ball position for your direction of travel. **(Fig. 14)**
- When driving forward (D), move the lever to position A.
- When reversing (R), move the lever to position B.

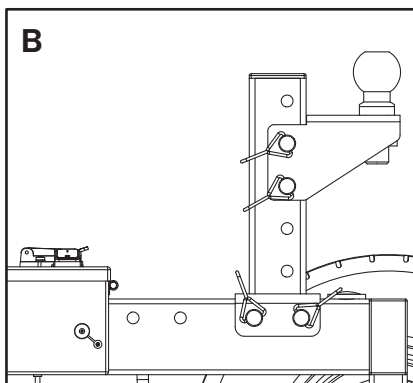
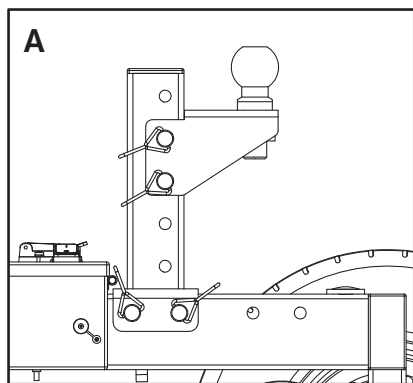

Fig. 13

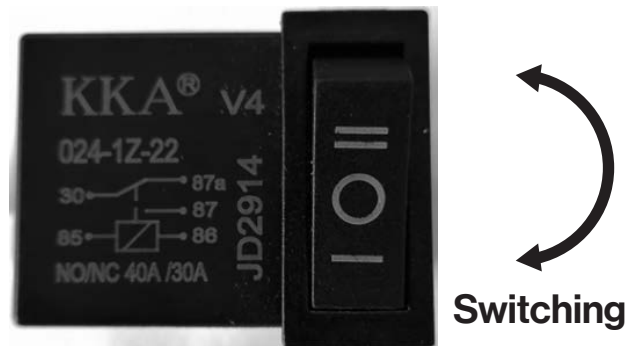
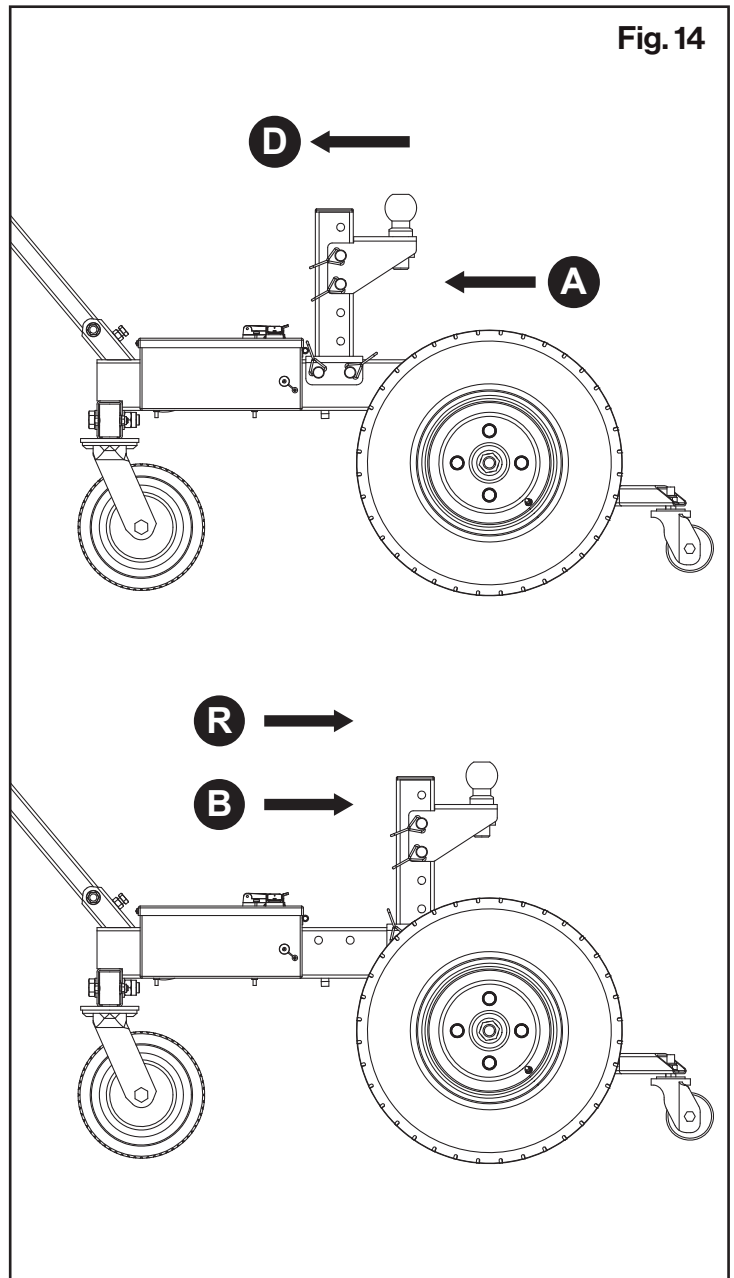

Fig. 14



Adjusting Hitch Ball Height

The hitch ball height of the dolly can be adjusted up and down (**Fig.15**), or the hitch ball can be installed directly on the main frame. (**Fig.16**)

- The adjustment range of the hitch ball height: 17.5"-26.5".
- When installing the trailer, always make sure the connecting rod is parallel to the ground, because any tilt will affect the traction efficiency and even the safety risk of overturning. (**Fig.17 & Fig.18**)

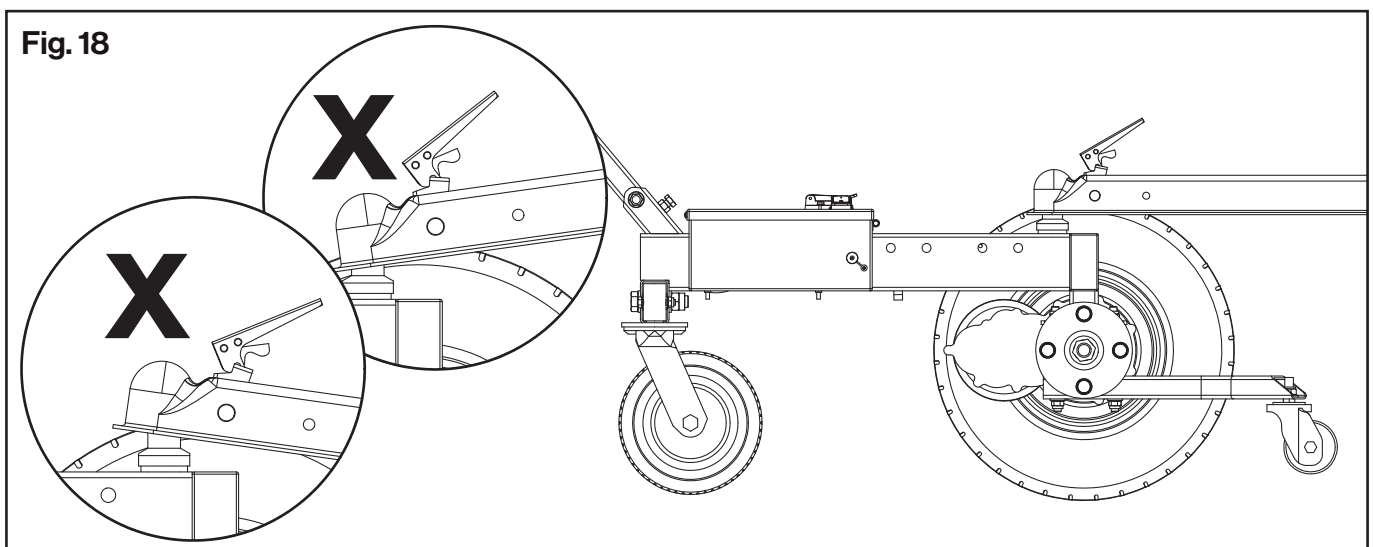
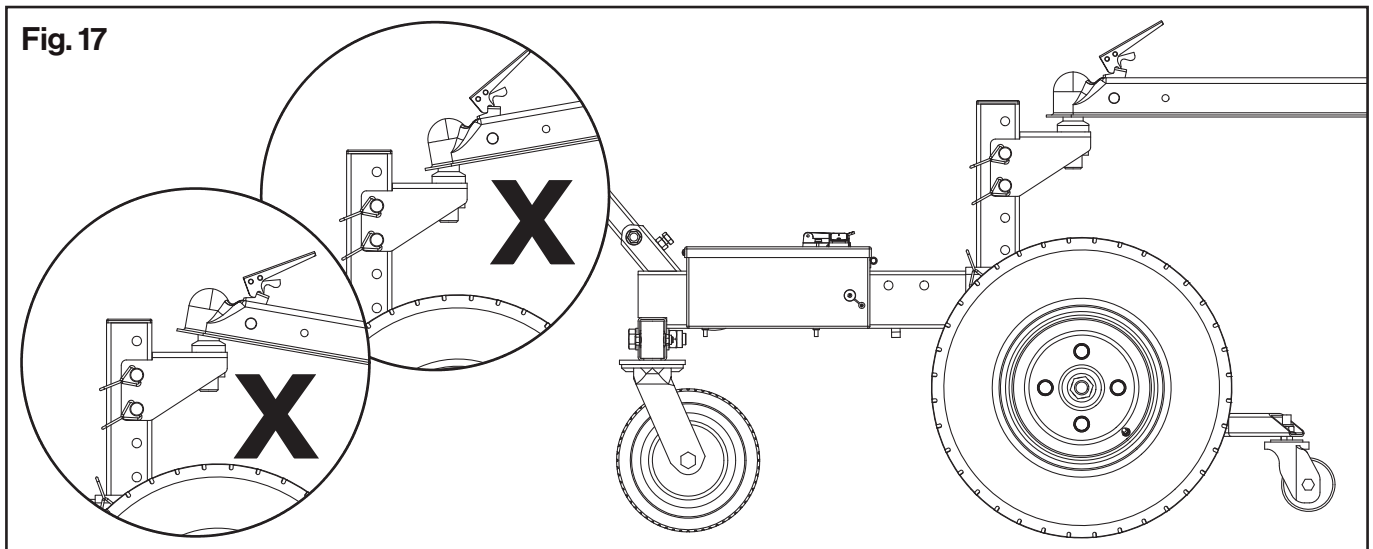
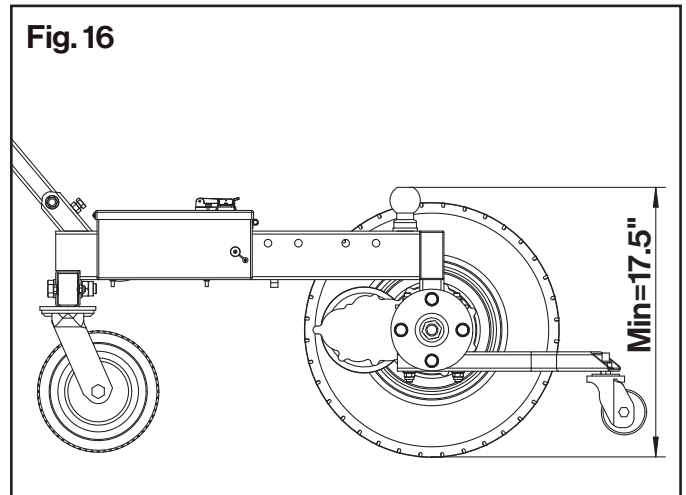
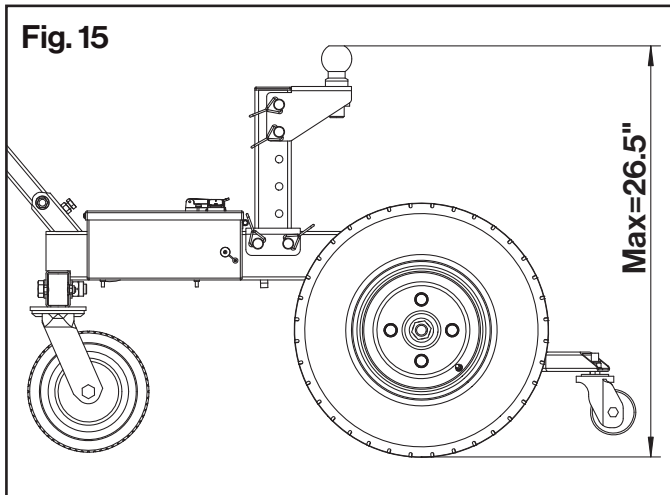

Towing Procedure

1. Position the dolly near the trailer's coupler. Adjust the hitch ball height so it is slightly lower than the coupler.
2. Move the dolly so that the hitch ball is aligned with the trailer coupler. Lower the trailer slowly until the coupler fully engages with the hitch ball.
3. Confirm a secure connection, then lock the safety latch. **(Fig.19)**

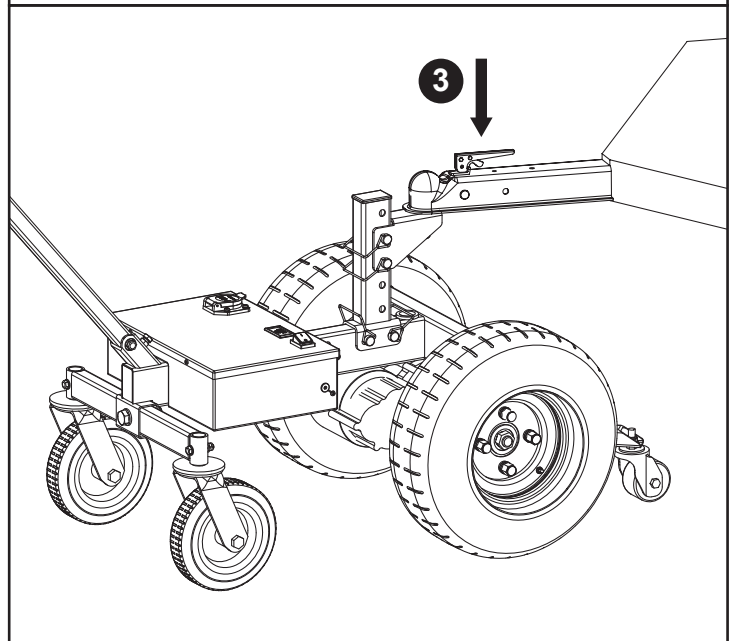
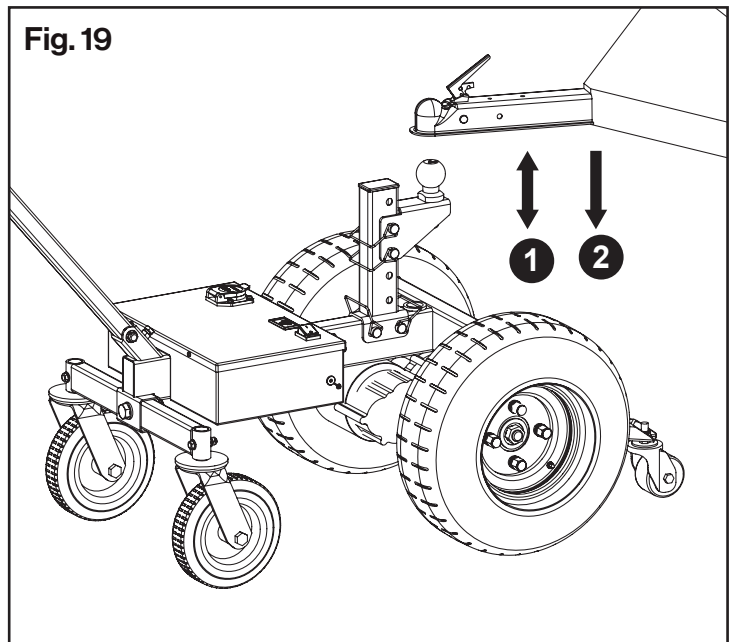

4. Turn on the Power Switch , Then check the Battery Level Display to confirm a full charge.
5. Press the Start Switch in the same direction you plan to move the dolly . The dolly will begin moving slowly at a speed of 1.5 km/h. **(Fig.20)**
6. After use, shut off the unit and park it in a safe position.

Important: Maintain regular battery charging. If the lead-acid battery is left uncharged, it can become fully discharged and may fail to recharge or be permanently damaged.

Overload Protection

1. The dolly includes built-in overload protection, which will automatically shut off the unit if excess load is detected. This protects both the user and the product.
2. Do not attempt to restart the dolly while it is overloaded. Reduce the load to within the rated capacity before restarting.

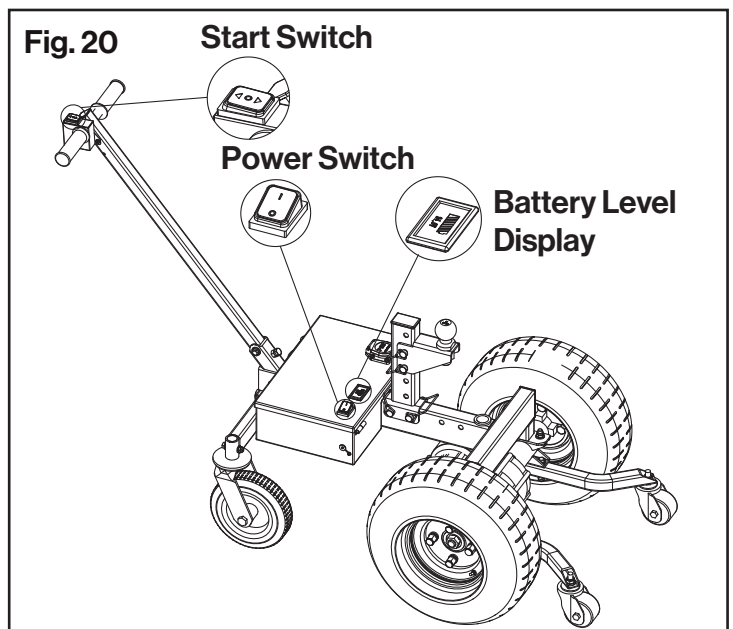

Maintenance

Replacing the Start Switch

1. Use a flat tool to gently pry open both sides of the Start Switch, then disconnect the terminal wires. **(Fig.21)**

2. Installation of a new start Switch. **(Fig.22)**

Step 1: Wire the new switch according to the diagram.

Step 2: Test the direction of movement using the Switch. Once confirmed, align the Switch and press it into the square slot.

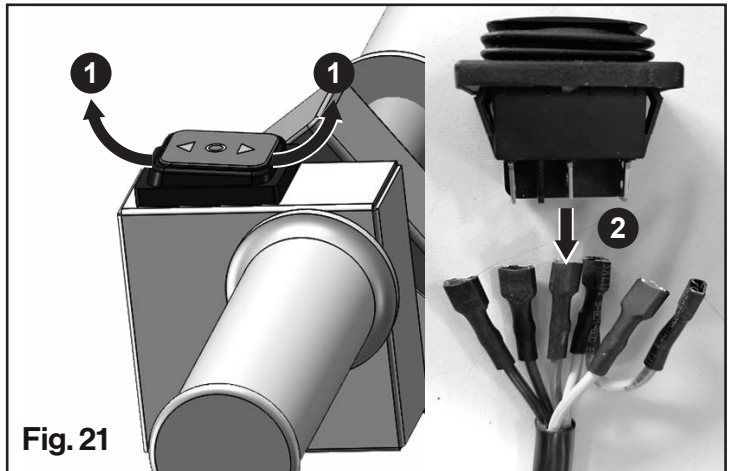
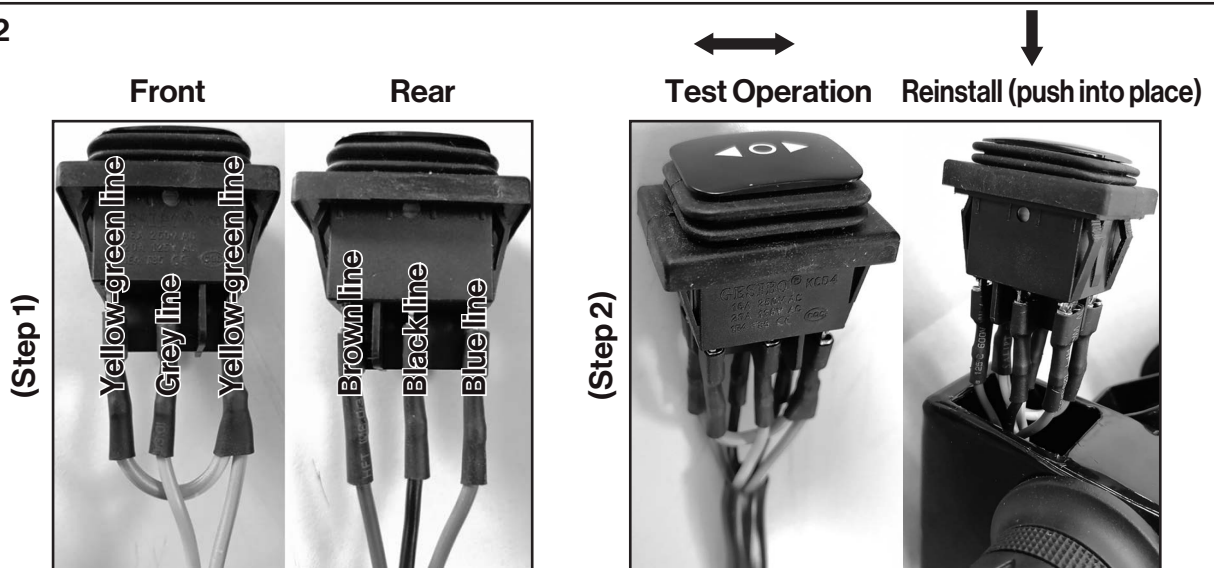

Fig. 22



Replacement of the Drive Wheels

1. Remove the Wheel

Loosen and remove the four M14 nuts (S/N 7), then gently tap the drive wheel loose using a soft mallet, alternating from left to right. **(Fig.23)**

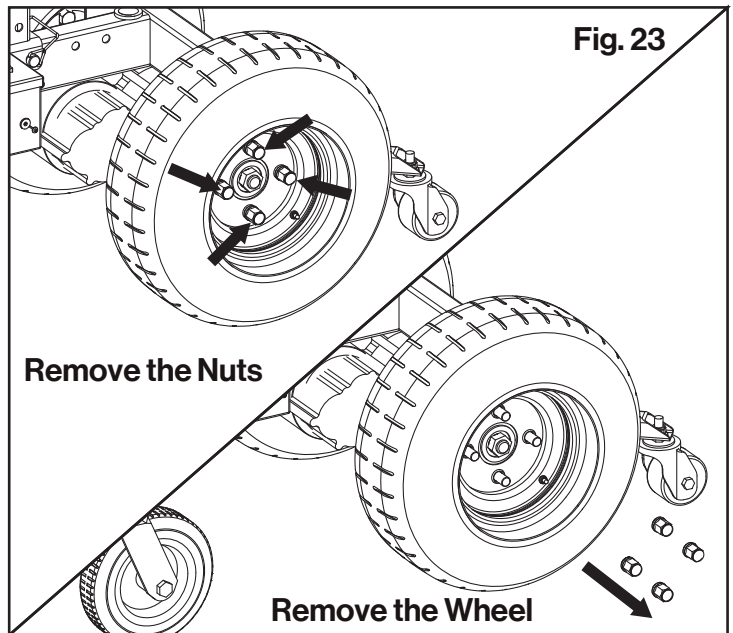

2. Install the New Wheel

With the valve stem facing outward, align the wheel onto the bolts. Tighten the four M14 nuts diagonally to secure the wheel evenly. **(Fig.24)**

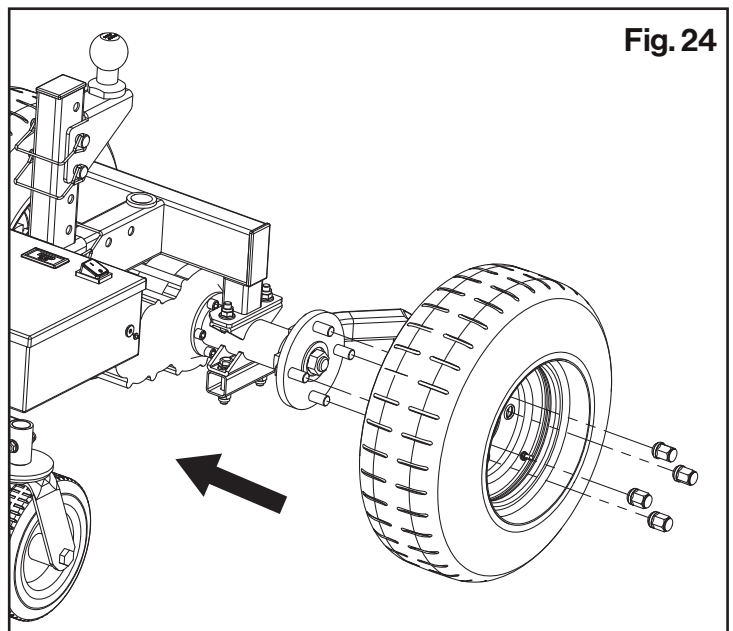

Replacement of the Controller

1. Remove the Controller

Loosen the M4x8 screws on the control box, open the lid, disconnect all terminals from the controller, and remove the unit. **(Fig.25)**

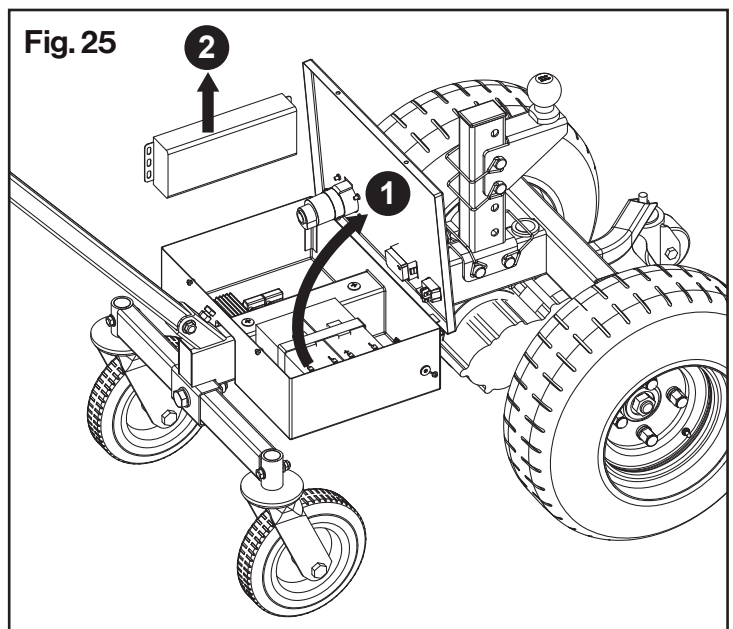

2. Install the Controller

Insert the controller into the battery box compartment and connect all wires to their matching color-coded terminals according to the diagrams **(Fig.26)**:

- (a) Connect to the rear axle motor
- (b) Connect to the batteries
- (c) Connect to the Start Switch
- Close the battery box lid and securely tighten the M4x8 screws.

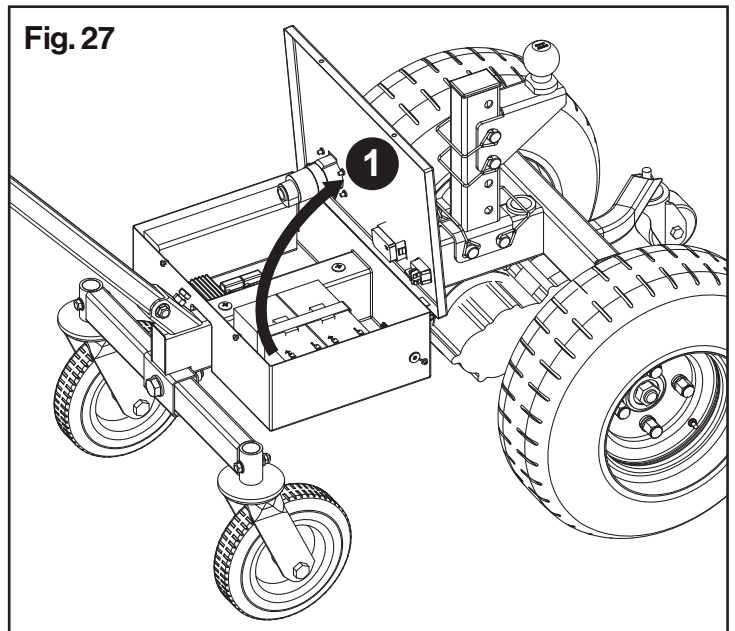
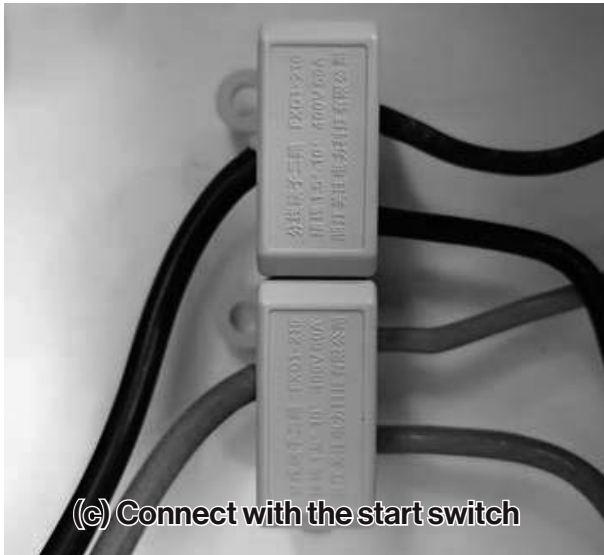
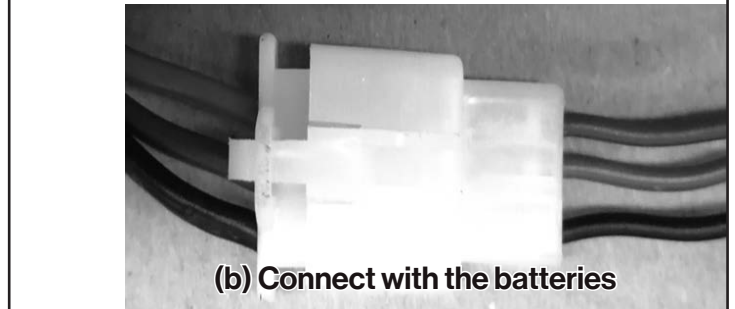
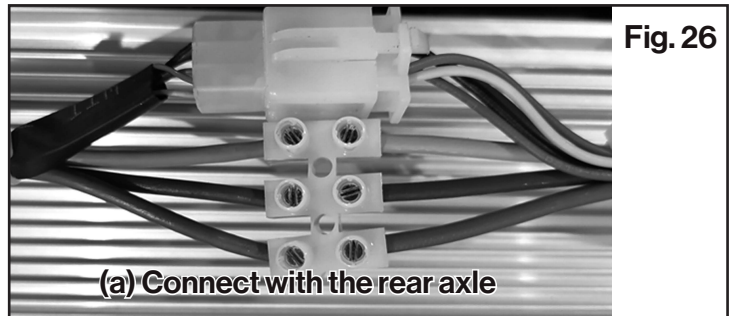

Replacement of the Power Switch

1. Remove the Power Switch

- (a) Open the lid of the battery box.
- (b) Disconnect the battery terminals first to avoid short circuits.
- (c) Then pull all terminals out of the power switch. Press the snap clips inward to release the switch and push it out. **(Fig.27)**

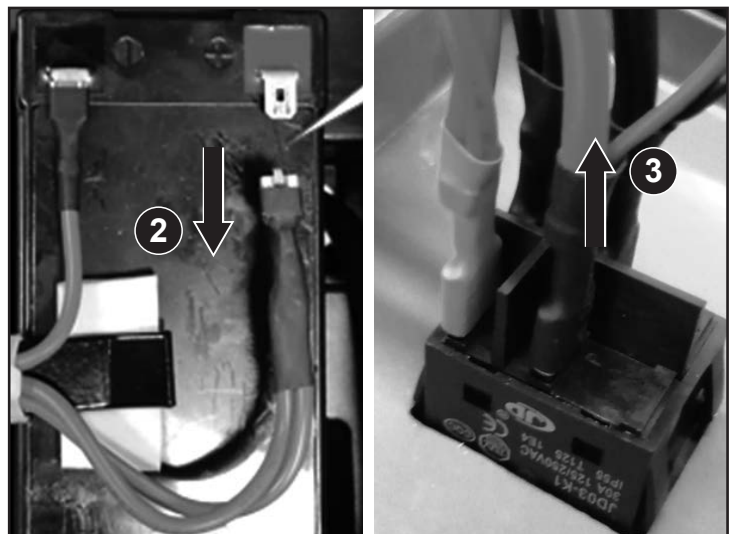

2. Install the Power Switch

- Align the power switch with the square hole in the lid and press it fully in to place.
- Ensure the snap clips are locked securely. Then, insert the terminals according to the electrical schematic and turn on the power after verifying correct in stallation. **(Fig.28)**

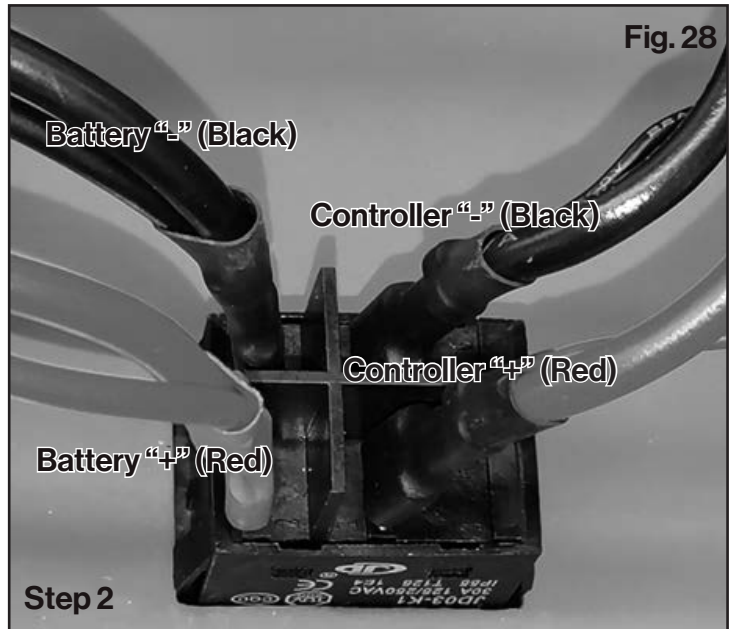
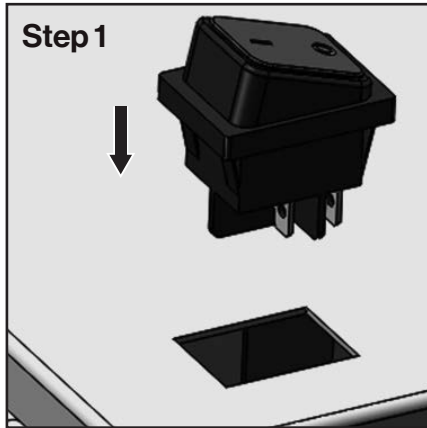

Replacement of the Batteries

1. Remove the Old Batteries

Step 1:

Open the lid of the battery box. Disconnect all terminals.

Step 2:

Then remove the two M5 screws and lift out the fixing bracket and battery set. **(Fig.29)**

2. Install the New Batteries

Install the replacement batteries in the reverse order and reconnect the terminals per the electrical diagram.

Note: Due to shipping restrictions, replacement batteries must be sourced locally. Use NPP 12V 9Ah lead-acid batteries or an equivalent model.

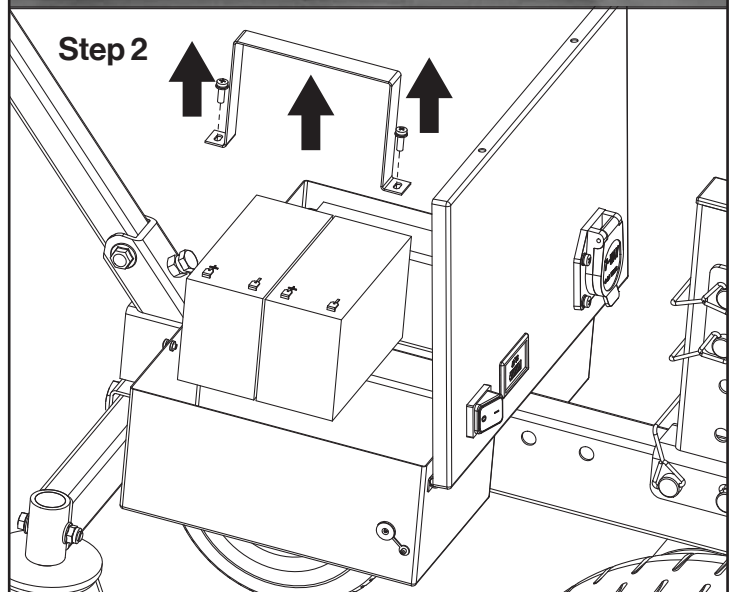
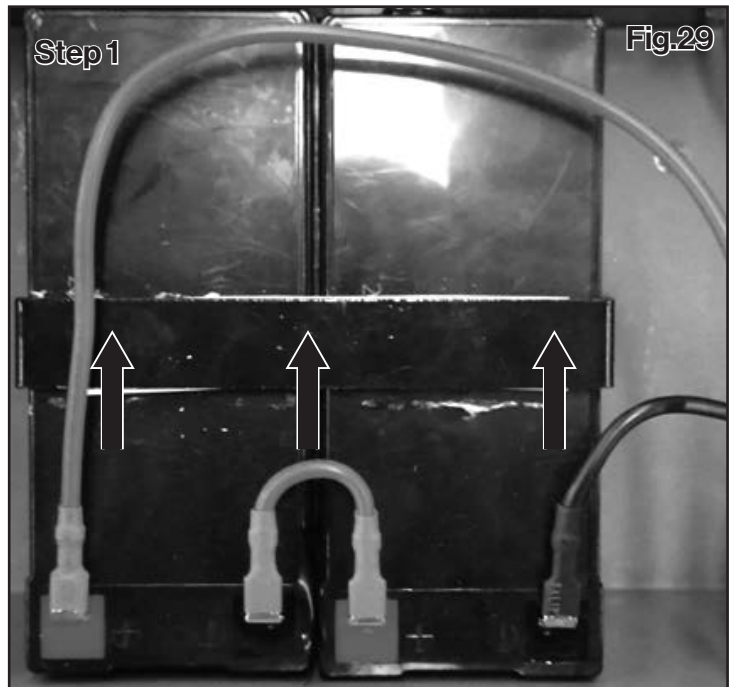

Storage

1. Store the product in a cool, dry, and dust-free area, away from direct sunlight and rain.
2. During transportation, loading, or unloading, avoid dropping, throwing, or performing any impact-heavy actions that could damage the unit.

Warranty

Twelve (12) months for workmanship of the product, except for wearing parts. Warranty period starts from the product purchase date. Warranty covers material quality and workmanship only. Warranty does not cover product for issues caused by improper usage or any operation not in accordance with the specifications of this manual. Any modification or tampering with the product in any way voids the warranty.

Troubleshooting

Issue	Possible Cause	Solution
Power dolly does not works.	1. Power shut down.	1. Check the battery status make sure it in full . 2. Check the power switch in power on status. 3. Check the connect cable without loose.
Power dolly stop during working.	1. Batteries in low. 2. Power dolly overloaded.	1. Recharge the power dolly in full. 2. Reduce the loading weight with the capacity and re-start.
Handlebar Assembly Lifts Up When Towing Trailer/RV.	1. Improper hitch ball position. 2. Starting off too quickly.	1. Adjust the hitch ball position toward the handlebar assembly side (closer to the control box). 2. Use a gradual, step-by-step start while applying downward pressure with both hands on the dolly handle. 3. Install the Anti-tip Casters Assembly to limit upward lift.
Drive Wheels Spin in Place.	1. Insufficient weight on the hitch ball reduces traction. 2. Tire pressure too high or too low, affecting contact area with the ground. 3. Slippery or uneven ground surface.	1. Ensure the trailer/RV weight is properly loaded onto the hitch ball (refer to “Adjusting Hitch Ball Height” steps), or add weight at the hitch ball to improve tire traction. 2. Maintain tire pressure at 60 ± 2 psi to ensure adequate ground contact. 3. Operate on dry, level ground surfaces.

Issue	Possible Cause	Solution
Abnormal Battery Charging.	<ol style="list-style-type: none"> 1. Charger indicator light is off. 2. Charger shows a red light while charging, but the battery display indicates full charge. 3. Battery appears fully charged quickly but drains immediately during use. 	<ol style="list-style-type: none"> 1. Check whether the power supply is functioning properly. 2. Turn off the power switch and recharge, the charger should show a green light when the battery is fully charged. 3. Check the battery status (normal voltage range: 9–15 Vdc). If abnormal, replace the battery.
Brake Failure.	<ol style="list-style-type: none"> 1. Loose connection in the 7-pin connector 2. Incorrect setting of the toggle switch(trailer brake controller). 	<ol style="list-style-type: none"> 1. Ensure the 7-pin plug is securely connected to the socket. 2. Open the control box and adjust the toggle switch (trailer brake controller) to the correct position compatible with the RV.

Exploded and Parts List

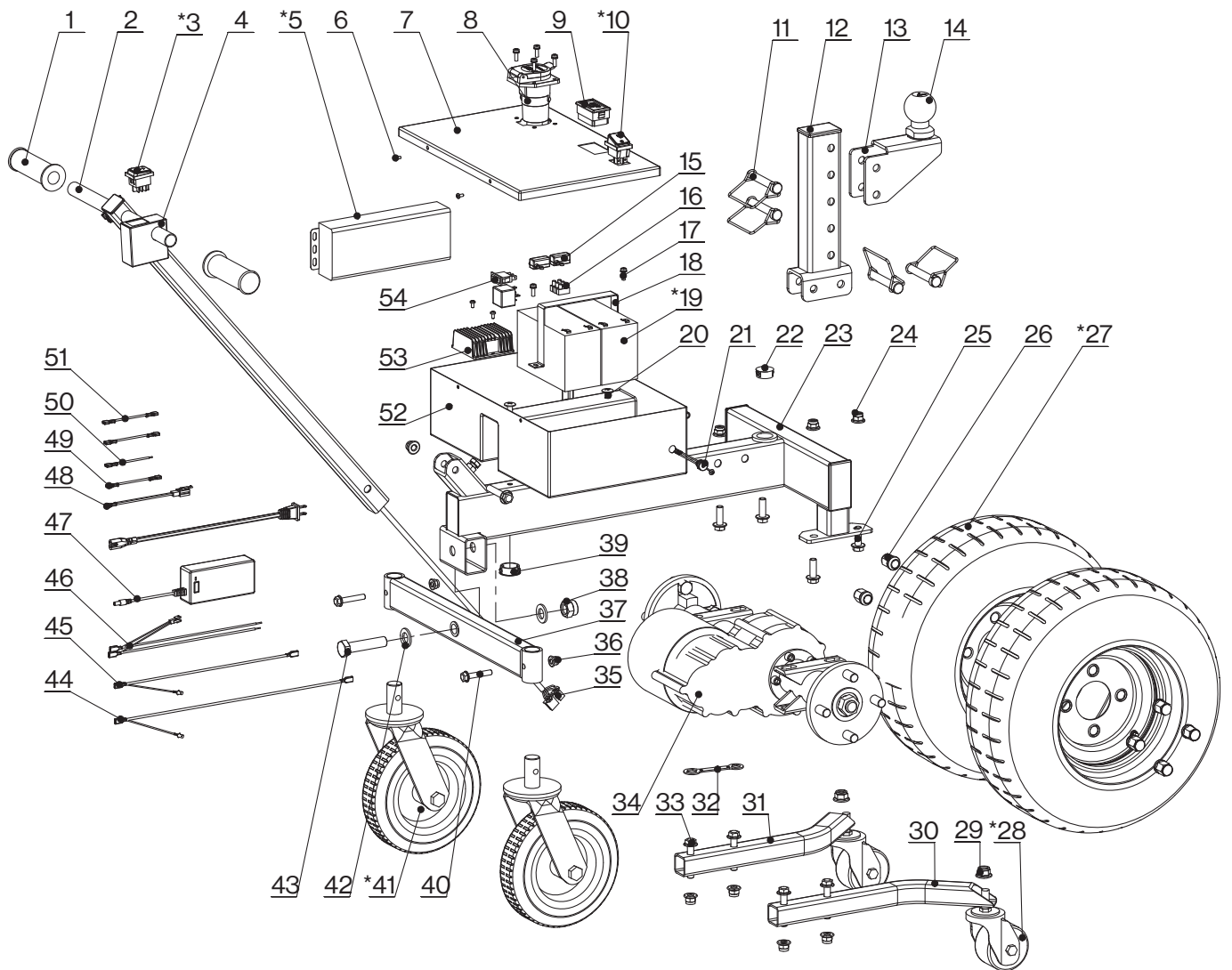

Part No.	Description	Q'ty	Part No.	Description	Q'ty
1	Handle Sleeve	2	*28	Swivel Caster Wheel 3-in	2
2	Handle Bar Assembly	1	29	Nut M12	2
*3	Start Switch	1	30	Left Rear Wheel Bracket	1
4	Switch Box	1	31	Right Rear Wheel Bracket	1
*5	Controller 24V 800W	1	32	Wrench	1
6	Screw M4x8	4	33	Bolt M10x55	5
7	Box Lid	1	34	Rear Axle Motor Assembly 24V 800W	1
8	7-Pin Connector	1	35	Harness 4	1
9	Battery Level Display	1	36	Nut M8	2
*10	Power Switch	1	37	Swinging Wheel Bracket Assembly	1
11	Lock Pin	4	38	Nut M16	1
12	Hitch Height Adjuster	1	39	Domed Plug ϕ 30	1
13	Hitch Ball Mount	1	40	Bolt M8x45	2
14	Hitch Ball	1	*41	Swivel Caster Wheel 8-in	2
15	Terminal	2	42	Washer 16	2
16	Binding Post	1	43	Bolt M16x70	1
17	Screw Assembly M5x16	8	44	Harness 1	1
18	Fixing Bracket	1	45	Harness 5	1
*19	Lead-Acid Battery 12V 9Ah	2	46	Harness 2	1
20	Screw M8x16	2	47	Charger 24V 2A	1
21	Dc Socket	1	48	Harness 6	1
22	Domed Plug ϕ 26	1	49	Harness 3	1
23	Dolly Frame	1	50	Harness 8	1
24	Nut M10	9	51	Harness 7	2
25	Bolt M10x30	4	52	Battery Box	1
26	Nut M14x1.5	8	53	Voltage Converter	1
*27	Drive Wheel 16.5x6.5-8	2	54	Control Switch	1

Note: Parts marked with * are more likely to require replacement due to frequent use or wear.



Thank you for supporting our brand!

superhandyus.com



Great Circle USA
Support Line: 1-866-493-0524
help@superhandyus.com
www.superhandyus.com



Follow us on social media
@SuperHandy