



Get Started!



FlexFeed

Automatic Pet Feeder

What you have:

Important: The food tray, bowl, USB power cable, USB adaptor, and food-saver pouches are packaged inside the food hopper. Remove all items from the food hopper before proceeding with the setup instructions.

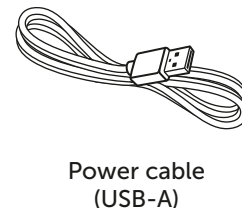
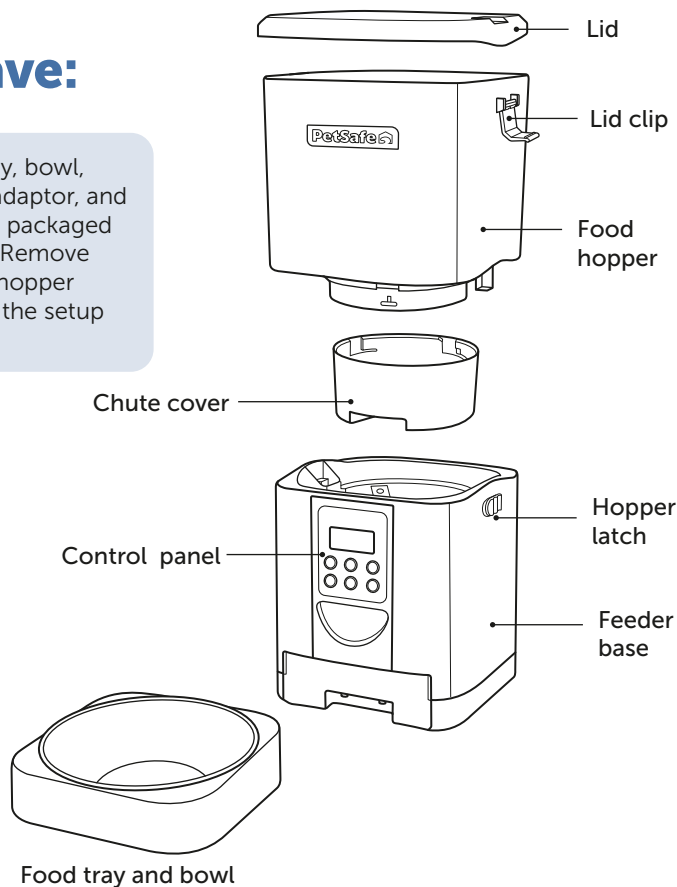

What you need:

- Three D-cell alkaline batteries (optional)

Set up the feeder

1

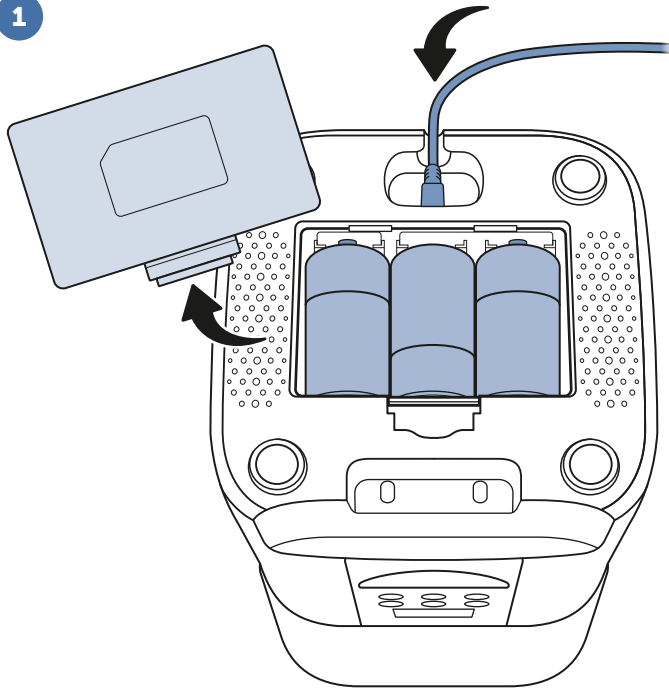

Turn the feeder upside down.

Connect the power cable to the socket on the bottom of the feeder.

Optional: Remove the battery door. Insert 3 D-cell alkaline batteries (not included) as indicated inside the battery compartment. Replace the battery door.

The batteries will power the feeder if there is a power outage or the feeder is unplugged.

2

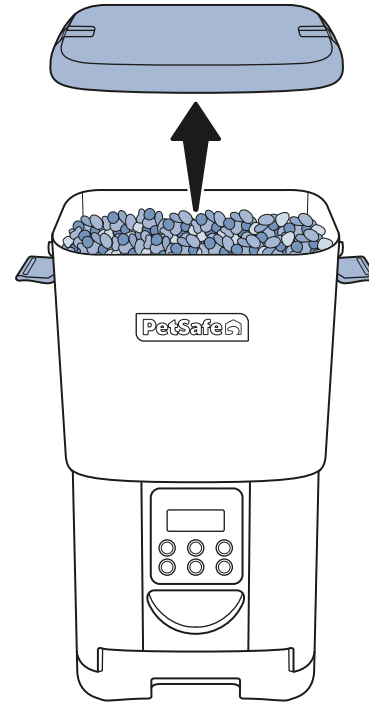

Turn the feeder right side up.

Unclip and remove the food hopper lid. Fill the food hopper with dry kibble up to the max fill line.

Choose dry kibble with a 1/4-inch to 1/2-inch (5 mm to 12 mm) diameter. **Important:** Do not use canned, wet or moist pet food.

3

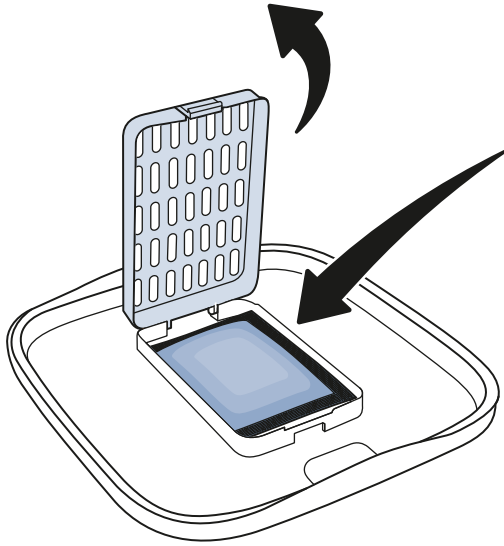

Turn the hopper lid over. Open the compartment on the underside of the lid.

Remove one of the food-saver pouches from its outer packaging and place it in the compartment. Snap the compartment closed.

Place the lid on the food hopper and fasten the clips to hold it in place.

Important: To help keep your pet's food fresher, replace the food-saver pouch every 30 days.

4

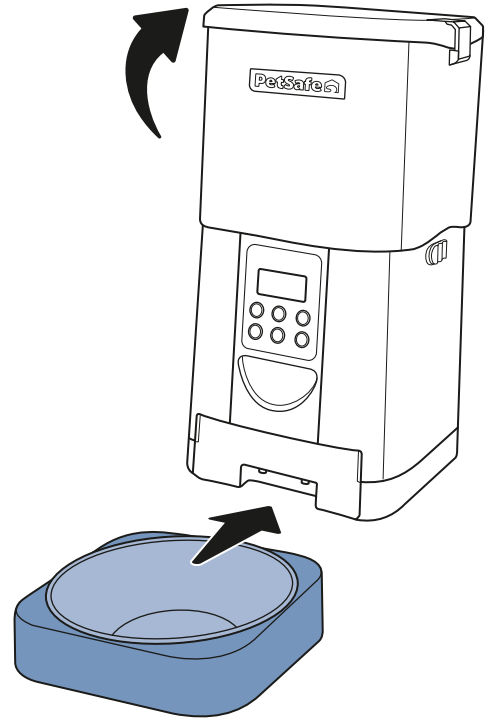

Tilt the feeder backward slightly and slide the food tray into place at its base. Lower the front of the feeder to secure the food tray.

Plug the feeder into an electrical outlet using the provided adaptor.

Set the feeder clock

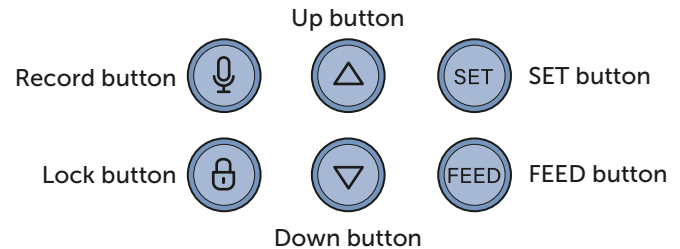
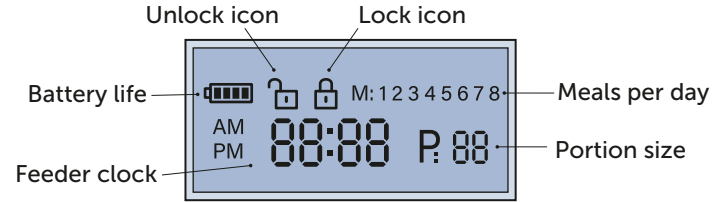

1. Unlock the control panel by pressing and holding the lock button for 3 seconds. The feeder will beep and the control panel will display the unlock icon.
The control panel is locked by default; this is to prevent your pet from pressing buttons to dispense extra food.
2. Press and hold the SET button for 3 seconds (until the hour field begins to flash).
The feeder displays the time in 12-hour clock format.
3. Use the up and down buttons to select the hour (making sure the AM/PM setting is correct).
4. Press the SET button to confirm the hour. The minutes field will begin to flash.
5. Use the up and down buttons to select the minutes.
6. Press the SET button to confirm the minutes.

Program meal times and portions for your pet

1. If the control panel is locked, unlock it by pressing and holding the lock button for 3 seconds.
2. Press the SET button. The meal field (M:) will begin to flash.
3. Use the up and down buttons to set the number of meals per day (1-8), then press the SET button to confirm. The meal field (M:) will display **1** and the hour field will begin to flash, prompting you to select a time for the first meal.
4. Use the up and down buttons to select the hour for the meal time, then press the SET button to confirm. The minutes field will begin to flash.
5. Use the up and down buttons to select the minutes for the meal time, then press the SET button to confirm. The portion field (P:) will begin to flash.
6. Use the up and down buttons to select the desired portion size (1-15).

Each portion is ~1/15 cup (15 mL). See the following table for some common feeding quantities and how they relate to feeder portion settings. (The actual volume of food dispensed will vary slightly depending on the size of kibble being used.)

7. Press the SET button to confirm the portion size. The meal field (M:) will display the number of the next feeding and the hour field will begin to flash.
8. Repeat steps 5 through 10 above to select the time and portion size for each subsequent meal (if applicable).

Important: To reset the feeder clock and erase all programmed meal times, press and hold the up and down buttons simultaneously for 6 seconds.

Approximate volume of food (cups)	Portion setting
1/8 cup	2
1/4 cup	4
1/3 cup	5
1/2 cup	8
2/3 cup	11
3/4 cup	12
1 cup	15

Prime the feeder

To ensure your pet is fed the correct amount of food, prime the feeder before the first programmed meal time:

1. If the control panel is locked, unlock it by pressing and holding the lock button for 3 seconds.
2. Press the FEED button. The feeder will dispense one portion of food. At first, just a few pieces of kibble may be dispensed.
3. Press the FEED button several more times, stopping when the feeder is dispensing an equal portion of kibble each time.

Record a message for your pet

If desired, you can record a word or phrase to call your pet to the feeder each time food is dispensed.

1. If the control panel is locked, unlock it by pressing and holding the lock button for 3 seconds.
2. Press and hold the record button . The feeder will beep once.

3. Still holding the record button, record your desired meal call (up to 10 seconds duration).
4. Release the record button. The feeder will beep twice to indicate the recording is saved, and then will play the recording back for you.
5. If you are satisfied with the recording, no further action is required. To try again, repeat steps 2 through 4 above.
6. To cancel a previously recorded message, repeat steps 1 and 2 above, then release the record button without recording a message.

Manually feed your pet

To feed your pet a portion of food outside of the programmed meal schedule:

1. If the control panel is locked, unlock it by pressing and holding the lock button for 3 seconds.
2. Press the FEED button. The feeder will dispense one portion of food.
3. Repeat the above step until the feeder has dispensed the desired amount of food.

Clean the feeder

When it's time to clean the feeder:

1. Unplug the feeder.
2. Slide the two hopper latches toward the front of the feeder.
3. Remove the food hopper from the feeder base.
4. Unclip and remove the hopper lid.
5. Empty any kibble from the food hopper.
6. Open the compartment on the underside of the hopper lid and remove the food-saver pouch.

Important: Each food-saver pouch lasts up to 30 days; we recommend replacing this pouch each time you clean the feeder.

7. Turn the food hopper upside down.
 8. Grip the chute cover on the bottom of the food hopper and turn it counterclockwise to unlock it.
 9. Remove the chute cover.
 10. Disconnect the food tray and bowl from the front of the feeder.
 11. Wash the stainless-steel bowl by hand or in your dishwasher.
 12. Hand-wash the lid, food hopper, chute cover and food tray in warm soapy water.
 13. Wipe the feeder base with a non-abrasive cloth.
- Important:** The feeder base contains electronic components and is not waterproof. Do not rinse the feeder base, submerge it in water, or spray it with cleaning solutions.
14. Allow all components to dry thoroughly before reassembling the feeder.

Resolve feeder errors

If the feeder has an error while running, the control panel will display an error code. See the table below for error codes and solutions:

Error code	Solution
E001	A mechanical failure has occurred. Please call our Customer Care team for assistance.
E002	The feeder is jammed. Remove the chute cover from the food hopper and clear any jammed food.
E004	Excess food in the bowl is blocking the chute.
E005	Feeder batteries are low. Replace the batteries or plug the feeder into a working power outlet.

FlexFeed

Automatic Pet Feeder



We're here to help!

For questions or additional tips:
support.petsafe.com