

CAUTION

THE SAFETY GUARD IS EXTREMELY LOUD. FOR YOUR SAFETY, NEVER PLACE THE UNIT CLOSE TO YOUR EARS. TO TEST ALARM, DIRECT THE UNIT AWAY FROM YOU AT ARM'S LENGTH AND ACTIVATE.

Customer Service :

Website : www.techkokogroup.com

Email: support@techkogroup.com

Mfg. By **Techko Kobot**

This product has a 1-year limited warranty. For further information please visit our website.

Patent No. 7,187,280

NOTICE

THIS PRODUCT IS PROTECTED UNDER FEDERAL TRADEMARK AND COPYRIGHT LAWS PREVENTING UNFAIR COMPETITION. NO DUPLICATION OR SIMULATION OF THIS PRODUCT IS PERMITTED EXCEPT BY WRITTEN AUTHORIZATION OF TECHKO, INC.

TECHKO AND THE CONFIGURATION OF THIS PRODUCT ARE TRADEMARKS OF TECHKO, INC.

COPYRIGHT 1992 TECHKO, INC.

ALL RIGHTS RESERVED

MADE IN CHINA

6-072-040100

110801

TECHKO®

SAFETY GUARD

Model: S284

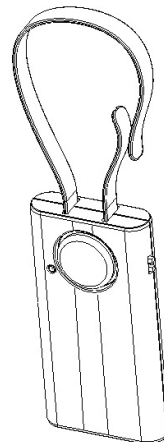

OPERATION MANUAL

INTRODUCTION

Congratulations on your purchase of the TECHKO Safety Guard S284 Vibration Activated Alarm/Chime. The Safety Guard provides protection of unauthorized entry by detecting vibration when opening a door or moving other objects that the unit is attached to. The S284 can also provide a chime function when the protected object is moved.

OPERATION

This unit has three modes- CHIME/OFF/ALARM. When the batteries are loaded, the LED light on the front of the unit flash once and a single beep will sound. This indicates the unit is Functioning and ready for operation.

When turning the switch from off to the CHIME/ALARM mode, or loading the batteries, there will be an 8-12 second alarm delay while the red LED light flashes.

In CHIME mode, there will be a chime that sounds 3 times, then resets itself to resume protection. In ALARM mode, the 6-tone alarm will sound for 60 seconds. It

will reset itself to resume protection.

- ◆ Hang the unit over doorknob (Fig. 1).

Fig. 1

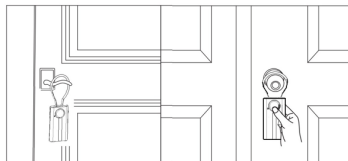

Alternatively, can be hung onto bag / luggage, or anywhere it can be hung to provide valuable protection (Fig. 2).

Fig. 2

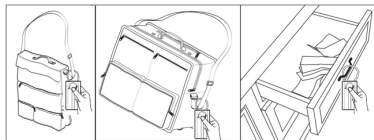

For bags or other items, unfasten the Velcro and fasten around the handle/strap (Fig. 3).

Fig. 3

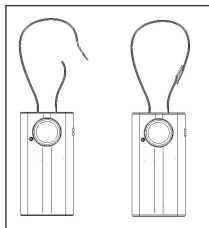

MAINTENANCE

When the red LED light on the front of the unit remains on, it indicates “Low Battery”. Please replace with (3) new 1.5V AAA batteries. Remove the backplate of the unit and install the batteries.

IMPORTANT

Your S284 Safety Guard can provide valuable protection for your home and property. However, this unit cannot guarantee complete protection against burglary or robbery. TECHKO KOBOT will not be held liable for any loss or damages. Upon first use, make sure to test your S284 unit to ensure it meets your application needs.

PLEASE KEEP THIS OPERATION MANUAL IN A CONVENIENT PLACE FOR FUTURE REFERENCE.