

Warning:

- 1.The Ride-On car is designed for children aged 12 + months. The rider's weight must not exceed 25kgs.
- 2.The product is designed to only seat 1 child at a time to avoid injuries.
- 3.Parental guidance and supervision are strongly advised to ensure safe riding.
- 4.Adult assembly and thorough installation of all components are essential for safety.
- 5.Avoid going near streets, crossroads, traffic areas, swimming pools and stairs when riding the car.
- 6.To Reduce risk occasionally check to see that the nut and bolt on the steering wheel are tight and secure.
- 7.Dangers may occur if the product is not correctly assembled.
- 8.Ensure shoes are worn before using the ride-on.

Battery Handling:

- 1.Battery must be handled by adults only.
- 2.Always replace exhausted batteries.
- 3.Use 2 xAA size batteries (not included) to make the lights and sound work.
- 4.Alkaline batteries are recommended.
- 5.Always remove batteries when the unit is not going to be used for an extended period of time.
- 6.When replacing new batteries, always replace all batteries.
- 7.Do not mix old and new batteries.
- 8.Do not mix Alkaline, Standard (Carbon-Zinc), or Rechargeable (Nickel-Cadmium) batteries.
- 9.Do not dispose of batteries in fire, as they may explode or leak.
- 10.Non-rechargeable batteries should never be recharged.
- 11.Remove rechargeable batteries from the toy before charging.
- 12.Rechargeable batteries should be charged only under adult supervision.
- 13.Batteries are to be inserted with the correct polarity.
- 14.Do not short-circuit the supply terminals.

REALTREE™

Activity Ride-On

Instructions Manual
Item No.:551



ASSEMBLY INSTRUCTIONS

COMPONENTS LIST

1.Car body x1		2.Handle x1	
3.Backrest x1		4.Wheel x4	
5.Wheel cap x4		6.Anti-tumble shelf x1	
7.Plastic ring x4		8.Cotter Pin x2	
9.Axle x2		10.Washer x4	
11.Bolt x1		12.Nut x1	
13.Screw x2			

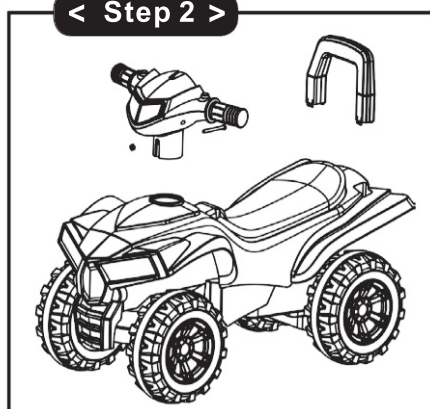
< Step 2 >**HANDLE ASSEMBLY**

- Position the handle in the designated area.
- Insert the bolt into the corresponding hole and tighten it using a screwdriver.

TODDLER BAR ASSEMBLY

- Align the toddler bar with the holes located at the rear of the product.
- Whilst holding the front of the vehicle down, firmly push the toddler bar into the holes until it fits. Ensure that the toddler bar is securely and properly fitted.

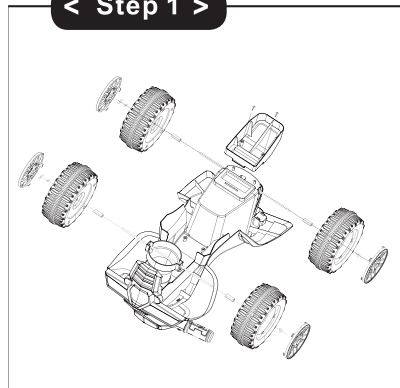
< Step 1 >**WHEEL ASSEMBLY**

- Insert the axle- Slide the axle through the plastic rings into the main body of the car. Tighten the axle using a cotter pin.
- Place and secure all four wheel caps onto the wheels.

ANTI-TUMBLE SHELF ASSEMBLY

- Insert the anti-tumble shelf into the rear section of the body.
- Use a screwdriver to assemble the two screws, ensuring the anti-tumble shelf is firmly attached.

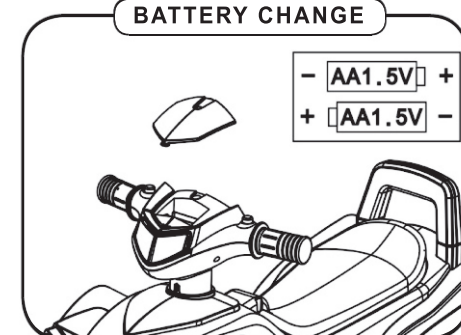
BATTERY CHANGE**How to change the battery:**

- Loosen the screw with a screwdriver.
- Keep the screw in a safe place away from children's reach.
- Put 2AA batteries in the battery house.
- Press the buttons on the handle to check the batteries are functioning and to make sure the revving engine, the horn and the blinking lights are properly activated.