

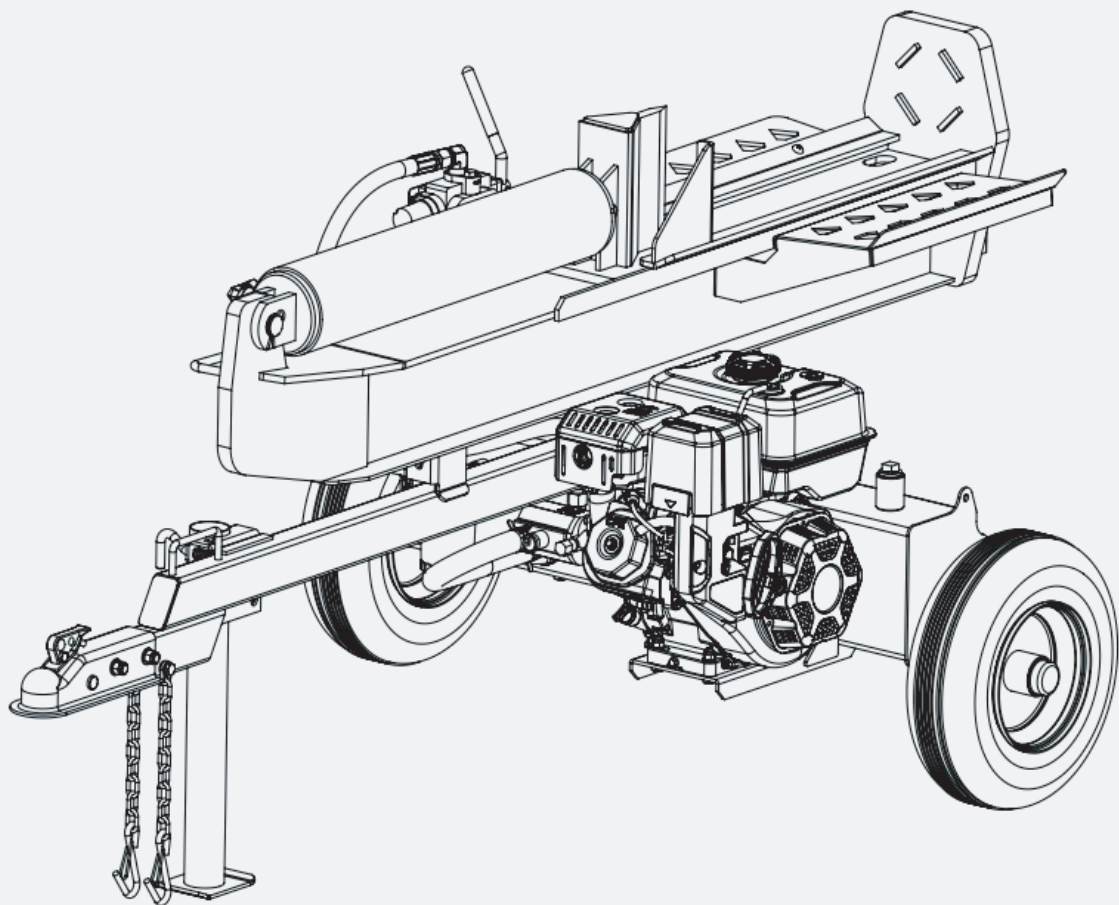

37 Ton Gas-powered Log Splitter | GUT200 Operator's Manual



Warning: Please read and thoroughly understand all instructions before operating. Failure to follow safety rules and other basic safety precautions may result in serious personal injury. Keep these instructions in a safe and easily accessible place so that they can be referred to when needed. Retain these instructions to assist in future servicing.

INDEX

Warning and Safety	3-4
General Operating Safety	4
Product Specific Safety	4
Engine Specific Safety	5-6
Technical Specifications	7
Main Components	8
Unpacking Instructions	9
Assembly	10-14
Operation	15-18
Maintenance and Storage	19
Warranty	20
Troubleshooting	20-21
Exploded and Parts List	22-23

Warning and Safety

These symbols are used to draw your attention to important safety instructions. They are meant to alert you to warnings, potential hazards, and best practices when operating this equipment. Make sure to read and follow all safety guidance in this manual to help prevent injury or damage. Anyone using this machine should read the entire manual before operating. Keep this manual for future reference.

Do not allow children to operate this log splitter. Keep small children away while the machine is in use. Do not allow anyone to operate the machine without proper instruction.

Warning Symbols and Definitions

DANGER

DANGER INDICATES A SERIOUS INJURY OR FATALITY WILL RESULT IF THE SAFETY INSTRUCTIONS THAT FOLLOW THIS SIGNAL WORD ARE NOT OBEYED.

WARNING

WARNING INDICATES A HAZARD WHICH, IF NOT AVOIDED, COULD RESULT IN DEATH OR SERIOUS INJURY AND/OR PROPERTY DAMAGE.

CAUTION

CAUTION INDICATES YOU CAN OR YOUR EQUIPMENT CAN BE HURT IF THE SAFETY INSTRUCTIONS THAT FOLLOW THIS SIGNAL WORD ARE NOT OBEYED.

IMPORTANT

IMPORTANT INDICATES HELPFUL INFORMATION FOR PROPER ASSEMBLY, OPERATION, OR MAINTENANCE OF YOUR EQUIPMENT.

Intended Use

Foreseeable Misuse

This hydraulic log splitter has a heavy-duty steel construction and 37 tons of ram force. When there's work to be done, you need outdoor power equipment you can rely on, this log splitter will get the job done fast. It is designed to work in both horizontal and vertical positions. It is easy to tow, easy to use and maintain. Never exceed the rated capacity of 37 tons when operating the log splitter.

WARNING

1. You must read, understand and comply with all safety and operating instructions in this manual before attempting to setup and operate your log splitter.
2. Failure to comply with all safety and operating instructions can result in loss of machine control, serious personal injury to you and/or bystanders, and risk of equipment and property damage. The triangle in the text signifies important cautions or warnings which must be followed.

WARNING

1. Engine exhaust, wood dust, and gasoline vapors from this product contains chemicals known to the state of california.
2. To cause cancer, birth defects, or other reproductive harm.

General Operating Safety

1. **Read, understand, and follow all instructions in the manual and on the unit before starting**
2. Operators must read and understand all safety and warning information, operating instructions, maintenance, and storage instructions before operating this equipment. Failure to properly operate and maintain the log splitter could result in serious injury to the operator or bystanders.

Product Specific Safety

WARNING

- Do not carry passengers, sit, or stand on the log splitter at any time.
- Do not allow children to play on, stand upon, or climb on the log splitter.
- Always inspect the log splitter before using it to ensure it is in good working condition.
- Replace or repair damaged or worn parts immediately.
- Always check and tighten hardware and assemble parts before operation.
- Do not exceed the equipments maximum load capacity of 37 tons.
- Avoid large holes and ditches when towing the equipment.
- Always operate the log splitter on clear and level ground.
- Do not operate the log splitter at night, only during daylight hours.
- Always slow down when towing over rough terrain, streams, ditches, and hillsides.
- To avoid personal injury and/or equipment damage **(DO NOT EXCEED 45 MPH.)**
- Always refer to the vehicle owner's manual for proper towing.
- Always secure and lock the log splitter to the vehicle hitch before towing.

Crush and Cut Hazards

- Always keep hands and feet clear from moving parts while operating the equipment.
- Always clear and the keep work area clean and free of debris when operating.
- Always wear safety gear, eye protection, gloves, and work boots when operating the log splitter.

WARNING

The warnings, cautions, and instructions outlined in this instruction manual cannot cover all possible conditions or situations that may occur. It must be understood by the operator that common sense and caution are factors that cannot be built into this product and must be supplied by the operator.

PROP 65 WARNING

This product can expose you to chemicals including lead and lead compounds which are known to the State of California to cause cancer and birth defects or other reproductive harm. For more information, go to www.p65warnings.ca.gov.

Engine Specific Safety

Before cleaning, repairing, or inspecting, shut off the engine and make certain that all moving parts have come to a complete stop. Disconnect the spark plug wire and secure the wire away from the spark plug to prevent accidental starting.

DANGER

- 1. ENGINES GIVE OFF CARBON MONOXIDE, AN ODORLESS, COLORLESS, POISON GAS. CARBON MONOXIDE MAY BE PRESENT EVEN IF YOU DO NOT SMELL OR SEE ANY ENGINE EXHAUST. BREATHING CARBON MONOXIDE CAN CAUSE NAUSEA, FAINTING OR DEATH, IN ADDITION TO DROWSINESS, DIZZINESS AND CONFUSION. IF YOU EXPERIENCE ANY OF THESE SYMPTOMS, SEEK FRESH AIR AND MEDICAL ATTENTION IMMEDIATELY.**
- 2. IF YOUR MACHINE COMES WITH A SEPARATE ENGINE MANUAL, BE SURE TO READ AND FOLLOW ALL SAFETY AND WARNING PRECAUTIONS OUTLINED THERE, IN ADDITION TO ANY IN THIS MANUAL.**

Fuel Safety

Fuel is highly flammable—always handle it with care and keep it away from sparks, flames, and hot surfaces.

- Only use an approved fuel container.
- Never add fuel to a running engine or one that's still hot.
- Always refuel outdoors in a well-ventilated area. Never fill the tank indoors or in enclosed spaces.
- Wipe up any spilled fuel before starting the engine, and make sure the fuel cap is securely tightened.

Preventing Carbon Monoxide Poisoning

- Always start and run engine outdoors. Do not start or run the engine in an enclosed area, even if doors or windows are open.
- Never try to ventilate engine exhaust indoors. Carbon monoxide can reach dangerous levels very quickly.
- Never run engine outdoors where exhaust fumes may be pulled into a building.
- Never run engine outdoors in a poorly ventilated area where the exhaust fumes may be trapped and not easily taken away. (Examples include: in a large hole or areas where hills surround your working area.)
- Never run engine in an enclosed or partially enclosed area. (Examples include: buildings that are enclosed on one or more sides, under tents, car ports or basements.)
- Always run the engine with the exhaust and muffler pointed in the direction away from the operator.
- Never point the exhaust muffler towards anyone. People should always be many feet away from the operation of the engine and its attachments.
- Do not modify the engine governor or run the engine at speeds higher than its intended setting.
- Do not operate the engine in a confined space where dangerous carbon monoxide fumes can collect.

Gasoline Fire Risk & Prevention

Use extra care in handling gasoline and other fuels. They are flammable and vapors are explosive.

- When storing extra fuel be sure that it is in an appropriate container and away from any fire hazards.
- Prevent fire and explosion caused by static electric discharge. Use only nonmetal, portable fuel containers approved by the Underwriter's Laboratory (U.L.) or the American Society for Testing & Materials.

3. Always fill fuel tank outside in a well ventilated area. Never fill your fuel tank with fuel indoors. (Examples include: basement, garage, barn, shed, house, porch, etc.) Never fill tank near appliances with pilot lights, heaters, or other ignition sources. If the fuel has to be drained, this should be done outdoors. The drained fuel should be stored in a container specifically designed for fuel storage or it should be disposed of carefully.
4. Never remove the fuel cap or add fuel with the engine running. Stop engine and allow to cool before filling.
5. Do not smoke while refueling or operating engine.
6. Never drain fuel from the engine in an enclosed area.
7. Always wipe up excess (spilled) fuel from engine before starting. Clean up spilled fuel immediately. If fuel is spilled, do not start the engine but move machine and fuel container from area. Clean up spilled fuel and allow to evaporate and dry after wiping and before starting.
8. Allow fuel fumes/vapors to escape from the area before starting engine.
9. Test the fuel cap for proper installation before starting and using engine.
10. Always run the engine with fuel cap properly installed on the engine.
11. During storage, keep machine so gas cap is up.
12. Never siphon fuel by mouth to drain fuel tank.
13. Always have an adult fill the fuel tank and never allow children to fill the engine.
14. Never allow an adult or anyone under the influence of drugs or alcohol to fill engine.
15. When storing gasoline or equipment with fuel in the tank, store away from furnaces, stoves, water heaters or other appliances that have a pilot light or other ignition source because they can ignite gasoline vapors.
16. Never fill containers inside a vehicle or on a truck bed with a plastic bed liner. Always place containers on the ground away from your vehicle before filling.
17. Remove gas-powered equipment from the truck or trailer and refuel it on the ground. If this is not possible, then refuel such equipment on a trailer with a portable container, rather than from a gasoline dispenser nozzle.

Burns and Fires

The muffler, muffler guard and other parts of the engine become extremely hot during the operation of the engine. These parts remain extremely hot after the engine has stopped.

Prevention of Burns and Fires

1. Never remove the muffler guard from the engine.
2. Never touch the muffler guard because it is extremely hot and will cause severe burns.
3. Never touch parts of the engine that become hot after operation.
4. Always keep materials and debris away from muffler guard and other hot parts of the engine to avoid fires.

Children and Bystanders

Tragic accidents can occur if the operator is not alert to the presence of children and/or bystanders. Never assume that others will remain where you last saw them.

1. Keep the area of operation clear of all persons, especially small children and pets. Keep children under the watchful care of a responsible adult.
2. Be alert and turn the machine off if children enter the area.
3. Before and while moving backwards, look behind and down for small children.
4. Never allow children to operate the machine.

Technical Specifications

SKU#	GUT200
Maximum Exerted Splitting Force	37 Ton
Manual Start Engine	389 cc
Cycle Time	16 Sec
Wedge Size	8"Harden Steel
Gear Pump	2-Stage
Hydraulic Oil	AW32, AW46 & Universal Hydraulic Oil
Hydraulic Fluid Tank Capacity	6 Gallon
Max. Log Length	24"
Max. Log Diameter	Horizontal 16"/ Vertical 24"
Hydraulic Cylinder	5" x 23"
Max. Pressure	3600 PSI
Max. Flow	14 GPM
Wheel Size	4.8-8 wheel with 16" outside diameter D.O.T tires
Hitch Type	2" Ball Coupler
Max. Towing Speed	45 MPH

Main Components

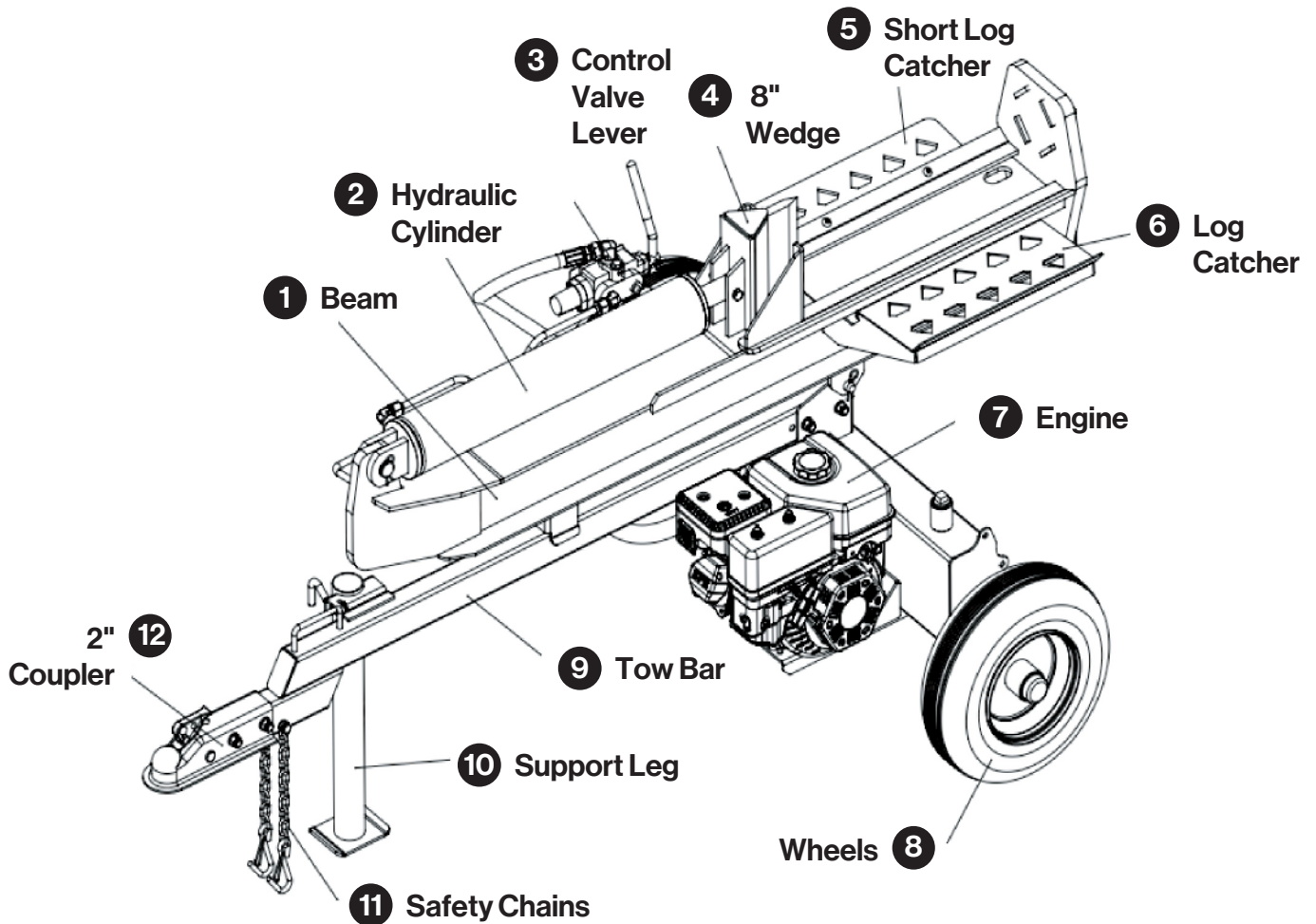

WARNING

Read and follow all instructions for assembly and operation. Failure to properly assemble this equipment could result in serious injury to the user or bystanders, or cause equipment damage.



Engine Shipped Without Oil.

Before starting the engine, fill it with SAE 10W-30 motor oil. See the engine manual for engine oil capacity.

Hydraulic Reservoir is Shipped Without Oil.

When adding oil verify the oil level reads 1 from the top of the hydraulic reservoir if marking is not shown fill to the neck.

Inspect all Log Splitter Components.

If you have damaged components: Contact the freight company that delivered the log splitter and file a claim.

Unpacking Instructions

Remove the wooden plate in the top. At least two people hold up the package and move it from the top.

Packing List

Part	Part Qty.	hardware needed	hardware Qty.	Tool needed
Wheels	2	Castle Nut	2	1x30mm open-end wrench
		Cotter Pin Ø4 x 32	2	Needle nose pliers
		Axle Cap	2	Mallet
Tow Bar	1	Bolt M12x80、 Lock Nut M12、 Flat Washer Ø12	2	1x18mm or 19mm wrench
Beam	1	Hitch Pin	1	
		R-Pin	1	
Engine	1	Bolt M10x40、 Lock Nut M10、 Flat Washer Ø10	4	1x16mm or 17mm wrench
Suction Hose	1	Spring Loaded Hose Clamp	2	Clamp Tool
High Pressure Hose	1	"O" Ring Ø10x 2.65	1	1x27mm open-end wrench
Oil Return Hose	1			1x27mm open-end wrench
Short Log Catcher	1	Bolt M10x30、 Nut M10、 Lock Washer Ø10、 Flat Washer Ø10	2	1x6mm allen wrench、 1x17mm wrench
Log Catchers	2	Bolt M10x20、 Lock Washer Ø10、 Flat Washer Ø10	4	1x16mm wrench or socket

Assembly

Tools Required

- Rubber or Wooden Hammer
- Wrenches
- Large Adjustable Wrench
- Phillips or Standard Screwdriver
- Pliers

Notice

Set the shipping crate on a solid flat surface and carefully remove the lid. Use two people and take all parts out of the shipping crate and inspect the components to ensure there are no missing pieces before starting to assemble the log splitter follow steps 1 through 6.

Step 1: Install the Base Tube

Parts: Base Tube

1. Remove the two sets of bolts M12 x 80, washers Ø12, and lock nuts M12 from the oil tank, and set them aside.
2. Raise the oil tank using wooden blocks approximately 8.8" high, ensuring that the axle center is at a similar height to the radius of the wheels. Insert one end of the base tube into the connection base of the oil tank, then secure it using the two sets of bolts M12x 80, flat washers Ø12, and lock nuts M12. Tighten securely.
3. Rotate the front support leg to a vertical position and lock it in place using the lock pin. Ensure that the base tube is approximately level with the ground. **(Fig01)**

Fig.01

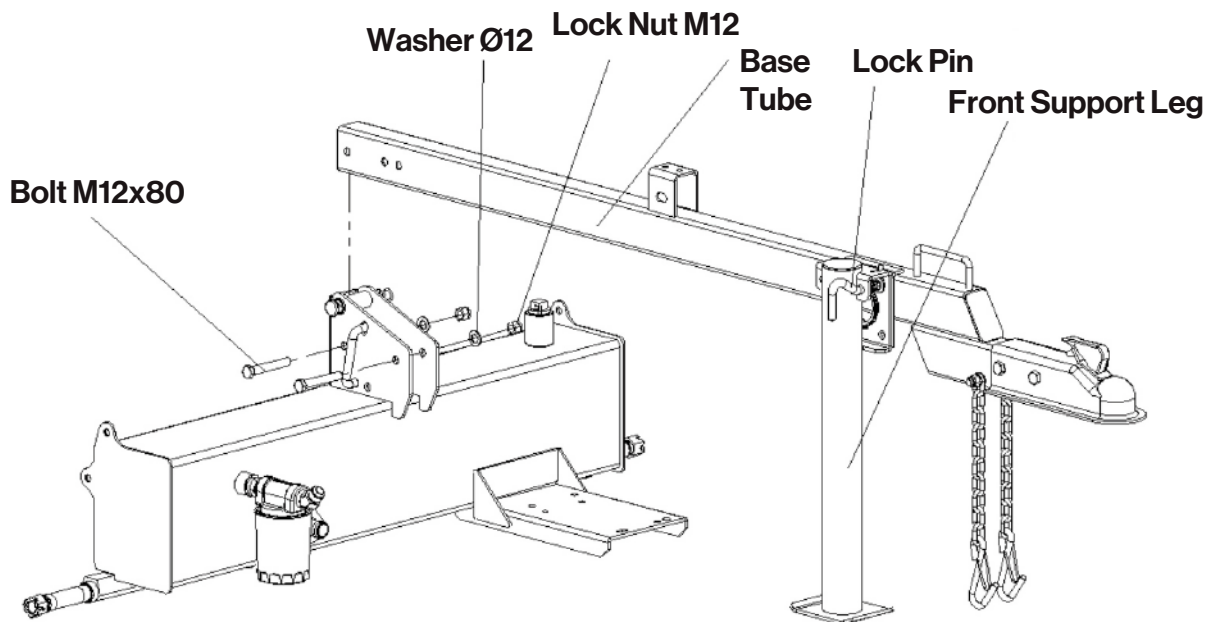

Step 2: Install the Wheels

Parts: Wheel (x2)

Hardware: Axle Caps (x2)

1. Remove the cotter pin from the axle of the oil tank, and unscrew the slotted nut M20x1.5. Set them aside.
2. Mount the wheels onto the left and right axles, ensuring that the tire valves face outward. Screw the slotted nut M20x1.5 onto both axles. Tighten the nuts to ensure the wheels rotate smoothly without lateral wobbling. Insert the cotter pin into the axle and bend it to secure.
3. Attach the axle caps onto both wheels. **(Fig02)**

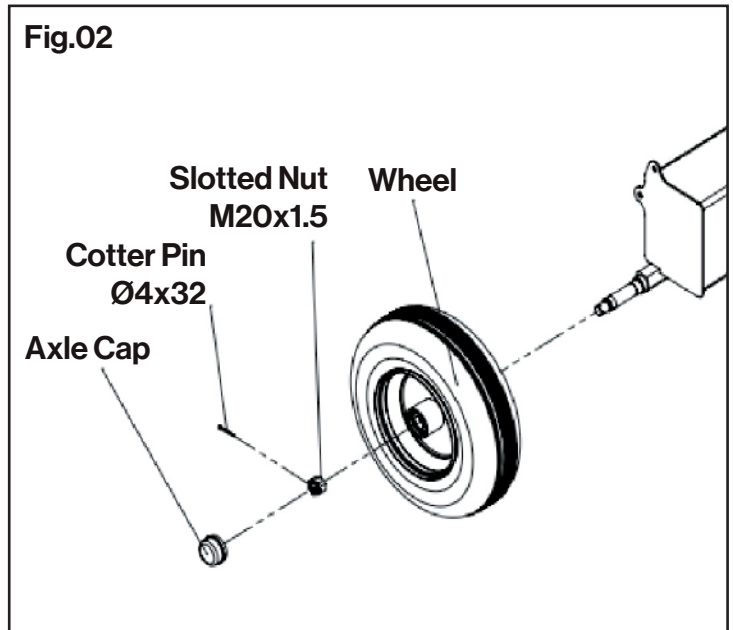

Step 3: Install the Beam

Parts: Beam

Stand the beam upright, paying attention to the protective coating at the base. Align the holes near the oil tank connection base as shown, insert the pin, and secure it with the R-pin. **(Fig03)**

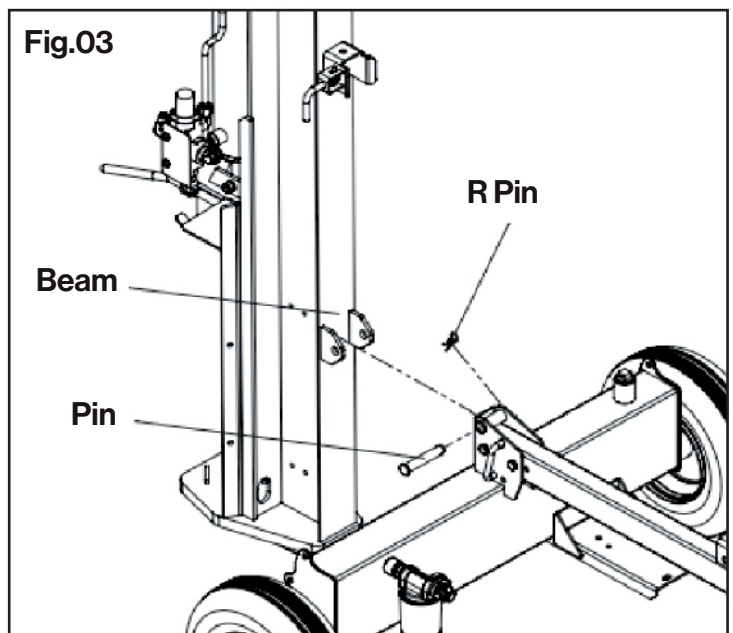

Step 4: Install the Engine Assembly

Parts: Engine Assembly

Hardware: Bolts M10 x 40(x4), Washers Ø10(x4), Nuts M10(x4)

1. Adjust the beam to a horizontal position. Check whether the lock pin automatically aligns and inserts smoothly into the corresponding hole on the base tube. Ensure smooth operation of the lock pin.
2. Place the engine and gear pump assembly onto the engine mounting plate of the oil tank as shown. Secure it with four sets of bolts M10 x 40, washers Ø10, and lock nuts M10. **(Fig.04)**

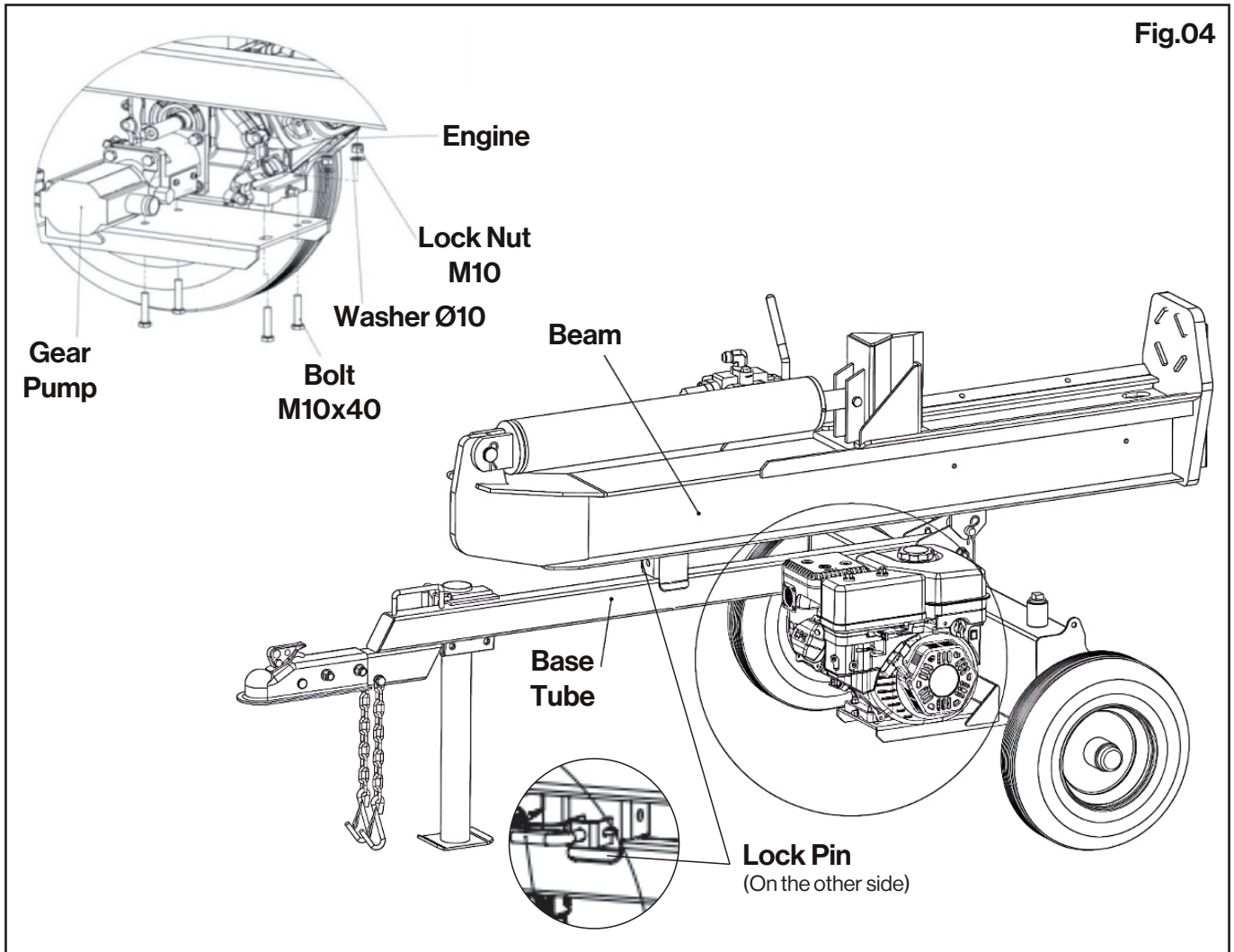

Step 5: Install the Hose Assembly

Parts: Oil Pipe, Hydraulic Hose, Hydraulic Hose Assembly

Hardware: O-ring 10x2.65 (x1), Clamps (x2)

1. Attach clamps 30 to both ends of the oil pipe. Insert one end of the oil pipe fully into the suction port of the gear pump and the other end into the port of the internal oil filter on the oil tank. Secure the clamps into the circular groove on both interfaces.
2. Place the O-ring 10x2.65 into the groove of the pump outlet connector. Screw the nut of the hydraulic hose assembly A-end into the pump outlet connector A-end, and tighten with a torque of 50 - 60 N. m.
3. Screw the B-end nut of the 74° return hydraulic hose into the B-end of the 135° JIC connector, and tighten with a torque of 70 - 80 N. m. **(Fig.06)**

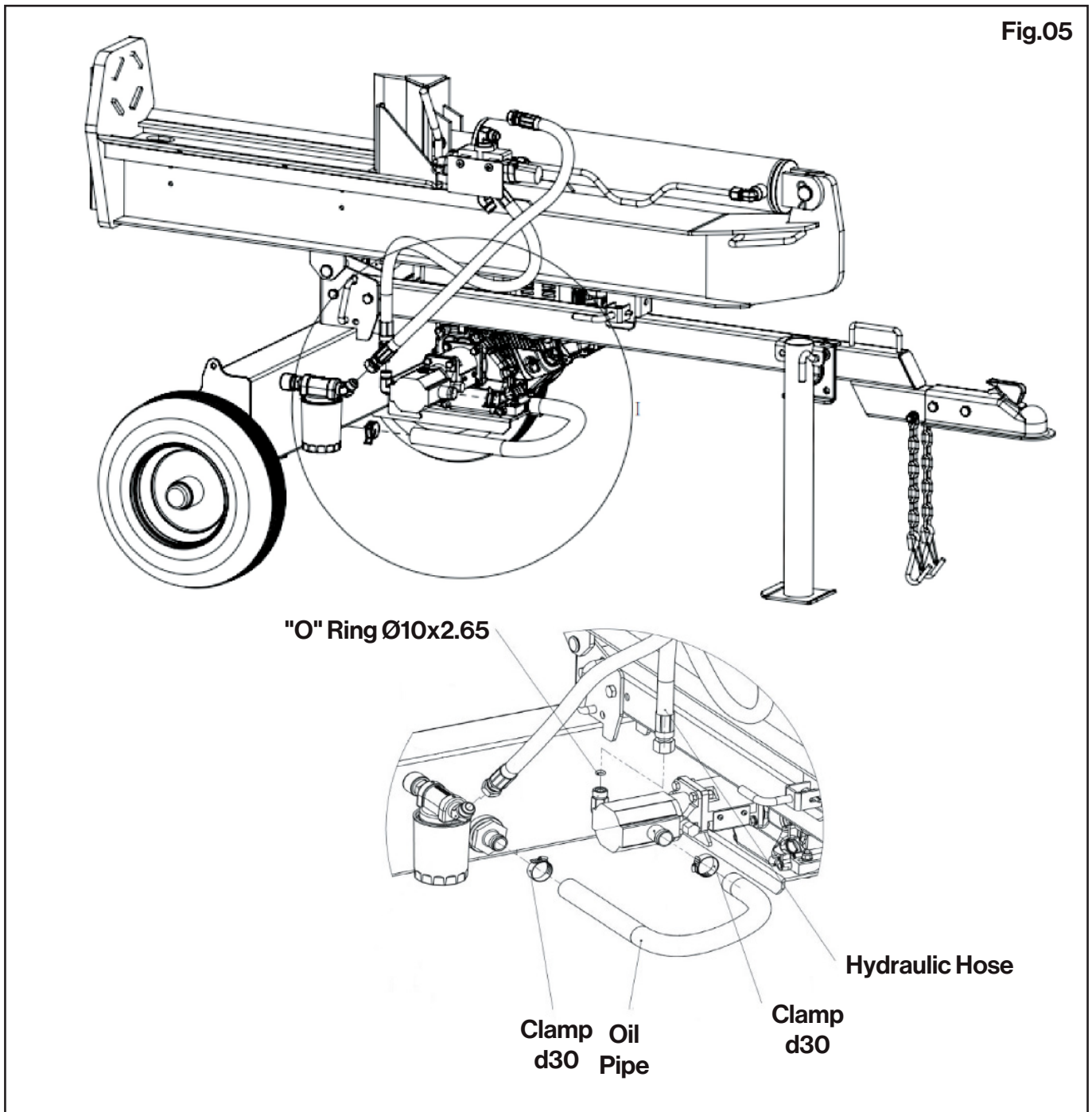

Step 6: Install the Log Catcher

Parts: Log Catcher Bracket, Short Log Catcher

Hardware: Bolts M10x 20 (x4), Washers Ø10 (x6), Washers Ø10 (x6), Bolt M10x 30 (x2)

1. Use four sets of bolts M10x 20, lock washers Ø10, and washers Ø10 to secure the log catcher bracket to the right side of the beam.
2. Use two sets of bolt M10x 30, lock washers Ø10, washers Ø10, and nuts M10 to secure the short log catcher to the left side of the beam as shown. After tightening, ensure the short log catcher is level with the ground. **(Fig.06)**

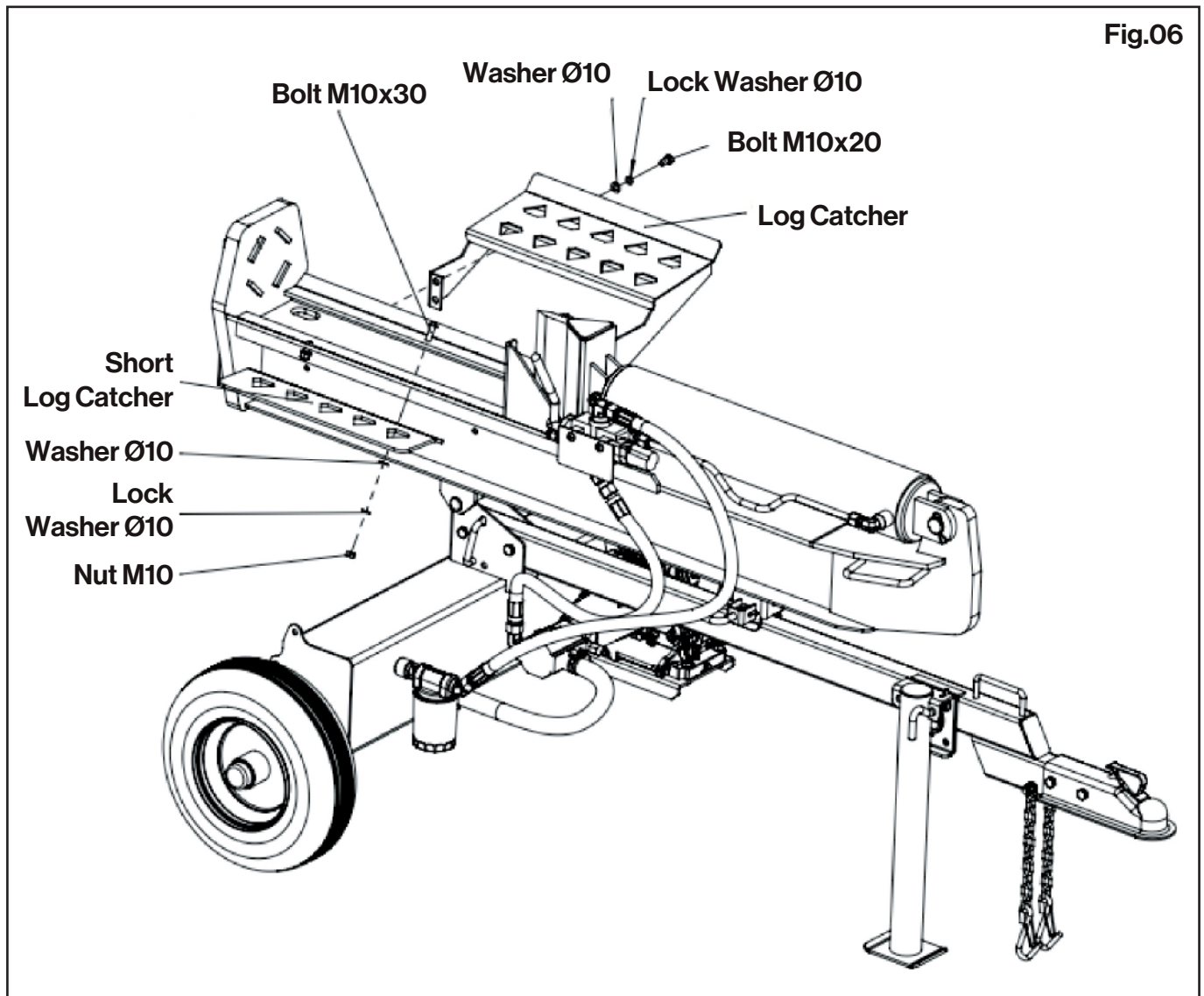

Operation

DANGER

- 1. THE EXHAUST FROM THIS PRODUCT CONTAINS CARBON MONOXIDE GAS. CARBON MONOXIDE IS A COLORLESS, ORDERLESS AND TASTELESS GAS THAT CAN CAUSE DIZZINESS, NAUSEA, UNCONSCIOUSNESS OR EVEN BRAIN DAMAGE AND DEATH IF INHALED FOR PROLONGED PERIODS.**
- 2. OPERATE THE UNIT OUTDOORS IN A WELL VENTILATED LOCATION ONLY. KEEP CHILDREN, PETS AND BYSTANDERS AWAY.**
- 3. FAILURE TO FOLLOW THESE INSTRUCTIONS MAY RESULT IN SERIOUS INJURY OR DEATH.**

Add Engine Oil

1. Make sure the log splitter is on a level surface.
2. Remove the oil fill cap/dipstick to add oil.
3. Refer to the separate owner's engine manual for the amount needed for SAE10W-30 engine oil; replace oil fill cap/dipstick.
4. Check engine oil level daily and add as needed.

NOTE: During the break-in period check the engine oil level often.

CAUTION

DO NOT attempt to crank or start the engine before it has been properly filled with the recommended type and amount of oil. Damage to the log splitter as a result of failure to follow these instructions will void your warranty.

Add Hydraulic Oil

1. The log splitter needs to be cold on a flat-level surface before adding the hydraulic oil.
2. Remove the oil cap from the hydraulic reservoir.
3. Add approximately 6 gallons of hydraulic oil, AW32, AW46 & universal hydraulic oil are all acceptable types of fluid. Automatic transmission fluid should be used when operating in temperatures below 90°F /32C (all units are tested and have excess oil in the ram).
4. Check the hydraulic oil level.
5. Start the engine and use the control lever to extend and retract the wedge several times to remove air from the lines.
6. With the wedge retracted, check the hydraulic oil level again and fill if necessary.
7. Do not thread in the dipstick when checking the hydraulic oil level. Check the hydraulic oil level using the oil sight glass. Oil level should visibly fill the sight glass.8.
8. Check oil level daily and add as needed.

WARNING

DO NOT remove the hydraulic oil fill cap when the engine is running or hot. Hot oil can escape causing severe burns. Always allow the log splitter to cool completely before removing the hydraulic oil cap. High fluid pressure and temperatures are created in the hydraulic log splitters. Hydraulic fluid will escape through a pin-size hole opening and can puncture the skin and cause severe blood poisoning. Inspect the hydraulic system regularly for possible leaks. **Never check for leaks with your hand while the system is pressurized. Seek medical attention immediately if injured by escaping fluid.** Make sure all fittings are tight and secure before applying pressure. Relieve system pressure before servicing.

Make sure the hydraulic hoses do not touch any hot surfaces or cutting areas. Hoses need to be positioned where they are clear from the engine and cutting wedge. To avoid serious bodily injury always inspect the hoses before operating the log splitter.

Add Gasoline to the Engine

1. Use only clean, fresh, regular unleaded fuel with a minimum 87 octane rating.
2. DO NOT mix oil with fuel.
3. Remove the fuel cap, and slowly add fuel to the tank. DO NOT overfill, allow approximately 1/4 inch of space for fuel expansion.
4. Screw on the fuel cap and wipe away any spilled fuel.

DANGER

- Log splitter engine exhaust contains carbon monoxide, a colorless, odorless, poison gas. Breathing carbon monoxide will cause nausea, dizziness, fainting or death. If you start to feel dizzy or weak, get to fresh air immediately.
- Operate log splitter outdoors only in a well-ventilated area.
- DO NOT operate the log splitter inside any building, enclosure or compartment.
- DO NOT allow exhaust fumes to enter a confined area through windows, doors, vents, or other openings.
- **DANGER CARBON MONOXIDE**, using a log splitter indoors **CAN KILL YOU IN MINUTES.**

CAUTION

- Fuel and fuel vapors are highly flammable and extremely explosive.
- Fire or explosion can cause severe burns or death.
- Unintentional startup can result in entanglement, traumatic amputation, or laceration.
- Only use regular unleaded gasoline with a minimum 87-octane rating.
- DO NOT mix oil and gasoline.
- Fill tank approximately 1/4" below the top of the tank to allow for fuel expansion.
- DO NOT fill the fuel tank indoors or when the engine is running or hot.
- DO NOT light cigarettes or smoke when filling the fuel tank.

Operation Instructions

WARNING

Before operating or using the log splitter, review the instructions below and all safety information. Failure to follow these instructions may result in property damage or injury to the operator or bystanders.

WARNING

- ALWAYS use the log splitter for its intended use.
- ONLY use the log splitter to split wood logs, length wise with the grain.
- NEVER modify, alter, or change the log splitter in anyway, modifications will void the warranty.
- NEVER attach a rope, cable, or other device to the control lever on the log splitter.
- ONLY operate the log splitter in daylight.
- NEVER leave the log splitter unattended while the engine is running.
- DO NOT change the splitting position with the engine running. Contact with the muffler can cause serious burns.
- ALWAYS make sure the beam is in the locked position.
- DO NOT let the beam drop as it could crush fingers or cause damage to the log splitter.
- NEVER operate or let anyone else operate, the log splitter while under the influence of alcohol, drugs, or medication.

Using Your Log Splitter

1. DO NOT carry passengers, sit or stand on the log splitter at any time.
2. Check the hydraulic oil level and visually inspect all hoses and attachments for problems.
3. Inspect the engine and make sure the engine oil level is correct.
4. Before towing the log splitter the tires need to be fully inflated.

WARNING

- DO NOT over-inflate tires. Serious injury can result if tires explode.
 - DO NOT tow the log splitter if the tires are worn or will not hold air.
 - DO NOT exceed the maximum 45 MPH towing speed.
5. Refer to the vehicle owner's manual for proper safety and towing instructions.

WARNING

- Serious injury or death can occur if towing safety rules are not followed.
 - Always use chains, secure and lock the log splitter to the vehicle hitch before moving.
 - Drive safely. Be aware of the added length of the log splitter.
 - Never exceed the maximum travel speed of 45 mph.
 - Never ride or transport cargo on the log splitter.
 - Turn off the vehicle before leaving the log splitter unattended.
 - Block the log splitter wheels to prevent unintended movement.
6. The log splitter must have at least seven feet of clearance from combustible material. It needs to be on a dry and level surface with good footing. Do not work on mud, ice, brush, or snow. When using the log splitter the work zone must be maintained at all times.

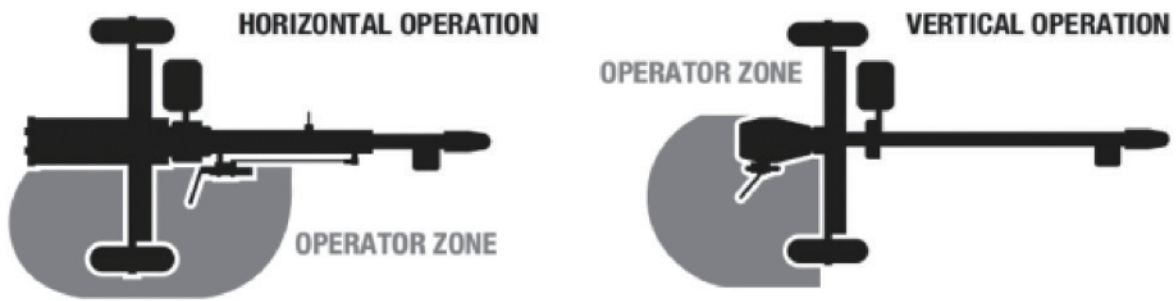

NOTE: Serious accidents can happen when other people are allowed inside the work zone. Keep everyone else outside the work zone while operating the control lever.

7. Always wear safety gear, eye protection, gloves and work boots when operating the log splitter.
8. Start the engine and make sure the log splitter is on level ground before operating.

NOTE: The hydraulic oil needs to be above 10°F (-12°C) before starting the engine. Cold hydraulic oil can damage the hydraulic pump. If outdoor air temperature is below 32°F (0°C) allow the log splitter to warm up by extending and returning the wedge several times before splitting wood.

9. Put both support legs in the down position to prevent the log splitter from moving during operation and block both tires.
10. Set the log splitter in a horizontal position.

NOTE: HORIZONTAL position is used for lighter logs that can easily be loaded onto the beam. Back injury can result from lifting logs onto the log splitter if proper lifting techniques are not used.

11. Load a log onto the beam against the endplate (Max Log Length-24")
12. Make sure hands are clear from the wedge and crush hazard areas.

⚠ WARNING

Machine can cut through the skin and break bones. Keep both hands away from the wedge and beam slide.

Serious accidents can happen when other people are allowed inside the work zone. Keep everyone else out of the work zone while operating the control lever.

DON'T wear loose clothing. It can get tangled in moving parts of a log splitter.

Only use the log splitter in daylight so you can see what you are doing.

13. Push the control lever FORWARD by one hand to split the log.
14. Push the control lever BACKWARD by one hand to return the wedge to its original position.

⚠ CAUTION

If a log gets stuck, embedded, or will not split completely, push the control lever in the reverse direction and allow the splitter to strip the log from the wedge.

If the log still remains stuck, embedded, or will not split, turn the machine off and use a sledge hammer and crow bar to remove the log.

ALWAYS keep hands clear of the log and wedge while it is retracting.

15. Always keep work zone clean and free of split wood and debris.

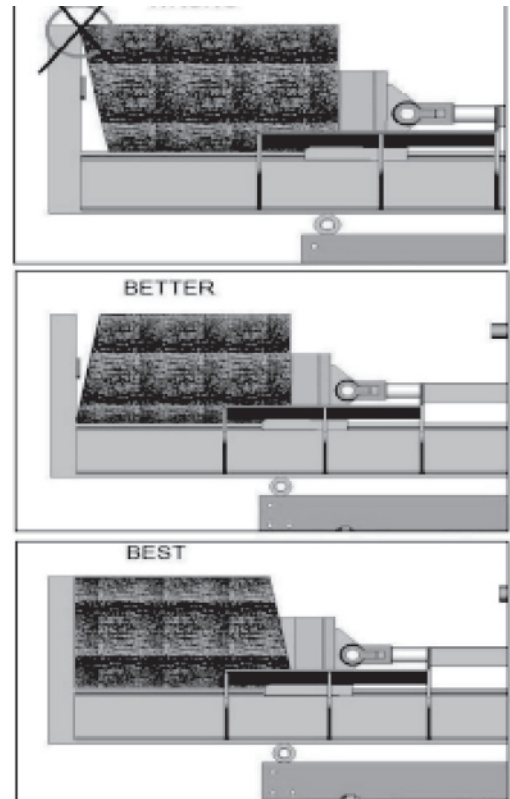

Maintenance and Storage

CAUTION

Improper maintenance and storage of the log splitter may void your warranty.

Maintenance

- Before performing maintenance, the log splitter must be placed in maintenance mode. Turn off the engine and move the control lever forward and backward to relieve the hydraulic pressure.
- After performing any maintenance, make sure all guards, shields and safety features are put back in place before operating the log splitter.
- Before operating make sure the tires have the RECOMMENDED TIRE PRESSURE.
- Regularly grease axle and wheel bearing area or when needed.
- After the wheel bearings have been greased make sure the axle nuts and pins are in place and secure.
- Periodically check all fasteners and hoses for tightness and leaks.
- Annually clean and lightly lubricate all moving parts or when needed.
- Use glossy enamel spray paint to touch up scratched or worn painted metal surfaces.
- Never exceed a load capacity rating of 37 tons it will damage the log splitter.

What	When	How
Hoses	Each Use	Inspect hoses for exposed wire mesh and leaks. Replace all worn or damaged hoses before starting the engine.
Hydraulic Fittings	Each Use	Inspect fittings for cracks and leaks. Replace all damaged fittings before starting the engine.
Nuts and Bolts	Each Use	Check for loose bolts, and tighten them before operating.
Beam	Each Use	Apply grease to the beam surface.
Moving Parts	Each Use	Clear debris from the log splitter.

Refer to the Engine Owner's Manual for engine maintenance.

IMPORTANT

If a part needs replacement, only use parts that meet the manufacturer's specifications. Replacement parts that do not meet specifications may result in a safety hazard or poor operations.

Storage

- Before storing make sure the log splitter is clean and dry for years of trouble-free service.
- Lightly lubricate all log splitter surfaces and moving parts to prevent rust.
- Store indoors or protected area during severe weather and winter months.

Warranty

Twelve (12) months for workmanship of the product, except for wearing parts. Warranty period starts from the product purchase date. Warranty covers material quality and workmanship only.

Warranty does not cover product for issues caused by improper usage or any operation not in accordance with the specifications of this manual. Any modification or tampering with the product in any way voids the warranty.

Troubleshooting

Issue	Possible Cause	Solution
Engine will not start.	No fuel.	Add fuel.
	Faulty spark plug.	Replace spark plug.
	Unit loaded during start up.	Remove load from unit.
Engine will not start.	Low oil level.	Fill crankcase to the proper level.
		Place log splitter on a flat, level surface.
Engine starts but runs roughly.	Choke in the wrong position.	Adjust choke.
	Spark plug wire loose.	Attach wire to spark plug.
Engine shuts down during operation.	Out of fuel.	Fill fuel tank.
	Low oil level.	Fill the crankcase to the proper level. Place the log splitter on a flat, level surface.
Engine cannot supply enough power or overheating.	Out of fuel.	Fill fuel tank.
	Insufficient ventilation.	Check for air restriction. Move to a well ventilated area.
Wedge movement is slow or erratic.	Air in the hydraulic oil system.	Purge air by extending and retracting the wedge several times until motion is smooth.
	Debris lodged in beam guides.	Clear debris from the beam.
	Low hydraulic oil.	Check the oil level and add as needed.

Issue	Possible Cause	Solution
Oil leak from cylinder.	Faulty cylinder rod seal.	Contact Customer Service.
	Scored or bent cylinder rod.	Contact Customer Service.
	Loose hydraulic fitting.	Tighten hydraulic fitting.
	Faulty combination washer seal on cylinder hydraulic fitting.	Contact Customer Service.
Wedge will not extend or retract.	Faulty control valve.	Contact Customer Service.
	Faulty hydraulic pump.	Contact Customer Service.
	Low hydraulic oil.	Check the oil level and add as needed.
Excessive bouncing while towing.	Under-inflated tires.	Inflate tires to the proper pressure. Refer to tire sidewall.

Exploded and Parts List

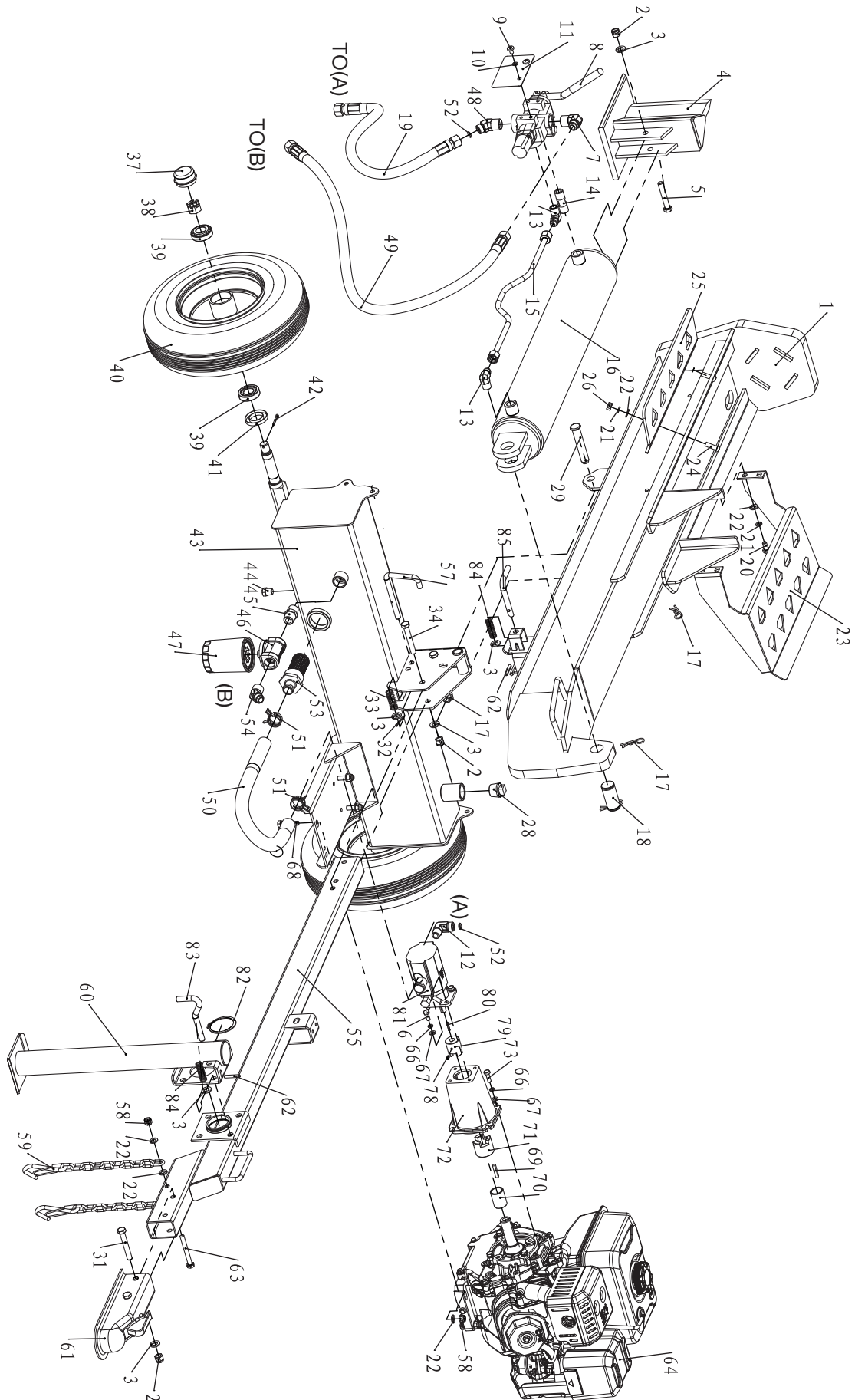

Part No.	Description	Q'ty	Part No.	Description	Q'ty
1	Beam	1	42	Cotter Pin Ø4x32	2
2	Lock Nut M12	5	43	Oil Tank	1
3	Washer Ø12	8	44	Oil Plug	1
4	Wedge Slide	1	45	Through Joint	1
5	Bolt M12x75(12.9)	1	46	Auto Filter Base	1
6	Bolt M8x20	4	47	Auto Filter	1
7	JIC Connector, 90 Degree	1	48	Filter Housing "OUT" Connection	1
8	Control Valve	1	49	Hydraulic Hose(Valve-Oil Tank)	1
9	Bolt M8x12	2	50	Oil Pipe	1
10	Washer Ø8	2	51	Clamp d30	2
11	Plate	1	52	"O" Ring Ø10x2.65	2
12	Outlet Connector Of Pump	1	53	Internal Oil Filter	1
13	Right Angle Joiner	2	54	JIC Connector, 135 Degree	1
14	Valve Joiner	1	55	Base Tube	1
15	Hydraulic Hose(Valve-Cylinder)	1	57	Pin	1
16	Cylinder	1	58	Lock Nut M10	5
17	R Pin	3	59	Safety Chain With Hook	2
18	Wedge Pin	1	60	Front Support Leg	1
19	Hydraulic Hose(Valve-Pump)	1	61	2-in. Coupler	1
20	Bolt M10x20	4	62	Elastic Cylindrical Pin 6x40	2
21	Lock Washer Ø10	6	63	Bolt M10x85	1
22	Washer Ø10	14	64	Engine	1
23	Log Catcher	1	66	Lock Washer Ø8	8
24	Bolt M10x30	2	67	Washer Ø8	8
25	Short Log Catcher	1	68	Bolt M10x45	4
26	Nut M10	2	69	Flat Key	1
28	Screw NPT 1 in.	1	70	Engine Bushing	1
29	Pin	1	71	Engine Connector	1
30	Oil Scale	1	72	Gear Pump Stand	1
31	Bolt M12x80	2	73	Bolt 5/16 in.-24x1 in.	4
32	Cotter Pin 3.2x14	1	78	Screw M6x10	1
33	Spring	1	79	Gear Pump Connector	1
34	Bolt M12x80	2	80	Flat Key 3.18x25.4	1
37	Axle Cap	2	81	Gear Pump	1
38	Slotted Nut M20x1.5	2	82	Circlip Ø63	1
39	Tapered Bearing	4	83	Lock Pin	1
40	Wheel	2	84	Spring	2
41	Cased Seal	2	85	Lock Pin	1



Thank you for supporting our brand!

superhandyus.com



Great Circle USA
Support Line: 1-866-493-0524
help@greatcircleus.com
www.superhandyus.com



Follow us on social media
@SuperHandy