

# Starwatcher Telescope 70060, 525 Power

## Description

The 525 power Starwatcher with an aperture of 60mm and a focal length of 700mm is an ideal entry-level telescope for the aspiring amateur astronomer. It is easy to set up and comes with everything necessary to begin the adventure of a lifetime including telescope, finderscope, diagonal, three eyepieces, moon filter, Barlow lens, mount and tripod. The beginner's version of Barska's popular Deepsky Astronomy Software leads this journey into space. The software is packed with many features that both experienced and novice users will appreciate and includes a searchable database of over 10,000+ objects including, nebulae, star clusters, double stars, and variable stars. Simply load it into a PC and begin your journey to the stars and planets.

## Specifications

Telescope Type	Refractor
Maximum Attainable Power	525x
Focal Length (mm)	700
Objective Lens Diameter (mm)	60
Finderscope	Red Dot
Mount	Altazimuth
Eyepiece 1	SR4
Eyepiece 2	H12
Eyepiece 3	H20
Barlow Lens	3x
Erecting Image Eyepiece	1.5x
Moon Filter	Yes
Accessory Tray	Yes
Tripod	Aluminum
Optical Coating	Fully Coated
Telescope Weight (kg/lbs)	3.2/7



See reverse side for additional information  
For detailed usage see included telescope manual

# Starwatcher Telescope Quick Set Up - 70060, 525 Power

**CAUTION: DO NOT LOOK DIRECTLY AT THE SUN. VIEWING THE SUN OR ANY LIGHT SOURCE WITH THIS OPTICAL DEVICE CAN CAUSE PERMANENT EYE DAMAGE.**



## Parts Included

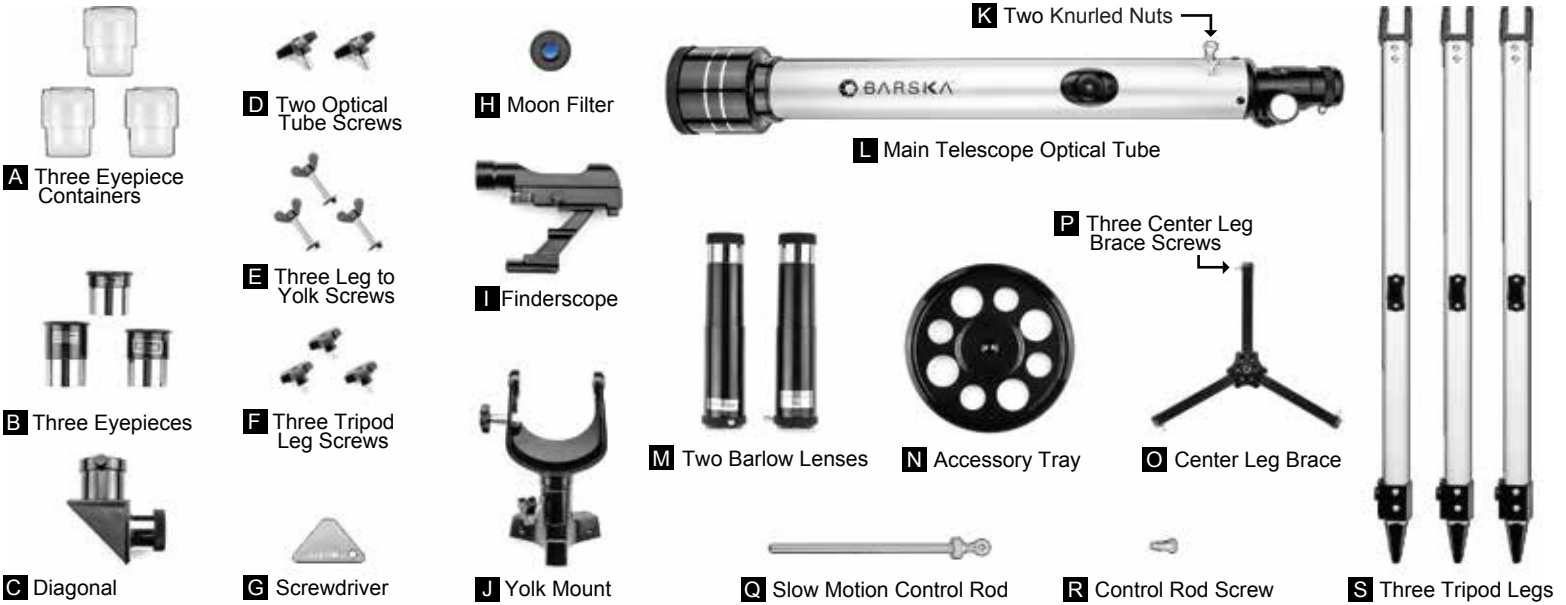

## Assembly

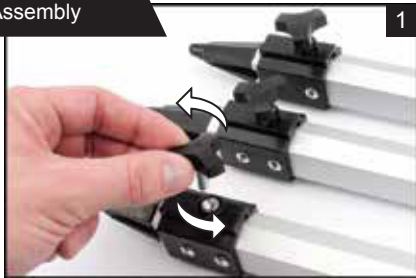

1 Attach (F) tripod leg screw to the extension base on each of the (S) tripod legs.



2 Attach each (S) tripod leg to the (J) yolk mount using the (E) leg to yolk screw sets.

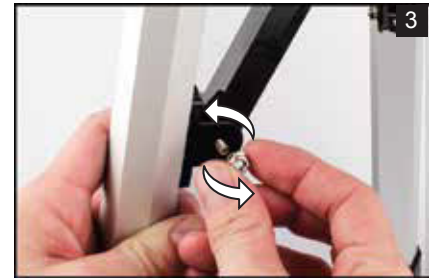

3 Use the (P) center leg brace screws on the (O) center leg brace to connect each of the center leg braces to the three (S) tripod legs.



4 Place the (N) accessory tray on top of (O) center leg brace. Thread the (N) accessory tray into the threaded hole in the center of the (O) leg brace and screw into place.



5 Line up the (L) main telescope optical tube with the side mount holes on the (J) yolk mount and secure in place using the two (D) optical tube screws.

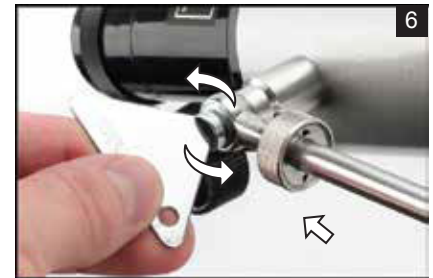

6 Insert the (Q) slow motion control rod into the hole on the (J) yolk mount. Then secure the (Q) slow motion control rod with the included (R) control rod screw by tightening it with the included (G) screwdriver.



7 Remove the (K) knurled nuts and attach the (I) finderscope to (L) main telescope optical tube with the battery compartment and lens facing the front of the telescope. Secure by tightening the (K) knurled nuts.



8 Insert the chrome barrel of the (C) diagonal into the focuser tube on the (L) main telescope optical tube and tighten the set screw.



9 Choose one (B) eyepiece and insert the chrome barrel of the eyepiece into the (C) diagonal and tighten the set screw.

See reverse side for additional information. For detailed usage see included telescope manual.