

TIE DOWN

MANUFACTURING INGENUITY

Spare Tire and Hub Carrier Assembly/Installation Instructions Part #86079

This kit contains the following components:

#	Qty.	Part #	Description
1	1	48056	Side Mount Carrier with Spindle
2	1	46210PA	1750# Hub 5 Stud
3	1	10520	Washer 1"
4	1	10551	Cotter Pin
5	1	10665	Castle Nut 1"
6	1	17093	Dust Cap
7	1	46963	Dust Cap Rubber Grommet
8	5	10641	Lug Nuts - Grade 5
9	4	10645	Nylock Nut 12"-13
10	4	10573	Flat Washer 1/2"
11	2	84470-1Z	U-bolt 1/2" x 3" x 4.0"
12	2	84472-1Z	U-bolt 1/2" x 4" x 4.3

Fully assembled 5 stud pre-greased hub with bearings. Heavy-duty zinc plated steel carrier mounts both spare hub and spare tire. Designed for 1,750 lb. hub with 1-1/16 in. and 1-3/8 in. bearings. Fits all trailer frames up to 3 in. wide and 4 in. high. Security holes for optional cable and lock.

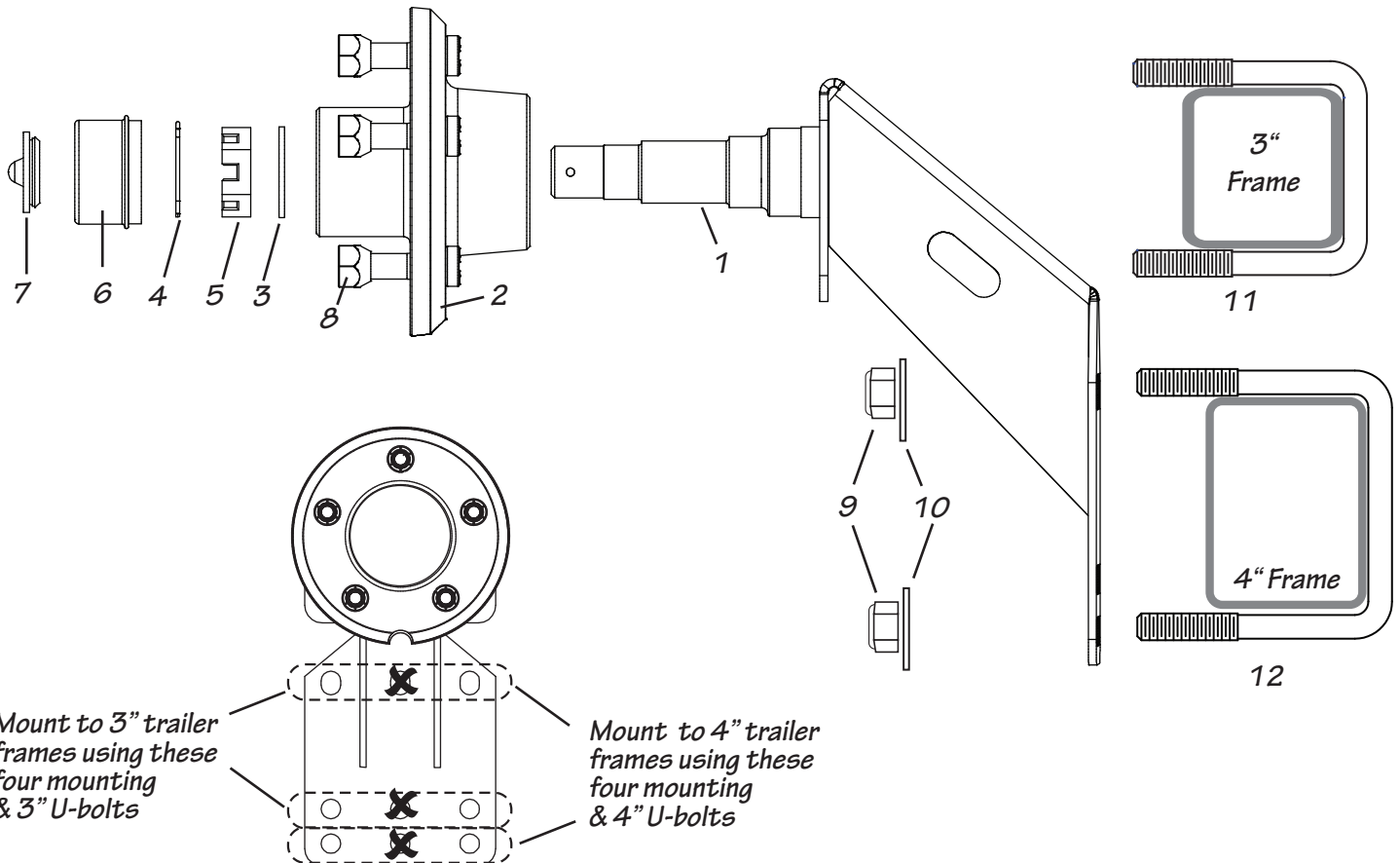
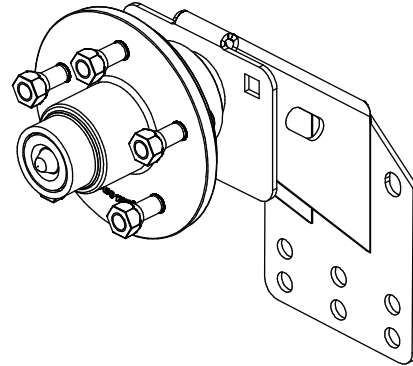

Instructions #08491 (A2111, Rev. 12/3/25)

Spare Tire and Hub Carrier Assembly/Installation Instructions Part #86079

Road Side Repairs

When required, you have several options when confronted with a flat tire, bearing failure or spindle damage. Flat tires should be handled like any other trailer tire change. Make sure trailer is on level or near level ground. Loosen lug nuts on wheel. Use jack on trailer frame to elevate tire in order to place spare tire on the hub. Make sure all lug nuts are securely tightened before moving trailer. Re-check lug nuts after several miles to make sure they are tight. Bearing failure is usually discovered by a loud grinding noise or wheel wobble. If there is obvious bearing damage, jack up the trailer to remove the tire. Remove the dust cap with a hammer by striking at the edge, rotating the hub to strike different sides until the dust cap is removed. The castle nut that holds the hub on has a cotter pin to keep it from coming off. Bend or straighten the pin so that the nut will come off. Remove the hub and inspect the spindle for damage. If none is detected, wipe the spindle clean and replace the damaged hub with a pre-greased spare. The washer and castle nut are replaced. Tighten the nut until it is tight with obvious friction on the bearings. Back off nut 1/4 turn to allow fluid bearing movement. Re-lock the castle nut with the unused tang on the washer. Replace tire and secure with lug nuts.

Wheel Hub

Your Spare Tire Carrier is equipped with a Super Lube cap. The hubs are pre-greased and assembled at the factory and should not require any initial adjustments. The UHI hub uses tapered roller bearing cones and cups. This configuration requires a minimal amount of end play that is provided at the time of assembly.

Removal/Remounting for the Hub

Removing the hub for inspection or maintenance should be done in a safe location away from moving vehicles.

1. Elevate the trailer using the manufacturers instructions. Always use jack stands or other solid supports. Do not depend on a jack to support the trailer. Block wheels to keep trailer from rolling.
2. Remove the tire/wheel assembly.
3. Remove the grease cap from the hub by prying around the edge of the cap.
4. Bend the cotter pin to the "free" position.
5. Remove the spindle nut in a counterclockwise direction and remove the spindle washer.
6. Remove the hub from the spindle. Be careful not to allow bearings to fall out of the hub.
7. Clean bearing and cup surfaces, repack with lithium marine grade grease.
8. Place hub on spindle in reverse order as listed above. Rotate the hub while tightening the spindle nut to approximately 50 ft lbs. This translates into full hand pressure with a 12" long set of pliers or 12" long wrench.
9. Loosen the spindle nut to remove the torque, do not rotate hub.
10. Finger tighten the spindle nut until snug, backing out only to line up the locking tang washer.
11. Bend a new cotter pin in place.
12. Replace grease/hub cap.
13. Test hub with wheel mounted for excessive play or tightness, readjust if required.