Operation Manual

Garden Pump



Illustration similar, may vary depending on model

Read and follow the operating instructions and safety information before using for the first time.

Due to further developments, illustrations, functioning steps and technical data can differ insignificantly.

Updating the documentation

If you have suggestions for improvement or have found any irregularities please contact us.

Thank you for purchasing this quality product. To minimize the risk of injury by means of fire or electric shock we urge that our clients take some basic safety precautions when using this device. Please read the operation instructions carefully and make sure you have understood its content.

Always use a grounded power connection with the appropriate mains voltage. You can find the corresponding mains voltage on the type plate. If you have any doubts about the connection being grounded, have it checked by a qualified professional. Never use a faulty electric cable.

Do not inspect the electrical part of the pressure pond filter in a wet or damp environment or when you are wet yourself and protect it from direct sunlight. Install this device in a safe location so that nobody can step on the cable, fall over or damage it. Disconnect the power plug before cleaning it and use only a damp cloth for cleaning. Avoid using cleaning agents and make sure that no liquid enters the electrical part of the pump.

The electric part of the device contains no parts that can be inspected or serviced by the user. Leave the maintenance, adjustment and repair to qualified technical personnel. Keep these operation instructions safe.

Instruction manual for Pump series CGP

Note: Before use of the pump, please carefully read the operation instruction. Keep this instruction manual for future reference and hand it out together with the pump when you give the pump to other people. Any damage due to failure to obey the instruction will not be under the guarantee scope.

Safety instructions



- a) This appliance is not intended for use by persons (including children) with reduced physical, sensory or mental capabilities or lack of experience and knowledge, unless they have been given supervision or instruction concerning the use of the appliance by a person responsible for their safety.
- b) Children should be supervised to ensure that they do not play with the appliance.
- c) If the supply cord is damaged, it must be replaced by the manufacturer or its service agent in order to avoid a hazard.
- d) The pump must not be used when people are in the water.
- e) Please check pump carefully after it got unpacked. If you find any defects, please contact a service agent. Do not try to repair it by yourself.
- f) This pump is not suitable for use in inflammable or explosive medium.
- g) Dry-running of pump is prohibited.
- h) This pump shall not be suitable for long time continuous operation (e.g. cyclic running in filter of swimming pond or act as industrial equipment).
- i) This pump is suitable for conveyance of clean water. Liquid including greasy stain or other materials will damage the pump. This pump shall not be used to convey abrasive materials, silt materials, slurry, or other viscous materials. If the pumped medium contains corrosive compositions, the corrosion resistance of the pump materials must be considered. This pump may be used to convey daily clean water, but conveyance of drinkable water shall be absolutely prohibited.
- j) This pump should be placed in a well-ventilated, dry, damp-proof or waterproof place under ambient temperature not above 40°C. It shall not be stored or used in rain or a wet room.
- k) When the pump is connected with washing basin or bath shower, it is unsuitable for conveyance of drinkable water.
- l) Max. temperature of the liquid to be pumped : 35°C
- m) The pump must be supplied through a residual current device (RCD) having a rated residual operating current not exceeding 30mA.

If the supply cord is damaged, it must be replaced by the manufacturer or its service agent in order to avoid a hazard.

Layout

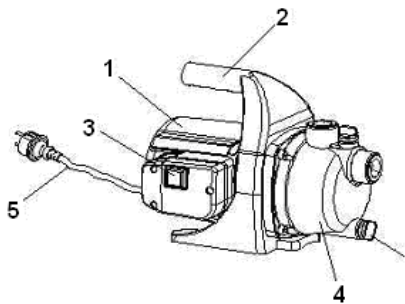

- 1 motor cover
- 2 handle
- 3 switch
- 4 pump head
- 5 cable
- 6 valve cover

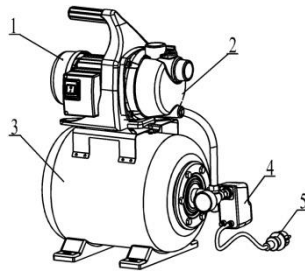

- 1 motor cover
- 2 pump head
- 3 pressure cylinder
- 4 pressure switch
- 5 cable

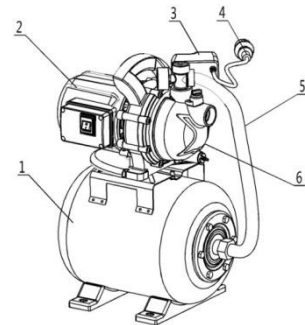

- 1 pressure cylinder
- 2 motor cover
- 3 pressure switch
- 4 cable
- 5 pump head

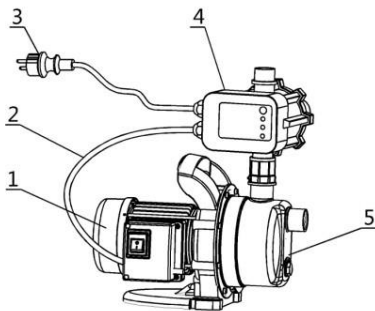

- 1 motor cover
- 2 connect cable
- 3 cable
- 4 electron switch
- 5 pump head

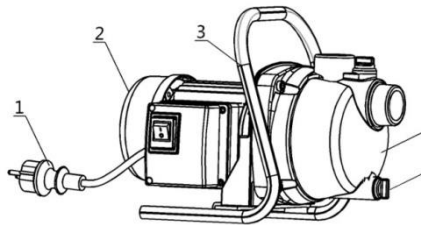

- 1 cable
- 2 motor cover
- 3 handle
- 4 pump head
- 5 valve cover

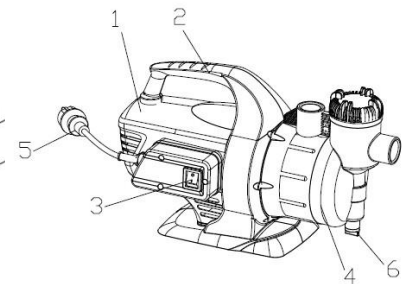

- 1 motor cover
- 2 handle
- 3 switch
- 4 pump head
- 5 cable
- 6 valve cover

Technical Parameters

Pump type	CGP600Lz-vqh	CGP800Lz-vqh	CGP1000Lz-vqh	CGP1200Lz-vqh
Input voltage (V)	110	110	110	110
Input power (W)	600	800	1000	1200
Max. total head (ft)	115	130	144	157
Max. flow rate (GPH)	792	845	925	1000
Max. suction height (ft)	23	23	23	23

Pump type	CGP600Lz-an	CGP800Lz-an	CGP1000Lz-an	CGP1200Lz-an
Input voltage (V)	110	110	110	110
Input power (W)	600	800	1000	1200
Max. total head (ft)	115	130	144	157
Max. flow rate (GPH)	792	845	925	1000
Max. suction height (ft)	23	23	23	23

Functions

CAUTION:

- This water pump has a water-sprinkling protection feature and should be placed only in a dry environment. Never place the water pump or operate it in the rain or in a humid space.
- This water pump should not be used with flammable or harmful liquids.
- Idle operation of the water pump must be avoided.
- This water pump is for work in clean water. The scope of its application includes irrigation in the garden, water supply to a household, sprinkling in a garden or on farmland.
- This water pump may not be exposed for long periods to impurities, sand, stone, sticky substances, etc., mixed in with the conveyed media. Because the conveyed media may contain chemical corrosive substances, it is necessary to pay special attention to preventing influence by these on the material of the pump body. It is not permitted to use this water pump to convey drinking water.

DANGER:

If this water pump is used in a swimming pool, garden pond or similar pools, the pump must be supplied through a residual current device (RCD) having a rated residual operating current not exceeding 30mA. Always keep it in a working state to ensure the safety and reliability of the water pump. In addition, the pump should be placed on a stable base to prevent it from falling down.

Power connection

General description:

Danger: During the installation of the water pump, the power supply to the water pump must be switched off.

Caution: During installation of the equipment, it is necessary to keep it under dry and well-ventilated conditions, at an ambient temperature below 40 °C.

- Before use, the water pump should be inspected for safety to ensure that there is no damage to the power cable or the plug.

Electrical connection:

Danger: The Electrician responsible for installation must check to ensure that the electrical connection is in accordance with the standard, including the earth terminal.

- The water pump must be well earthed.

Taking into use

The pump are not self-priming pumps, this means that suction hose should first of all be fitted with:

1. Non-return valve with filter; this ensures that, after disconnecting the pump, the hose and the pump do not run dry. This part of the hose is suspended in the water to be pumped away.
 2. Hose with coupling nut; this end of the hose is attached to the front of the pump.
 3. Both accessories should be securely screwed on to the hose using the hose clip supplied.
- Before fastening the hose to the pump, it is best to fill it with water first. After this you can screw the three-way cock or another 1"connector to the outlet on the pump; this is on the top of the pump.
 - Then you should loosen the small screw cap on top of the pump housing and fill the pump housing with water through the opening; then re-seal it.
 - If the pump housing and the hose have both now been filled with water, you can switch on the pump using the on/off switch.
 - The pump now immediately begins to pump water.
 - If the pump is subsequently switched off again, water remains in the pump housing and the hose which means that when the pump is next switched on it will pump water immediately.

Pressure hose:

- The pressure hose is used for conveying the water from the pump to the water consumption point (e.g. tap, etc.). In order to minimize the friction loss caused by the water pressure, we recommend that you use a pressure hose with diameter of 1”.

Maintenance

- The appliance only needs an external regular cleaning.
- Before cleaning the appliance, always unplug it from power supply and wait till the unit stopped.
- Do not clean the painted parts with emery or solvents and use only a moistened cloth.
- If trouble with the pump is experienced, it must be repaired by professional personnel or an authorized service centre.

Cleaning and Care

Proper and regular care will not only ensure safe use but also elongate the lifetime of this appliance.

Warning! Switch of the appliance and disconnect from power supply before you carry out cleaning and maintenance work to avoid electrical hazards.

- a) Wipe dust off with a soft dry cloth or brush.
- b) To clean other debris you may use a slightly wet cloth and neutral detergent.

Note! Do not use chemical, alkaline, abrasive or other aggressive detergents or disinfectant to clean this appliance as these might be harmful to its surface.

Repair and Maintenance

This appliance does not contain any user serviceable parts. Do not try to repair the appliance yourself. Always bring it to your dealer or an authorized service partner.

Correct Disposal of this product



This marking indicates that this product should not be disposed with other household wastes throughout the EU. To prevent possible harm to the environment or human health from uncontrolled waste disposal, recycle it responsibly to promote the sustainable reuse of material resources. To return your used device, please use the return and collection systems or contact your local authorities.