

# Cordless Horse Clippers

User Manual

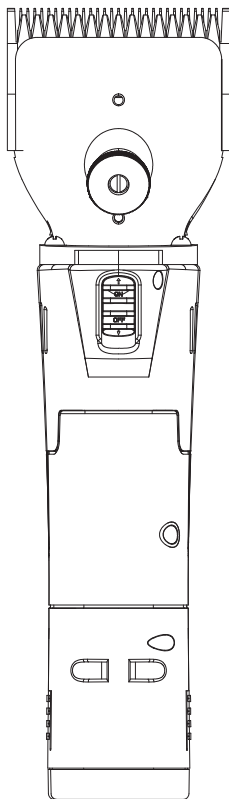

ON-D131

# Safety Instructions

---

1. **Read Before Use:** Before using the clippers, read all safety and operating instructions.

2. **Electrical Safety:** Ensure that the voltage indicated on the rating label matches your electrical outlet. Do not immerse the appliance in water or any other liquids to avoid electric shock.

**WARNING: Keep the appliance dry.**

3. **Supervision:** This appliance can be used by children aged from 8 years and above and persons with reduced physical, sensory or mental capabilities or lack of experience and knowledge if they have been given supervision or instruction concerning use of the appliance in a safe way and understand the hazards involved. Children shall not play with the appliance. Cleaning and user maintenance shall not be made by children without supervision.

4. **Regular Checks:** Periodically check the clippers for damage. If the appliance or power cord shows any sign of damage, do not use it. Contact the service center for repair or replacement.

5. **Regular Maintenance:** Disconnect the clippers from the power source before cleaning, changing accessories, or performing any maintenance. Keep the blades clean and well-oiled to avoid overheating and ensure optimal performance. Replace blades as needed.

**WARNING : Cutting blades may become hot after prolonged use.**

6. **Storage:** After use, unplug and store the clipper in a dry place, away from pets and children.

7. **Handling:** Avoid touching the blades directly with your fingers. Always switch off the appliance when not in active use.

**8. Use for Intended Purpose:** These clippers are designed for trimming pet hair only. Do not use them for any other purpose.

9. **Disposal:** Dispose of the clipper and its accessories according to local regulations for electronic waste.

# What You Have

---

---

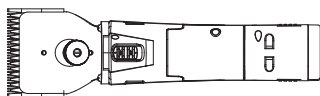

Main Unit

---

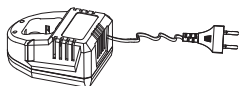

Charging Base



Replacement Blades (3mm)

---



Backup Battery

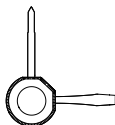

Wrench



Blade Protector

---



Cleaning Brush

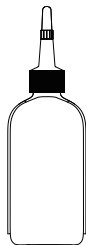

Lubricating Oil



Shims x2

# Display of Machine Components

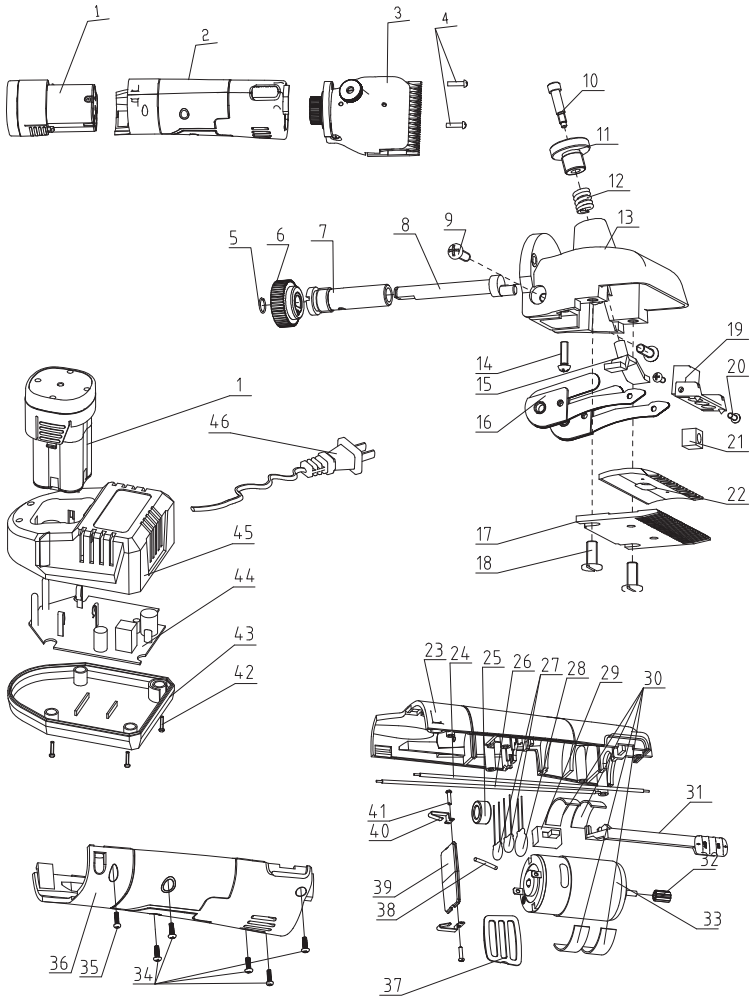

# Introduction of Machine Components

---

1. Battery Pack	2. Body	3. Clipper Head
4. Screw		
<b>Clipper head (Including Clipping Blades)</b>		
5. Jump Ring	6. Gear	7. Deflection Collar
8. Axis of Deflection	9. Screw	10. Adjustment Screw
11. Adjustment Cap	12. Regulation Spring	13. Aluminium Head
14. Screw	15. Adjustment Claw	16. Demihull Component
17. Bottom Blade	18. Screw	19. Swing Head Component
20. Screw	21. Slide Block	22. Upper Blade
<b>Body</b>		
23. Left Body	24. Wire	25. Magnet Ring
26. Wire	27. Capacitance	28. Capacitance
29. Switch	30. EVA	31. Switch Push Button
32. Small Gear	33. Motor	34. Screw
35. Screw	36. Right Body	37. Mesh Enclosure
38. Wire	39. Connector Piece	40. Contact Chip
41. Screw		
<b>Charger Set</b>		
42. Screw	43. Charging Bottom	44. PCB
45. Charger Base	46. Power Cord	

## Before We Start

---

1. If the machine is not installed blade, won't be used.
2. Please clean the blade regularly and maintain the blade with oil.
3. Avoid placing the machine in direct sunlight and keep it away from any potential sources of ignition.

4. Please turn off the power before replacing the battery.

Please use the charging base provided with this product to charge the machine, other adapters may cause the machine to malfunction or be damaged.

5. This horse clipper is only recommended for use on horses or sheep, not on humans.

## Let's Get Started

---

### 1. Charging the machine for the first use

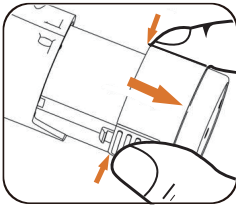

1) Press both sides of the battery with your fingers, then pull out the battery.

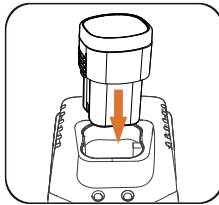

2) Insert the battery into the charging base

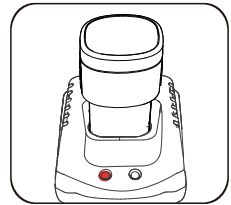

3) Turn on the power to start charging

#### Note:

1. Please use the charging base we provided for charging.
2. Red light means charging, green light means fully charged.

## 2. How to Assemble

### I. Remove/Replace the 3mm blade

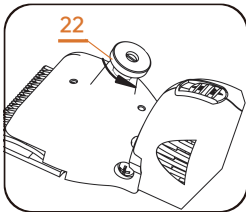

1) Disassembly Method:  
loosen the knob 22 part.

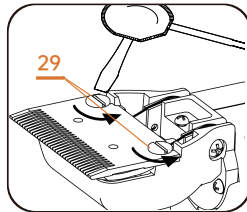

2) Use a tool wrench to  
rotate the nut 29 part,  
remove the cutter head.

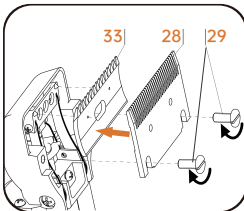

3) Fixed the flat holes  
of the 28, 33 blade  
part, then rotate the nut  
29 part.

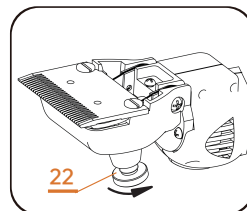

4) Tighten the knob 22  
part and test the horse  
clippers whether can cut  
normally.

II. If the shim is deformed/the shim bushing is broken, replace the spare shim promptly.

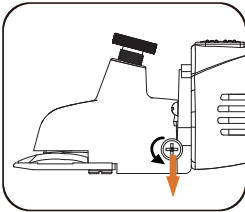

1) Removing the blade as Step I, then unscrew the screws on both sides to remove shims .

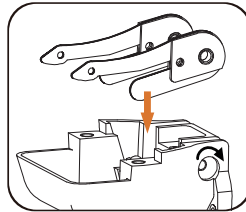

2) Put in the new shim, tighten the screws.

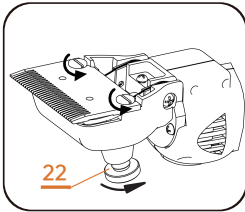

1) Follow Step I to install the blade, tighten the knob 22 part.

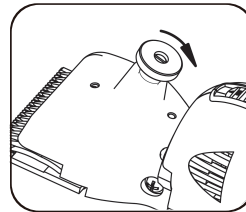

4) The knobs need to be tightened before use to ensure smooth cutting.

### 3. Drip Oil Tips

To keep the blade cool, it is recommended to lubricate it with oil every 10 minutes.

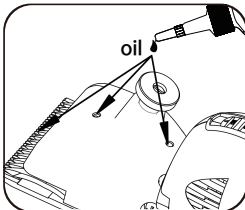

# Product Parameters

---

## Horse Clippers

Model NO.	2601
Voltage	100-240V~
Motor Power	45W
Speed	2400rpm
Amplitude of swing	6.5mm
Dimensions(W/H/L )	Approx 72mm*80mm*281mm (including battery cartridge)
Weight	1.1kg (including battery cartridge)

## Battery Pack

Battery Specification	14.4V Li-ion battery cells
Voltage	14.4V $\equiv$
Capacity	2500mAh
Overload current	10A
Weight	213g

## Charger

AC input	100-240V 50/60Hz
DC output	17V $\equiv$ 1500mA
Operating temperature	-40 to 40°C
Weight	398g

# Maintenance & Cleaning

---

## I. Daily Cleaning

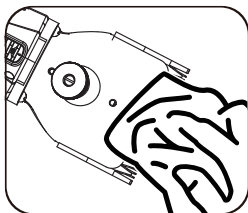

1. Wipe off oil stains on the blade with a dry cloth

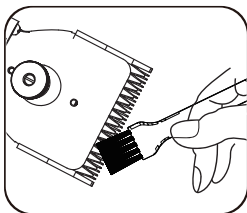

2. Use a cleaning brush to remove hair from the blade

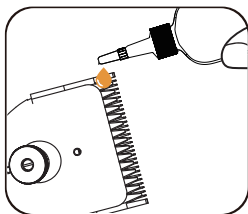

3. Finally, drop oil to the blade to prevent rust

### Note:

It is not recommended to clean the blade with running water. If you use water to clean the blade, please make sure to thoroughly dry it afterwards and lubricate the blade with oil to prevent rust that may affect cutting performance.

# Troubleshooting

---

MALFUNCTION	CAUSE	RECTIFICATION
Charging indicator not on	Not connected to a power supply	Plug into a power supply
	Indicator damaged	If you can still charge the clipper normally, it is not necessary to repair it. If you really need to repair this problem, please return the appliance to a service centre.
	Low power (appliance not used for a prolonged period)	Please charge the battery continuously for a few minutes and it should work normally
	Charging circuit defect	Return the appliance to a service centre
Charging takes too long	Original adaptor not used	Use the original adaptor for charging
	Reach the life time of battery	Return the appliance to a service centre
	Charging circuit defect	Return the appliance to a service centre
Appliance does not work when you turn it on	Low power level on battery	Charge battery with the adaptor and power cord
	Power switch damaged	Return the appliance to a service centre
	Circuit defect	Return the appliance to a service centre

Appliance is noisy	Insufficient lubrication of the cutting blades	Lubricate the cutting blades
	Hair twisted on cutting head	Clean the cutting head and clippers
Clipper head too hot	The pressure on the blades is too high	Reduce the pressure on blades using the adjustment cap
	There is no lubricating oil on the blades	Add lubricating oil
	No lubricating oil at the driving wheel	Add lubricating oil to the lubrication port on the clipper head
Cutting performance is not good	Clipper blades are blunt	Have upper and lower blade resharpened by a service centre
	Clipper blades are not contacting correctly	
	Clipper blades not oiled	Oil clipper blades every 15 minutes
	Clipping tension too low	Add pressure by tightening the adjustment cap (Figure 3)
	The animal's hair is wet	Only clip when dry
Other	Possible malfunction	Any problems, please contact us our email: support@oneisall.com

# GPSR Product Information

---

**UK REP**

Name: APEX CE SPECIALISTS LIMITED  
Add: 6f East Union Street, Manchester, England, M16 9AE  
Contact: Wells  
Tel : +441616371080  
E-Mail: Info@apex-ce.com

**EC REP**

Name : Apex CE Specialists GmbH  
Add : Grafenberger Allee 277-287,40237 Düsseldorf,DE  
Contact Person: Wells Yan  
Tel: +353212066339  
E-Mail: Info@apex-ce.de

GPSR-Manufacturer info:

Business Name: chuzhouguanyidianzishangwuyouxiangongsi  
Manufacturer Address: CN, 239200, anhui, chuzhoushi, laianxian,  
xinanzhenqingliuxilu, taixinxiangzhangyuan1dong1danyuan2403shi  
Telefonnummer: +86 130 4980 3796  
E-Mail: oneisallofficial@hotmail.com

Product Name: Horse Clippers  
Brand: oneisall  
Product Model: 2601  
Li-ion14.4V = 2500mAh 36wh



Made in China

# Contact Us

---

## WE ARE READY TO HELP

Oneisall offers a standard **2 years** warranty. If you have any issues with your Oneisall product, please do not hesitate to contact us. Be sure to include your proof of purchase, model number, and any relevant photos or videos in your message to expedite the process. Our Oneisall support team is available 7 days a week and will respond to your inquiry within **24 hours**. Thank you for choosing Oneisall.

Please note that the Oneisall warranty does not apply to used products or purchases made from unauthorized sellers. It's important to be aware that the warranty also does not cover consumable parts such as blades, guards, filters, brushes, and similar items. These parts may require regular replacement or maintenance.

✉ [support@oneisall.com](mailto:support@oneisall.com)

📞 +1 877-522-8578 (US)

🌐 [www.oneisall.com](http://www.oneisall.com)

**Mon-Fri** 8am-5pm(PST)

## Guide Video



Product  
Introduction  
Video



Install the  
blade Video



@Oneisall Official



Any problems you have, please contact us :  
[support@oneisall.com](mailto:support@oneisall.com)