

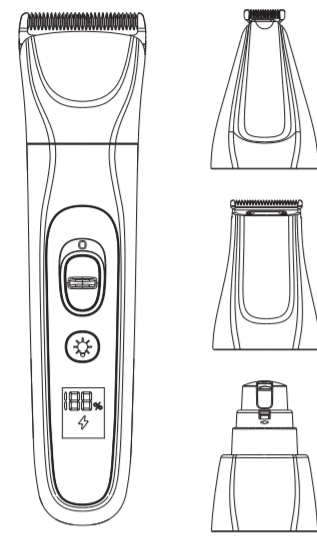

4 in 1 Pet Grooming Kit

Model: FC10



User Manual

Any problems you have, please contact us:
support@oneisall.com

ON-D165

Product Composition

Names of Each Part

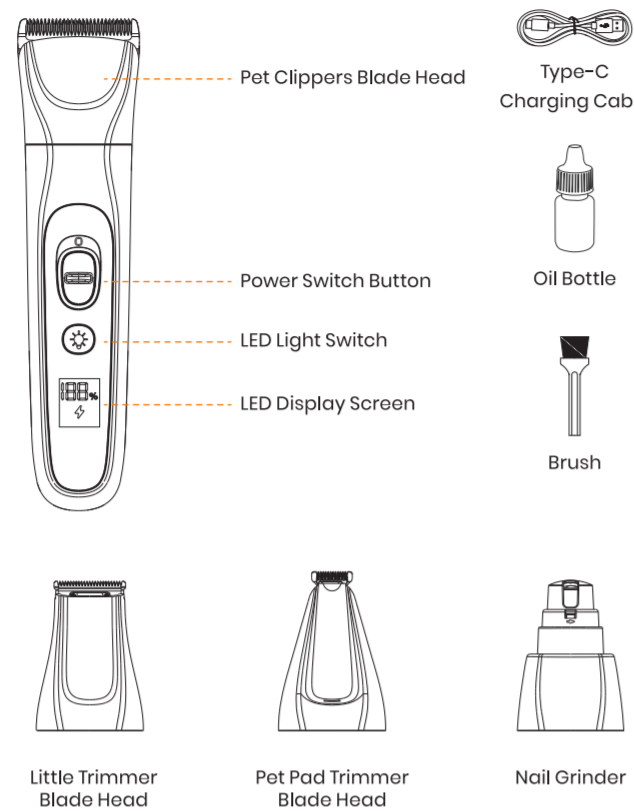

Warning

- Before use, please be sure to lubricate the blade for maintenance (blade lubricant is included in the product package). During use or charging, the body may get slightly warm, but it has no effect on the performance.
- Do not use gasoline, alcohol, or thinner to clean the body, which may cause the body to discolor.
- You can wipe the body with diluted soapy water.
- Do not use this product in the bathroom.
- Do not charge in an environment where the indoor temperature is lower than 0°C or higher than 40°C.
- Please store it properly out of the reach of children.
- When the display shows a battery level of 2% or lower during use, it is recommended to connect the device to a USB Type-C charger as soon as possible to prevent damage to the battery life due to being completely drained or nearly depleted.

Product Specification

Working Voltage:	3.7V
Battery:	2000mAh
Charging Time:	Approximately 3 hours.
Continuous Working Time:	Up to 220 minutes on a full charge.
Input:	5V = 1A
Power:	5W

- Turn off the pet clipper before inserting the USB Type-C charging cable into the clipper.
- Insert the USB Type-C charging cable into the power socket, the charging power indicator light will turn on, and during charging, the 100% number in the LED display will flash (as the charging time and battery power increase, the number will increase), and the lightning icon will always be on. When the battery is fully charged to 100%, the number 100% will display "100" (always on), and the lightning icon will not be displayed.
- After charging, unplug the USB Type-C charging cable from the power socket.

- Please charge in an environment between 5°C and 35°C.
- For the first use or unused for more than three months, fully charge the pet clipper before use.
- To avoid affecting the service life of the product, after the battery is fully charged, unplug the USB Type-C charging cable from the power socket and do not let the clipper stay connected to the external power source for a long time.

Warning: Do not use non-rechargeable batteries in this product.

Introduction to The Blade Head

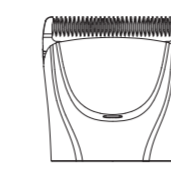

Pet Clippers Blade Head

45mm long pet clippers blade head is suitable for trimming the hair of the pet's whole body. When used with the limit comb, it can better control the length of the hair left, and you can control the length of the hair as you like. For beginners, with the limit comb cover, they can easily trim a flat hair shape without any hair trimming skills.



Little Trimmer Blade Head

26mm long little trimmer blade head is suitable for multi-part trimming for large and medium-sized pets, such as foot hair, buttocks, and around the eyes and ears. It can also be used with the hair clippers blade head to finely trim various personalized shapes. Using it with a limit comb can better control the length of hair required for the shape. Because the head is smaller, for beginners, it is also safer and more convenient to use with the limit comb.

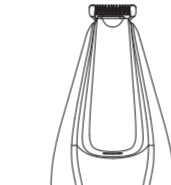

Pet Pad Trimmer Blade Head

15mm long pet pad trimmer blade head is suitable for multi-part trimming for small pets, such as paws, legs, hips, tail, and around the eyes and ears. As its head is smaller, you will get a more fitted trimming angle.



Nail Grinder

Mainly used for grinding nails.

How to Install & Disassemble Attachments



- Detach the head: Grip the body firmly with one hand, and with the other hand, slide upwards from the side to remove the head.

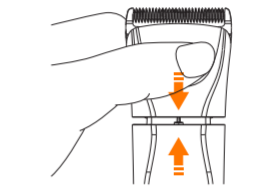

- Installation: Press down firmly to secure the component in place.



TRANSFORM HOW YOU PET
Any problems you have, please contact us:
support@oneisall.com



ON-D165

How to Use Guide Combs

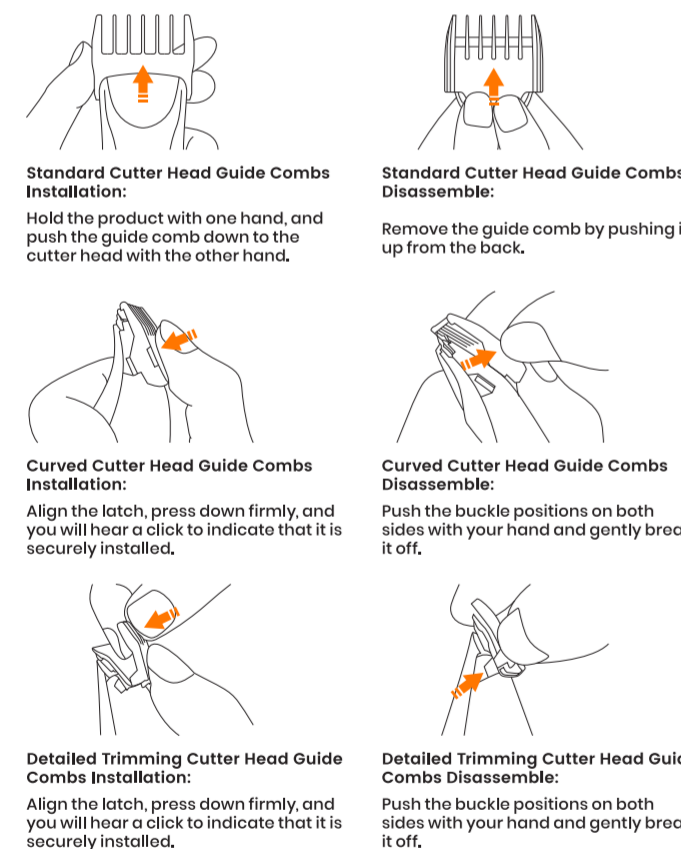

How to Use A Limit Comb

Limit comb function trim for crew cut or the side hair. (2,2,3,6,9,12,15,18mm) 8 kinds of length adjustment to control the length of hair.

- Determine the need hair length
- Select the appropriate limit comb

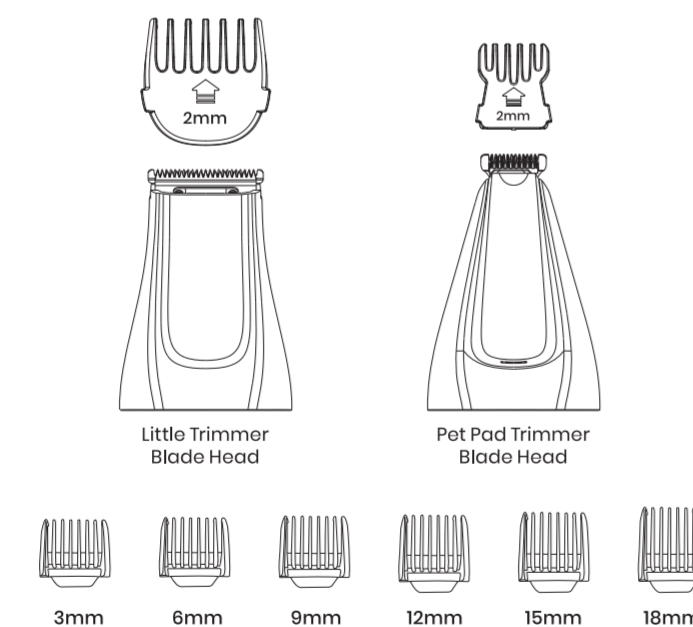

How to Install & Disassemble Blade

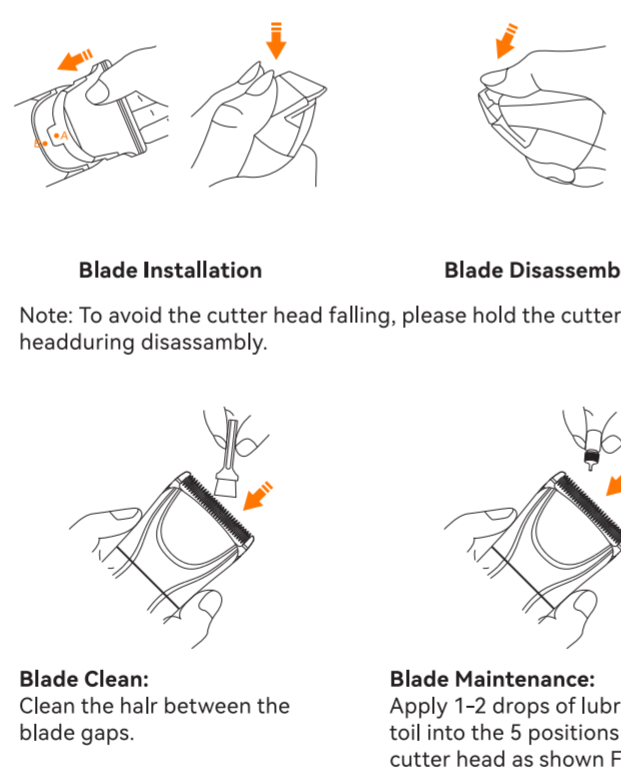

Installation & Disassemble



Please scan the QR code for detailed instructions

Maintenance and Care

- Cleaning**
Use a cleaning brush to remove the hair in the pet clipper and around the blade.
- Maintenance**
After cleaning the blade, add a few drops of oil at the indicated points.

Tip: Before and after use, apply a few drops of oil to the blade to prevent it from becoming blunt, overheating, or making abnormal sounds.
Blade Head Life: The life of the blade head depends on the frequency and duration of use. If used twice a month for 20 minutes each time, the expected life of the blade head is 2 years. If properly maintained, the life of the blade head will be extended. When you find that the hair cutting effect is reduced, please replace the blade head.
- Battery Use**
The battery used in this machine is a rechargeable battery, model is 2000mAh lithium battery.
Note: Do not replace battery.

Battery Life: The life of the battery depends on the frequency and duration of use. If the battery is not used for a long time, it is recommended to charge the pet clipper at least once every three months to ensure the battery life.

Contact Us

WE ARE READY TO HELP

Oneisall offers a standard 2-year warranty. If you have any issues with your Oneisall product, please do not hesitate to contact us. Be sure to include your proof of purchase, model number, and any relevant photos or videos in your message to expedite the process. Our Oneisall support team is available 7 days a week and will respond to your inquiry within 24 hours. Thank you for choosing Oneisall.
Please note that the Oneisall warranty does not apply to used products or purchases made from unauthorized sellers. It's important to be aware that the warranty also does not cover consumable parts such as blades, guards, filters, brushes, and similar items. These parts may require regular replacement or maintenance.

- support@oneisall.com
- +1 877-522-8578 (US) Mon-Fri 8am-5pm (PST)
- www.oneisall.com



@Oneisall Official

GPSR Product Information

UK REP Name: APEX CE SPECIALISTS LIMITED
Add: 8f East Union Street, Manchester, England, M16 9AE
Contact: Wells
Tel: +441616371080
E-Mail: info@apex-ce.com

EC REP Name: Apex CE Specialists GmbH
Add: Grafenberger Allee 277-287, 40237 Düsseldorf, DE
Contact Person: Wells Yan
Tel: +353212068339
E-Mail: info@apex-ce.de

GPSR-Manufacturer Info:
Business Name: Shenzhenbenfendianzishangwuyouxiangongsi
Manufacturer's Address: CN, 518000, Guangdong Sheng, Shenzhen, Longhua District, Minxin Community Bishui Longting Building 6 Unit, 7B
Tel: +86 195 8587 5424
E-Mail: topservice4u@hotmail.com

Product Name: Pet Grooming Kit
Brand: Oneisall
Product Model: FC10
Input: 5V = 1A

FCC Statement:

This device complies with part 15 of the FCC Rules. Operation is subject to the following two conditions:
1. This device may not cause harmful interference, and
2. This device must accept any interference received, including interference that may cause undesired operation.



Made in China

FC10 美英说明书 V2 版_25.8.15 (GPSR 页认证标志更新)

尺寸: 105*140mm

材质: 128g 双铜 + 哑油

印刷: PANTONE 2018C +K

装订方式: 折页