

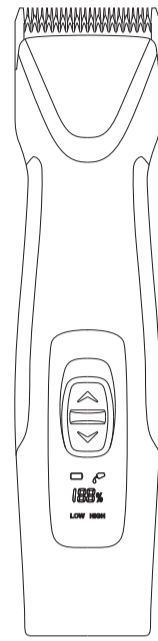

Professional Dog Clippers



User Manual
Model: PC14

Use Precautions

- Before use, be sure to add oil to the blade. The product packaging includes oil for maintenance, you can purchase additional clipper oil from the website. During use or charging, the machine may get slightly warm, but it has no effect on the performance.
- Do not use gasoline, alcohol, or thinner to clean the machine.
 - As this may cause the machine to discolor.
 - You can wipe the clippers with diluted soapy water.
 - Do not use this product in the bathroom.
 - Do not charge in an environment where the indoor temperature is lower than 32°F (0°C) or higher than 104°F (40°C).
 - Please store it properly out of the reach of children.

01

Package List

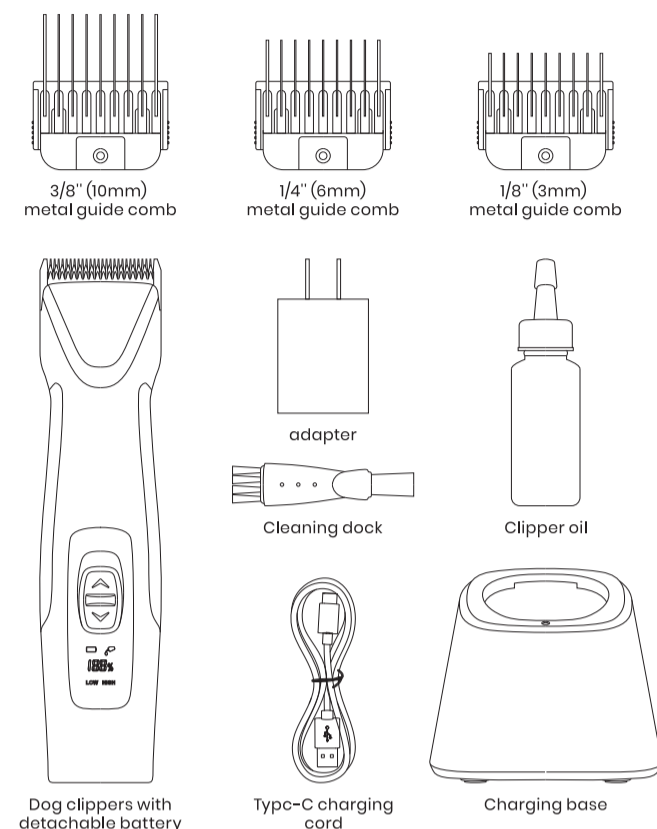

02

Specifications

Working Voltage:	7.4V
Battery capacity:	2000mAh
Charging Time:	3H with plug-in; 4H with charging dock
Working Time:	60-90 min
Input:	5V = 2A
Low Speed:	2800-3200 strokes per minute
High Speed:	3300-3700 strokes per minute

03

How to Use The Guide Combs

The metal limit combs help to keep 3 kinds of length after grooming.

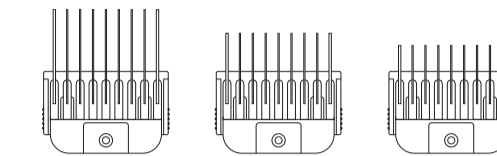

- Here are 1/8" (3mm), 1/4" (6mm), 3/8" (10mm) for option.
- Determine the desired hair length
 - Select a proper guide comb
 - Install the limit comb and disassemble it after use.

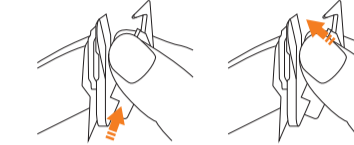

- Install the Guards**
- Step 1. Snag the metal sheet under the guide comb to the bottom of blades.
 - Step 2. Draw the comb upward until the guide comb tightens the groove on both sides of the blades.



- Take Off The Guards**
- Step 1. Push the guide comb upward.
 - Step 2. Remove the metal sheet under the guide comb from the blades.

04

LED Display

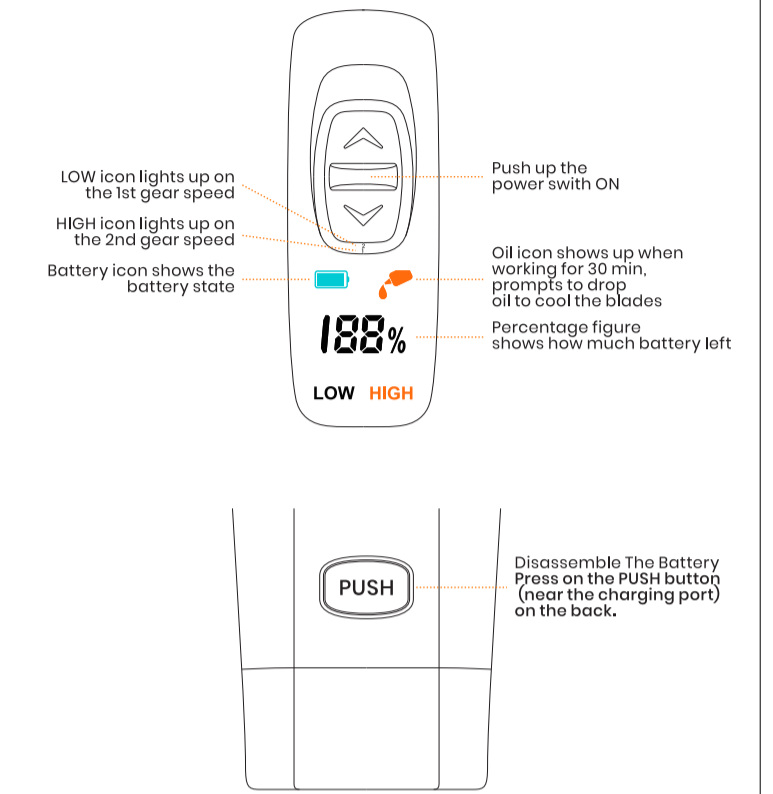

05

Blade Maintenance

How to Disassemble/Clean The Blades
1. Clean the blade with a cleaning brush.

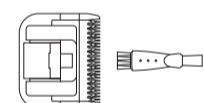

- Remove and install the blades as shown in the picture. Press the button on the back, the blades pop out.

Remove the Blade



Install the Blade

- When The Latch is Open

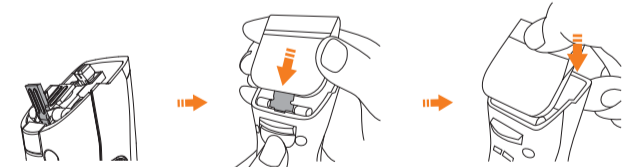

- When The Latch is Closed

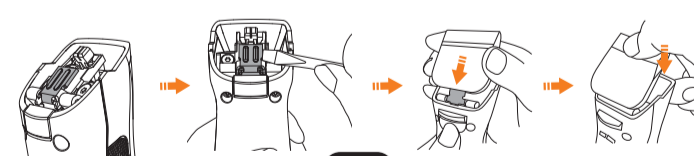

06

- Drop oil on the tip of the blades before you use the clippers and after grooming work.

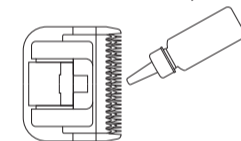

Charging Indication

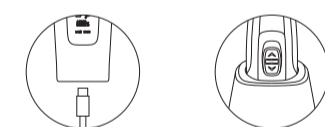

Plug the charging cord to the Type-C port, or push the clippers on the charging dock.



Charging Icon on LED Display

- Red battery icon flashes: the battery is very low, left 0-10%.
- Orange battery icon lights up: the battery is quite low, left 11%-20%.
- Green battery icon lights up: 100% battery level.

Lights on The Charging Dock

- Green light: Clippers or battery is 100% charged on the dock.
- When plug in the cord, the charging dock shows green light at the first time, and then shows red light.
- In any other case, the red light is on.

07

Failure Troubleshooting

Failure	Troubleshooting
Product Heating During Use	It is normal for the product to warm up during operation.
Product Not Working	If the product fails to operate, please check the battery or contact customer service.
Battery Failure	If the battery is damaged, please replace it or contact customer service.
Product Heating During Use	Clean the debris from the blade head using a cleaning brush and water. After cleaning, apply oil to the blade. If the problem persists, please contact support@oneisall.com
Charging Issues	The product may not charge properly if the charging environment is too hot or too cold.
Optimal Charging Temperature	Please charge the product in an environment between 41°F and 104°F (5°C and 40°C).
Liquid is poured or splashed into the charging base	Tilt the charging base back to allow liquid to drain from the bottom of the base (adding an automatic leakage hole), and allow the base to dry before continuing to use.

08

Warranty Information

Oneisall offers a standard 2-year warranty. If you have any issues with your Oneisall product, please do not hesitate to contact us. Be sure to include your proof of purchase, model number, and any relevant photos or videos in your message to expedite the process. Our Oneisall support team is available 7 days a week and will respond to your inquiry within 24 hours. Thank you for choosing Oneisall.

Please note that the Oneisall warranty does not apply to used products or purchases made from unauthorized sellers. It's important to be aware that the warranty also does not cover consumable parts such as blades, guards, filters, brushes, and similar items. These parts may require regular replacement or maintenance.

- support@oneisall.com
- +1877-522-8578 (US) Mon-Fri 8am-5pm (PST)
- www.oneisall.com



09

GPSR Product Information



Name: Apex CE Specialists GmbH
 Add: Grafenberger Allee 277-287, 40237 Düsseldorf, DE
 Contact Person: Wells Yan
 Zip Code: 40237
 E-Mail: info@apex-ce.de
 Tel: +353212066339



Name: APEX CE SPECIALISTS LIMITED
 Add: 6f East Union Street, Manchester, England, M16 9AE
 Contact: Wells
 Tel: +441616371080
 E-Mail: info@apex-ce.com

GPSR-Manufacturer info:
 Business Name: Shenzhenbenfendianzishangwuyouxian-gongsi
 Manufacturer's Address: CN, 518000, Guangdong Sheng, Shenzhen, Longhua District, Minxin Community Bishui Longting Building 6 Unit, 7B
 Tel: +86 185 6587 6424
 E-Mail: topservice4u@hotmail.com

Product Name: Professional Dog Clippers
 Brand: Oneisall
 Product Model: PC14
 Rated Voltage: 7.4V
 Input: 5V = 2A



10

TRANSFORM HOW YOU PET
 Any problems you have, please contact us:
 support@oneisall.com



ON-D190

PC14 高端电推剪 美英说明书 -V1 版

单页尺寸: 60*150mm

材质: 128g 双铜 + 哑油

印刷: PANTONE 2018C +K

装订方式: 折页