

Check that you have all your parts and accessories.

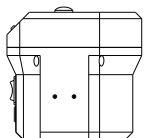

TVPJX3500 UNIT

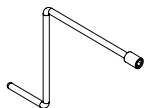

HAND CRANK

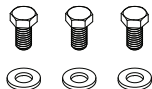

MOUNTING HARDWARE (3X)



CLEVIS PIN

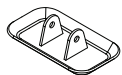

FOOT PLATE



MANUAL



TRAILER VALET PJX3500

Quick Start Guide

NOTE: For proper grounding, remove paint from around one mounting hole on the Jack and the matching mounting hole on the trailer tongue. If the paint is thick, add a washer (sold separately) between the jack and trailer to provide good contact.

Rev 03.20.25

1.

Remove footplate and insert jack through the coupling plate in the desired position.

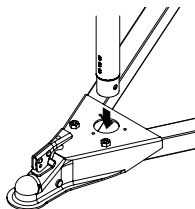

2.

Use the mounting hardware to secure the jack to the hitch coupling.

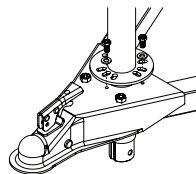

3.

Reinstall the foot plate onto the bottom of the jack.

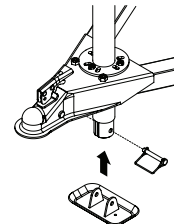

4.

Connect the power wires to the 12-volt trailer battery source: Red wire to the positive + battery terminal, Black wire to the negative (-) battery terminal.

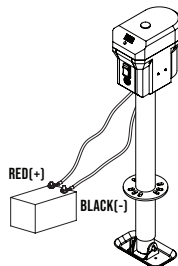

5.

POWERED OPERATIONS: Press the power button to turn on the jack. Use the up/down switch to raise/lower the jack.

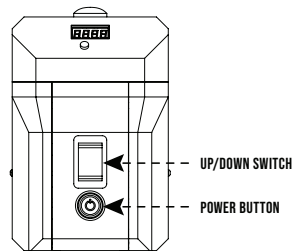

6.

MANUAL OPERATIONS: Disconnect the power and remove the rubber access cover. Insert the crank and rotate counter-clockwise to raise the trailer.

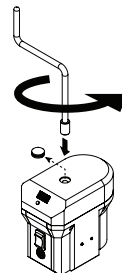

IMPORTANT SAFETY INFORMATION

For information and assistance, please visit our support page at TrailerValet.com or give us a call at (844) 846-9344. Scan the QR code to the right for detailed safety and usage information.



 **TRAILER VALET**

MOVE *FORWARD.*