



TVPJX3500

POWER JX3500

OPERATING MANUAL

Rev 08.28.25

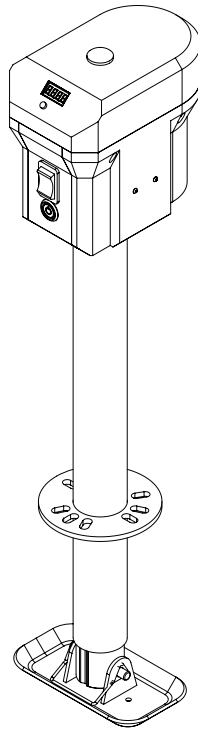

MOVE FORWARD.



WARNING

Carefully read and understand all the instructions before connecting your new Power JX3500.

Failure to follow these guidelines may result in serious injury to persons and property for which Trailer Valet will not be held liable. Do not allow persons to operate or assemble this unit until they have read this manual and have developed a thorough understanding of how the unit works.

THANK YOU FOR YOUR PURCHASE!

Congratulations on your purchase of the Trailer Valet Power JX3500. For your future reference, please complete the owner's record below:

Purchase Date: _____

Order No.: _____

Retailer: _____

Be sure to keep your receipt, owner's manual, and warranty information in a safe place.

TABLE OF CONTENTS

WARNING AND TABLE OF CONTENTS.....	2
IMPORTANT SAFETY INFORMATION & SPECIFICATIONS.....	3
ASSEMBLY.....	4
OPERATING INSTRUCTIONS.....	5-6
LIMITED MANUFACTURER'S WARRANTY.....	7

Phone: (844) 846-9344

Email: support@trailervalet.com

Website: www.trailervalet.com



IMPORTANT SAFETY INFORMATION

Failure to heed these warnings may result in personal injury and/or property damage:

1. Use caution when wiring the jack to a battery source. Connecting the jack backwards to the power source can cause damage to the electrical components of the jack.
2. Inspect the Power JX3500 before use. If there is any damage to jack, discontinue use and contact the factory.
3. Prior to use, ensure that the jack is securely connected to the trailer coupling.

Lift Capacity: 3,500 lbs

Product Weight: 25.1 pounds

Dimensions: 8.3" x 7.4" x 31.5 to 48"

Travel Range: 16.5"

Foot Plate Dimensions: 4.1" x 7.4"

Electrical Requirement: 12 VDC

Includes:

1. Rubber Access Cover
2. Digital Scale Display
3. Zero/Tare Button
4. Control Switch
5. Power Switch
6. Outer Tube
7. Mount Flange
8. Foot Plate
9. Clevis Pin
10. Hand Crank
11. Mounting Hardware (bolts and washers)

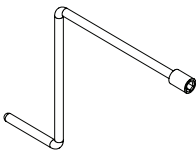

10



11

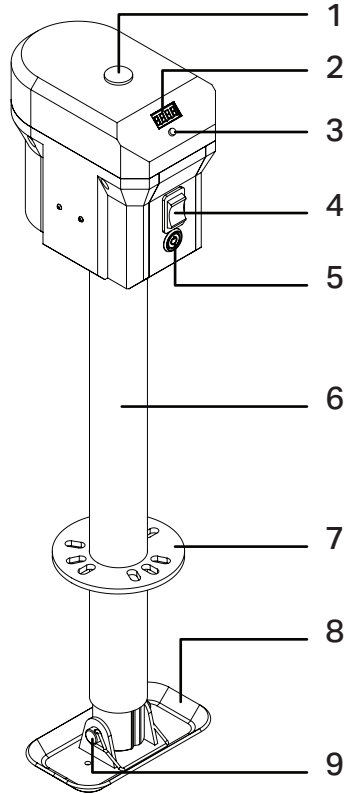

Upon removing items from packaging, it is very important to thoroughly inspect all parts of the system. Any part that is missing or damaged must be immediately replaced before using the device.

Contact Trailer Valet Customer Service at 1-844-846-9344 or Support@TrailerValet.com



ASSEMBLY

Prior to install, raise the trailer tongue until you have adequate space to attach the jack. The unit must be attached while the weight of the trailer is supported by an existing support or tow vehicle. Having wheel chocks in place during connection will ensure a safe install.

STEP 1: If the foot plate is installed on the bottom of the jack, remove it so the jack fits through the hole in the hitch coupling.

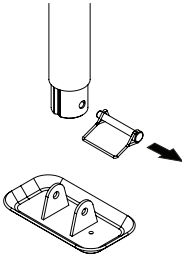

STEP 2: After the jack is inserted into the coupling, position the front of the jack in the desired direction.

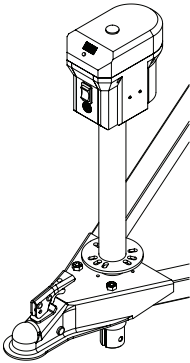

STEP 3: Once the jack is in the correct position, use the mounting hardware to secure the jack to the hitch coupling.

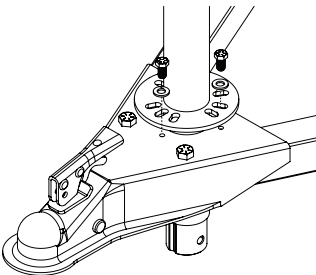

STEP 4: Reinstall the foot plate onto the bottom of the jack.

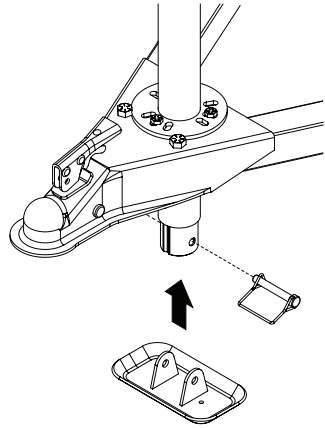

STEP 5: Connect the power wires to the 12-volt trailer battery source: Red wire to the positive + battery terminal, Black wire to the negative (-) battery terminal.

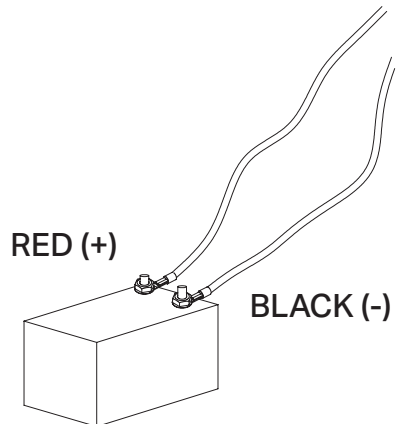



OPERATING INSTRUCTIONS

POWERED OPERATION

STEP 1: Press the power button to turn on the jack. The LCD screen for the scale will now turn on and go through a brief initialization check.

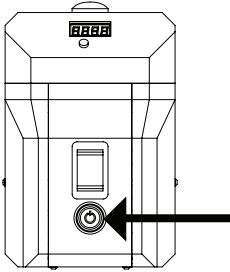

STEP 2: Use the up/down switch to raise/lower the jack.

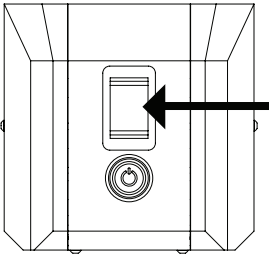

STEP 3: After use, press the power button to turn off the jack.

STEP 4: Before towing, raise the jack all the way up to provide maximum ground clearance.

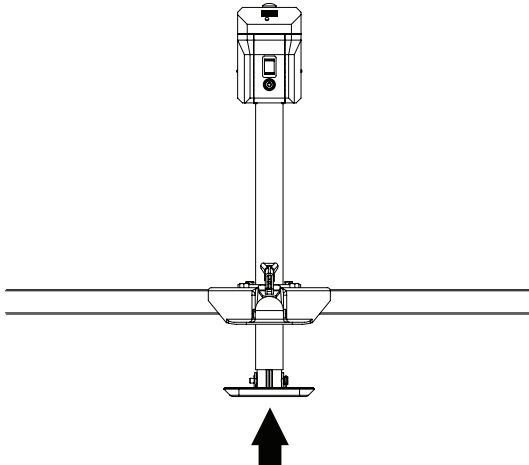

MANUAL OPERATION

STEP 1: Remove the rubber cover at the top of the jack and insert the crank handle.

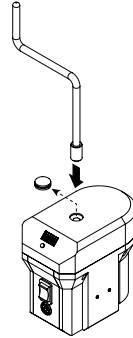

STEP 2: Turn the handle clockwise to lower the jack and counterclockwise to raise it.

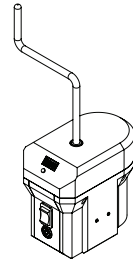



OPERATING INSTRUCTIONS

SCALE OPERATION

STEP 1: As soon as any weight is supported by the jack, the scale will display the weight in pounds.

STEP 2: If there is no weight being supported by the jack and the scale is not reading zero (plus or minus two pounds), press the button under the scale display to zero (tare) the scale.

STEP 3: If the scale reading is still inaccurate and cannot be zeroed, contact Customer Service.

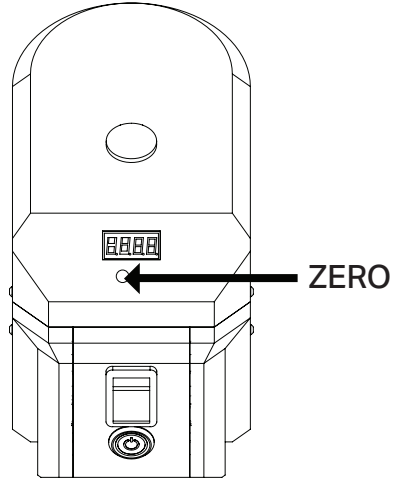

WIRING

Connect the RED wire lead from the jack directly to the positive (+) terminal on the battery.

Then, connect the BLACK wire to the negative (-) terminal on the battery or ground location such as the trailer frame.

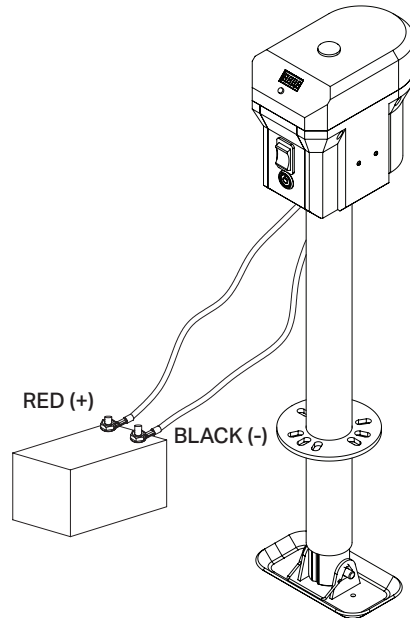

STORING THE DEVICE (IF APPLICABLE)

If the jack will be removed from the trailer for storage, cover it and store it in a cool, dry place.



LIMITED MANUFACTURER'S WARRANTY

Trailer Valet warrants for one year from the purchase date, that the product will be in working condition and will be free from manufacturing defects, provided that installation and use of the product is in accordance with product instructions. This warranty is only made to the original consumer purchaser and is not transferable.

ALL OTHER WARRANTIES ARE HEREBY DISCLAIMED.

THIS WARRANTY DOES NOT COVER:

1. Normal wear and tear or normal aging of the product;
2. Consumable parts designed to diminish over time, unless failure occurred due to a manufacturing defect;
3. Cosmetic damage, including but not limited to scratches and dents;
4. Damage through accident, abuse, neglect, misuse, natural events, or other external causes;
5. Damage through misapplication, overloading, or improper installation;
6. Damage due to improper maintenance and repair;
7. Damage as a result from secondary shipping and handling; or
8. Product alterations.

LIMITATION OF LIABILITY:

EXCEPT AS PROVIDED IN THIS WARRANTY AND TO THE MAXIMUM EXTENT PERMITTED BY LAW, TRAILER VALET IS NOT RESPONSIBLE FOR ANY DIRECT, INCIDENTAL OR CONSEQUENTIAL DAMAGES OR INJURIES RESULTING FROM ANY BREACH OF WARRANTY OR CONDITION, INCLUDING BUT NOT LIMITED TO LOSS OF USE; LOSS OF REVENUE; LOSS OF ACTUAL OR ANTICIPATED PROFITS; LOSS OF BUSINESS; LOSS OF OPPORTUNITY; LOSS OF GOODWILL; LOSS OF REPUTATION; OR ANY DIRECT OR INDIRECT OR CONSEQUENTIAL LOSS OR DAMAGE WHATSOEVER CAUSED INCLUDING THE REPLACEMENT OF EQUIPMENT AND PROPERTY.

CUSTOMER RESPONSIBILITIES:

Customers may be required to provide proof of purchase date, respond to questions designed to assist with diagnosing potential issues and follow Trailer Valet's directions to make a claim on your warranty.

TO MAKE A WARRANTY CLAIM:

Contact us either through:

Phone: (844) 846-9344

Email: support@trailervalet.com

Office: 16021 Euclid Ave., Chino, CA, 91708

www.trailervalet.com

TRAILER VALET'S RESPONSIBILITIES:

1. We will try to assist you in operating or repairing your product.
2. If we determine a replacement part is necessary, we will send you a free replacement part.
3. If we determine a replacement will not resolve your problem, we may ask you to return your product to our warehouse. Upon receiving the product at our warehouse, Trailer Valet will inspect the product.
4. If we determine that the product has a manufacturing defect we will send you a replacement part. If replacement of the part or repair of the unit is not possible, Trailer Valet will send you a replacement product.
5. Customers who purchased the product from a third-party vendor are not eligible for a refund from Trailer Valet.

TRAILER VALET SHALL HAVE THE EXCLUSIVE RIGHT TO DETERMINE IF A UNIT IS COVERED UNDER ITS WARRANTY POLICY.

SEVERABILITY:

The invalidity, illegality or unenforceability of any provision of this warranty shall not render the other provisions invalid, illegal or unenforceable.

GOVERNING LAW AND JURISDICTION:

This warranty shall be governed by the laws of the State of California. The courts of California shall have the exclusive right to adjudicate any disputes arising under or in connection to this warranty.

Copyright 2025 by Supertech S. Corporation. All rights reserved. No portion of this manual or any artwork contained herein may be reproduced in any shape or form without the express written consent of Supertech S. Corporation.



For further information or if you have any questions, please contact:

SUPERTECH S. CORP.
Customer Service: (844) 846-9344
Email: support@trailer valet.com
WWW.TRAILERVALET.COM