



Get Started!



Welcome!

PetSafe® brand is devoted to making sure you and your pet have what you need to live your best life together. We know that safe pets make happy people. Before getting started, please take a moment to read through this important safety information. If you have any questions, please don't hesitate to contact us.

Hereinafter Radio Systems Corporation and any other affiliate or Brand of Radio Systems Corporation may be referred to collectively as "We" or "Us".

IMPORTANT SAFETY INFORMATION

Explanation of attention words and symbols used in this guide



This is the safety alert symbol. It is used to alert you to potential personal injury hazards. Obey all safety messages that follow this symbol to avoid possible injury or death.

⚠ WARNING

WARNING indicates a hazardous situation which, if not avoided, could result in death or serious injury.

⚠ CAUTION

CAUTION, used with the safety alert symbol, indicates a hazardous situation which, if not avoided, could result in minor or moderate injury.

CAUTION

CAUTION, used without the safety alert symbol, indicates a hazardous situation which, if not avoided, could result in harm to your pet.

⚠ WARNING

- Do not use this product if your pet is aggressive or is prone to aggressive behavior. Aggressive pets can cause severe injury and even death to their owner and others. If you are unsure whether this product is appropriate for your pet, please consult your veterinarian or a certified trainer.
- This device contains Lithium-Ion (Li-Ion) batteries; never incinerate, puncture, deform, short circuit, or charge with an inappropriate charger. Fire, explosion, property damage, or bodily harm may occur if this warning is not followed.

⚠ CAUTION

- It is vitally important that you and your pet remain safe while learning during on-leash training. Your pet should be on a strong leash, long enough for him to attempt to chase an object, but short enough for him not to reach a road or other hazard. You must also be physically strong enough to restrain your pet when he tries to chase.
- This pet training device is not a toy, keep away from children.

CAUTION

- Proper fit of the collar is important. A collar worn for too long or made too tight on the pet's neck may cause skin damage ranging from redness to pressure ulcers. This condition is commonly known as bed sores.
- Avoid leaving the collar on the dog for more than 12 hours per day.
- When possible reposition the collar on the pet's neck every 1 to 2 hours.
- Regularly recheck the fit to prevent excessive pressure; follow the instructions in this quick start guide.
- You may need to trim the hair in the area of the contact points. However, never shave the dog's neck; this may lead to a rash or infection.
- Never connect a leash to a collar with contact points. It will cause excessive pressure on the contact points.
- When connecting a leash to a separate collar, do not allow it to put pressure on the training collar.
- Wash the dog's neck area and the contacts of the collar weekly with a damp cloth.
- Examine the contact area daily for signs of a rash or a sore.
- If a rash or sore is found, discontinue use of the collar until the skin has healed.
- If the condition persists beyond 48 hours, see your veterinarian.
- For additional information on bed sores and pressure necrosis, please visit our website.
- This product is only for use with healthy pets. If you're not certain that your pet is in good health, we recommend that you take your pet to a veterinarian before using this product.

Basic Dog Trainer

with Remote

What you have:

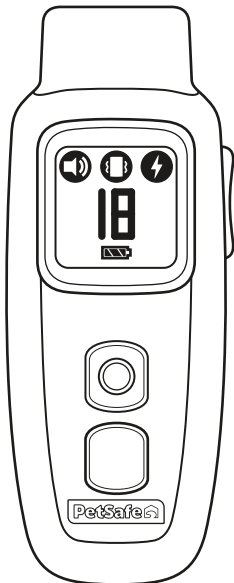

Remote

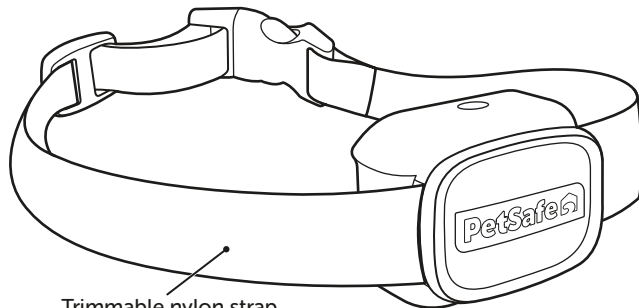

Trimmable nylon strap

Collar
with medium contact points

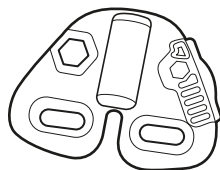

Test light tool



Long contact points

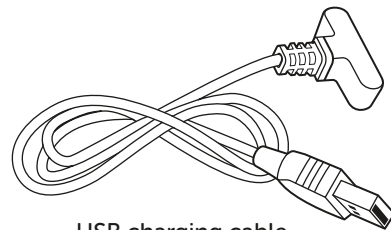

USB charging cable

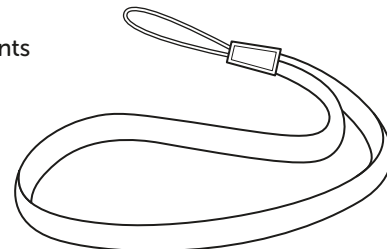

Wrist strap

Let's bring out the best in your best friend.

Charge the collar and remote

1

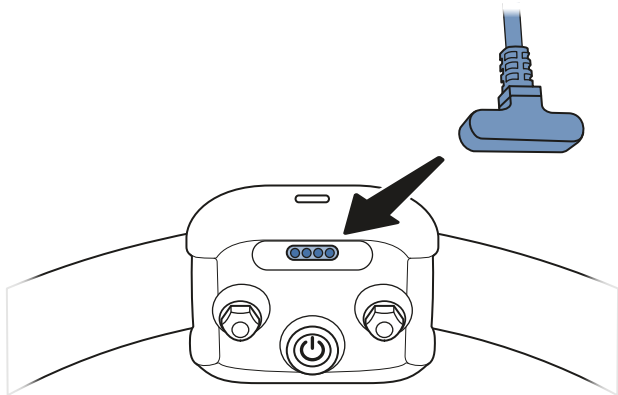

Connect the USB charging cable to the magnetic charging port on the back of the collar and then plug it into a USB power outlet. Leave the collar plugged in until fully charged; this will take about 2 hours.

The LED on the top of the collar will glow solid green when the collar is charging and will start flashing green when the collar is fully charged.

Each charge can last up to 20 hours, depending on frequency of use. To maximize battery life, turn off the collar when not in use.

2

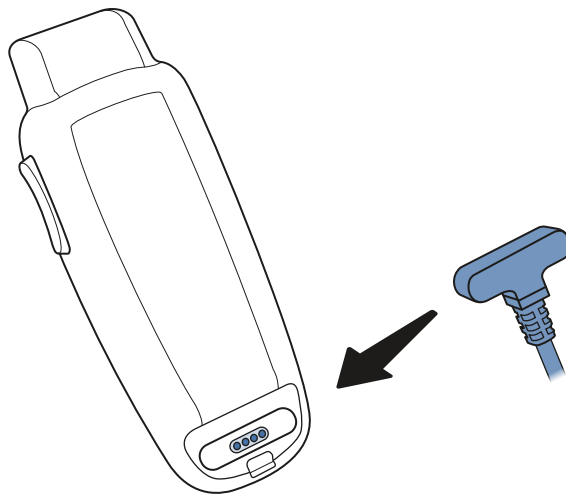

Once the collar is done charging, charge the remote.

Connect the USB charging cable to the magnetic charging port on the back of the remote and then plug it into a USB power outlet. Leave the remote plugged in until fully charged; this will take about 2 hours.

The battery icon () on the remote will appear full when the remote is fully charged. The remote is always on, but the display turns off automatically when not in use. Press any button to wake the display.

Each charge can last up to 20 hours, depending on frequency of use.

Test the trainer

3

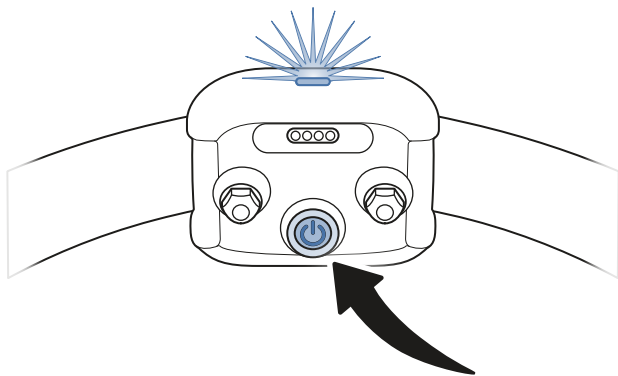

Once the collar is fully charged, turn it on by pressing and holding the power button until the collar beeps low to high and the LED on the top of the collar flashes green.

4

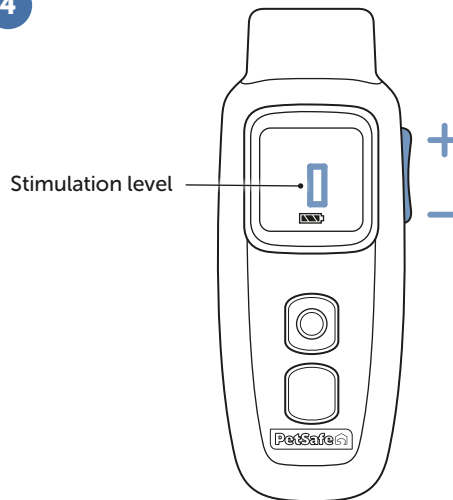

Press any button on the remote to wake the display.

The number shown at the center of the display is the current stimulation level. Use the rocker switch on the right side of the remote to change the stimulation level. Level 0 is vibration only; levels 1 through 8 are increasing levels of static stimulation.

5

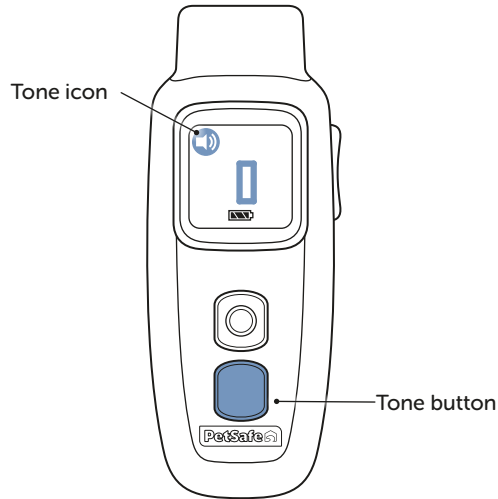

To deliver a tone, press and hold the tone button.

The collar will tone and the remote will display the tone icon (🔊).

Important: The collar and remote are paired to one another during manufacturing. Should the collar and remote lose their pairing at any time, visit support.petsafe.com for re-pairing instructions.

6

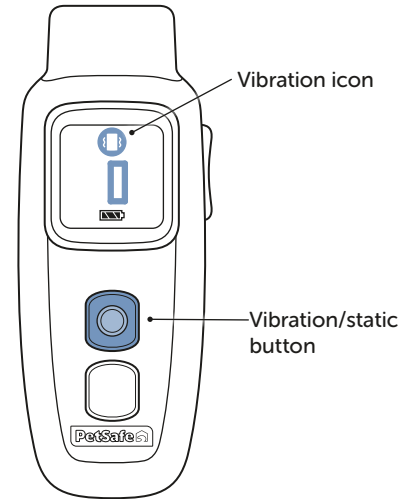

To deliver a vibration, set the stimulation level to 0 (vibration only) and then press and hold the vibration/static button.

The collar will vibrate and the remote will display the vibration icon (🔊). There is only one level of vibration.

7

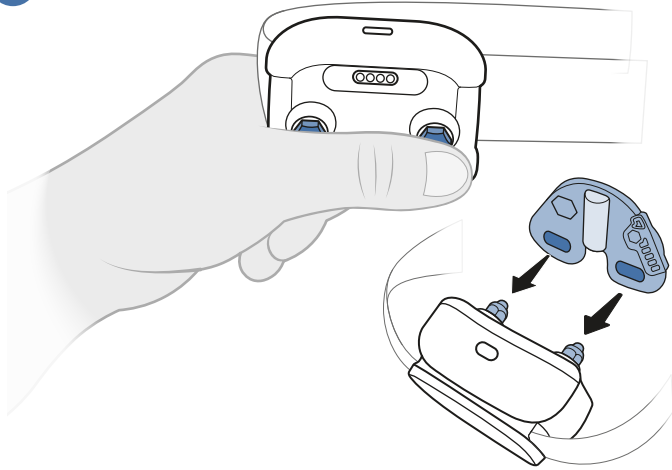

We recommend you experience firsthand how static stimulation functions. Start at the lowest level.

- a. Place one finger over both contact points of the collar.

Optional: To test the collar without feeling the static stimulation, hold the collar contact points against the wires on the provided test light tool. When the collar delivers a static stimulation, the LED on the test light tool will illuminate.

- b. Set the stimulation level to 1 (the lowest level of static stimulation).

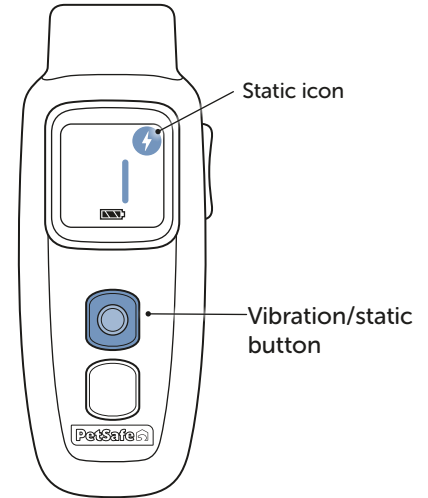

- c. Press and hold the vibration/static button for 1 to 2 seconds.

A static stimulation will be delivered to the collar and the remote will display the static icon (⚡). At this level you may not feel the stimulation.

- d. Repeat the previous steps, increasing the stimulation level each time, until the sensation begins to feel uncomfortable.

Important: Continuous stimulation is limited to 10 seconds. To deliver a longer stimulation, release and re-press the vibration/static button.

Fit the collar

8

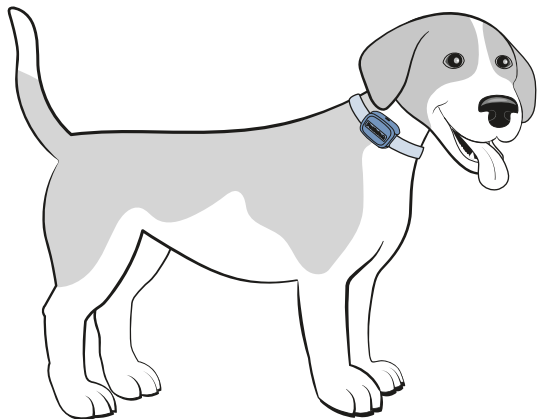

Now that you are familiar with how the trainer works, it's time to fit the collar to your dog.

First, turn off the collar by pressing and holding the power button until the collar beeps high to low and the LED glows red and then turns off.

With your dog standing comfortably, place the collar high around his neck, close to his ears. The contact points should be on the side of your dog's neck, touching his skin. If your dog has long or thick hair, it may be necessary to switch to the long contact points provided or trim (not shave) the hair around the contact points to make sure that contact is consistent.

Important: Check the tightness of the collar by inserting one finger between the end of a contact point and your dog's neck. The fit should be snug but not constricting. If your dog shakes his head after fitting, the collar should not move. Recheck the fit of the collar frequently as your dog becomes comfortable wearing it.

Once you are satisfied with the fit of the collar, remove it from your dog and trim the excess strap, making sure to allow room for growth or a thicker winter coat. Seal the cut end of the strap with a lighter to prevent fraying.

Important: Do not leave the collar on your dog for more than 12 hours a day, and never attach a leash to it — use a separate collar or harness for that. See the beginning of this guide for more important safety information about how to fit and use the collar.

Find the best stimulation level for your pet

9

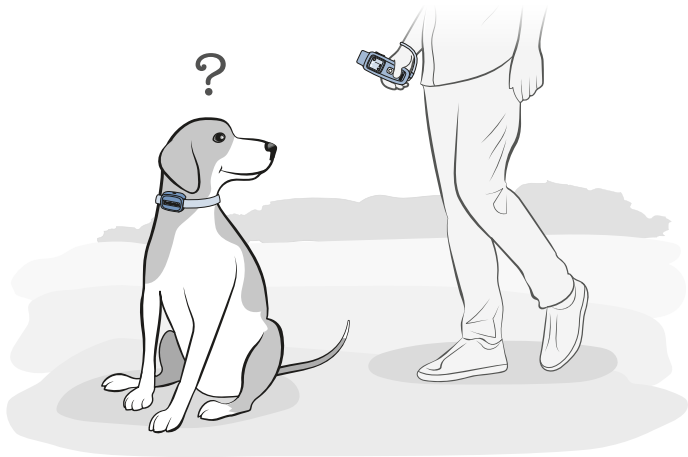

The next step is to find your pet's "recognition level." The recognition level is the lowest stimulation level that your dog begins to notice.

Important: Always start at the lowest stimulation level and work your way up.

- Turn the collar back on and place it on your dog.
- Take your dog to a calm environment where he is unlikely to be excited or distracted.

- Select level 0 on the remote and then press and hold the vibration/static button for 1 to 2 seconds. Watch your pet for a reaction.

Important: You are looking for a very slight reaction such as your dog twitching his ears or picking up his head and looking around. Your dog should not vocalize or panic when receiving a stimulation. If this happens, the stimulation is too high and you need to go back to the previous level.

- If your pet shows no reaction to the vibration, move on to static stimulation. Select level 1 on the remote and then press and hold the vibration/static button for 1 to 2 seconds. Watch your pet for a reaction.
- If your pet shows no reaction, repeat this stimulation level several times before moving up to the next level.
- Continue moving up through the static levels until your pet reliably responds to the stimulation.
- If your pet continues to show no response at level 8, check the fit of the collar. You might also want to test it on your hand at a lower level to make sure the collar is working.

Once you've found your pet's recognition level, you're ready to start using the trainer. See the following page for some important training tips.

Important: Please note that during instances of high or extreme distraction, higher levels of stimulation may be required to get your dog's attention.

Training tips

If you are attempting to teach your dog a behavior, make sure your dog understands what you want before introducing static stimulation. You can do this using your dog's favorite treats. If your dog looks nervous, scared or confused after static stimulation, return to treat training until you are sure your dog understands the cue.

When to start training

To use the trainer, your dog should be at least 6 months old and at least 8 pounds. You can begin basic obedience training (without the trainer) as soon as you bring your puppy home.

Stopping unwanted behavior

The stimulation level should be enough to interrupt your dog and give you the ability to redirect your dog's attention to another behavior.

It's best if the behavior you redirect your dog to is incompatible with the unwanted behavior. For instance, if training your dog not to jump, having him sit instead is incompatible and will keep him from jumping.

Note: Using praise or treats immediately after the correct response is great for encouraging your dog to repeat the desired behavior, and can help strengthen the communication between you and your dog.

Collar conditioning

You don't want your dog to associate the training collar only with being corrected. While your dog is wearing the training collar, make sure to spend lots of time playing and letting your dog be a dog.

The importance of timing

Proper timing is essential for static training to be effective. You should apply the static stimulation immediately (within 2 seconds) of an undesirable behavior. This will help your dog make the association between the undesirable behavior and the static stimulation.

If your dog seems nervous, scared or confused after applying a static stimulation, stop using the stimulation and make sure your dog has learned an appropriate behavior that will remove the static stimulation and/or earn him a reward. For example, your dog should learn that heeling is a behavior that is acceptable and rewarding prior to being corrected for pulling on a leash. This will keep your dog from being confused and will give him the opportunity to better control the consequences.

Terms of Use and Limitation of Liability

1. **Terms of Use**

The use of this product is subject to your acceptance without modification of the terms, conditions and notices contained with this product. Use of this product implies acceptance of all such terms, conditions, and notices. If you do not wish to accept these terms, conditions, and notices, please return the product, unused, in its original packaging and at your own cost and risk to the relevant Customer Care location together with proof of purchase for a full refund.

2. **Proper Use**

Proper Use includes, without limitation, reviewing the entire Product Manual and any specific safety information statements. The specific temperament or size/weight of your pet may not be suitable for this product. If you are unsure whether this product is appropriate for your pet, please consult your veterinarian or certified trainer prior to use. For products used with pets where training is desired, Radio Systems Corporation recommends that these training products are not used if your pet is aggressive and accepts no liability for determining suitability in individual cases.

3. **No Unlawful or Prohibited Use**

This product is designed for use with pets only. This product is not intended to harm, injure or provoke. Using this product in a way that is not intended could result in violation of Federal, State or local laws.

4. **Limitation of Liability**

In no event shall Radio Systems Corporation or any of its associated companies be liable for (i) any direct, indirect, punitive, incidental, special or consequential damage and/or (ii) any loss or damages whatsoever arising out of or connected with the use or misuse of this product. The Purchaser assumes all risks and liability from the use of this product to the fullest extent permissible by law.

5. **Modification of Terms and Conditions**

Radio Systems Corporation reserves the right to change the terms, conditions and notices governing this product from time to time. If such changes have been notified to you prior to your use of this product, they shall be binding on you as if incorporated herein.

6. **Limited Warranty**

This product has the benefit of a limited one-year manufacturer's warranty. Complete details of the warranty applicable to this product can be found online at <https://www.petsafe.net/support/policies-and-terms/return-and-warranty-information> and/or by contacting your local Customer Care Center at +1 (800) 732-2677, Radio Systems Corporation, 10427 PetSafe Way, Knoxville, TN 37932. Radio Systems Corporation disclaims all other express or implied warranties, including merchantability and fitness for a particular purpose.



Important Recycling Advice

Please respect the Waste Electrical and Electronic Equipment regulations in your country. This equipment must be recycled. At the end of the product life, do not place it in the normal municipal waste system. Please check the regulations in your area or return it to where it was purchased so that it can be placed in our recycling system.

Compliance

FCC

This device complies with part 15 of the FCC Rules. Operation is subject to the following two conditions: (1) This device may not cause harmful interference, and (2) this device must accept any interference received, including interference that may cause undesired operation.

NOTE: This equipment has been tested and found to comply with the limits for a Class B digital device, pursuant to part 15 of the FCC Rules. These limits are designed to provide reasonable protection against harmful interference in a residential installation. This equipment generates, uses, and can radiate radio frequency energy and, if not installed and used in accordance with the instructions, may cause harmful interference to radio communications. However, there is no guarantee that interference will not occur in a specific installation. If interference does occur to radio or television reception, which can be determined by turning the equipment off and on, the user is encouraged to try to correct the interference by one or more of the following measures:

Reorient or relocate the receiving antenna.

- Increase the separation between the equipment and the receiver.
- Connect the equipment to an outlet on a circuit different from that to which the receiver is connected.
- Consult customer care, the dealer, or an experienced radio/TV technician for help.

CAUTION: Modification or changes to this equipment not expressly approved by Radio Systems Corporation may void the user's authority to operate the equipment.

RF warning for Mobile device:

This equipment complies with FCC radiation exposure limits set forth for an uncontrolled environment. This equipment should be installed and operated with minimum distance 20 cm between the radiator and your body.

Basic Dog Trainer

with Remote



We're here to help!

For questions or additional tips:
support.petsafe.com