

USER MANUAL

PIONEER LITE / PACER LITE / VOYAGER

1.The LCD Display Interface

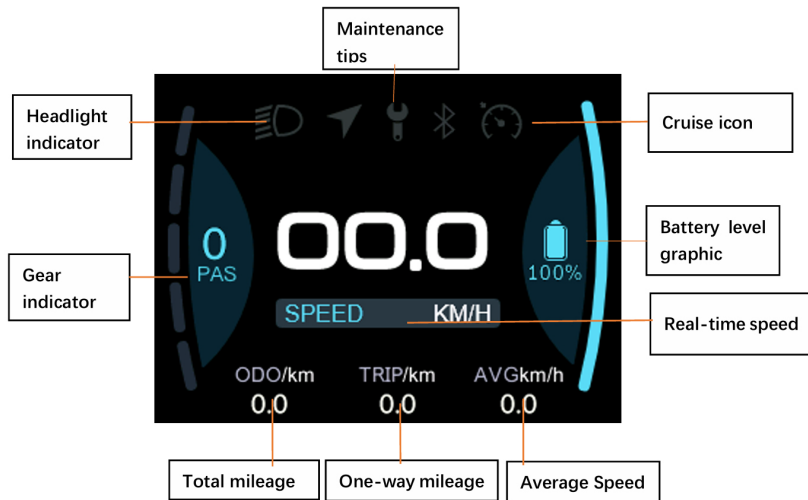

- **Headlight Status:** Shows whether the headlight is on or off. The icon appears when the headlights are on and disappears when they're off.
- **Maintenance Reminder:** Displays a symbol for when maintenance is due.
- **Battery Status:** Provides a real-time indication of the battery level.
- **Current Speed:** Shows the rider's current speed.
- **Gear Indicator:** Displays the gear the bike is currently in.
- **Trip Mileage:** Displays the distance traveled during the current ride.
- **Odometer:** Shows the total accumulated distance the bike has traveled.
- **Average Speed:** Shows the average speed for the current ride.
- **Cruise Control:** The cruise control icon lights up when the Cruise function is engaged.

2.Button Functions

The Pioneer Lite / Pacer Lite / Voyager models each feature three buttons: the Power Button, the Increase Button, and the Decrease Button. The functions of these buttons are defined as shown in the diagram below:



3.Standard Operations

For ease of reference in the following instructions, the terms will be abbreviated as follows:

"Press and hold the button for >2.5 seconds" will be shortened to "long press."

"Press the button for <0.5 seconds" will be shortened to "tap."

① Power On/Off

To turn on the instrument, press and hold the Power Button. Once powered on, the device will begin operating.

To turn off the instrument, press and hold the Power Button again while it is on.

In the off state, the instrument's leakage current is less than 1 μ A. Refer to the figure below for the startup interface.

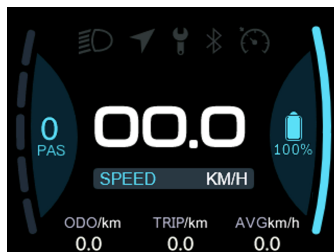

② Gear Level Selection

After powering on and entering the main display, use the "+" or "-" buttons to increase or decrease the gear level. This adjusts the motor's output power.

The default gear range is 0–5 (customizable):

Gear 0: No power output.

Gear 1: Lowest power (default setting at startup).

Gear 5: Highest power.

Refer to the figure below for the gear level selection screen.



③ Headlight/Backlight Switch

Turn On the Light: When the light is off, press and hold the "+" button. The headlight icon on the screen will light up, and the controller will activate the light.

Turn Off the Light: When the light is on, press and hold the "+" button. The headlight icon on the screen will dim (but not disappear), and the controller will turn off the light.

Refer to the figure below for the headlight switch display interface.



4.Settings Instruction

① Accessing the Settings Menu

Press and hold the "+" and "-" keys simultaneously to enter the Settings Menu.

Use the "+" or "-" buttons to move the cursor up and down through the menu options.

Select a menu option by highlighting it, then press the Power Button to confirm your selection.

Refer to the figure below for the interface layout.

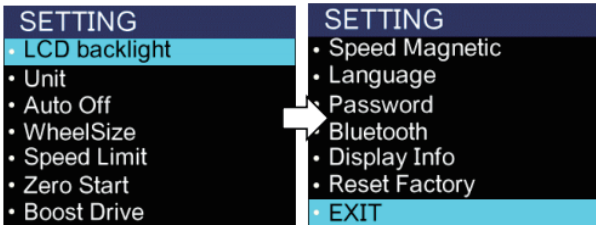

② Backlight Level Adjustment

Enter the Backlight Level menu. The default backlight setting is 50%.

Use the "+" or "-" buttons to adjust the backlight level to 10%, 30%, 50%, 75%, or 100%.

Press the Power Button to save your selection and exit the menu.

Refer to the figure below for the backlight level interface.

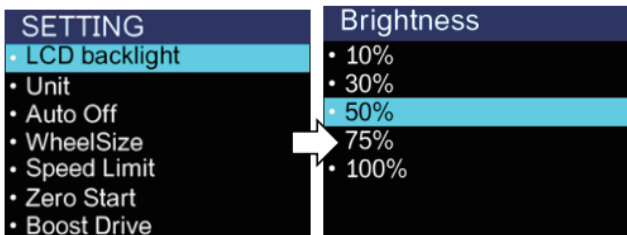

③ Unit Switching

Enter the Units menu.

Use the "+" or "-" buttons to toggle between Metric and Imperial units.

Press the Power Button to save your selection and return to the menu.

Refer to the figure below for the unit switching interface.

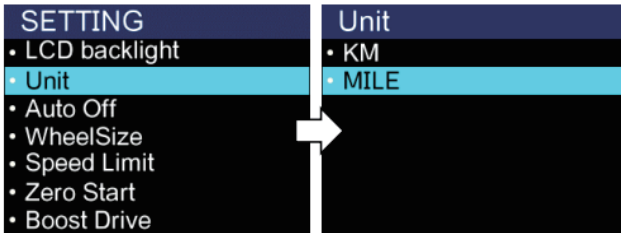

④ Automatic Shutdown Settings

Enter the Auto Shutdown menu. The default shutdown time is 10 minutes.

Use the "+" or "-" buttons to adjust the shutdown time between 0–60 minutes:

0: Disables the auto-shutdown function.

1–60 minutes: Sets the auto-shutdown timer.

NOTE:

The auto-shutdown function is disabled when the device is connected to the BIKEGO App via Bluetooth.

The timer only begins counting down after the bike stops moving.

Any interaction with the device resets the auto-shutdown timer.

Refer to the figure below for the auto-shutdown interface.

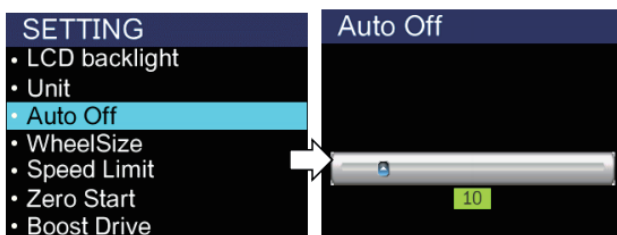

⑤ Wheel Diameter Settings

Enter the Wheel Diameter menu. The default setting is 28 inches. Use the "+" or "-" buttons to adjust the wheel diameter between 10.0–30.0 inches.

Refer to the figure below for the wheel diameter interface.

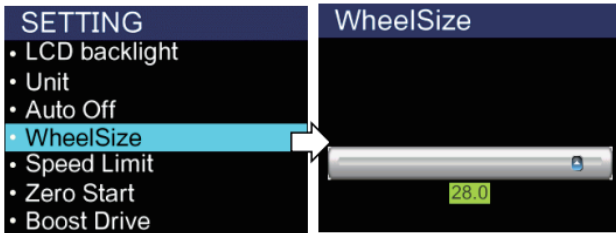

⑥ Speed Limit Settings

The default speed limit is 100 km/h.

Use the "+" or "-" buttons to adjust the speed limit between 1–100 km/h.

Refer to the figure below for the speed limit interface.

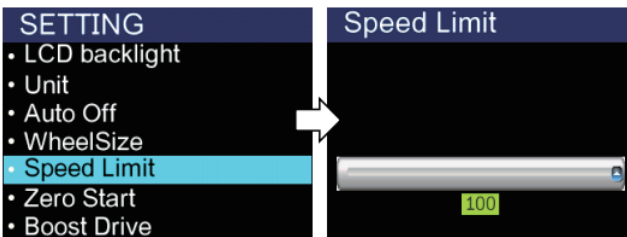

⑦ Zero Start Settings

The default setting is Zero Start On.

Use the "+" or "-" buttons to toggle between On and Off.

Refer to the figure below for the Zero Start interface.

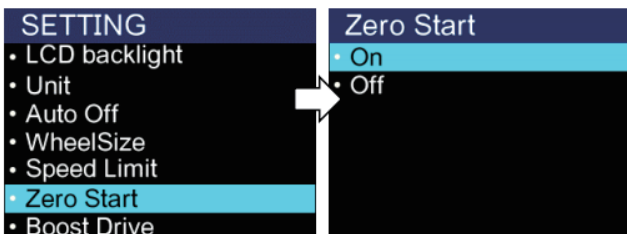

⑧ Cruise Control Settings

The default setting is Cruise Control On.

To Activate Cruise Control:

While riding at a speed greater than 20 km/h, press and hold the "-" button.

The cruise control icon will light up on the main display.

To Deactivate Cruise Control:

Press and hold the "-" button, or adjust the speed during cruise control. Refer to the figure below for the cruise control interface.

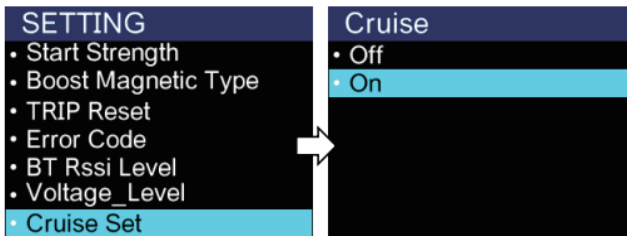

⑨ Language Settings

The default language is English.

Use the "+" or "-" buttons to switch between English, Spanish, and Chinese.

Refer to the figure below for the language settings interface.

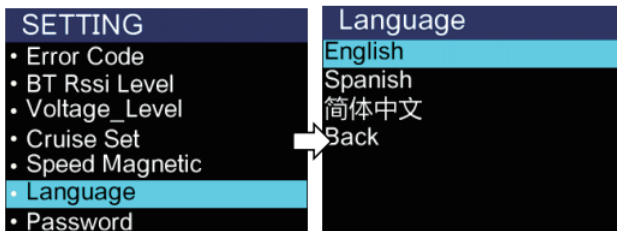

⑩ Password Function Settings

The password function is enabled by default, with the initial password set to 0510.

Use the "+" or "-" buttons to cycle through numbers (0–9). Press the Power Button to confirm each digit.

Follow the on-screen prompts to enable or disable the password function.

Refer to the figure below for the password settings interface.

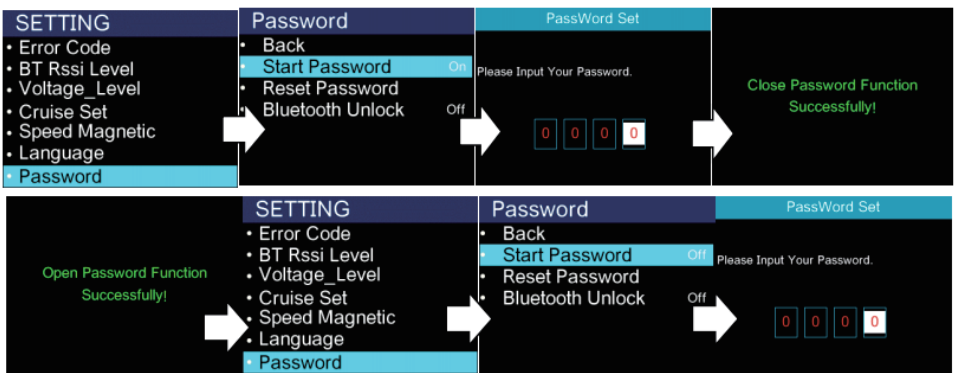

⑪ Modify Password

When prompted to "Enter your old password", use the "+" or "-" buttons to input the current password. Press the Power Button to confirm each digit.

When prompted to "Enter your new password", input the new password using the same method.

When prompted to "Confirm your new password", re-enter the new password.

NOTE:

If you enable the password function, you must set a new password after modification.

Avoid changing the initial password unnecessarily.

Refer to the figure below for the password modification interface.

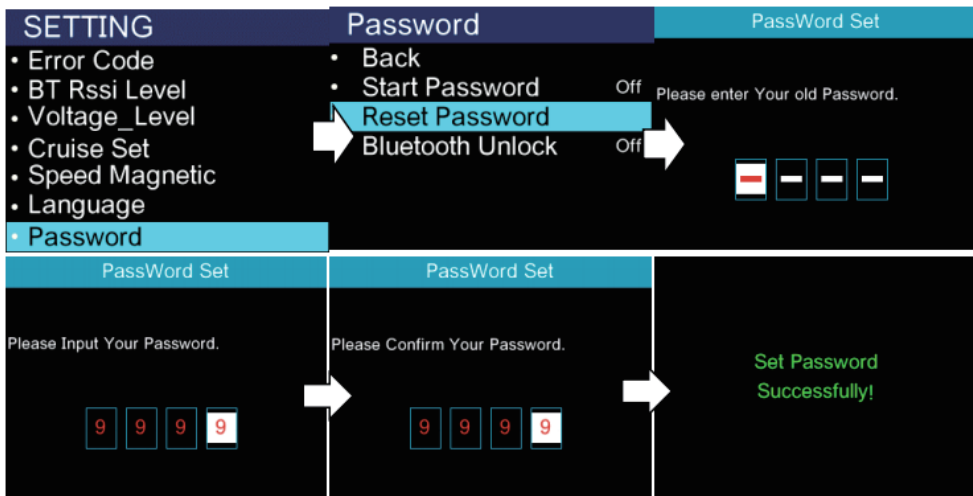

⑫ Factory Reset

Enter the Factory Data Reset menu.

Select Confirm and press the Power Button to reset the following settings to factory defaults:

- Backlight level
- Light sensitivity level (if applicable)
- Bluetooth distance level
- Language
- Theme (if applicable)
- Password settings

Select Cancel and press the Power Button to exit without resetting. Refer to the figure below for the factory reset interface.

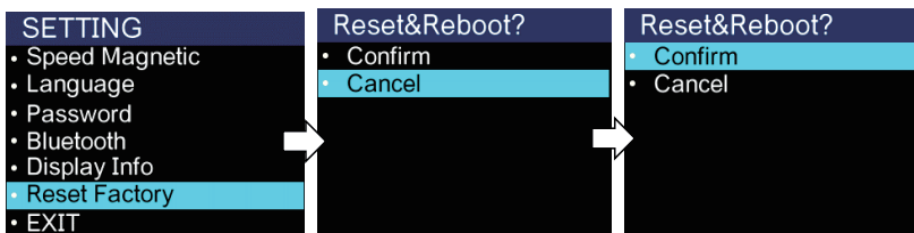

5. Error Codes List

Error code	Description of the fault	Troubleshooting methods
"04"	The speed control put has no homing	Check that the handle is in place
"05"	Speed regulation put failure	Check the handlebar
"06"	Undervoltage protection	Check the battery voltage
"07"	Overvoltage protection	Check the battery voltage
"08"	The motor Hall signal line is faulty	Check the motor module
"09"	Motor phase line failure	Check the motor module
"11"	Controller temperature sensor failure	Check the controller
"12"	Current sensor failure	Check the controller
"13"	Battery internal temperature failure	Check the battery
"14"	Temperature failure in the motor	Check the motor
"21"	Speed sensor failure	Check where the speed sensor is installed
"22"	BMS communication failure	Replace the battery
"30"	Communication failure	Check the controller connector