



MIXED FLOW INLINE FAN

Instruction Manual



Please read instruction manual carefully before use

Thank you for purchasing a DuraBreeze fan. We greatly appreciate your business and strive to deliver the best value in ventilation and horticultural equipment to our customers.

Package Contents:

- Mounting Bracket
- Instruction Manual

Operating Instructions:

- Remove any packaging material
- Check airflow direction indicated
- Plug into a power source
- Attached mounting bracket to fan

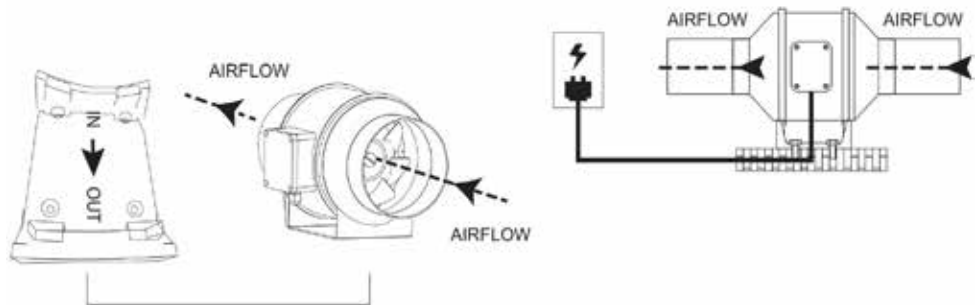

Operation in Ducts:

- This booster fan fits standard 4 inch, 6 inch and 8 inch air ducts.

Safety Precautions:

- Max temperature in the operating environment for this fan must not exceed 140° (60°C).
- Do not operate this fan if it appears to be malfunctioning or damaged please reach out to us for a replacement.
- Keep this fan away from children.
- Improper use will void manufacturer warranty.

Warning: These products should be installed by a qualified professional. Buyer acknowledges that by purchasing these products, buyer has special knowledge on installation and use of the product or has consulted a professional on the product's installation and use. In no event will the Company or any of its subsidiaries or their parent companies be liable to you for any direct, special, indirect, consequential, incidental damages or any damages of any kind even if the Company has been advised of possibility thereof.



Limited Warranty

What This Warranty Covers

This warranty covers defects in materials and workmanship under normal use, with the exceptions stated below.

Who This Warranty Covers

This warranty applies to the original purchaser of this product with the original proof of purchase.

How Long Warranty Coverage Lasts

This warranty is in effect for a period of 5 years from the original date of purchase.

What This Warranty Does Not Cover

This warranty does not cover damage or defects resulting from the improper installation, alteration, abuse, accidental damage, unauthorized repair or misuse of this product. Misuse includes but is not limited to outdoor use. This warranty does not apply to cosmetic defects or other defects that do not affect the functionality of the product, and is void if the product has been damaged as a result of fire, flood, or other natural disaster. DuraBreeze shall not be responsible for any incidental or consequential damages of any nature, including damage or injury caused to other products, machinery, buildings or property; loss of profits, time or product; or inconvenience. The original proof of purchase **MUST** accompany the DuraBreeze product for this warranty to be valid. This warranty is given in lieu of all other warranties, express or implied, including without limitation merchantability and fitness for a particular purpose.

Some states do not allow the exclusion or limitation of incidental and consequential damages, or limitations on how long an implied warranty lasts, so the above limitation(s) may not apply to you.

What DuraBreeze Will Do

If DuraBreeze determines the warranted product is defective in materials or workmanship during the warranty period, then DuraBreeze, at its option, will either repair or replace the product. In no event shall the cost of repair or replacement exceed the original purchase price.

How to Obtain Warranty Service

Return this product along with the original proof of purchase to the place of purchase in accordance with store policy.

How State Law Applies

This warranty gives you specific legal rights, and you may also have other rights which vary from state to state.

For technical support and warranty information, email info@durabreeze.com.