

OWNER'S MANUAL

25-Gallon 5-Nozzle Multi-Boom ATV Sprayer

Model: ATV-25-4ADM-5NMB-TSC
(5303851)

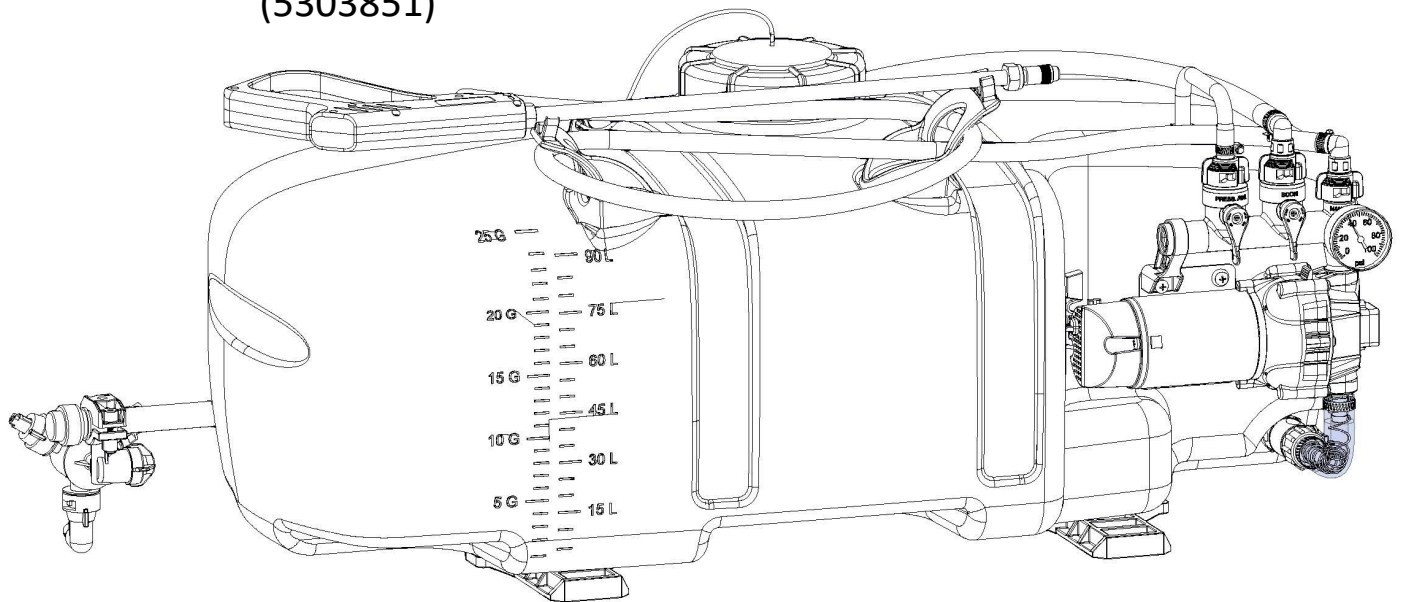

- Assembly
- Installation
- Operation
- Repair Parts

**BEFORE RETURNING THIS PRODUCT
FOR ANY REASON, PLEASE CALL**
MONDAY-FRIDAY, 8:00 AM to 5:00 PM CST

1-800-831-0027



WARNING: To reduce the risk of injury, the user must read and understand the operator's manual before using this product.



WARNING: Cancer and Reproductive Harm.
www.P65Warnings.ca.gov



www.fimcoindustries.com

1000 FIMCO Lane, P.O. Box 1700, North Sioux City, SD 57049
Toll Free Phone: 800-831-0027 : Toll Free Fax: 800-494-0440
[5196278 (02/26)]

**BEFORE RETURNING THIS PRODUCT
FOR ANY REASON, PLEASE CALL**

1-800-831-0027

MONDAY-FRIDAY, 8:00 AM TO 5:00 PM CST

If you should have a question or experience a problem with your Fimco Industries Product: Visit our website @ www.fimcoindustries.com or call the Toll free number above. Our technical support representatives will be happy to help you.

In most cases a customer service rep. can resolve the problem over the phone.

To obtain prompt, efficient service, always remember to give the following information...

- Correct Part Description and/or part number
- Model number and Serial Number

Part descriptions and numbers can be obtained from the illustrated parts list section(s) of this manual.

**Retain a copy of your receipt for your unit,
as it will be required to validate any
warranty service.**

**Warranted against manufacturer or workmanship defects
from date of purchase with copy of receipt:**

Homeowner Usage:

**Sprayer—One Year &
Pump: Two Year.**

Commercial Usage:

Sprayer & Pump: 90 Days.



Record your purchase information and attach a copy of your receipt to this manual.

Date of Purchase: _____

Purchased From: _____

Model: **ATV-25-4ADM-5NMB-TSC (5303851)**

Technical Specifications

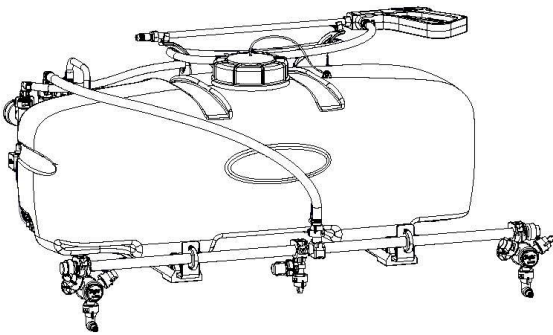

Model: ATV-25-4ADM-5NMB-TSC (5303851)

(25 Gallon Lawn & Garden/ATV Boomless Sprayer)

Technical Specifications

- 25 Gal. Corrosion-Resistant Polyethylene Tank
- 12 Volt Diaphragm Pump, 4.5 GPM - 60 PSI
- Deluxe Pistol Grip Handgun
- 20 Ft. Handgun Hose (3/8" I.D.)
- 28 Ft. Vertical throw, 40 Ft. Horizontal Throw
- 36 Foot Spray Coverage w/Boom
- Corrosion-Resistant Nozzles

This sprayer may be mounted to most makes of agricultural ATV vehicles.

CAUTION: When fully filled with water, this sprayer will weigh approx. 250 Lbs.

Always check the vehicle load rating before using this sprayer. Do not exceed the recommended rating.

Safety

- Use for intended purposes only.
- Wear protective clothing, eye protection and chemical resistant gloves when filling, using or cleaning this sprayer.
- Do not allow adults to operate without proper instruction or without having read the owner's manual.
- Always be aware of your surroundings when using. Do not let anyone near while operating any sprayer.
- Slow down before turning and be careful when backing up to avoid any damage to sprayer or your equipment.
- Clear the spray area of people and pets. Restrict access for a period recommended on chemical label.
- Clean up spills immediately per instructions on chemical label.
- Turn off sprayer and relieve any pressure before leaving sprayer unattended.
- Exercise special caution in handling and DO NOT exceed 10 MPH, 5 MPH is recommended at most. ATV/UTV is less stable and will perform differently with a filled sprayer. Exercise extreme caution on sloped or rough surfaces.

Contents of Sprayer Carton:

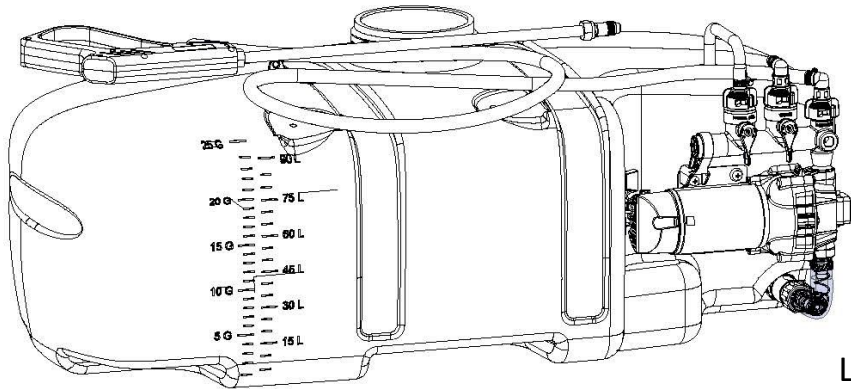

Tank/Plumbing Pre-Assembly

Owner's
Manual



Lid w/Lanyard

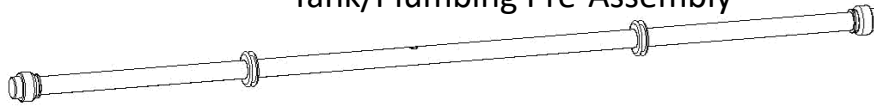
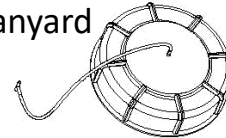

Wet Boom Tube Assembly

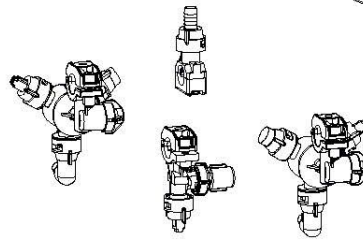

Wet Boom
Nozzle Bag
#5283397

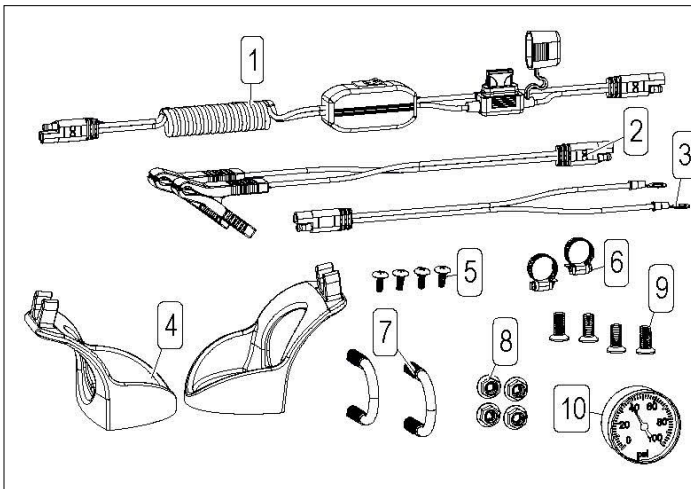

Contents of Parts Bag
#5283358

Ref. #	Part #	Description	Qty
1	5164336	60" 16AWG, Switched Lead Wire w/15 amp Fuse	1
1.1	5157238	15 Amp Regular Blade Fuse	1
2	5164333	36" 16AWG Battery Clamp Ends	1
3	5164334	36" 16AWG Ring Terminal Ends	1
4	5133275	20-Gallon Hose Wrap	2
5	5117234	#10-24 x 0.50 PH Truss Head Screw	4
6	5051114	Hose Clamp (3/8"-1/2")	2
7	5034220	5/16-18 x 1.3125 x 1.75 Round U-Bolt	2
8	5006307	5/16-18 Serrated Flng Hex Nut	4
9	5034149	5/16-18 x 0.75 PH Flat Head Screw	4
10	5167097	2" Dry, 100#, Back Mount Gauge	1

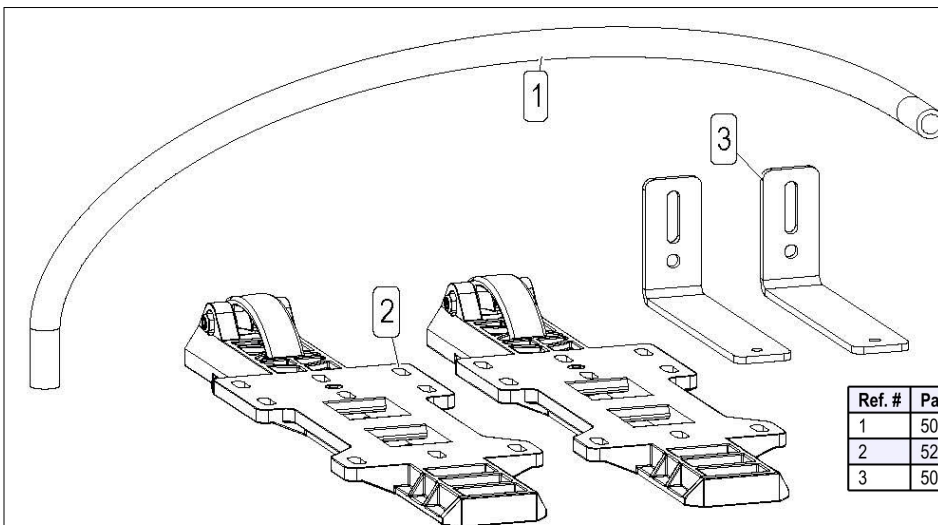

Contents of Bracket Kit
#5278138

Ref. #	Part #	Description	Qty
1	5020570	Hose, 1/2"-1 Brd. x 48"	1
2	5278222	ATV Quick Release Bracket Assembly	2
3	5038873-BLK	QR Boom Mount Bracket - Bent Fixed Height	2

Assembly Procedure

Step 1

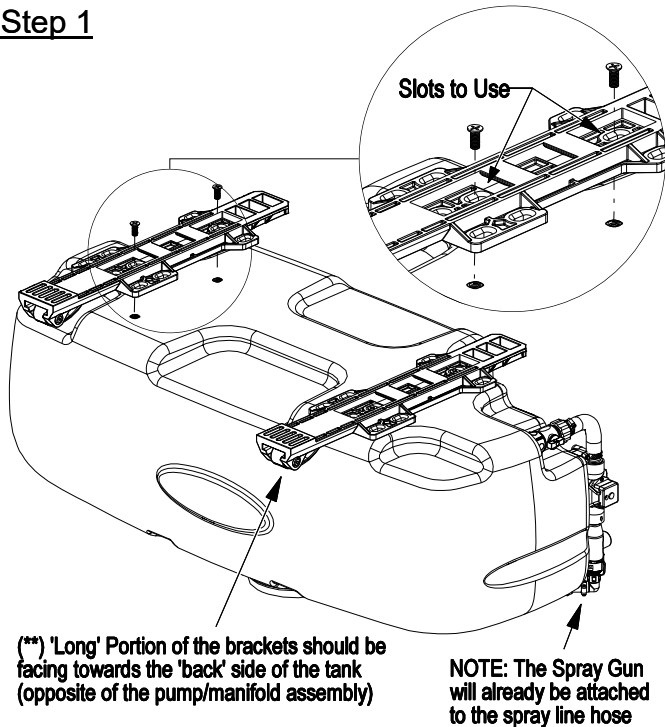

- Make sure the contents of the sprayer's carton match the items shown on page 3 of the manual.
- Follow the steps on pages 4,5 & 6 to properly assemble the sprayer.

Normally, the sprayer will be mounted on an ATV with the pump assembly at the operator's back. Right Hand (RH) and Left Hand (LH) sides of the sprayer are determined as if you are standing behind the sprayer, looking at it (facing forward)

After removing the tank from the box, start the assembly procedure by turning the tank upside down on a stable, flat surface.

A phillips head screwdriver is required for this step.

(**) Mount tank brackets to the underside of the tank as shown in Step 1. Use (4) flat head screws to secure it to the tank. The tank will rest on the surface of the brackets. Make sure the brackets are parallel with each other before tightening down the bolts. Do not over-tighten.

After your tank brackets are securely attached, turn the tank assembly over and position it so that the cam handles which extend beyond the back of the tank are facing you and just hanging over the edge of the table or flat surface you are assembling this on.

Secure the boom mounting brackets to the tank mounting brackets with Cam handles as shown in Detail A. You can position them as needed within the slot on the bracket. Just be sure that the surfaces of both brackets are even with each other.

You are now ready to mount this unit to an ATV, using ratchet straps (NOT INCLUDED)

Step 2

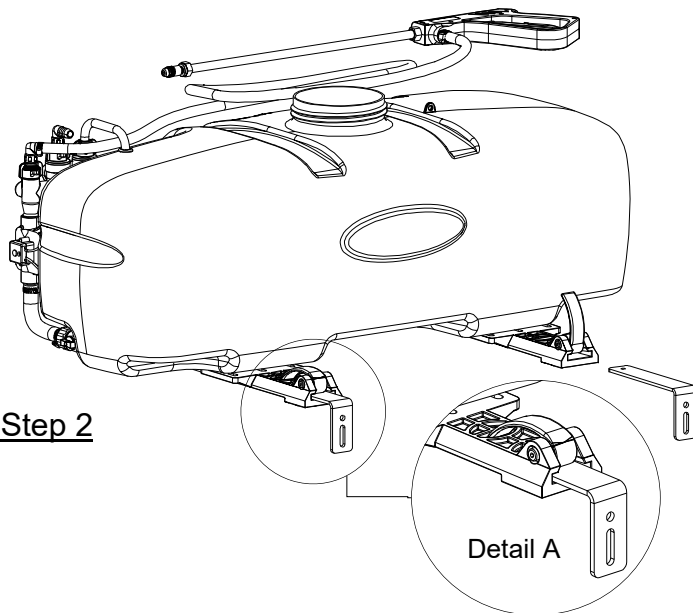

Attach boom to the mounting brackets with the (2) U-bolts and (4) whiz locknuts. Make sure the U-bolts are positioned within the grooves of the grommets on the boom tube

NOTE: The purpose of these grommets is to prevent metal-to-metal contact between the U-bolts, boom tube and boom mounting brackets.

The grommets will 'compress' as you tighten the whiz locknuts onto the U-bolts. Tighten just so that the boom tube will NOT rotate within the grommets. Alternate the tightening of the locknuts to provide even pressure on the grommet.

****DO NOT OVER TIGHTEN the whiz locknuts, as this may cause the boom tube to flatten slightly!**

Step 3

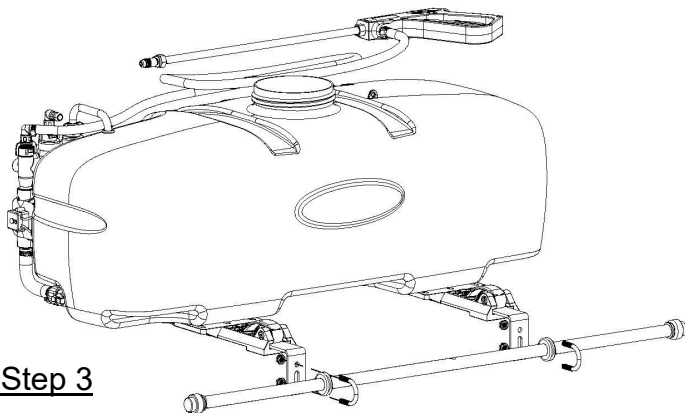

Important: Refer to next page for directions to attach the Boom Supply, Center w/Shutoff and both of the end Turrets to the boom.

Assembly Instructions:

Boom Assembly

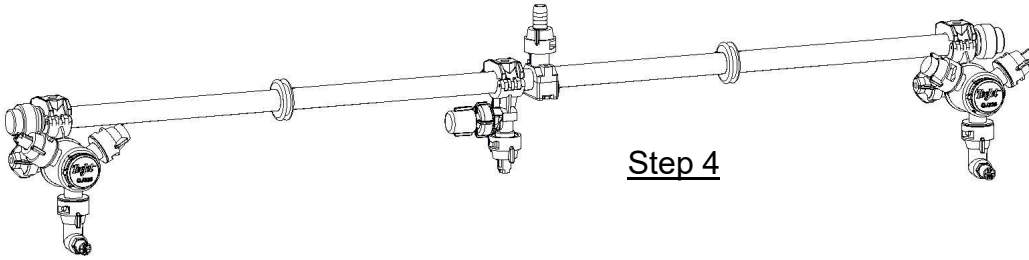

Step 4

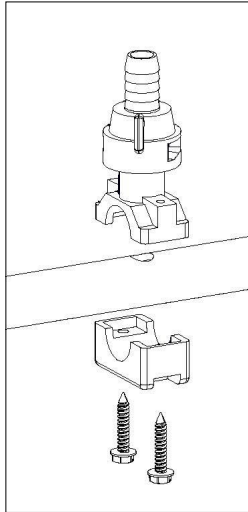

The boom tube will have 3 holes on one side and another hole on the opposite side.

The single hole will be the top and used for installing the Boom Supply, as seen to the left.

Once you have installed the Boom Supply, then install the Center w/Shutoff as seen to the left, using the center hole on the bottom of the tube.

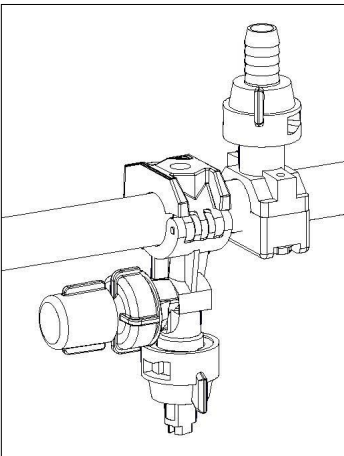

The knob on the side of the nozzle body is the on/off valve. Turning the knob clockwise will close the nozzle, and counter clockwise will open the nozzle.

The outer Boom Turrets can then be installed on each end of the boom tube, as seen to the right, using the holes to the outer end of the boom tube.

When installing the XP tips on to the adapters, they will thread into the 90 Degree Quick Cap Adapters. When threading the XP tips into the Adapters, DO NOT OVERTIGHTEN.

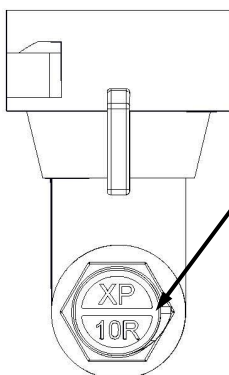
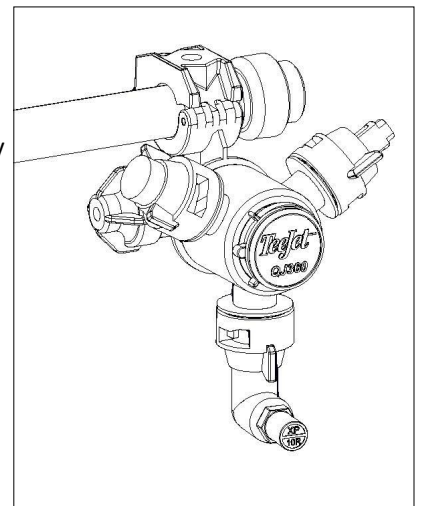

There is a line on the end of the XP tips, that should be turned in until that is horizontal.

Assembly Procedure

Step 5

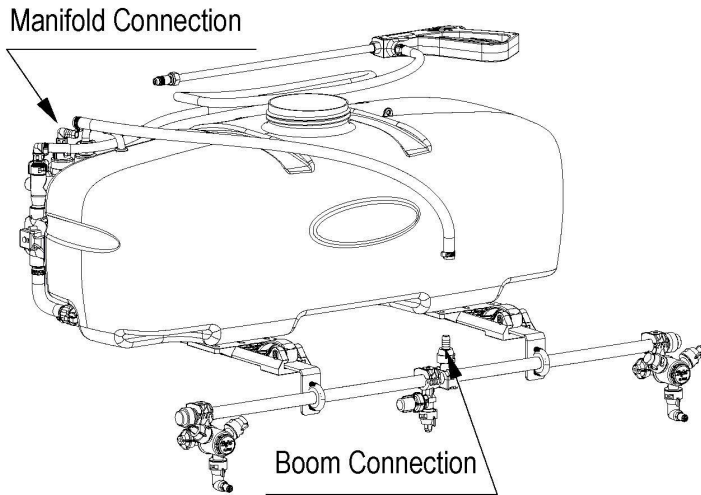

After your boom is attached, locate the 48" hose and the (2) hose clamps from the parts bag.

Place the hose clamps over each end of the hose loosely. Slip the ends of the hose over the hose barbs on both the manifold and on the center nozzle. Use a twisting motion, if necessary, to get the hose fully onto each barb. Bring the hose clamps to the connection point and tighten securely.

NOTE:

Make sure this boom feeder hose does not end up on the 'outside' of the spray wand hose, otherwise unwrapping the spray wand hose from around the tank may be difficult.

Detail A: Install the pressure gauge. Hand tighten securely. **** DO NOT OVER-TIGHTEN ****

Detail B: Screw the lid onto the tank. Place the end of the lanyard through the tab in the tank. This is so the lid can 'hang' off the tank when filling/rinsing the tank out.

Detail C: Locate (2) hose wraps and (4) PH screws from the parts bag.

A Phillips screwdriver is required for this step

Place a hose wrap on the tank and secure with two screws. Tighten so that the hose wrap is secure. Do this for each hose wrap.

**** DO NOT OVER-TIGHTEN ****

The spray wand will snap into the hose wraps once installed. Do not use excessive force when placing the spray wand into the clips on the hose wraps, as this could cause the them to break.

Step 6

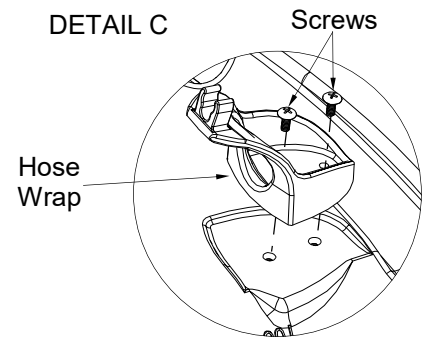
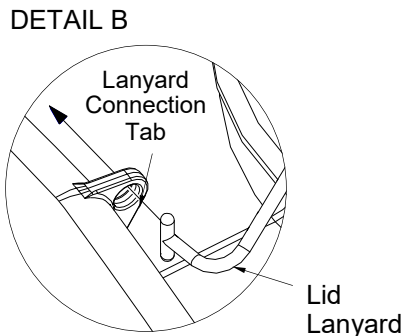
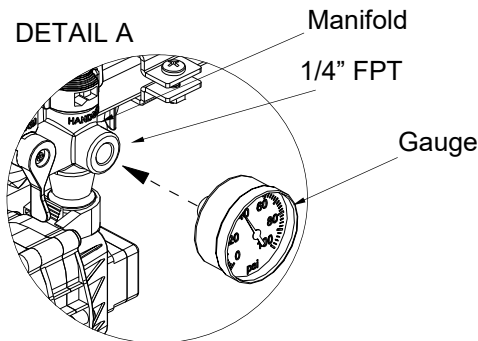
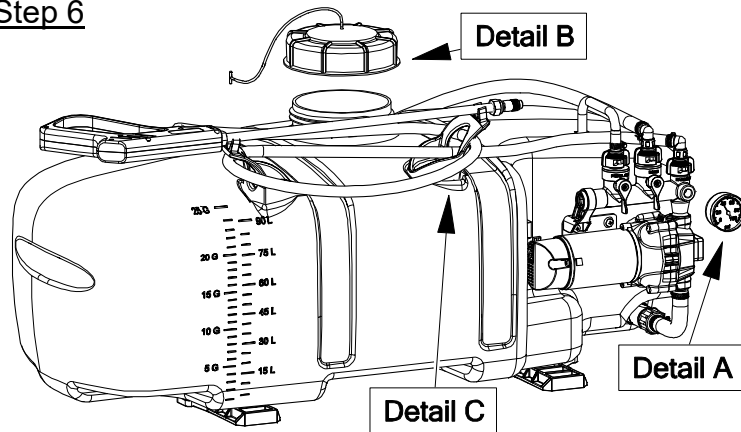

- Make sure all hose clamps are tight before testing or spraying for the first time.
- One requirement will be to hook up your battery leads to a fully charged 12 Volt battery.

****The Sprayer is now ready to TEST w/plain water before actual use****

IMPORTANT: Remove tank lid and be sure the tank is clean and free of any foreign material. Rinse tank out of any tank residue before filling with water to test.

Testing the Sprayer

NOTE: It is VERY important to test this sprayer with plain water before actual spraying is attempted. This will enable you to check the sprayer for leaks without the possibility of losing any expensive chemicals.

Fill the tank about 1/2 full with plain water and drive to the starting place for spraying.

When you are ready to spray, turn the boom valve to the “on” position (Detail A). This will start solution spraying from the tips of the boom. The pressure will decrease slightly when the boom is spraying.

Adjust the pressure by turning the “ON/OFF” valve lever on the Press Adj. valve (Detail B). Make sure your pattern is sufficient. You may down-pressure the system by ‘bypassing’ solution back into the tank. This is achieved by opening the press adj. valve. Regulating pressure is also done in this manner.

Initially begin spraying by closing the ‘Pressure Adjust’ valve and opening the boom line valve (Detail A). This will enable the air in the line to be eliminated (purged) through all the tips, while building pressure. When everything tests all right (no leaks and good pressure), add the desired chemicals to the mixture and water combination and start the spraying operation. Adjust pressure and spray as you did in the testing procedure.

Conditions of weather and terrain must be considered when setting the sprayer. Do not spray on windy days. Protective clothing must be worn in some cases.

Be sure to read the chemical label(s) before application!

Operation

The pumping system draws solution from the tank, through the strainer and to the pump. The pump forces the solution under pressure to the handgun or boom nozzles.

Fill the tank part way with water and then add the desired amount of chemical to be sprayed. Finish filling tank to proper level.

Only fill the tank with what you’re going to spray in a day, never leave chemicals sit in tank.

Connect the lead wire to a fully charged 12 volt battery. You may use either a stand-alone battery or the battery on your towing vehicle. Connect to the positive (red) terminal first, then connect to the negative (black) terminal. Then connect the end of the lead wire to the end of the pump. When disconnecting, disconnect the end of the pump wire from the lead wire, then disconnect the negative (black) connection and finally the positive (red) connection. Lead wire has an On/Off switch to activate the pump. “-” is on and “O” is off. Turn the pump on by depressing the “-” side of the rocker switch. The pump is equipped with a pressure switch that is pre-set at the factory to shut the pump off when all discharges are closed.

The pump will turn back on when one of the following actions occurs:

- ◆ Handgun lever is squeezed to spray the handgun.
- ◆ Boom valve is opened to broadcast spray with the boom.
- ◆ Press Adj. valve is opened to re-circulate solution back into the tank.

- Rotating the adjustable nozzle tip on the handgun will change tip pattern from a straight stream to a cone pattern (fine mist)

When spraying with either the boom or the handgun, pressure may be reduced by slowly opening the bypass valve until desired pressure is achieved. Opening the valve decreases pressure, closing the valve increases pressure. When spraying with the boom, the proper method to set the pressure is to open the boom valve completely and if a lower pressure is desired, then slowly open the bypass valve until that pressure is obtained.

For the safest and most efficient chemical application, you will need to calibrate your sprayer using the tip and speed charts. Once you have determined the proper speed and pressure settings, you will need to consult your chemical label for the amount of chemical to be added to the tank. Read the entire label. Use only according to label directions.

Manifold Valves CLOSED

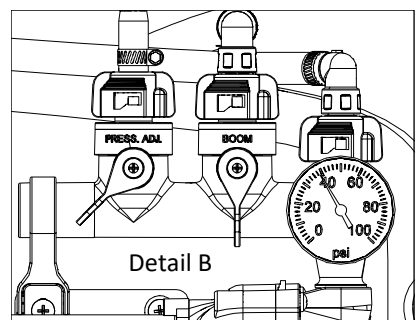
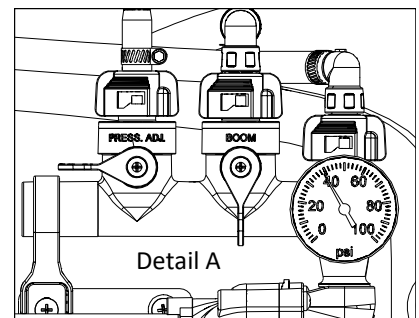
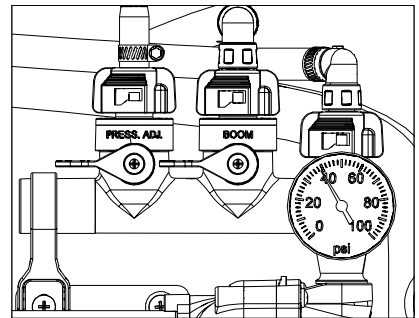

Calibration

Chemical labels may show application rates in gallons per acre, gallons per 1000 square feet or gallons per 100 square feet. Note that the tip chart shows 3 of these rating systems. Once you know how much you are going to spray, then determine (from the tip chart) the spraying pressure (PSI) and the spraying speed (MPH).

Determining the proper speed of the pulling vehicle can be done by marking off 100, 200 & 300 feet. The speed chart indicates the number of seconds it takes to travel the distances. Set the throttle and with a running start, travel the distances. Adjust throttle until you travel the distances in the number of seconds indicated by the speed chart. Once you have reached the throttle setting needed, mark the throttle location so you can stop and go again, returning to the same speed.

Add water and proper amount of chemical to the tank and drive to the starting place for spraying.

		Rate Chart for Outer Two XP Nozzles & Center AIXR					
		Gallons Per Acre (3-Nozzles)			Gallons Per 1,000 Sq. Ft.		
PSI	3-Nozzle Capacity GPM	4 MPH	6 MPH	8 MPH	3 MPH	4 MPH	5 MPH
30	2.26	11.9	7.9	5.9	0.36	0.27	0.22
40	2.60	12.2	8.2	6.1	0.37	0.28	0.22
50	2.91	12.8	8.5	6.4	0.39	0.29	0.23
60	3.17	13.1	8.7	6.6	0.40	0.30	0.24

Speed Chart			
Speed in M.P.H. (Miles Per Hour)	Time Required in seconds to travel a distance of		
	100 Ft.	200 Ft.	300 Ft.
1.0	68 sec.	136	205
2.0	34	68	102
3.0	23	45	68
4.0	17	34	51
5.0	14	27	41
6.0	11	23	34
7.0	9.7	19	29
8.0	8.5	17	26

Using the Boom Nozzles

Four things must be considered when spraying with a boom.

1. How much chemical must be mixed in the tank.
 2. Rate of spray (gallons per acre to be sprayed).
 3. What pressure (p.s.i.) will be used.
 4. Speed traveled (mph) while spraying.
- * Refer to chemical label to determine your chemical mixture
 - * See the tip chart to determine the pressure to be used. The chart will also show the speed used when spraying.
 - * Start the pump and open the valve to the boom nozzles.
 - * Check the spray pattern. Usually you can see the coverage better on a solid concrete surface, such as a driveway.

AIXR11006VP Spray Tip Rate Chart (20" Spacing)							
	Pressure (psi)	Capacity (GPM)	4 MPH	5 MPH	6 MPH	8 MPH	10 MPH
Gallons Per Acre Based on Water	15	.37	27.0	22.0	18.3	13.7	11.0
	20	.42	31.0	25.0	21.0	15.6	12.5
	30	.52	39.0	31.0	26.0	19.3	15.4
	40	.60	45.0	36.0	30.0	22.0	17.8
			2 MPH	3 MPH	4 MPH	5 MPH	
Gallons Per 1000 Sq. Ft. Based on Water	15	.37	1.3	0.84	0.63	0.50	
	20	.42	1.4	0.95	0.71	0.57	
	30	.52	1.8	1.2	0.88	0.71	
	40	.60	2.0	1.4	1.0	0.82	

Maintenance During/After Spraying

Periodically check the strainer and clean the screen on your intake line.

If sprayer becomes clogged during use, discontinue use immediately. DO NOT attempt to service while chemicals are in the sprayer and power is connected.

Proper care and maintenance will prolong the life of your sprayer.

After use, drain the tank and store or dispose of chemical properly. Fill the sprayer half way with clean water. Start the pump and allow the water to pump through the entire plumbing system and nozzles. Drain and then refill half full, add the recommended amount of a good quality tank cleaner, such as FIMCO Tank Neutralizer and Cleaner. (If no tank cleaner is available, you may substitute dish soap for this step, about 1-2 oz. per gallon). But a neutralizer/cleaner should be used to thoroughly clean the system. Turn pump on and circulate through system for 15 minutes and then spray out through boom and handgun nozzles. Refill sprayer half way with clean water and repeat. Follow the chemical manufacturer's disposal instructions of all wash or rinsing water. If boom or handgun nozzles need cleaning, remove them from the sprayer and soak in warm soapy water. Clean with a soft bristled brush or toothpick if necessary. Never use a metal object. Even the slightest damage can change the flow rate and spray distribution. Water rinse and dry the tips before storing.

WARNING: Some chemicals will damage the pump valves if allowed to soak untreated for a length of time! ALWAYS flush the pump as instructed after each use. DO NOT allow chemicals to sit in the pump for extended times of idleness. Follow the chemical manufacturer's instructions on disposal of all waste water from the sprayer.

Tank Care & Maintenance

Warning: Do not use the tank as a container for fuel oils, kerosene, gasoline or any other petroleum distillate product. All polyolefins are softened and permeated by such products. In an enclosed area the vaporization of these materials from the outside surface of the tank could create a dangerous condition.

Tank should not be used as a pressure vessel nor used with chemicals or solutions having a weight more than 12 pounds per gallon. Store the tank in a dry dark place when not in use. Storage out of sunlight will prolong the life of the tank.

Do not drop, strike or kick the tank, especially at low temperatures. Tanks become brittle and are subject to cracking at temperatures below 20° Fahrenheit.

Always flush the tank with water and a neutralizing agent at the end of each use, to prevent contamination of solutions.

Storing Sprayer

When sprayer is not in use, release Cam Lock Handles. This is to prevent deforming of Cam Lock Mechanism. Do not use QR bracket Cams to hold and store boom in vertical position.

Winter Storage

Prepare the sprayer for end-of-season storage by running RV antifreeze through the system. This will keep internal parts lubricated, protect against corrosion and keep the unit from freezing. *Note: RV antifreeze is non-toxic and biodegradable and generally safer for the environment than automotive antifreeze.*

Before storing your sprayer for winter or long term storage, thoroughly clean and drain it as much as possible. Then pour enough pink RV antifreeze into the tank so that when the pump is turned on you can pump the antifreeze throughout the entire plumbing system, including the bypass. Make sure to operate the boom and handgun until you see pink fluid spraying from the nozzles.

Leave any remaining antifreeze in the tank. Before your next usage, rinse the antifreeze from the sprayer with clean water.

It is nearly impossible to drain all of the water from the sprayer and any trapped water can freeze in cold weather and damage parts. Pumping the antifreeze through the system will displace the water and help prevent this damage.

Removing from storage: drain the antifreeze. Fill the tank with fresh water and run through the system. Dispose of antifreeze and flush water properly.

Pump Model: 5281372
4.5 GPM, 60 PSI
Available Replacement Parts

Replacement Pump: 5151088

Includes:
 1/2" MNPT Port Kit Fitting #5168832
 1/2" Hose Barb Port Kit Fitting #5168833

Ref. #	Part #	Description	Qty
1	5151097	4.5 GPM Pump Head	1
1.1	5164271	60 PSI Pressure Switch	1
1.2	5168824	Check Valve w/O-Ring	1
1.3	5051162	Pump Slide Clips (Pkg/2)	1
1.4	5063271	4.5 GPM Diaphragm/Piston/Cam/Bearing Kit	1
2	5075019	Grommets (Pkg/4)	1
3	5157206	15 Amp 'Mini Blade' Fuse	1



- Clean and rinse your pump after each use with Fimco Tank Neutralizer
- Winterize your pump or sprayer by rinsing, draining and running RV Antifreeze through it before storing for the winter.
- Use clean water for your spray mixture
- Store inside a building when not in use.



- Use to pump bleach.
- Use to pump petroleum products such as diesel fuel, gasoline or kerosene.
- Use to pump chemicals w/petroleum distillates or surfactants.
- Store flammable or combustible liquids.
- Leave your pump sit with spray mixture in it for extended periods.
- Use dirty or unfiltered water for spraying.

CAUTION

PRESSURE SWITCH OPERATION

Pressure switch is pre-set at the factory. Improper adjustment of the pressure, may cause severe overload or premature failure. If pump is subjected to rapid cycling during normal operations or infrequent periods, damage may occur.

STOP WARNING STOP

**DO NOT USE PUMP IN AN EXPLOSIVE ENVIRONMENT.
DO NOT USE TO PUMP FLAMMABLE/COMBUSTIBLE
FLUIDS, GASOLINE, KEROSENE, FUEL, OIL, ETC.**

Before Troubleshooting or Attempting to Service the Pump:

- ◆ **Review Troubleshooting Chart:** Do Not attempt to repair until steps below are followed.
- ◆ **Personal Protective Gear:** Wear protective gear when servicing pump.
- ◆ **Disconnect Power:** Disconnect the power to the pump and relieve the pressure from the system.
- ◆ **Empty and Flush** the pump system with water, never attempt to service the pump until it has been emptied and flushed.
- ◆ **Perform Repairs:** Follow directions provided in the troubleshooting section to repair the pump.
- ◆ **Test:** Always test the pump for leaks with plain water after any repairs before using.

Troubleshooting			
Pump will not run:	Check for loose wiring	Pump surges:	Low flow may cause pump to surge
	Make sure the ON/OFF switch is on		Spray Wand is adjusted to small or fine of a spray pattern
	Check the fuse		Check for defective pressure switch
	Check for defective pressure switch		Check for leaks in the discharge line
	Check to see if connected to good 12 Volt Power Source		Check for debris in nozzle orifice
	Check for Low Voltage		Discharge hose may be too long
Pump Does Not Prime (No Discharge w/Motor Running)	Check for clogged strainer/filter	Pump continues to run:	Check for worn or dirty check valve
	Check for kinked inlet/outlet hoses		Check for empty product supply
	Check for empty product supply		Check for Low Voltage
	Check for defective check valve		Check for leaks in the discharge line
	Check for debris in the check valve assembly		Check for defective pressure switch
	Check for cracks in the pump housing		System has leaks
	Check for air leaks in supply line		Air trapped in outlet line or pump head
Low Pressure/ Low Flow:	Check for a clogged strainer	Fuse blows:	Excessive voltage
	Check for proper voltage Try another 12-Volt battery		Improper adjustment of pressure switch
	Check for leaks in the discharge line		Damaged or defective wiring harness
	Check for restrictions in the discharge line		Defective pressure switch
	Check for debris in intake		
	Check for debris in nozzle orifice		
	Check for worn or dirty check valve		

Sprayer and Pump FAQs:

◆ **Why does the pump not run all the time?**

This is an on-demand pump and only runs when a discharge is open (spray gun, bypass, boom (if applicable) or a leak is in the system.

◆ **Why does the pump surge while using the spray gun?**

Low flow/high pressure may cause the pump to surge (or cycle). Typically the spray wand is adjusted at too fine of a mist, to overcome, adjust the nozzle for a higher flow.

◆ **How do I adjust the pressure?**

Pressure can only be adjusted by opening the pressure adjust (bypass) valve to allow some of your water or solution to return to the tank (if equipped).

◆ **Pump quit and will not run, what do I need to do?**

Squeeze trigger on spray gun to ensure that the system isn't just pressurized up with discharges closed. Check electrical connections, ensure switch is on. Check fuses. Check for proper voltage. Check pressure switch.

◆ **Low flow or no flow at all, what do I need to check for?**

Check for a clogged or kinked intake hose and/or clogged intake strainer. Check for proper voltage. You will need to occasionally check your intake strainer to ensure that it is clean of any debris.

◆ **What is causing the fuse to blow each time I turn the pump on?**

Check for excessive voltage. Improper adjustment of the pressure switch. Damaged or defective wire harness or defective pressure switch.

Warning:

Ensure the wiring harness does not become pinched or damaged in any way. This may damage the pump or cause the wiring harness to overheat, resulting in a melt down or fire.

Motor is NOT Running - Checking the Pressure Switch:

If motor is not running and you've checked the following: for loose wiring connections, fuse, the switch on the lead wire was "ON" and sprayer was connected to a fully charged battery, but motor won't run, then it's time to check to see if the pressure switch is bad.

- Remove the cover off the 1" square box (pressure switch) on the head of the pump, the cover is held on by one phillips-head screw. This will expose the two red wires.
- With the pump connected to a good 12 volt power source and everything on.
- Slip the two red wires off the terminals and touch them together.
- ♦ If the motor runs, it means the pressure switch is bad and needs to be replaced.
- ♦ If motor still doesn't run, try bypassing the switch in the lead wire or using another lead wire. Even if a tester shows power to the pressure switch, still try this test.

Warning: It is NOT recommended to run the pump this way, as the pump will continue to run and not shut off.

This could result in blown hoses when all discharges are closed or premature failure of the pump completely.

Motor Running-No Pressure - - Cleaning the Check Valve:

If you're experiencing little to no pressure or the pump is not priming and filter screen is clean and plumbing is good with no leaks, you may need to clean the check valve.

- Remove the head of the pump, which is held on by 7 screws.
- The first piece inside the head of the pump is called a check valve, it's the part responsible for building up pressure and pumping water/solution through the lines.
- Clean the check valve under hot, soapy water (such as a good grade dish soap).
- Give it a very light scrubbing with something like an old toothbrush, something with soft bristles.
- Then let it soak for about an hour or so in the hot soapy solution and replace in the pump and reassemble the pump.

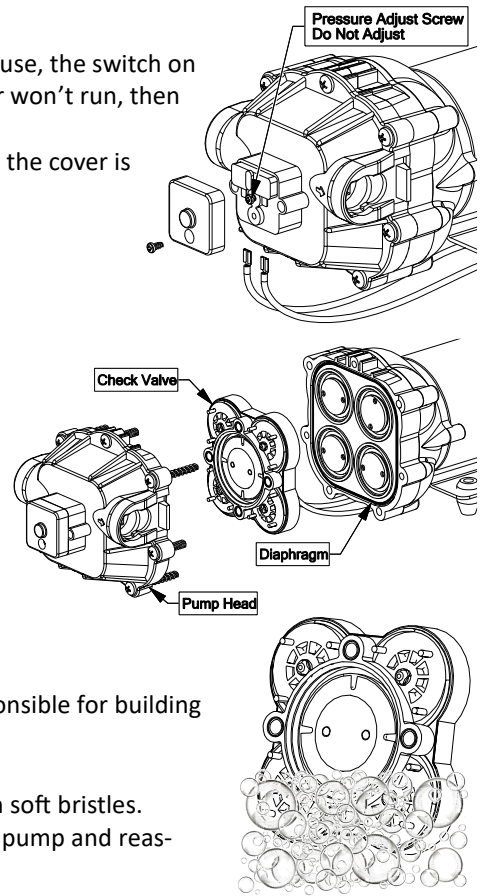

Most times this will restore most, if not all of the prime of a pump.

If you're still having issues with pressure after this step, it would be recommended to replace this part.

Intake/Siphon Tube/Screen Detail

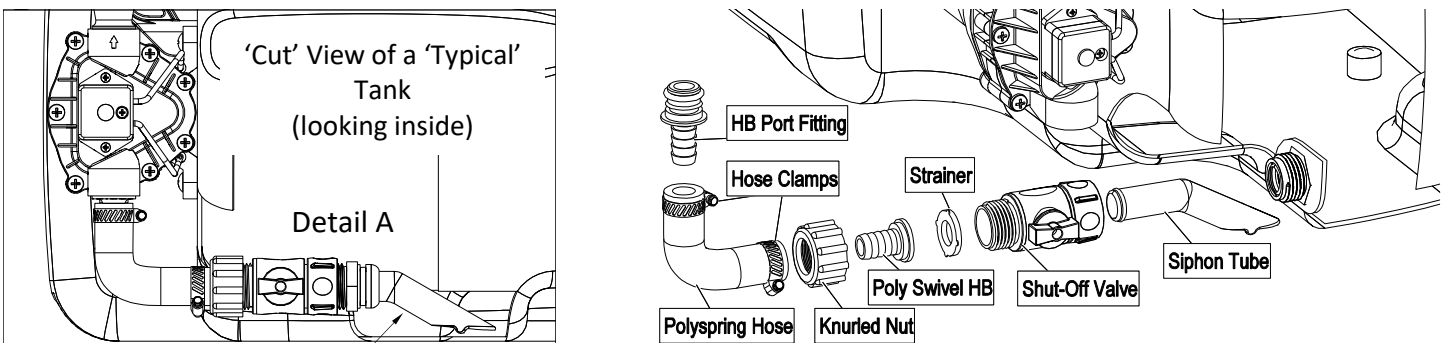

Make sure the siphon tube is rotated so that the tube just touches the bottom of the tank.

The suction line of your sprayer should contain a 'siphon tube' or intake tube which should be rotated so that it just touches the bottom of the tank surface. (see Detail A). Reach in and rotate it, as needed, if not already in this position. A shut-off valve is threaded onto the pipe nipple at the intake location on the tank. It is at this location so you can shut off the flow of solution to access your system's screen for cleaning.

Checking/Cleaning the sprayer's filter/screen:

- ♦ Start your pump and before it shuts off, reach down and Shut the valve to the 'Closed' position (lever is perpendicular to the flow of fluid), then shut off your pump.
- ♦ Unscrew the knurled nut from the shut-off valve, leaving the valve connected to the tank.
- ♦ Swing (swivel) the intake assembly towards you. Look in the nut you JUST unscrewed. There is a screen/washer there.
- ♦ Remove the screen and clean as necessary. Replace when done and reassemble the entire assembly.
- ♦ Make sure the valve is turned to the 'Open' position before restarting your pump.

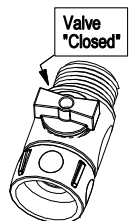
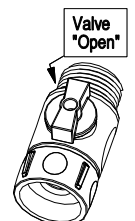

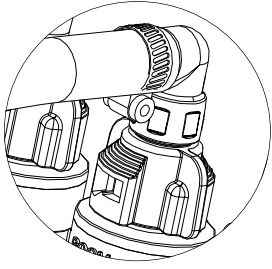

Troubleshooting Leaking Elbow on Manifold:

Manifold is leaking at the elbow connection, remove the elbow from the manifold. Quarter turn counter clockwise and lift off.

Look inside the cap and make sure the flat washer is in place.

If washer is in place, you'll notice a hexagon shape hole. While holding the elbow and cap at the same time, using an allen wrench, head of a bolt or a standard screwdriver, something just big enough to catch the edges, give it a twist clockwise to snug up the connection. The elbow is a two-piece interlocking mechanism and may just be a little loose. Replace on manifold.

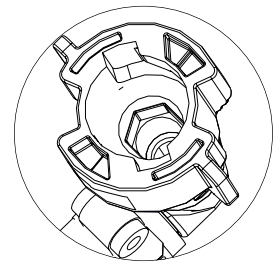

Pump Intended Uses

The pump is intended to be used spraying agricultural pesticides, herbicides, and other non-flammable liquids.

Spraying Pesticides:

Pesticides are hazardous chemicals that must be handled with caution as directed on the pesticide label. Pesticides are regulated by the United States Environmental Protection Agency (EPA) and defined as:

Any substance or mixture of substances intended for preventing, destroying, repelling, or mitigating any pest. Though often misunderstood to refer only to insecticides, the term pesticides is a comprehensive term that applies to insecticides, herbicides, fungicides, and various other substances used to control pests.

The pump is intended for use in spraying pesticides in liquid form only. The pump is NOT intended for use in spraying pesticides in dry or aerosolized form, for use with fumigants.

In addition to spraying pesticides, this pump may be used to spray other **non-flammable** liquids. Example uses include herbicides, watering plants/trees or spraying water for dust control, or applying water-based, **non-flammable** sealant or stain to outdoor wood surfaces.

WE RECOMMEND THAT THE PUMP NOT BE USED FOR OTHER PURPOSES ONCE IT HAS ALREADY BEEN USED FOR SPRAYING PESTICIDES.

Any chemical will leave some residual in the pump components, even after the pump has been properly cleaned. These residual chemicals can have unexpected effects on future uses. For example, spraying water or other liquids that are contaminated with residual pesticide may result in unforeseen hazards to plant or animal life.

NOTE: The pump will be damaged, and warranty voided if used to apply bleach, chlorine, ice control chemicals, or any petroleum-based product (gasoline, diesel, kerosene, oil).

Exploded View: ATV-25-4ADM-5NMB-TSC (5303851)

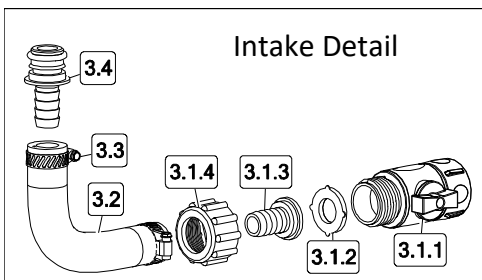
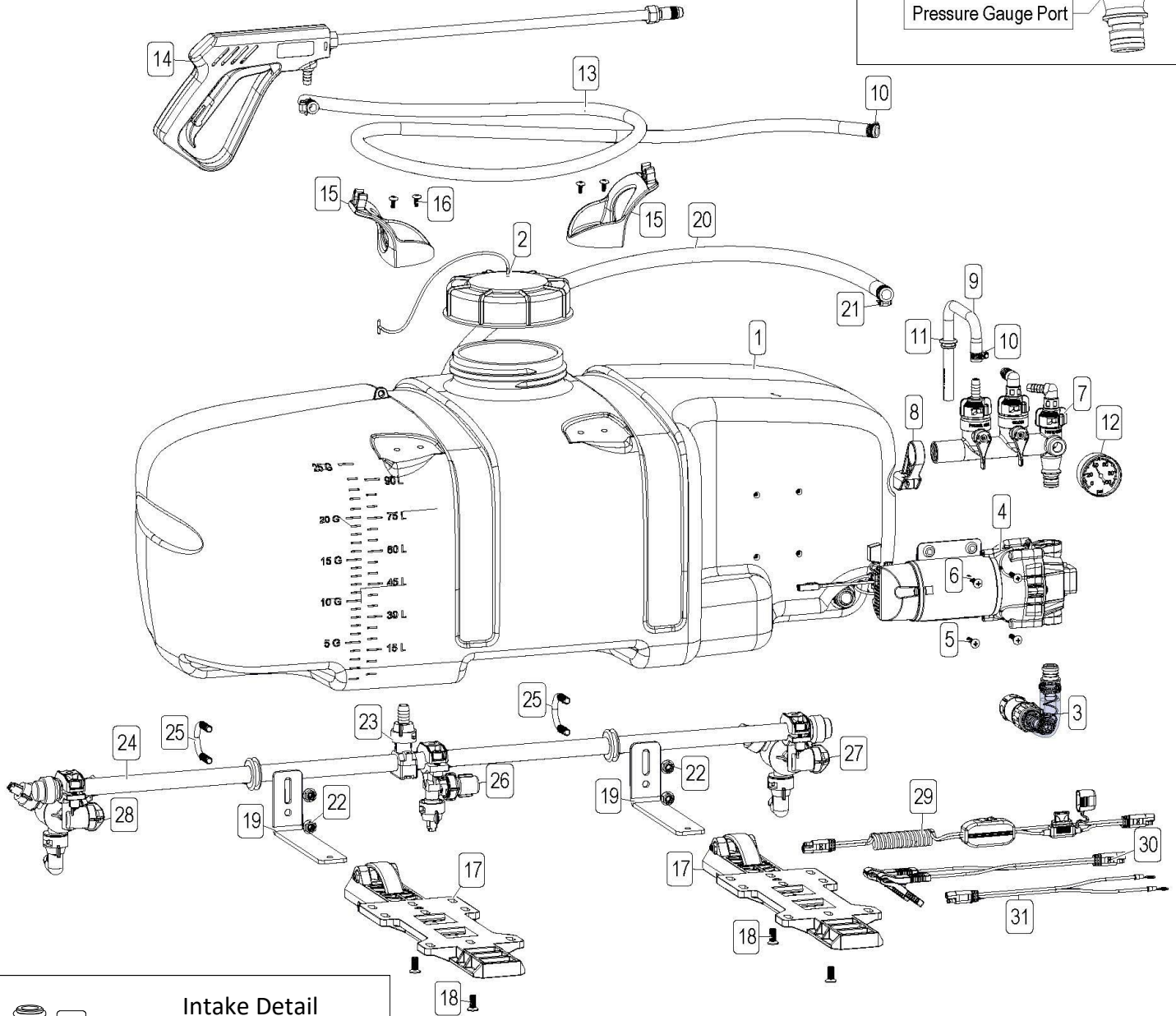
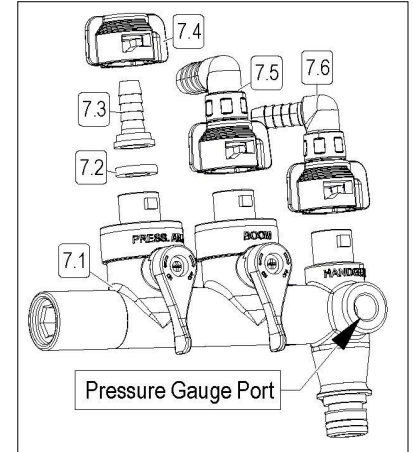

Parts List: ATV-25-4ADM-5NMB-TSC (5303851)

Ref. #	Part #	Description	Qty
1	5169335	25-Gallon ATV Tank	1
1.1	5100452	Siphon Tube	1
2	5058188	Tank Lid w/Lanyard	1
3	5275877	Intake Sub-Assembly	1
3.1	5282416	Intake Shutoff Subassembly	1
3.1.1	5116242	Strainer, 1" Filter Washer	1
3.1.2	5143419	Swivel Shut-Off	1
3.1.3	5149035	Poly Swivel, 1/2" Hose Barb	1
3.1.4	5006209	Poly Knurled Swivel Nut, 3/4" FGHT	1
3.2	5020557	1/2" Polyspring Hose x 5 1/4"	1
3.3	5051114	Hose Clamp (1/2")	2
3.4	5168833	1/2" HB Port Fitting	1
4	5281372	4.5 GPM, 60 PSI 12V Pump	1
5	5117168	#10-24 x 1.00 PH Truss Head Screw	3
6	5117338	#10-24 x 1.50 PH Truss Head Screw	1
7	5281539	Quick Connect Manifold Assembly	1
7.1	5302347	Quick Connect Manifold (Main Body)	1
7.1.1	5072514	O-Ring -113	1
7.1.2	5143421	QC Manifold - Handle	2
7.2	5143430	Flat Washer - Hose Barb Seal	1
7.3	5143431	QC Manifold - 3/8" Hose Straight Barb	1
7.4	5143429	Quick Connect Quarter Turn Cap	1
7.5	5302354	QC Manifold 1/2 Swivel 90° Elbow	1
7.5.1	5143430	Flat Washer - Hose Barb Seal	1
7.6	5302802	QC Manifold 3/8 Swivel 90° Elbow	1
7.6.1	5143430	Flat Washer - Hose Barb Seal	1
8	5143422	QC Manifold - Support Bracket	1

Ref. #	Part #	Description	Qty
9	5100962	Formed Bypass Tube	1
10	5051144	Hose Clamp (3/8")	3
11	5075018	Grommet	1
12	5167097	2" Dry, 100#, Back Mount Gauge	1
13	5020584	Hose 3/8" 1-Brd (2SP) x 20'	1
14	5273959	Deluxe Pistol-Grip Handgun w/X-26 Tip	1
14.1	5018331	Brass Handgun Tip (X-26)	1
15	5133275	20-Gallon Hose Wrap	2
16	5117234	#10-24 x 0.50 PH Truss Head Screw	4
17	5278222	ATV Quick Release Bracket Assembly	2
18	5034149	5/16-18 x 0.75 PH Flat Head Screw	4
19	5038873-BLK	QR Boom Mount Bracket - Bent Fixed Height	2
20	5020570	Hose, 1/2"-1 Brd. x 48"	1
21	5051114	Hose Clamp (3/8"-1/2")	2
22	5006307	5/16-18 Serrated Flng Hex Nut	4
23	5283392	1/2" Wet Boom Supply	1
24	5283398	1/2" Wet Boom Tube	1
25	5034220	5/16-18 x 1.3125 x 1.75 Round U-Bolt	2
26	5283394	1/2" Wet Boom Center w/Shutoff	1
27	5283393	1/2" Wet Boom Left Turret	1
28	5283395	1/2" Wet Boom Right Turret	1
29	5164336	60" 16AWG, Switched Lead Wire w/15 amp Fuse	1
29.1	5157238	15 Amp Regular Blade Fuse	1
30	5164333	36" 16AWG Battery Clamp Ends	1
31	5164334	36" 16AWG Ring Terminal Ends	1

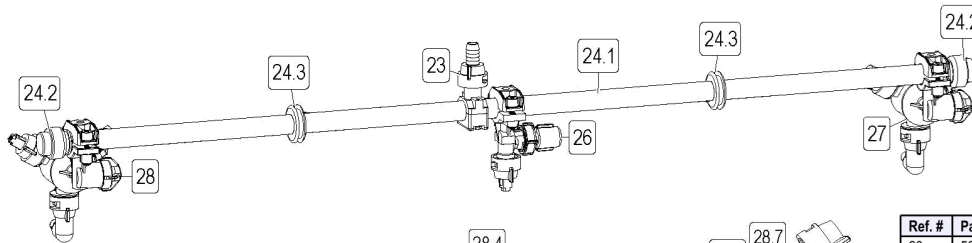

**Multi-Boom Assembly
Exploded View/Parts List**

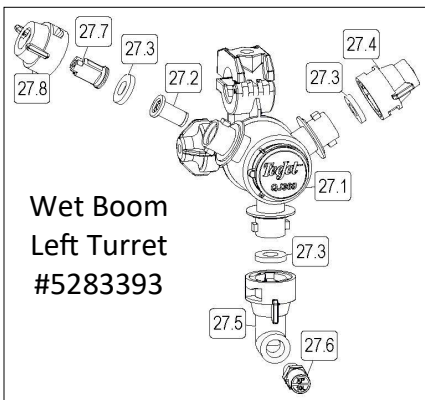

**Wet Boom
Left Turret
#5283393**

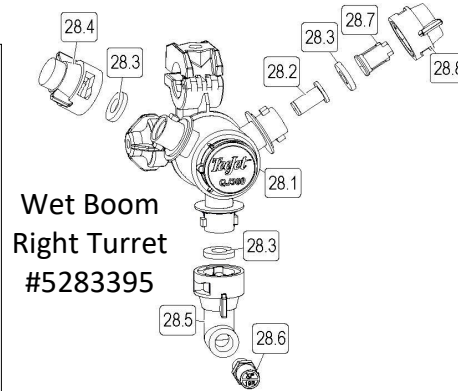

**Wet Boom
Right Turret
#5283395**

Ref. #	Part #	Description	Qty
23	5283392	1/2" Wet Boom Supply	1
23.1	5056130	TeeJet Quick Nozzle Body, QJ7421-1/2-NYB	1
23.2	8400-500-NYB	1/2" Hose Barb Adapter Fitting	1
23.3	5046293	Quick TeeJet Cap w/ Seat 114445A-1-CELR	1
23.3.1	5016157	Seat Washer - EPDM - QJ Caps	1
24	5283398	1/2" Wet Boom Tube	1
24.1	5100986	SS Boom Tube	1
24.2	5011340	1/2" Pip Cap Push Connect	2
24.3	5075016	3/4" x 1-5/8" Grommet	2
26	5283394	1/2" Wet Boom Center w/Shutoff	1
26.1	5056125	TeeJet Nozzle Body, QJ17560A-1/2-NYB	1
26.2	58140-NYB	Manual Chemsaver	1
26.3	5117299	#10-24 x 0.75 PH Round Head Screw	1
26.4	5143543	Nozzle Check Strainer, Blue (50 Mesh)	1
26.5	5016157	Seat Washer - EPDM - QJ Caps	1
26.6	AIXR11006VP	Air-Induction XR Flat Spray Tip - AIXR11006VP	1
26.7	5046214	Quick TeeJet Cap ONLY (Black)	1
27	5283393	1/2" Wet Boom Left Turret	1
27.1	QJ373-1/2-NYB	3-Outlet Nozzle Body, QJ373-1/2-NYB	1
27.2	5143543	Nozzle Check Strainer, Blue (50 Mesh)	1
27.3	5016157	Seat Washer - EPDM - QJ Caps	3
27.4	5046186	Quick Cap Shut-Off w/Seat Washer	1
27.5	QJ4676-90-1/4-NYR	TeeJet 1/4" FPT 90 Degree Quick Cap Adapter	1
27.6	1/4XP10L-VP	XP BoomJet Nozzle, Left	1
27.7	AIXR11006VP	Air-Induction XR Flat Spray Tip - AIXR11006VP	1
27.8	5046214	Quick TeeJet Cap ONLY (Black)	1
28	5283395	1/2" Wet Boom Right Turret	1
28.1	QJ373-1_2-NYB	3-Outlet Nozzle Body, QJ373-1/2-NYB	1
28.2	5143543	Nozzle Check Strainer, Blue (50 Mesh)	1
28.3	5016157	Seat Washer - EPDM - QJ Caps	3
28.4	5046186	Quick Cap Shut-Off w/Seat Washer	1
28.5	QJ4676-90-1/4-NYR	TeeJet 1/4" FPT 90 Degree Quick Cap Adapter	1
28.6	1/4XP10R-VP	XP BoomJet Nozzle, Right	1
28.7	AIXR11006VP	Air-Induction XR Flat Spray Tip - AIXR11006VP	1
28.8	5046214	Quick TeeJet Cap ONLY (Black)	1



**Wet Boom
Supply
#5283392**

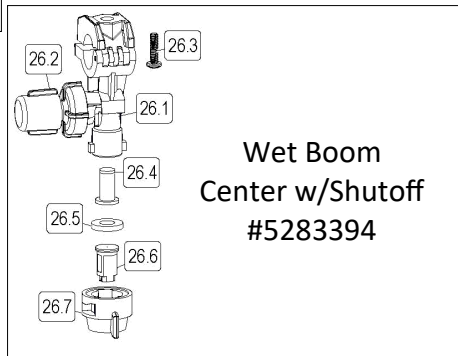

**Wet Boom
Center w/Shutoff
#5283394**

Approx. Dimensions:

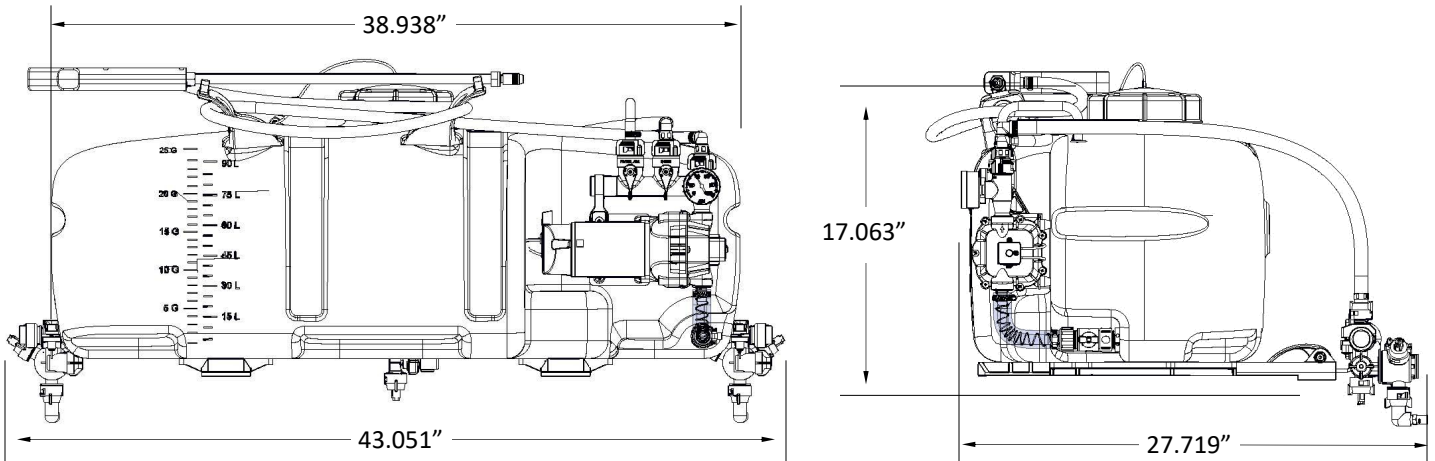

Warranty Information

LIMITED WARRANTY FOR NEW FIMCO, IND. EQUIPMENT

WHO MAY USE THIS LIMITED WARRANTY. This limited warranty (the "Limited Warranty") is provided by Fimco, Ind. to the original purchaser ("you") of the Equipment (as defined below) from Fimco, Ind. or one of Fimco, Ind.'s authorized dealers. This Limited Warranty does not apply to any subsequent owner or other transferee of the Equipment. THIS LIMITED WARRANTY GIVES YOU SPECIFIC LEGAL RIGHTS, AND YOU MAY ALSO HAVE OTHER RIGHTS WHICH VARY FROM STATE TO STATE.

WHAT THIS LIMITED WARRANTY COVERS AND FOR HOW LONG. Fimco, Ind. warrants that any new Equipment will be free from defects in material and workmanship for a period of **one (1) year** for sprayer and **two (2) years** for High-Flo High Performance pump (homeowner), **90 days** for sprayer and pump (commercial user), after delivery of the Equipment to you (the "Warranty Period"). The Warranty Period is not extended if Fimco, Ind. repairs or replaces the Equipment.

WHAT IS NOT COVERED BY THIS LIMITED WARRANTY. This Limited Warranty does not apply to: (1) used Equipment; (2) any Equipment that has been altered, changed, repaired or treated since its delivery to you, other than by Fimco, Ind. or its authorized dealers; (3) damage or depreciation due to normal wear and tear; (4) defects or damage due to failure to follow Fimco, Ind.'s operator's manual, specifications or other written instructions, or improper storage, operation, maintenance, application or installation of parts; (5) defects or damage due to misuse, accident or neglect, "acts of God" or other events beyond Fimco, Ind.'s reasonable control; (6) accessories, attachments, tools or parts that were not manufactured by Fimco, Ind., whether or not sold or operated with the Equipment; or (7) rubber parts, such as tires, hoses and grommets.

HOW TO OBTAIN WARRANTY SERVICE. To obtain warranty service under this Limited Warranty, you must (1) provide written notice to Fimco, Ind. of the defect during the Warranty Period and within **thirty (30) days** after the defect becomes apparent or the repair becomes necessary, at the following address: Fimco, Ind., 1000 Fimco Lane, North Sioux City, SD 57049; and (2) make the Equipment available to Fimco, Ind. or an authorized dealer within a reasonable period of time. For more information about this Limited Warranty, please call: **800-831-0027**.

WHAT REMEDIES ARE AVAILABLE UNDER THIS LIMITED WARRANTY. If the conditions set forth above are fulfilled and the Equipment or any part thereof is found to be defective, Fimco, Ind. shall, at its own cost, and at its option, either repair or replace the defective Equipment or part. Fimco, Ind. will pay for shipping and handling fees to return the repaired or replacement Equipment or part to you.

LIMITATION OF IMPLIED WARRANTIES AND OTHER REMEDIES. THE REMEDIES DESCRIBED ABOVE ARE YOUR SOLE AND EXCLUSIVE REMEDIES, AND FIMCO, IND.'S SOLE LIABILITY, FOR ANY BREACH OF THIS LIMITED WARRANTY. TO THE EXTENT APPLICABLE, ANY IMPLIED WARRANTIES, INCLUDING, WITHOUT LIMITATION, THE IMPLIED WARRANTIES OF MERCHANTABILITY AND FITNESS FOR A PARTICULAR PURPOSE, SHALL BE LIMITED IN DURATION TO THE WARRANTY PERIOD, AND THE REMEDIES AVAILABLE FOR BREACH THEREOF SHALL BE LIMITED TO THE REMEDIES AVAILABLE UNDER THIS EXPRESS LIMITED WARRANTY. SOME STATES DO NOT ALLOW LIMITATIONS ON HOW LONG AN IMPLIED WARRANTY LASTS, SO THE ABOVE LIMITATION MAY NOT APPLY TO YOU. IN NO EVENT SHALL FIMCO, IND.'S LIABILITY UNDER THIS LIMITED WARRANTY EXCEED THE ACTUAL AMOUNT PAID BY YOU FOR THE DEFECTIVE EQUIPMENT, NOR SHALL FIMCO, IND. BE LIABLE, UNDER ANY CIRCUMSTANCES, FOR ANY CONSEQUENTIAL, INCIDENTAL, SPECIAL OR PUNITIVE DAMAGES OR LOSSES, WHETHER DIRECT OR INDIRECT. SOME STATES DO NOT ALLOW THE EXCLUSION OR LIMITATION OF INCIDENTAL OR CONSEQUENTIAL DAMAGES, SO THE ABOVE LIMITATION OR EXCLUSION MAY NOT APPLY TO YOU.