

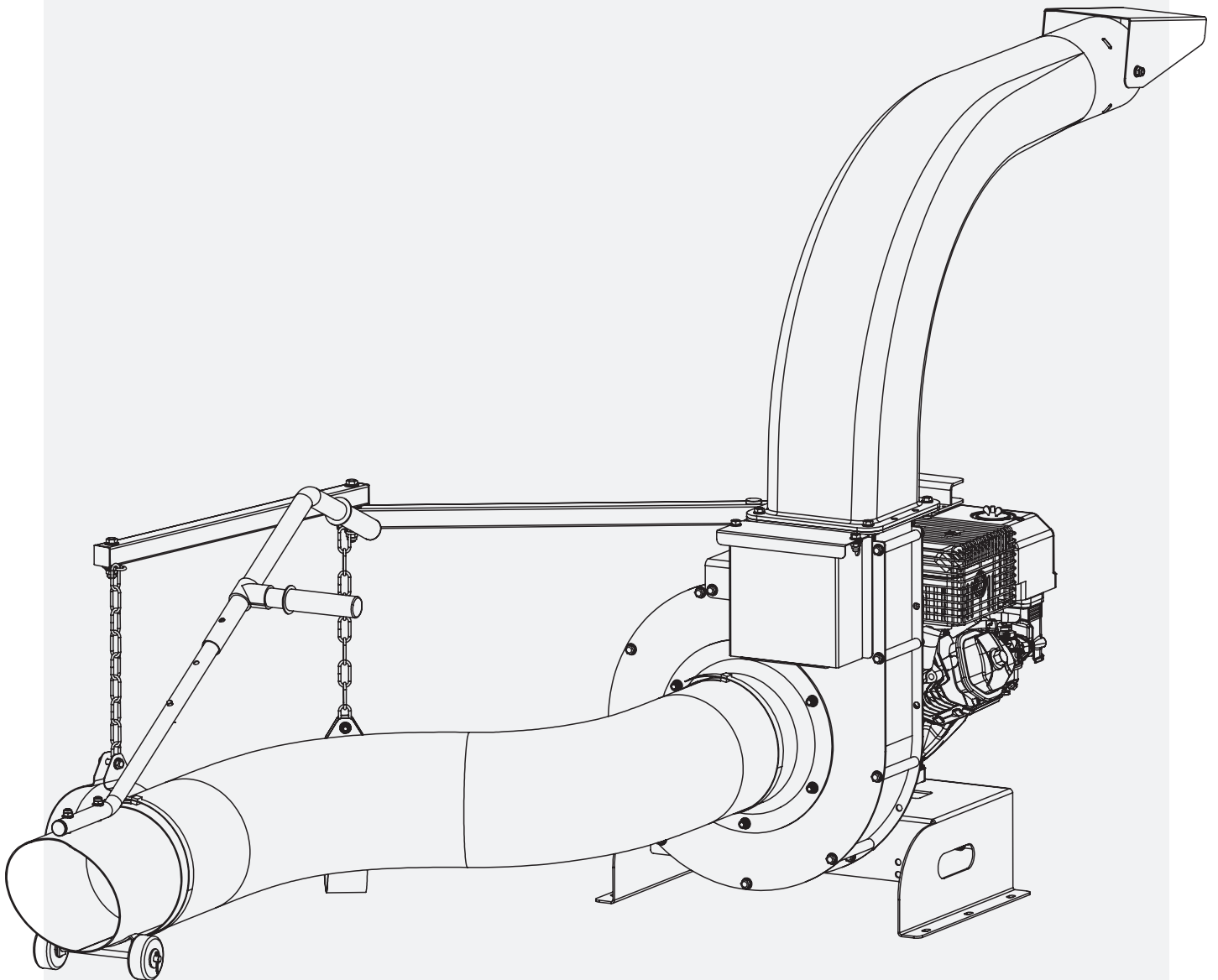

Truck Loader Leaf Vacuum | GUO143 Operator's Manual



Warning: Please read and thoroughly understand all instructions before operating. Failure to follow safety rules and other basic safety precautions may result in serious personal injury. Keep these instructions in a safe and easily accessible place so that they can be referred to when needed. Retain these instructions to assist in future servicing.

INDEX

| | |
|---------------------------------------|-------|
| Safety Warnings & Statements | 3-4 |
| Technical Specifications | 5 |
| Main Components | 6 |
| Recommended Tools | 6 |
| Part List | 7 |
| Assembly | 8-10 |
| Preparation | 11 |
| Operation | 11-14 |
| Troubleshooting | 15 |
| Exploded and Parts List | 16 |
| Optional Accessories & Components | 17 |
| Maintenance and Storage | 18 |
| Transportation & Storage Requirements | 19 |
| Warranty | 19 |

Safety Warnings & Statements

For your own safety and the safety of the product, please always follow these basic safety precautions when using this product.

General Precautions

1. Before use, you need to read and understand the product manual carefully to understand this product and its installation and operation methods.
2. The manual cannot describe all conditions or situations that may occur that may cause injury. The operator must understand the product or understand this user manual.
3. Never operate this product under the influence of alcohol or drugs.
4. If you are under 16 years old, do not operate this product.
5. When using this product, make sure there are no unauthorized persons nearby.
6. When unpacking and installing this product, use appropriate tools and wear gloves.
7. Please operate this product during the day or under good artificial light.
8. Never operate or install this product without reading or understanding the operator's manual.

Operation Precautions

1. Be very careful when loading or unloading the machine.
2. Please operate the machine carefully on the road or sidewalk.
3. Do not run the engine in an enclosed area where dangerous carbon monoxide fumes can collect.
4. When starting or operating the machine, make sure that the machine is on level ground and never lean directly over the machine.
5. Be sure the area is clear of other people before operating. Stop the unit if anyone enters the area.
6. When the machine is running, do not put your hands near the vacuum suction and discharge chute.
7. Operate the machine only in daylight or good artificial light.
8. Do not operate the unit while under the influence of alcohol or drugs.
9. Always wear eye and ear protection, anti-dust mask when operating this unit.
10. Keep in mind the operator is responsible for accidents occurring to other people or property.
11. Never operate the machine without proper guards, plates, or other safety protective devices in place.
12. Thoroughly inspect where machine is to be used and remove all foreign objects. And check the terrain to determine how to perform safely.
13. We suggest do not work on the slope as possible, especially in downhill, be sure to operate carefully and slowly
14. Never attempt to clear clogs from the intake hose and the discharge chute while the unit is running. Always shut the engine off, allow the impeller to come to a complete stop, and remove the spark plug wire from the spark plug before removing excess materials.
15. Never attempt to perform any maintenance, repairs, or attachment of accessories while the unit is running. Always shut the unit off, allow the impeller to come to a complete stop, and remove the spark plug wire from the spark plug before beginning these activities.

Product Specific Safety

DANGER

The leaf vacuum has spinning blades that can amputate hands and feet. Do not place hands or feet in the hopper or chipper cone, or discharge chute.

WARNING

Do not allow anyone in the area while the unit is running, and if someone enters, shut the unit off immediately until they leave.

- Organize the work area before starting work.
- Never leave the machine running unattended; always turn off the engine, wait for the impeller to stop, and disconnect the spark plug.
- Keep the machine clear of material buildup, do not attempt to move it while running, and inspect for any signs of damage or foreign objects before operation.
- Use only approved attachments and accessories, ensure the machine is free of debris before starting, and stop the engine and inspect for damage if a foreign object is struck.

Disclaimer

Please read and understand all instructions carefully before operating this equipment. Only strictly observe safety precautions and other basic safety precautions before operating this equipment. Our company is not responsible for personal injury or property damage caused by human factors or abnormal use.

Main Purpose

The unit is a gasoline engine powered that can be used to suck up and pulverize leaves, debris, and other similarly sized organic material from the ground.

Technical Specifications

| | |
|----------------------------|---------------------------------|
| SKU# | GU0143 |
| Impeller Diameter | 15.7" (400 mm) |
| Vacuum Hose | 8"x10' (203x3000 mm) |
| Assembled Dimension | 28"x27"x69.5" (713x686x1765 mm) |

Engine Specifications

| | |
|----------------------------|----------|
| Engine Type | OHV |
| Power | 15 HP |
| Starting | Electric |
| RPM | 3600 |
| Oil | 10W-30 |
| Working Temperature | 5°C-40°C |

Main Components

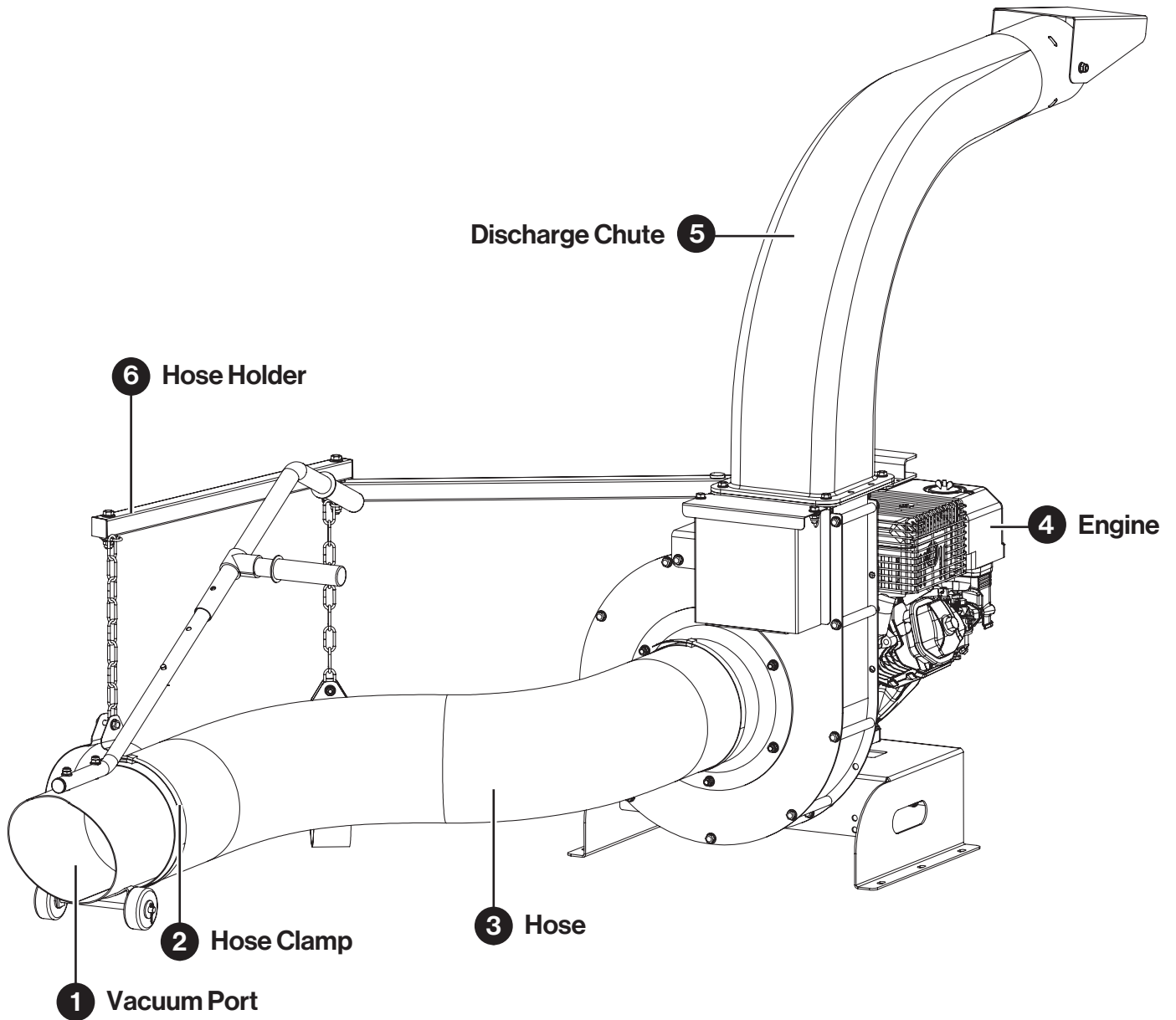

Recommended Tools



12mm Open-end Wrench
13mm Open-end Wrench
24mm Open-end Wrench (x2)



Slotted Screwdriver



Phillips Screwdriver

Part List

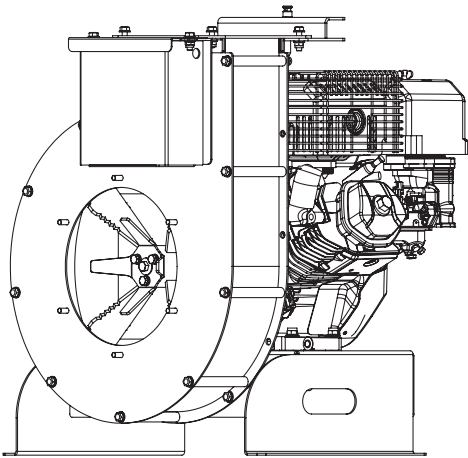

Engine Assembly Kit

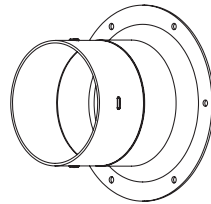

Hose Flange

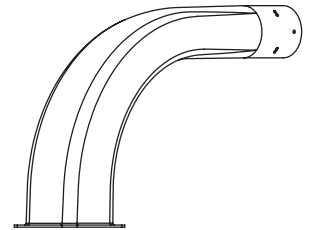

Discharge Chute

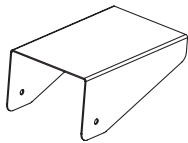

Direction Plate

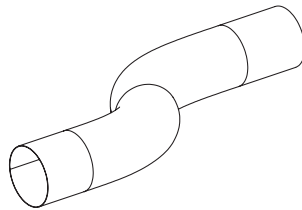

Hose

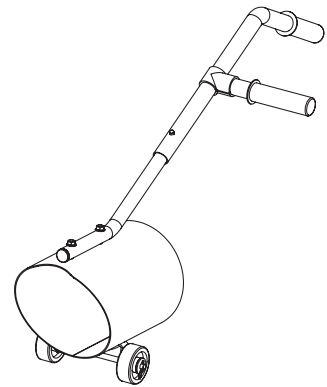

Vacuum Port

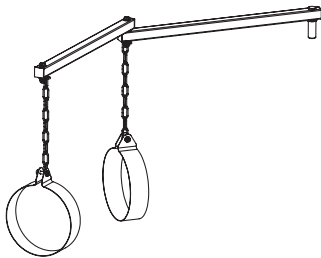

Hose Holder

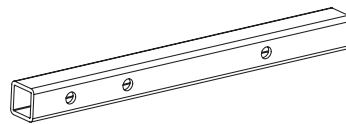

Hitch Bar



M8 Nut (x8)



M16 Nut (x3)

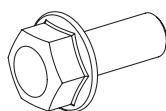

M8x20 Bolt (x2)

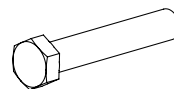

M16x90 Bolt (x3)

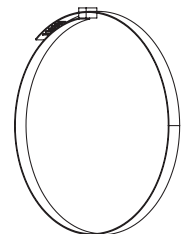

Hose Clamp x2

Assembly

Step 1 - Assemble the Hose Flange

Recommended Tools: 13mm Open-end wrench

- Install the hose flange at the front of engine assembly kit, fixing by 6 M8 nuts. **(Fig.01)**

Step 2 - Assemble the Discharge Chute

Recommended Tools:
12mm Open-end wrench
13mm Open-end wrench

- Loosen and remove the 2 M8x25 bolts and 2 M8x30 bolts and 4 M8 nuts from the engine assembly kit. **(Fig.02)**

CAUTION

Support the battery compartment and handle holder while extracting bolts to prevent accidental dropping or misalignment.

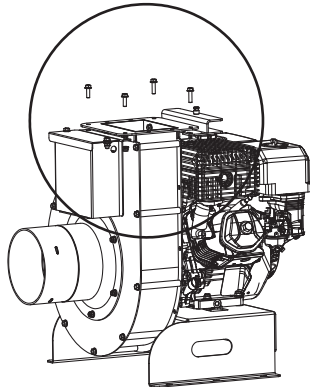

- Mount the discharge chute onto the engine assembly kit.
- Secure the discharge chute and battery box to the engine assembly kit using:
The two M8x25 bolts and two M8 nuts removed in the previous step. **(Fig.03)**

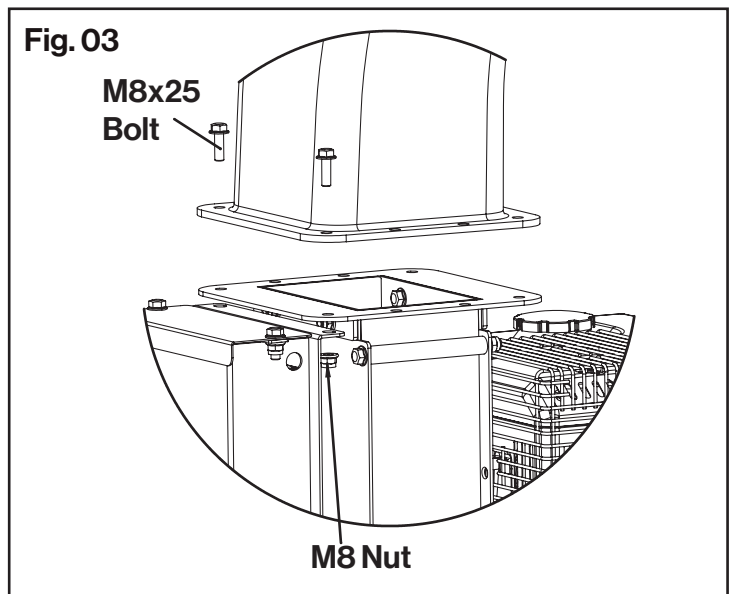
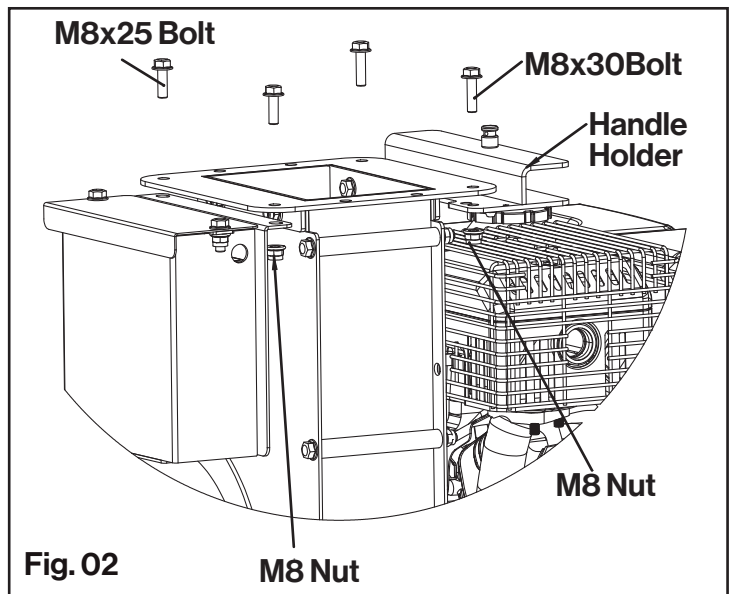
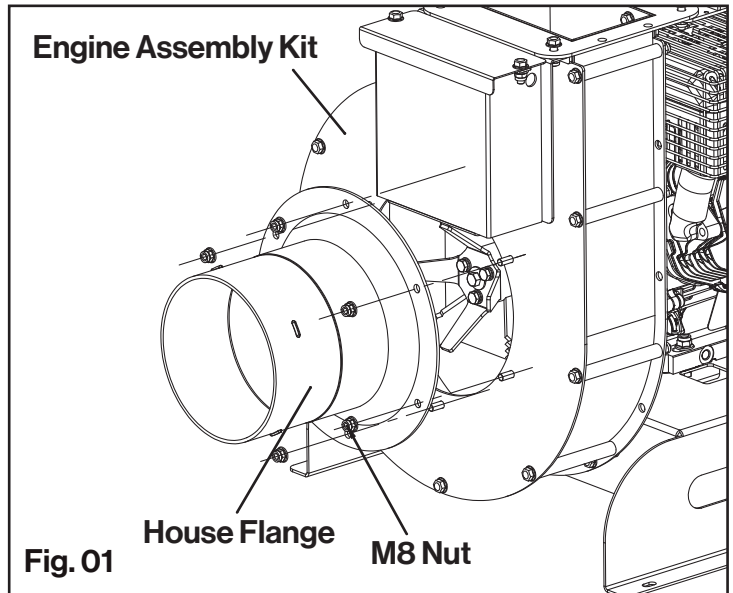
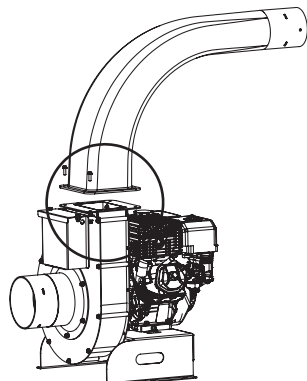

- d. Attach the discharge chute and handle holder to the engine assembly kit using:
The two M8x30 bolts and two M8 nuts removed in the previous step. **(Fig.04)**

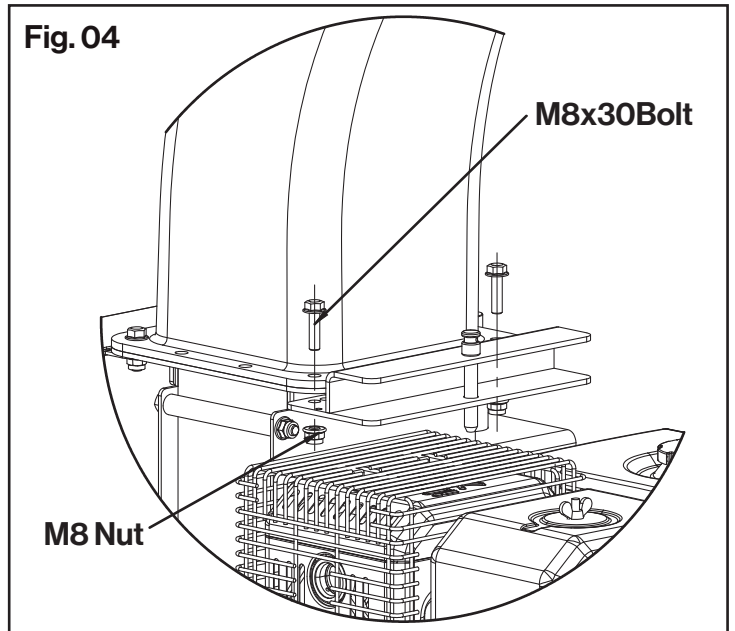
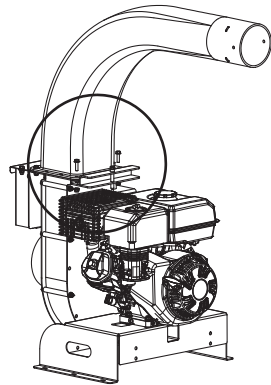

Step 3 - Assemble the Direction Plate

Recommended Tools:
12mm Open-end wrench
13mm Open-end wrench

- a. Install the direction plate at the discharge chute by 2 M8x20 bolts and 2 M8 nuts. **(Fig.05)**

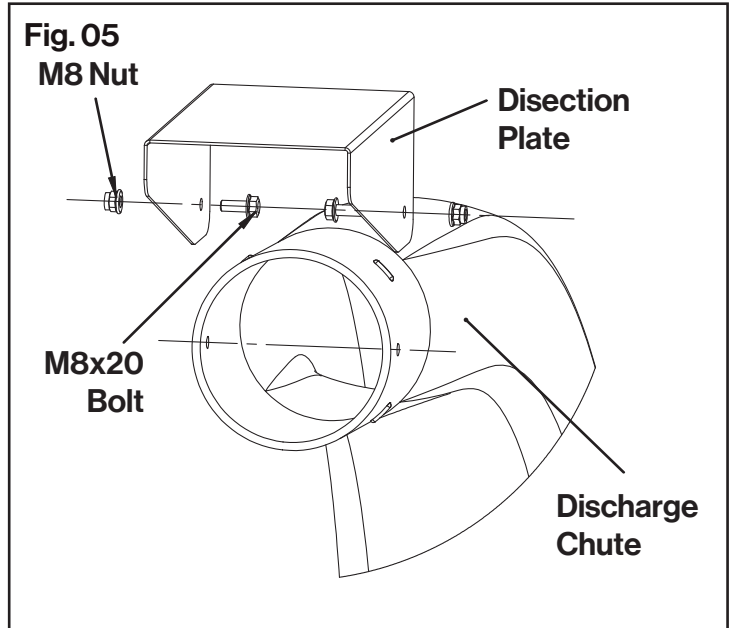
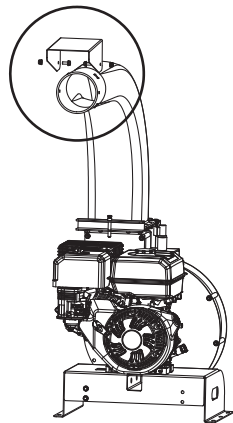

Step 4 - Assemble The Hose

Recommended Tools: Slotted Screwdriver

- a. Insert one end of the hose into the hose flange and securely fasten it using a hose clamp. **(Fig.06)**

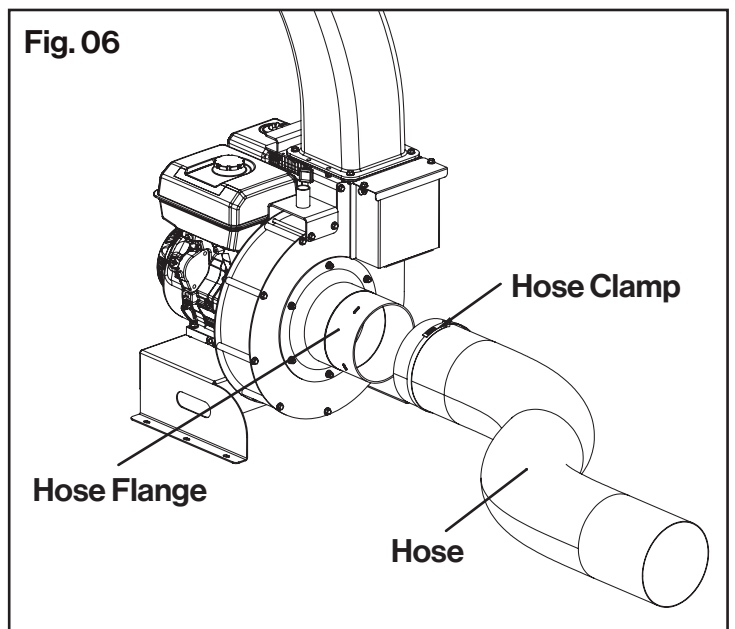

Step 5 - Assemble the Hose Holder

- Secure the hose holder to the engine assembly kit. (Fig.04)

Step 6 - Assemble the Vacuum Port

Recommended Tools: Slotted Screwdriver

*. The hose holder may be required during transportation or use. Insert the hose into the ring of the hose holder. (Fig.08)

- Insert the other end of the hose into the Vacuum Port and securely fasten it using a hose clamp. (Fig.07)

Fig. 07

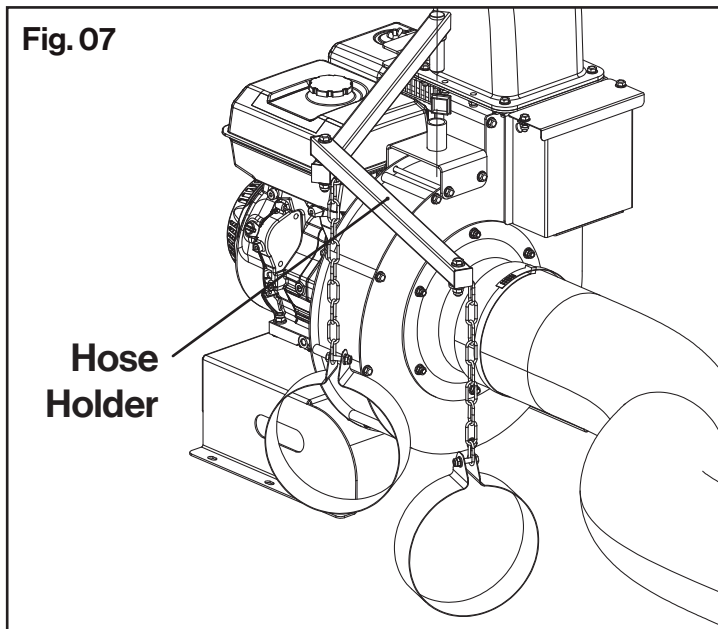
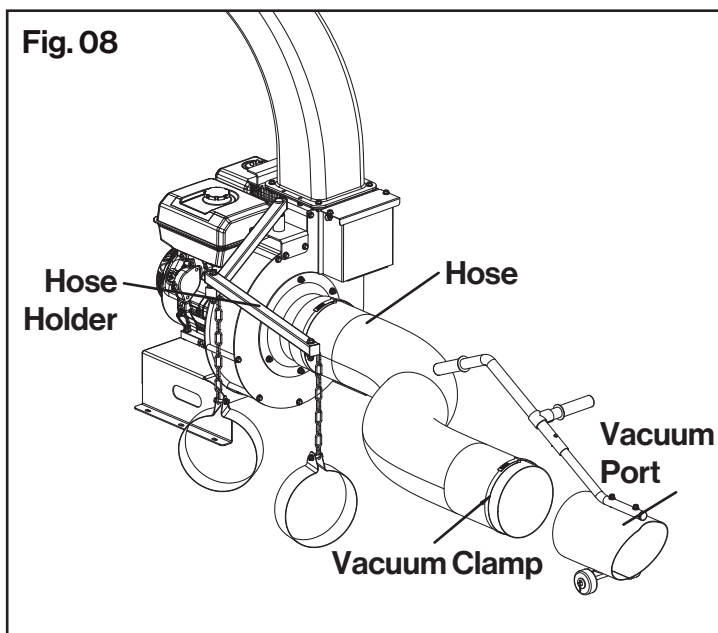

Fig. 08



Step 7 - Turn on the Power

Recommended Tools: 12mm Open-end wrench 13mm Open-end wrench Phillips Screwdriver

- Loosen 2 M8x20 bolts and 2 M8 nuts remove the battery cover.
- Connect the cables to the battery: Red wire to the positive terminal (red), black wire to the negative terminal (black or blue).
- Replace the cover and tighten the battery box using 2 M8x20 bolts and 2 M8 nuts. (Fig.09)

Reversing the power cables will damage the engine and cause product failure. Ensure correct connections.

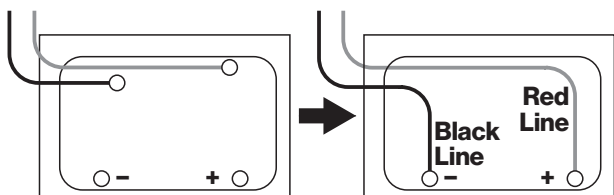
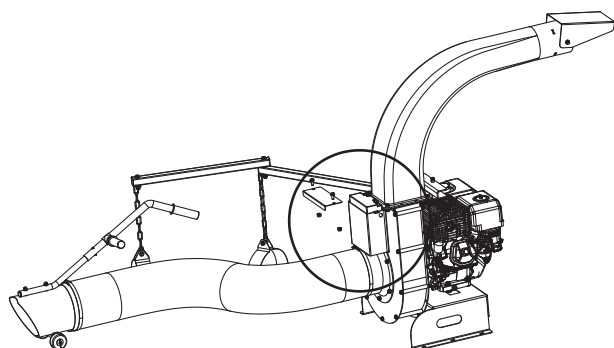
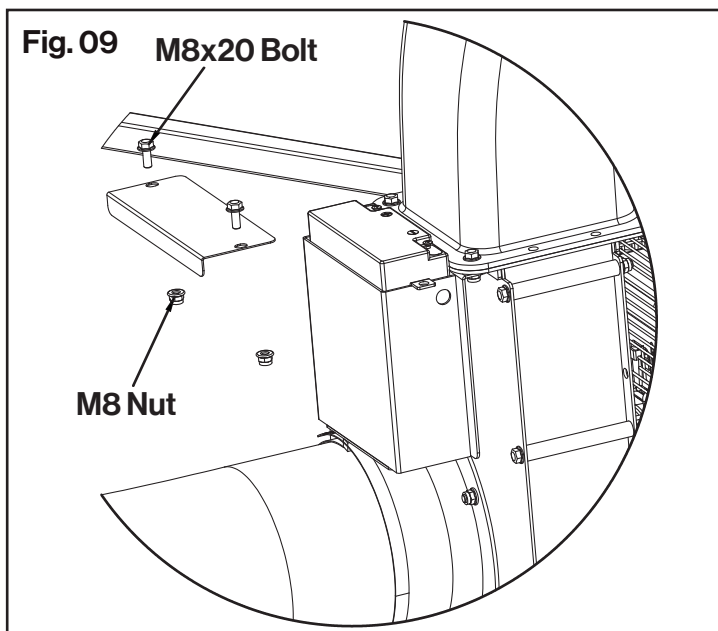

Fig. 09



Operation

Preparing For Operation

1. Check that all bolts are not loose before operation.
2. Keep the engine supplied with sufficient gasoline and oil.

DANGER

- 1. THE EXHAUST FROM THIS PRODUCT CONTAINS CARBON MONOXIDE GAS. CARBON MONOXIDE IS A COLORLESS, ODORLESS AND TASTELESS GAS THAT CAN CAUSE DIZZINESS, NAUSEA, UNCONSCIOUSNESS OR EVEN BRAIN DAMAGE AND DEATH IF INHALED FOR PROLONGED PERIODS.**
- 2. OPERATE THE UNIT OUTDOORS IN A WELL VENTILATED LOCATION ONLY. KEEP CHILDREN, PETS AND BYSTANDERS AWAY.**
- 3. FAILURE TO FOLLOW THESE INSTRUCTIONS MAY RESULT IN SERIOUS INJURY OR DEATH.**

1. Engine Operation

Before cleaning, repairing, or inspecting, shut off the engine and make certain that all moving parts have come to a complete stop. Disconnect the spark plug wire and secure the wire away from the spark plug to prevent accidental starting.

Adding Fuel

Notice: The machine is shipped without fuel from the factory.

- Remove the fuel cap and fill the tank without overfilling.
- Leave room for fuel expansion as per the engine manual's recommendations.
- Hand tighten the fuel cap. Starting and Stopping the Engine.

Adding Oil

Notice: The machine is shipped without oil from the factory. Oil is a major factor affecting performance and service life.

Add engine oil according to the engine manual, and familiarize yourself with relevant knowledge and procedures.

Handle fuel with care; it is highly flammable.

1. Use an approved fuel container.
2. Never add fuel to a running engine or hot engine.
3. Fill fuel tank outdoors with extreme care. Never fill fuel tank indoors.
4. Before restarting the engine, please clean up spilled fuel before restarting.

Gasoline Fires and Handling Fuel Safely

Use extra care in handling gasoline and other fuels. They are flammable and vapors are explosive.

1. When storing extra fuel be sure that it is in an appropriate container and away from any fire hazards.
2. Prevent fire and explosion caused by static electric discharge. Use only nonmetal, portable fuel containers.
3. If necessary, the fuel in the engine tank should be discharged outdoors. The discharged fuel should be handled carefully and stored in professional non-metallic fuel containers. Please store the fuel tank in the area with good ventilation conditions. Do not store the fuel tank indoors.
4. Never remove the fuel cap or add fuel with the engine running. Stop engine and allow to cool before filling.
5. Do not smoke while refueling or operating engine.
6. Never drain fuel from the engine in an enclosed area.
7. Always wipe up excess (spilled) fuel from engine before starting. Clean up spilled fuel immediately. If fuel is spilled, do not start the engine.
8. Test the fuel cap for proper installation before starting and using engine.
9. Never siphon fuel by mouth to drain fuel tank.
10. Always have an adult fill the fuel tank and never allow children to fill the tank.
11. Never allow an adult or anyone under the influence of drugs or alcohol to fill tank.
12. When storing gasoline or machine with fuel in the tank, store away from furnaces, stoves, water heaters or other appliances that have a pilot light or other ignition source because they can ignite gasoline vapors.

Starting / Stopping the Engine

1. Follow the engine manual for starting and shutting down procedures. Ensure the engine is running at full throttle before operation. For engines with adjustable throttle, move it to the SLOW position, wait for the engine to run at a slow RPM, and then switch to STOP ENGINE as described in the manual. Stopping the engine is crucial to halt the rotor from turning. Tips for Starting, Interrupting Operation, and Shutdown.
2. Start the engine as instructed in the manual, keeping hands and feet away from the vacuum suction or discharge chute. Do not adjust the engine governor settings or over speed it to avoid hazards.

Interrupting the Engine

1. Do not reposition the machine while it is running, as it may tip over and cause injury. Never leave the machine running unattended. Park the machine on flat ground, turn off the engine, and inspect for any signs of damage or foreign material if unusual noise or vibration occurs.
2. When not in use, always turn off the engine, wait for the impeller to stop, and disconnect the spark plug before moving the unit to a safe storage area. If equipped with a fuel valve, switch the throttle to low speed and shut down the fuel valve after the engine is stopped. Refer to the engine manual for specific shutdown details.

Prevention of Burns and Fires

1. Never remove the muffler guard from the engine.
2. Never touch the muffler guard because it is extremely hot and will cause severe burns.
3. Never touch parts of the engine that become hot after operation.
4. Always keep materials and debris away from muffler guard and other hot parts of the engine to avoid fires.

2. Truck Coupling Operation

Recommended Tools:

24mm Open-end wrench (x2)

1. Insert the hitch bar into the engine assembly kit and secure it with 2 M16x90 bolts and 2 M16 nuts sets. **(Fig.10)**

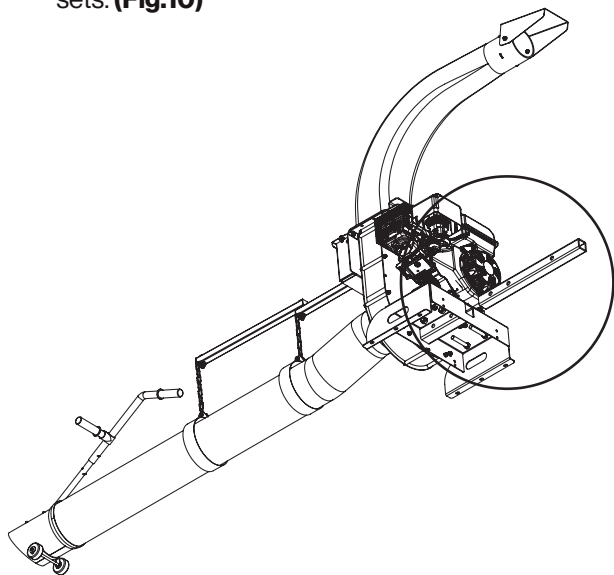
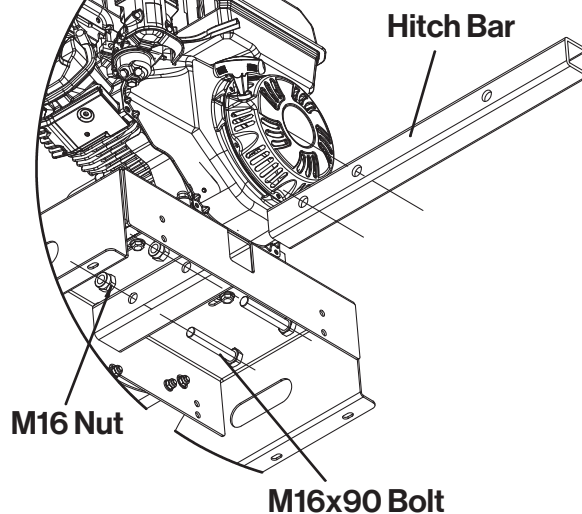

Fig. 10



Recommended Tools:

24mm Open-end wrench (x2)

2. Insert the hitch bar into the truck and secure it with M16x90 bolt and 2 M16 nut sets. **(Fig.11)**

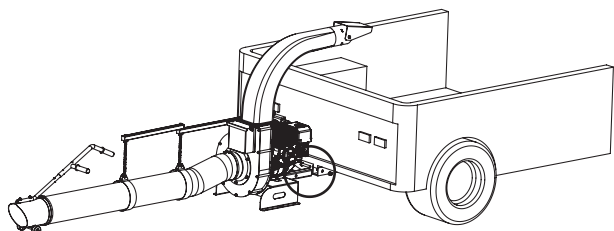
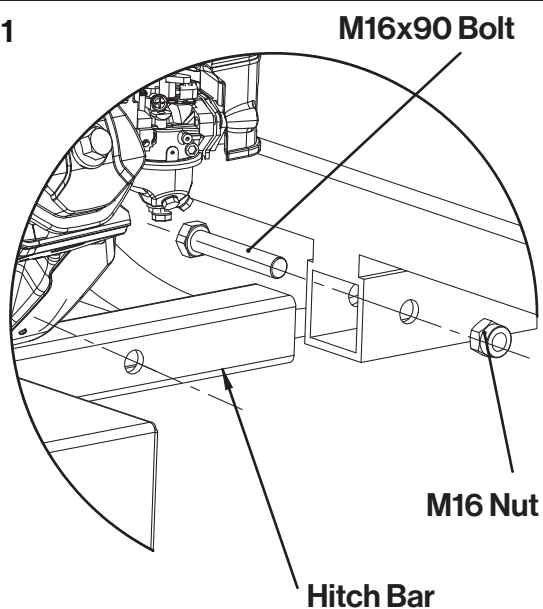

Fig. 11



3. Direction Plate Operation

Recommended Tools:

12mm Open-end wrench

13mm Open-end wrench

- Loosen the 2 M8x20 bolt and 2 M8 nut, Adjust the direction plate deflector to your desired direction. Then tighten the bolt and nut securely. **(Fig.12)**

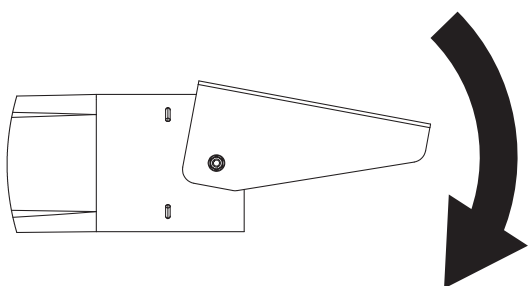
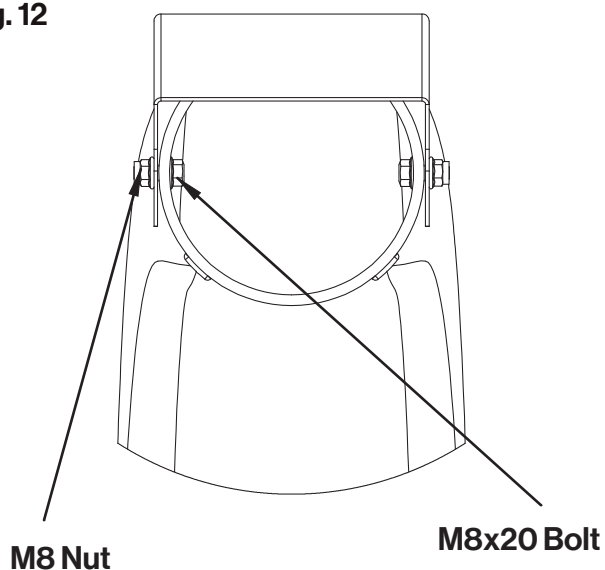
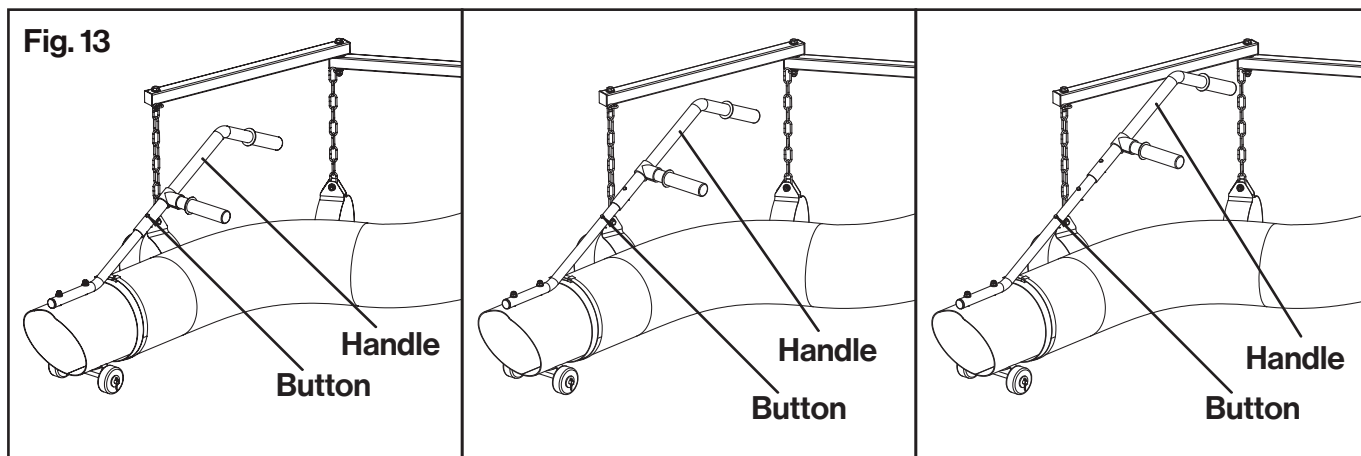

Fig. 12



4. Vacuum Operation

1. Press and hold the button to adjust the handle height as needed. **(Fig.13)**



2. Once the engine is started, the vacuum port will begin drawing material. Starting the engine, move the machine to the working area. the vacuum port will begin drawing material. **(Fig.14)**

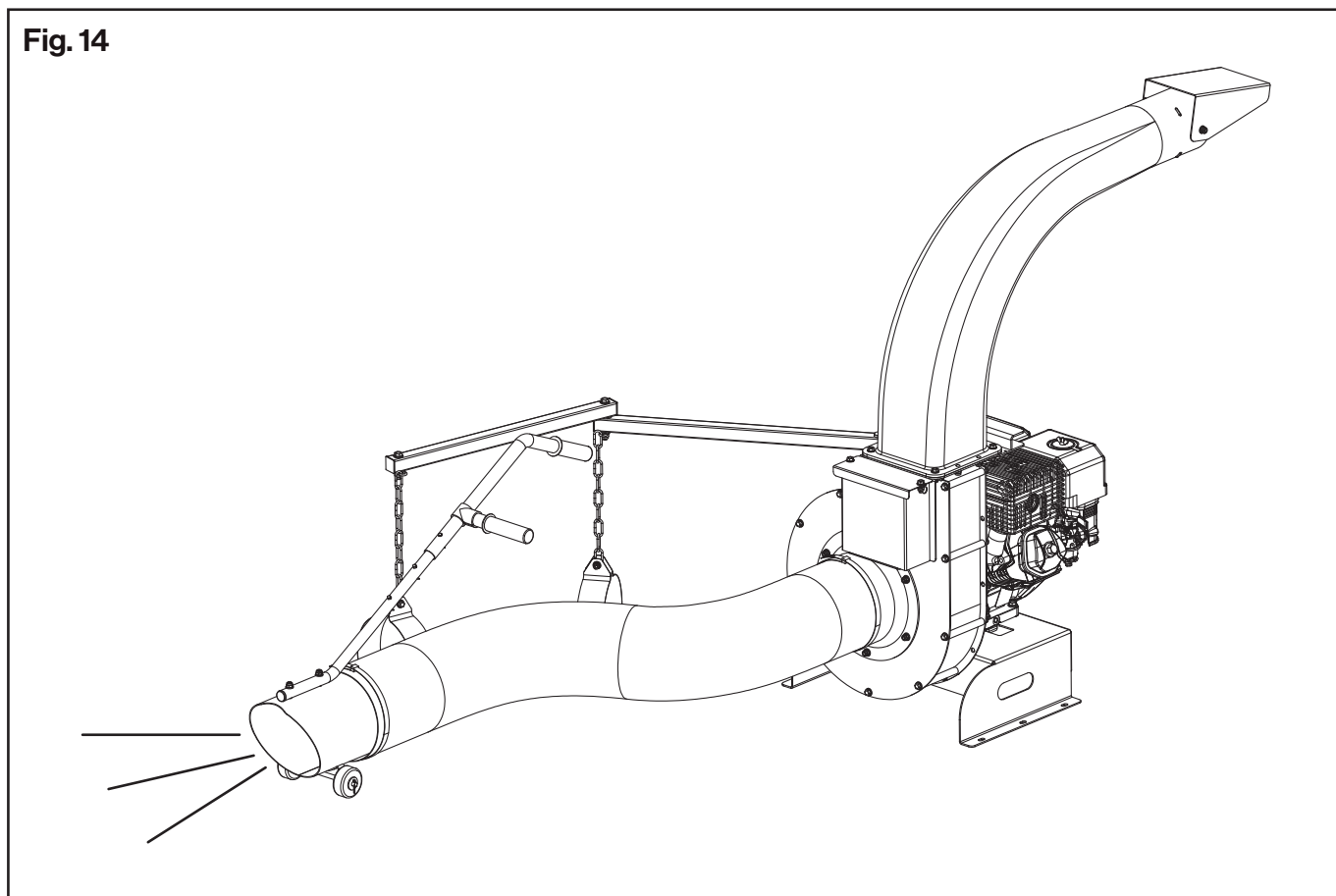

Troubleshooting

| Issue | Possible Cause | Solution |
|---|---|--|
| Engine won't start. | 1. No fuel. | 1. Add fuel. |
| | 2. Choke not in START position. | 2. Turn choke to START position. |
| | 3. Low quality or deteriorated, old gasoline. | 3. Use fresh unleaded gasoline. |
| | 4. Dirty fuel passageways. | 4. Clean out passageways using fuel additive. Heavy deposits may require further cleaning. |
| | 5. Spark plug cap not connected securely. | 5. Connect spark plug cap properly. |
| | 6. Spark plug fouled. | 6. Remove spark plug. Clean/replace as recommended in engine manual. |
| | 7. No compressions. Problem after long storage periods. | 7. Lubricate the cylinder, pour tablespoon of oil into spark plug hole. Crank engine a few times and try to start again. |
| | 8. Low engine oil. | 8. Add engine oil to proper level. |
| Engine exhaust is black. | 1. Dirty air filter. | 1. Replace air filter. |
| | 2. Choke closed. | 2. Open choke. |
| Engine stops suddenly. | 1. Fuel tank empty or full of impure or low quality gasoline. | 1. Add fuel tank with fresh unleaded gasoline. |
| | 2. Low oil shutdown. | 2. Fill engine oil to proper level. |
| | 3. Disconnected or improperly connected spark plug cap. | 3. Secure spark plug cap. |
| Engine runs but no material is discharged. | 1. Discharge chute clogged. | 1. Clean out debris. |
| | 2. Engine not running at full speed. | 2. Set throttle control to FAST if equipped. |
| Vacuum not working. | 1. Hose not attached properly. | 1. Clear blockage or replace. |
| | 2. Engine not running at full RPM. | 2. Set throttle control to FAST if equipped. |

Exploded and Parts List

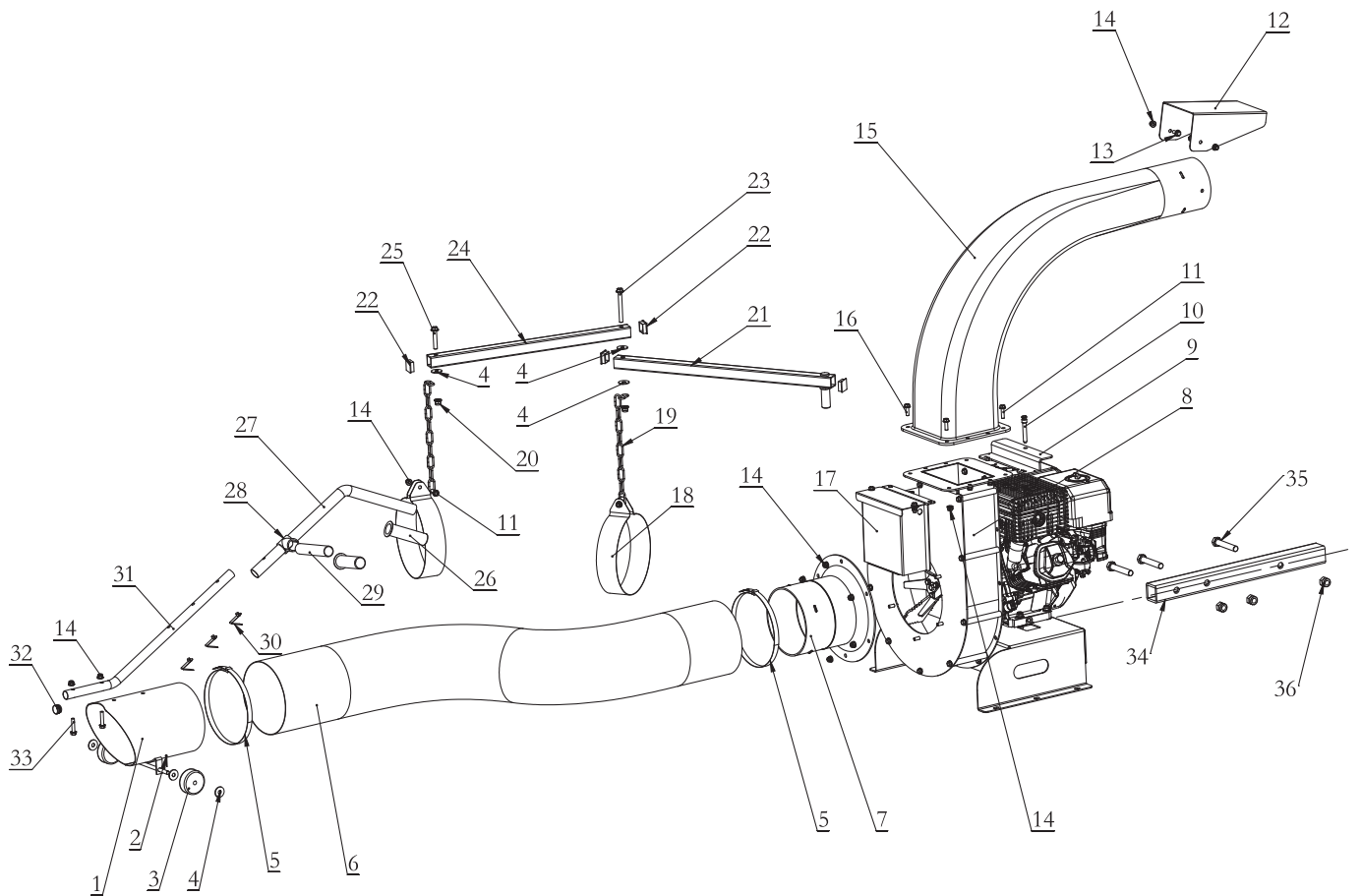

| Part No. | Description | Q'ty | Part No. | Description | Q'ty |
|----------|---------------------|------|----------|-------------------|------|
| 1 | Vacuum Port | 1 | 19 | Chain | 2 |
| 2 | Cotter Pin | 2 | 20 | M10 Nut | 2 |
| 3 | Wheel | 2 | 21 | Hose Holder Mast | 1 |
| 4 | Washer | 7 | 22 | End Cap | 4 |
| 5 | Hose Clamp | 2 | 23 | M10x90 Bolt | 1 |
| 6 | Hose | 1 | 24 | Hose Holder Arm | 1 |
| 7 | Hose Flange | 1 | 25 | M10x55 Bolt | 1 |
| 8 | Engine Assembly Kit | 1 | 26 | Handle Sleeve | 2 |
| 9 | Handle Holder | 1 | 27 | Top Handle-bar | 1 |
| 10 | Pin | 1 | 28 | Handle link | 1 |
| 11 | M8x30 Bolt | 4 | 29 | Left Handle-bar | 1 |
| 12 | Direction Plate | 1 | 30 | Button | 3 |
| 13 | M8x20 Bolt | 2 | 31 | Bottom Handle-bar | 1 |
| 14 | M8 Nut | 16 | 32 | End Cap | 1 |
| 15 | Discharge Chute | 1 | 33 | M8x40 Bolt | 2 |
| 16 | M8x25 Bolt | 2 | 34 | Hitch Bar | 1 |
| 17 | Battery Box | 1 | 35 | M16x90 Bolt | 3 |
| 18 | Ring | 2 | 36 | M16 Nut | 3 |

Optional Accessories & Components

The unit includes a standard connecting rod for standard truck/trailer connections. To enhance compatibility with diverse vehicle interfaces or expand functionality, the following optional accessories are available for separate purchase

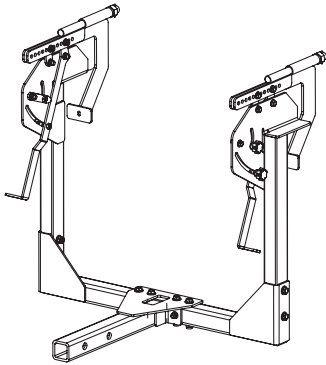

Tailgate Hanger

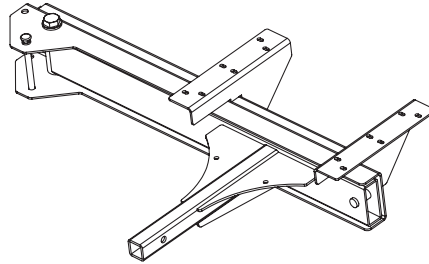

Swing Away Mount

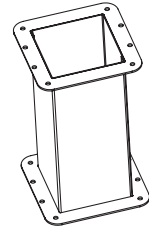

Extension Kit

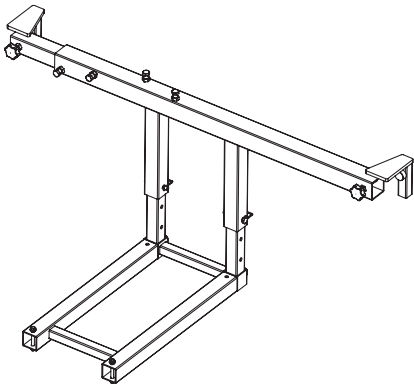

Transverse Mount

Maintenance and Storage

Engine Maintenance

Refer to the engine manual included in your package for information on engine maintenance. Your engine manual provides information and a maintenance schedule for performing the following tasks:

1. Always check oil level before starting engine. Refer to engine manual for capacity and type of oil to use.
2. Change oil after first 5-8 hours of operation. Change oil while engine is warm. Refill with new oil of recommended grade.
3. Check spark plug yearly or every 50 hours of operation.
4. Service air cleaner.
5. Keep engine and parts clean.
6. Check engine and equipment often for loose nuts and bolts, keep these items tightened.

Check for Loose Hardware

1. Service Interval: Every 5 hours; every spring and fall.
2. Inspect the unit, checking for loose hardware or components.

Vacuum System Maintenance

1. Maintenance Interval: Every 50 hours of operation or when suction power decreases
2. Check vacuum pipelines for blockages or leaks
3. Inspect fan blades for damage
4. Ensure all seals are intact
5. Perform a thorough system cleaning before long-term storage.

IMPORTANT

Engine is shipped from factory without oil. You must add engine oil before starting engine.

CAUTION

1. For the safety of the user, and to maximize the life of the engine, it is crucial to take time to check the condition of the engine.
2. Problems must be corrected before operating.
3. Avoid injury! Engine oil is hazardous to your health. Dispose of oil appropriately.
4. Use a safe disposal/recycling center.

Transportation & Storage Requirements

1. When storing the product, it must be placed in a cool, dry, dust-free place, away from direct sunlight and rain.
2. During product transportation, loading and unloading, it is strictly prohibited to throw, drop, toss, trample and other barbaric operations.

Warranty

Twelve (12) months for workmanship of the product, except for wearing parts. Warranty period starts from the product purchase date. Warranty covers material quality and workmanship only. Warranty does not cover product for issues caused by improper usage or any operation not in accordance with the specifications of this manual. Any modification or tampering with the product in any way voids the warranty.



Thank you for supporting our brand!

superhandyus.com



Great Circle USA
Support Line: 1-866-493-0524
help@superhandyus.com
www.superhandyus.com



Follow us on social media
@SuperHandy