

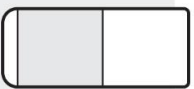

Thank You for Purchasing CONFERENCE SPEAKER

TCS100KU

What's in the Box



Conference Speaker
S100



Power Adapter
Warranty Card
USB Cable
User Guide

FCC Statement
Warning: Changes or modifications to this unit not expressly approved by the party responsible for compliance could void the user's authority to operate the equipment.

NOTE: This equipment has been tested and found to comply with the limits for a Class B digital device, pursuant to Part 15 of the FCC Rules. These limits are designed to provide protection against interference to other equipment in a residential installation. This equipment shall not be used in areas that are known to experience radio frequency interference, and it may cause interference to other equipment in such areas. This equipment may cause harmful interference to radio communications.

However, there is no guarantee that interference will not occur in a particular installation. If this equipment does cause harmful interference to radio or television reception, which can be determined by turning the equipment off and on, the user is encouraged to try to correct the interference by one or more of the following measures:

- Reorient or relocate the receiving antenna.
- Increase the separation between the equipment and receiver.
- Connect the equipment into an outlet on a circuit different from that to which the receiver is connected.
- Consult the dealer or an experienced radio/TV technician for help.

This device complies with Part 15 of the FCC Rules. Operation is subject to the following two conditions:
(1) This device may not cause harmful interference.
(2) This device must accept any interference received, including interference that may cause undesired operation.

ISED Regulatory Compliance

This device contains licence-exempt transmitter(s)/receiver(s) that comply with Innovation, Science and Economic Development Canada's licence-exempt RSS(S). Operation is subject to the following two conditions:

1. This device must not cause interference.
 2. This device must accept any interference, including interference that is received from another licence-exempt transmitter(s)/receiver(s) that is operating in the same radio frequency band.
- L'appareil ne doit pas produire de brouillage.*
L'appareil doit accepter tout brouillage radioélectrique subi, même si le brouillage est susceptible d'en compromettre le fonctionnement.

RF Exposure Compliance

This equipment complies with FCC/IC radiation exposure limits set forth for an uncontrolled environment.
This equipment should be installed and operated with minimum distance 20cm between the radiator and your body.
Cet équipement est conforme aux limites d'exposition aux radiations FCC/IC établies pour un environnement non contrôlé.
Cet équipement doit être installé et utilisé avec une distance minimale de 20 cm entre le radiateur et votre corps.

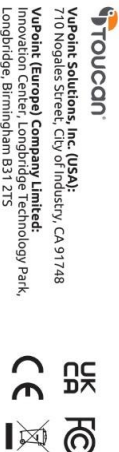

For additional info, visit our website at www.toucan.com

©2022 VUPOINT SOLUTIONS, INC. All Rights Reserved.
The Toucan logo and Toucan are trademarks or registered trademarks of VuPoint Solutions Inc. in the United States and other countries. The Bluetooth® word mark and logos are registered trademarks owned by Bluetooth SIG, Inc. Product names, logos, brands and other trademarks related to herein are the property of their respective trademark holders. All other trademarks are the property of their respective owners. These trademarks, logos, and products or services being provided. These trademarks, logos are not affiliated with VuPoint Solutions, Inc. They do not sponsor or endorse VuPoint Solutions, Inc.'s products or services.

Getting to know your Conference Speaker S100

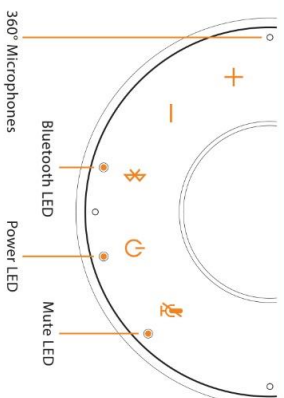

Volume up
Tap to increase volume

Volume down
Tap to reduce volume

Bluetooth
Connect with new Bluetooth device

Press and hold to enter Bluetooth pairing mode to connect with a new Bluetooth device

Disconnect or reconnect with Bluetooth device
Tap to disconnect or reconnect with a paired Bluetooth device

Power On/Off
Press and hold to turn S100 on/off

Mute
Mute microphone
Tap to mute or unmute microphone

Voice guidance
Press and hold 10s to turn voice guidance on/off

2 Connect S100 to your computer

- Plug the included USB cable into your computer and connect the end with the Type-C connector to S100.
- Select S100 as the default microphone and speaker source.

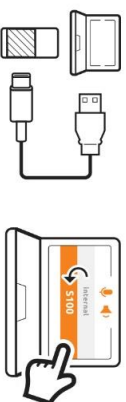

3 Connect S100 with a Bluetooth Device

- Press and hold for 2 seconds until the Bluetooth LED on S100 begins flashing. You will hear connection guidance voice prompts.
- Enable Bluetooth on your Bluetooth device.
- Select S100 from the list of available Bluetooth devices to connect.
- You will hear a successful connection message from S100.
- Tap to disconnect with connecting Bluetooth device.

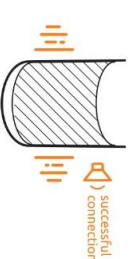

successful connection

Getting Started

1 Turn on S100

- Plug the included power adapter into a power outlet and connect the other end to S100.
- Press and hold for 1 second to turn S100 on and 2 seconds to turn it off.

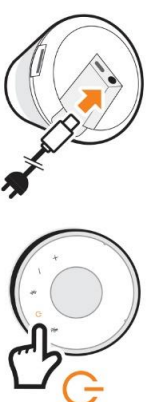

4 Mute/Unmute

- Tap while calling to mute or unmute the microphone.



For detailed product information, set up procedures and FAQ's please visit our website: www.toucan.com or scan the QR code.