

## Operator's Manual 6-Gallon Oil-free Air Compressor

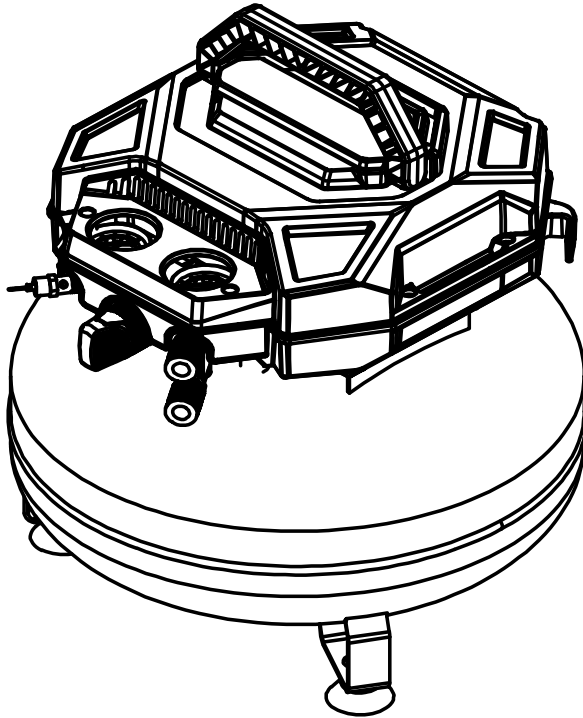

**CAUTION:** Before using this product, read this manual and follow all its Safety Rules and Operating Instructions.



**WARNING:** This product and dust created by its use may contain chemicals, including lead, known to the State of California to cause cancer, birth defects, or other reproductive harm. Wash hands after handling. For more information, visit [www.P65warnings.ca.gov](http://www.P65warnings.ca.gov).



**DO NOT RETURN TO STORE!**

**HAVE QUESTIONS OR NEED SERVICE?**



1-866-591-8921



[support@pulsar-products.com](mailto:support@pulsar-products.com)

# TABLE OF CONTENTS

	Page
Warranty . . . . .	see below
Safety Symbols . . . . .	.3
Important Safety Instructions & Guidelines . . . . .	.3
Specifications . . . . .	.4
Glossary . . . . .	.4
Parts & Features . . . . .	.5
Installation . . . . .	.6
Operating Procedures . . . . .	.7
Maintenance . . . . .	.8
Storage . . . . .	.8
Troubleshooting Guide . . . . .	.9
Exploded Views . . . . .	.10
Parts Lists . . . . .	.11
Service Number . . . . .	.Back Cover



## GOODYEAR LIMITED WARRANTY





**1 Year** – Limited on single-cylinder, oil-free compressors. This warranty is not transferable to subsequent owners.

**2 Year** - Limited on oil-lubricated and 'silent' air compressors. This warranty is not transferable to subsequent owners.

With proof of sale, please call 1-866-591-8921 for technical support, spare parts, or warranty related issues. **DO NOT RETURN THE PRODUCT TO THE STORE.** This warranty applies for only 30 days from the date of sale if this product is ever used while providing commercial services or if rented to another person. This warranty gives you specific legal rights, and you may also have other rights which vary from state to state.

## Safety Instruction

The information listed below should be read and understood by the operator. This information is given to protect the user while operating and storing the air compressor. We use the symbols below to allow users to recognize important information about their safety.





<p style="text-align: center;"> <b>DANGER!</b></p> <p>Indicates an imminently hazardous situation which, if not avoided, will result in death or serious injury.</p>	<p style="text-align: center;"> <b>CAUTION!</b></p> <p>Indicates a potentially hazardous situation which, if not avoided, may result in minor or moderate injury.</p>
<p style="text-align: center;"> <b>WARNING!</b></p> <p>Indicates a potentially hazardous situation which, if not avoided, could result in death or serious injury.</p>	<p style="text-align: center;"> <b>NOTICE</b></p> <p>Indicates a potentially hazardous situation which, if not avoided, may result in property damage.</p>





## Important Safety Instructions and Guidelines

### Save all instructions

 **WARNING!** This product can expose you to chemicals including Lead and DEHP, which are known to State of California to cause cancer, birth defects or other reproductive harm. Wash hands after handling. For more information go to [www.P65Warnings.ca.gov](http://www.P65Warnings.ca.gov).

Improper operation or maintenance of this product could result in serious injury and/or property damage. Read and understand all of the warnings and safety instructions provided before using this equipment.

<b>NOTICE</b>	<p>The air compressor should be operated on a dedicate 20 Amp circuit. If the circuit does not have 20 free Amps available, a larger circuit must be used. Always use more air hose before utilizing extension cords. All extension cords used must be 12 gauge with a maximum length of 25 ft. The circuit fuse type must be a time delay. Low Voltage could cause damage to the motor.</p>
<p style="text-align: center;"><b>Risk of Moving Parts</b></p> 	<p>If the air compressor is in operation, all guards and covers should be attached or installed correctly. If any guard or cover has been damaged, do not operate the equipment until the authorized personnel has correctly repaired the equipment. The power cord should be free of any moving parts, twisting and/or crimping while in use and while in storage.</p>
<p style="text-align: center;"><b>Risk of Burns</b></p> 	<p>There are surfaces on your air compressor that, while in operation and thereafter, can cause serious burns if touched. The equipment should be allowed time to cool before any maintenance is attempted. Items such as the compressor pump and the outlet tube are normally hot during and after operation.</p>
<p style="text-align: center;"><b>Risk of Falling</b></p> 	<p>Operation of the air compressor should always be in a position that is stable. Never use the air compressor on a rooftop or elevated position that could allow the unit to fall or be tipped over. Use additional air hose for elevated jobs.</p>
<p style="text-align: center;"><b>Risk from Flying Objects</b></p> 	<p>Always wear ANSI Z87.1 approved safety glasses with side shields when the air compressor is in use. Turn off the air compressor and drain the air tank before performing any type of maintenance or disassembly of the hoses or fittings. Never point any nozzle or sprayer toward any part of the body or at other people or animals.</p>

<p><b>Risk to Breathing</b></p> 	<p>Avoid using the air compressor in confined areas. Always have adequate space (12 inches) on all sides of the air compressor. Also keep children, pets, and others out of the area of operation. This air compressor does not provide breathable air for anyone or any auxiliary breathing device. Spraying material will always need to be in another area away from the air compressor to not allow intake air to damage the air compressor filter.</p>
<p><b>Risk of Electrical Shock</b></p> 	<p>Never utilize the air compressor in the rain or wet conditions. Any electrical issues or repairs should be performed by authorized personnel such as an electrician and should comply with all national and local electrical codes. The air compressor should also have the proper three prong grounding plug, correct voltage, and adequate fuse protection.</p>
<p><b>Risk of Explosion or Fire</b></p> 	<p>Never operate the compressor near combustible materials, gasoline or solvent vapors. If spraying flammable materials, locate the air compressor at least 20 feet away from the spray area. Never operate the air compressor indoors or in a confined area.</p>
<p><b>Risk of Bursting</b></p> 	<p>Always drain the air compressor tank daily or after each use. If the tank develops a leak, then replace the air compressor. Never use the air compressor after a leak has been found or try to make any modifications to the tank. Never modify the air compressor's factory settings which control the tank pressure or any other function.</p>

## Specifications

Pump .....	Oil-Free, Direct Drive	Air Tank Capacity .....	6 Gallons
Motor .....	1HP	Cut-in Pressure .....	120 PSI
Bore .....	1.97"	Cut-out Pressure .....	150 PSI
Stroke .....	1.26"	SCFM @ 90 PSI .....	3
Voltage Single Phase .....	120 VAC	SCFM @ 40 PSI .....	4
Rated Current .....	13 Amps		

## Glossary

- CFM:** Cubic feet per minute.  
**SCFM:** Standard cubic feet per minute; a unit of measure for air delivery.  
**PSIG:** Pounds per square inch gauge; a unit of measure for pressure.  
**ASME:** American Society of Mechanical Engineers.

**Cut-out Pressure:** The point at which the motor stops when the tank has reached maximum air pressure.

**Code Certification:** Products that bear one or more of the following marks: UL, CUL, ETL, CSA, have been evaluated by OSHA-certified independent safety laboratories and meet the applicable Underwriters Laboratories Standards for Safety.

**Cut-In Pressure:** The air compressor will automatically start to refill the tank when the pressure drops below the prescribed minimum.

## Parts & Features

- 1 **Tank Safety Valve** - Used to allow excess tank pressure to escape into the atmosphere. This valve should only open when the tank pressure is above the maximum rated pressure.
- 2 **Pressure Switch** - This controls the power to the motor and also the cut-in/cut-out pressure settings. This switch serves as the Auto-On/Off positions for the unit.
- 3 **Tank Pressure Gauge** - Indicates the reserve air pressure in the tank.
- 4 **Tank Drain Valve** - Used to drain condensation from the air tank.
- 5 **Quick Connect** - Offers a quick release feature for attaching and removing the air hose.
- 6 **Regulator Pressure Gauge** - Indicates the outgoing air pressure to the tool and is controlled by the regulator.
- 7 **Regulator**-The pressure coming from the air tank is controlled by the regulator. To increase the pressure, turn the knob clock wise, and to decrease the pressure, turn the knob counterclockwise.

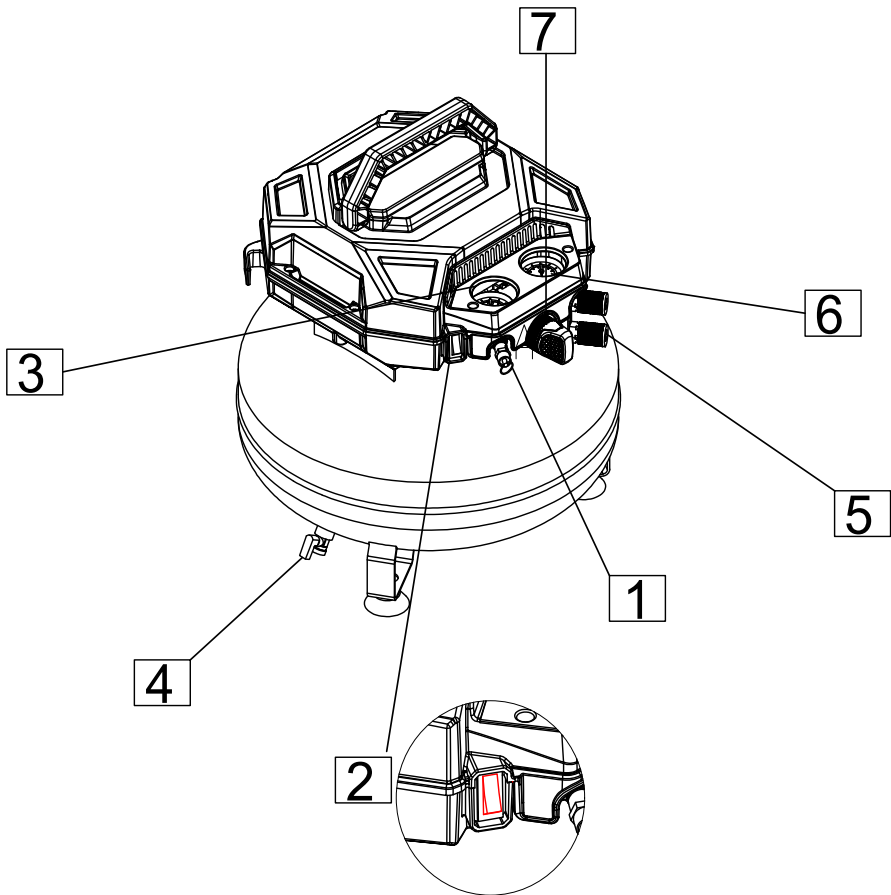

# Installation

## **WARNING!**

Before performing any maintenance, turn the compressor off, unplug from power source, bleed air from tank and allow unit to cool. Personal injuries can occur from moving parts, electrical sources, compressed air or hot surfaces.

## Installation

### Location of the Air Compressor

The air compressor should always be located in a clean, dry and well-ventilated environment. The unit should have at minimum, 12 inches of space on each side.

## **WARNING: Risk of fire or explosion**

This product includes an electric motor which tends to produce arcs and sparking. Do not expose this product to flammable liquids or vapors. This product is not intended for installation or use in a commercial garage or shop environment.

## Grounding Instructions

This product must be grounded. In the event of an electrical short circuit, grounding reduces the risk of electric shock by providing an escape wire for the electric current.

This product is equipped with a cord having a grounding wire with an appropriate grounding plug. (See figure below.)

The plug must be plugged into an outlet that is properly installed and grounded in accordance with all local codes and ordinances. Check with a qualified electrician or service personnel if these instructions are not completely understood or if in doubt as to whether the tool is properly grounded.

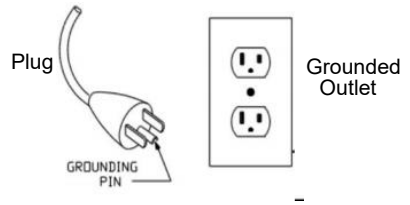

# Operation

## Daily Start-Up Procedures

1. Set the Auto-On/Off switch to the Off position.
  2. Inspect the air compressor, air hose, and any accessories or tools being used for damage or obstruction. If any of these items need repair or replacement, contact customer service at 1-866-591-8921.
  3. Close the drain valve (closed position shown; turn switch vertical to open).
  4. Connect the air hose to the quick connect socket on the regulator assembly by inserting the quick connect plug on the air hose into the quick connect socket. The quick connect socket collar will snap forward and lock the plug into place to provide an airtight seal.
- To release the air hose, push the collar back on the quick connect socket.
5. Plug the power cord into the proper receptacle.
  6. Turn the Auto-On/Off switch to the On-Auto position and the compressor will start and build air pressure in the tank to cut-out pressure and then shut off automatically.
  7. Adjust the regulator to a PSI setting that is needed for your application and be sure it is within the safety standards required to perform the task. If using a pneumatic tool, the manufacturer should have recommendations in the manual for that particular tool on operating PSI settings.
  8. The air compressor is now ready for use.

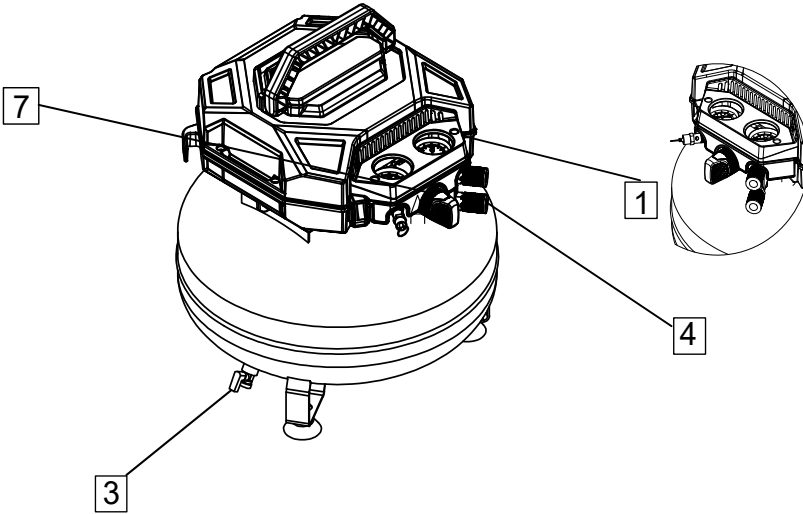

## Daily Shut-Down Procedures

1. Set the Auto-On/Off lever to the Off position
2. Unplug the power cord from the receptacle.
3. Set the outlet pressure to zero on the regulator.
4. Remove any air tools or accessories..
5. Pull the safety valve pull ring until the tank pressure gauge reads about 20 psi.
6. Only with the tank pressure below 20 psi. Open the drain valve, allowing air to bleed from the tank. After all of the air has bled from the tank, close the drain valve to prevent debris buildup in the drain valve.

### ⚠ CAUTION!

When draining the tank, always use ear and eye protection. Drain the tank in a suitable location' condensation will be present in most cases of draining.

### ⚠ WARNING!

Water that remains in the tank during storage causes the tank to rupture. To avoid serious injury, be sure to drain the tank after each use or daily.

# Maintenance

**NOTE:** Any service procedure not covered in the maintenance schedule should be performed by qualified service personnel. Contact customer service at 1-866-591-8921.

## **⚠ WARNING!**

Before performing any maintenance, turn air compressor off, unplug it from the power source, bleed air from the tank and allow the unit time to cool.

## **⚠ CAUTION!**

To ensure efficient operation and longer life of the air compressor, a routine maintenance schedule should be followed. The maintenance schedule shown to the right is intended for a consumer whose compressor is used in a normal working environment on a daily basis.

Maintenance Schedule	
Items to Check/Change	Before each use or daily
Check Tank Safety Valve	Each Use
Overall Unit Visual Check	Daily
Drain Tank	Daily
Check Power Cord for Damage	Each Use

## **Tank Safety Valve Check**

Check the safety valve as follows:

1. Plug the compressor in and run until cut-out pressure is reached.
2. Wearing safety glasses, pull out on the safety valve ring to release pressure from the tank.
3. The safety valve should close automatically at approximately 40-80 PSI. If the safety valve does not allow air to be released when pull out on the ring, or does not close automatically, it must be replaced.

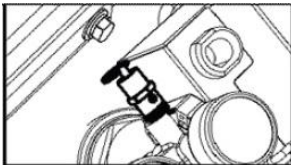

## **Storage**

When storing the air compressor, be sure to do the following:

1. Turn the unit off and unplug the power cord from the receptacle.
2. Remove all air hoses, accessories, and air tools from the air compressor.
3. Perform the daily maintenance schedule.
4. Open the safety valve pull ring until the tank pressure is about 20 psi.
5. Open the drain valve to bleed all air from the tank.
6. Close the drain valve.
7. Store the air compressor in a clean and dry location.

## Troubleshooting Guide

### **WARNING!**

The air compressor should be turned off and unplugged from the receptacle before any maintenance is performed as well as the air bled from the tank and the unit allowed time to cool. Personal injuries could occur from moving parts, electrical sources, compressed air, or hot surfaces.

PROBLEM	POSSIBLE CORRECTION
Air leaks at the check valve or at the pressure relief valve.	A defective check valve results in a constant air leak at the pressure relief valve when there is pressure in the tank and the compressor is shut off. Drain the tank, then remove and clean or replace the check valve.
Air leaks between head and cylinder.	Inspect for proper torque on head bolts. If leak remains, contact customer service at 1-866-591-8921.
Air leak from tank safety valve.	Operate the tank safety valve manually by pulling on the ring. If the valve continues to leak when in the closed position, it should be replaced.
Pressure reading on the regulated pressure gauge drops when an accessory is used.	If there is an excessive amount of pressure drop when the accessory is used, replace the regulator. <b>NOTE:</b> Adjust the regulated pressure under flow conditions (while accessory is being used). It is normal for the gauge to show minimal pressure loss during initial use of the tool.
Excessive tank pressure.	Move the Auto-On/Off lever to the Off position. If the unit doesn't shut off, unplug it from the receptacle and contact customer service at 1-866-591-8921
Motor will not start.	Make sure power cord is plugged in and the On/Off lever is turned on. If the circuit breaker trips, make sure the circuit and the breakers are rated for 15 amps, contact a technician if necessary.
	Make sure the Thermal Overload Switch has not tripped. The motor has a built-in thermal cut out that trips when necessary to protect the motor from damage when overheated.  To reset the motor overload turn the pressure switch Auto/Off lever to the Off position and unplug the unit from the power outlet. Allow 10 minutes minimum for motor overload cut-out to cool and reset. Unit can then be plugged in and restarted.
Thermal overload protector cuts out repeatedly	<ol style="list-style-type: none"> <li>1. Lack of ventilation, room temperature too high. Move to cooler environment.</li> <li>2. Excessive air usage, compressor too small for the application. Lower the rate of consumption.</li> </ol>
Excessive moisture in the discharge air.	Remove the water in the tank by draining after each use. High humidity environments will cause excessive condensation. Utilize water filters on your air line. <b>NOTE:</b> Water condensation is not caused by compressor malfunction. Be sure the compressor's air output is greater than your tool's air consumption rate.
Air leaks from the tank body or tank welds.	Never drill into, weld or otherwise modify the air tank or it will weaken. The tank can rupture or explode. Compressor tanks cannot be repaired. Discontinue use of the air compressor.

# Exploded View

GOODYEAR Air Compressor Model GYC6060SPK

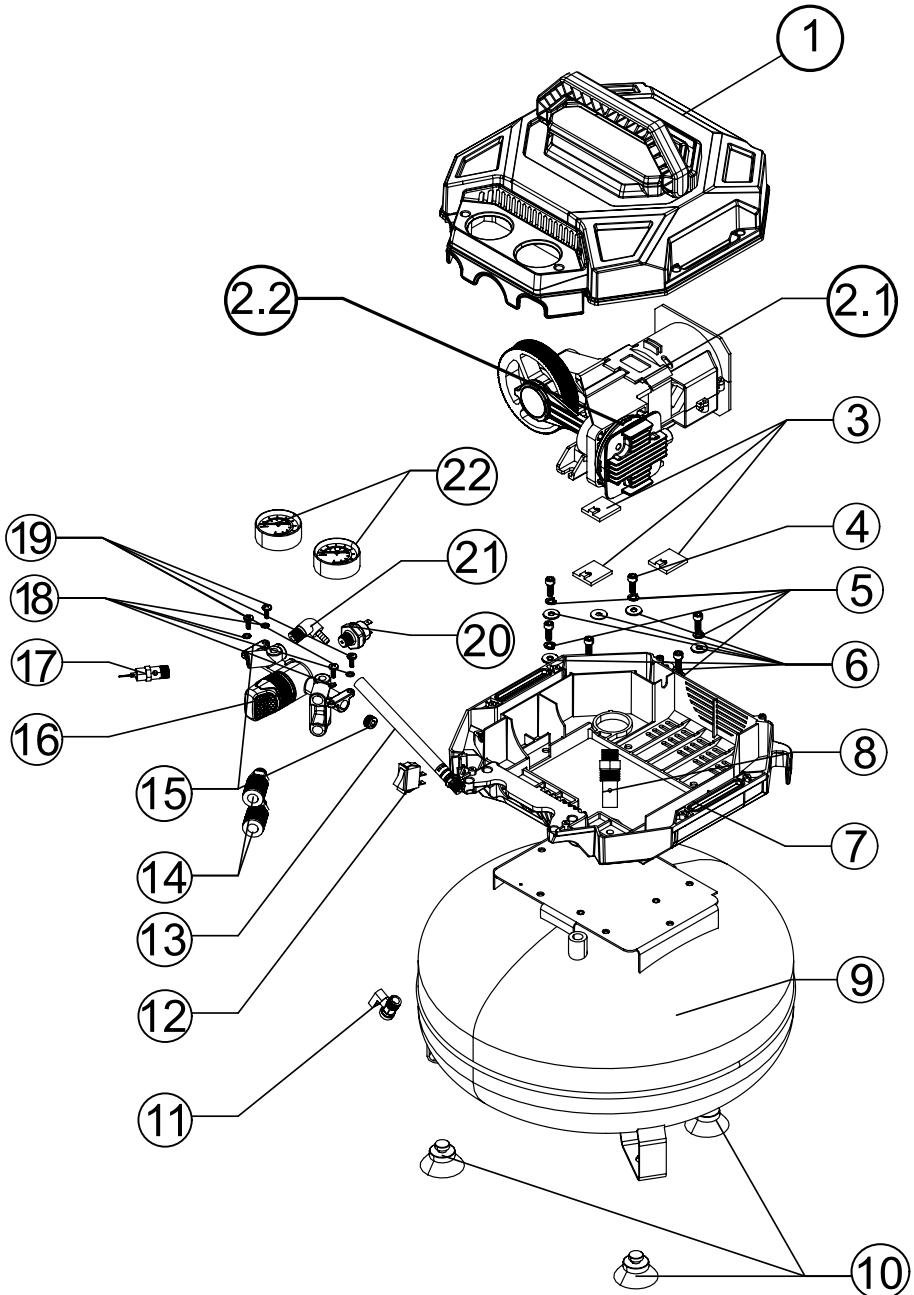

## Parts Lists

### GOODYEAR Air Compressor Model GYC6060SPK

Ref.#	Description	Quantity
1	Plastic upper cover	1
2.1	Motor components	1
2.2	Pump components	1
3	Pump body gasket	3
4	Screw	6
5	Spring washers	3
6	Flat washers	6
7	Plastic lowercover	1
8	Inlet Check Valve Assemblies	1
9	Tank components	1
10	Rubber floor mat	3
11	Drain ball valve	1
12	Power switch	1
13	Exhaust pipe	1
14	Quick coupling	2
15	Bulkhead	2
16	Regulators	1
17	Safety valves	1
18	Flat washers	4
19	Phillips pan head screws	4
20	Pressure switch	1
21	Air outlet elbow	1
22	Gauge	2



**For product questions or to order replacement parts,  
please call 1-866-591-8921 or email [support@pulsar-  
products.com](mailto:support@pulsar-products.com).**

Goodyear (and Winged Foot Design) are trademarks of or licensed to The Goodyear Tire & Rubber Company or Goodyear Canada Inc. used under license by Pulsar Products Inc, 8676 Rochester Ave, Rancho Cucamonga, CA 91730. © 2024 The Goodyear Tire & Rubber Company.