

# ***ARC-X***

## **Owner's Manual**

Please read this manual thoroughly  
before operating the ARC-X  
training e-collar.

# IMPORTANT SAFETY AND PRODUCT INFORMATION

## WARNING

Read all safety and product information below before using Dogtra products. Failure to follow these safety instructions could result in injury to you, your dog, and/or damage to Dogtra products or other property.

## PRODUCT SAFETY

### Training Methods

Dogtra products can be used with a variety of training methods. However, each dog may respond differently to training methods and Dogtra products. Observe your dog closely when determining the correct training method to use with Dogtra products.

### Aggressive Dogs

Do not use Dogtra products on aggressive dogs. Such dogs may react adversely and cause injury to people or other dogs. When dealing with an aggressive dog, seek the help of a dog training professional or veterinarian.

### Children and the disabled

Dogtra products are not toys. Adult supervision and extreme caution are required when Dogtra products are used by or near children.

## PRODUCT DAMAGE

### Electrical Product

Dogtra products include electrical components and batteries. Do not use or store the product near heat or flammable substances. Such use or storage may damage the product or cause fire, explosion, personal injury, or property damage.

## Medical Device Interference

Dogtra products contain electrical and magnetic components that emit low levels of electromagnetic radiation and radio frequencies. These electromagnetic waves or radio frequencies may interfere with pacemakers, defibrillators, or other medical devices. Consult your physician or medical device manufacturer before using any medical device with Dogtra products. If you think Dogtra products may interfere with your pacemaker, defibrillator, or other medical device, stop using Dogtra products.

## Inadvertent Activation

The digital microprocessor offers thousands of unique codes to eliminate frequency match-up with other Dogtra e-collars. The Constant button will automatically shut down after being held down for 12 seconds or more as a safety feature.

## Charging

Only charge Dogtra products with Dogtra Branded batteries and device chargers. Do not charge the product by any other means or at temperatures below 0°C (32°F) or above 45°C (113°F).

## Unauthorized use

Dogtra products should only be used in a humane manner to train and educate dogs. Dogtra products are not intended for use in any other way and are not intended for use on other animals or humans.

## Battery removal and disposal

Dogtra products include batteries. Be careful when removing or installing the battery as your fingers may be caught. Dispose of batteries according to local regulations. Do not disassemble, crush, heat or modify the battery. Fire, injury or property damage may result.

# CONTENTS

AT A GLANCE .....	6	8. BATTERY CHARGE .....	
MAIN FEATURES .....	7	9. ATTACHING THE BELT CLIP .....	33
OVERVIEW .....	8	10. USING THE TEST LIGHT .....	34
UNDERSTANDING YOUR TRAINING SYSTEM		GENERAL TRAINING TIPS .....	36
1. TURNING THE PRODUCT ON/OFF .....	12	MAINTENANCE .....	37
2. DEFAULT BUTTON SETTINGS .....	13	TROUBLESHOOTING GUIDE .....	39
3. SIDE BUTTON .....	14	FCC/ISED WARNING STATEMENT .....	41
4. SAFETY STIMULATION LEVEL LOCK .....	18	WARRANTY AND REPAIR INFORMATION .....	42
5. EXPANDABLE 3-DOG SYSTEM .....	18		
6. HOW TO ADD AN ADDITIONAL RECEIVER DEVICE .....	19		
7. X-SHIELD .....	20		
8. HANDSFREE SQUARE INFORMATION .....	21		
HOW TO USE THE RECEIVER	22		
1. RECEIVER FITTING .....	23		
2. HOW TO INSERT THE STRAP .....			
3. OBTAINING MAXIMUM DISTANCE .....	26		
4. FINDING THE RIGHT STIMULATION LEVEL .....	27		
5. NON-STIMULATION CONTACTS .....	28		
6. LED INDICATOR .....	30		
CARE FOR LCD TRANSMITTERS IN COLD	31		
7. TEMPERATURE .....	32		

## AT A GLANCE



### Optional Accessories

**Auto Charger** The input of the automatic charger for ARC-X is 12V ~ 24V and the output is 5V 1000mA.

### European Charger

Dogtra's European chargers are designed for use with 220V AC electrical outlets.

To purchase accessories, visit [www.dogtra.com](http://www.dogtra.com) or call customer service at (888) 811-9111.

## MAIN FEATURES

- 3/4-mile range
- Expandable to a 3-dog system
- IPX9K waterproof certified transmitter and receiver
- 100-level stimulation with Rheostat Dial and LCD screen for precise control
- Safety Stimulation Level Lock
- Constant stimulation with customizable Boost button for instant level increase
- LCD screen display for stimulation level and battery life
- 1 1/8" LCD Display
- Nick/Constant stimulation
- XPP (Extreme Performance Pager) Vibration
- Audible Tone
- Beacon & Locate LED Light
- Medium output receiver
- 2-hour rapid charge batteries for transmitter and receiver
- USB C-TYPE Charging
- Expandable up to 14 HANDSFREE SQUARES

# OVERVIEW



**ARC-X Transmitter**



**ARC-X Transmitter LCD Screen**

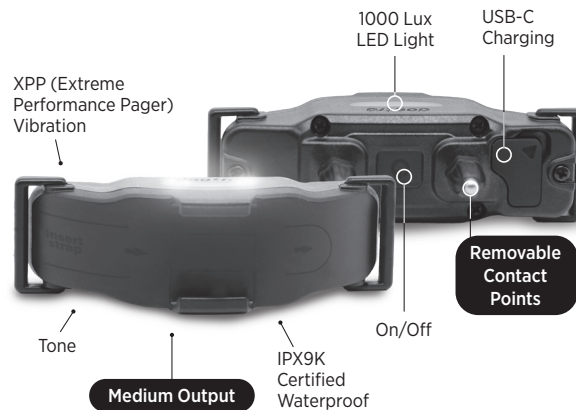

**ARC-X Receiver**

# UNDERSTANDING YOUR TRAINING SYSTEM

## 1. TURNING THE PRODUCT ON/OFF



The remote transmitter's power button is located on the bottom right. Press and hold the power button for 2 seconds to turn it on or off.



The receiver's collar power button is located between the contacts. Press and hold the power button for 2 seconds to turn it on or off. The LED indicator will turn solid green with a tone when the unit powers on and a red light with a tone when it powers off. (Press the power button briefly to turn on the backlight.)

## 2. DEFAULT BUTTON SETTINGS

### Front button (Nick or Constant)

The front button can be selected as Nick / Constant. The stimulus type indicated at the top of the display is applied. (Factory set to Nick mode)



### Front button settings

#### (PROGRAMMING BETWEEN NICK AND CONSTANT)



- 1) Set the stimulation level to "0".
- 2) Hold both the main front button and side power button together for 5 seconds to program Nick or Constant mode. The selected mode will be displayed on the top of the LCD screen.

### 3. SIDE BUTTONS



#### Boosted Constant

Apply Constant boost stimulation for up to 12 seconds at a pre-selected boost level. The stimulation level can be quickly increased without the user having to manually increase the level. Users can customize their desired jump level by pressing Boosted Constant.

**Base Displayed Level + Incremental Amount = Boosted Constant Output**

#### Example

Selecting “5” as the Incremental Amount for the Boosted Constant button will apply the output level of displayed level + 5, as shown below.

Base Displayed Level	Incremental amount (Boost amount)	Boosted Constant Output
1	+5	6
5	+5	10

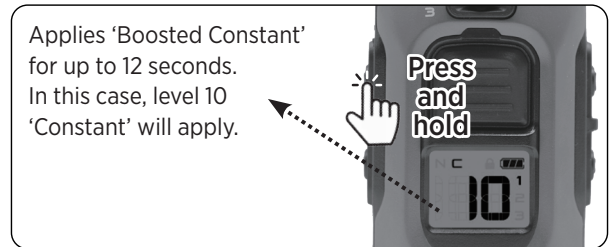
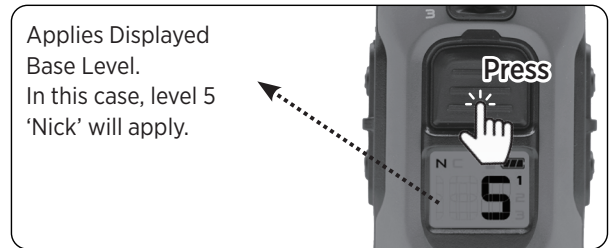

## Setting up Boost feature



1. Set the stimulation level to zero.



2. **Hold the Boosted Constant button for 5 seconds** until the LED light blinks; then release it.



3. Turn the Rheostat Dial to **select the incremental Boost amount** as shown on the LCD screen.

**Note:** Set the Boost level to 0 to use the Constant stimulation without Boost.



4. Tap the Boosted Constant button to save the setting.

**Note:** The saved setting will remain even if the unit is turned off. To reset the setting, repeat the steps above.

## Non-Stimulation Features



### XPP (Extreme Performance Pager) Vibration

Provides vibration for up to 12 seconds when held.



### Tone

Provides an audible tone for up to 12 seconds when held.



### LED Locate Light

Uses a 1000 lux LED Light on the receiver to locate your dog in the dark.

- For continuous blinking, every 4 seconds, tap the Locate Light button once.

To disable the continuous blinking, tap Locate button again.

- To manually enable the continuous blinking, press and hold the Locate Light button which can stay blinking for up to 12 seconds.



#### 4. SAFETY LEVEL LOCK



To prevent the stimulation level from changing unintentionally, press the switch at the top of the Rheostat dial for more than 2 seconds to lock it. When locked, a lock icon will appear on the LCD screen. To release lock mode, press the switch at the top of the volume again for more than 2 seconds.

#### 5. EXPANDABLE 3-DOG SYSTEM



If you purchase an additional receiver, you can use the front toggle switch to select the dog you want to stimulate. You can check the selected dog on the LCD screen.

#### 6. HOW TO ADD AN ADDITIONAL RECEIVER DEVICE



1) Turn on the transmitter and set the stimulation level to “0”. Use the toggle to select the desired dog (1,2 or 3).



2) To begin pairing, receiver must be off. Initiate pairing mode by pressing and holding the power button for 5 seconds until the LED starts blinking and then release.



3) Simultaneously press the front transmitter button and side Boost button until the screen reads “CD\*\*\*\*” then release. Confirm successful pairing by pressing Pager vibration.

**Repeat the pairing process if the pager vibration test is unsuccessful. The pairing between the devices has timed out or failed.**

CD\*\*\*\* : Product ID CODE

## 9. X-SHIELD INSTALLATION

Additional X-SERIES case covers, X-Shields are sold separately.

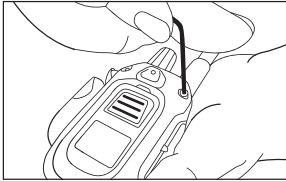

1. Use the included tool to loosen the four screws.

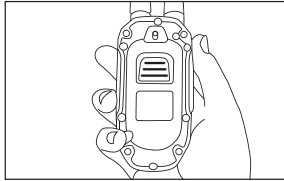

2. Remove the front case.

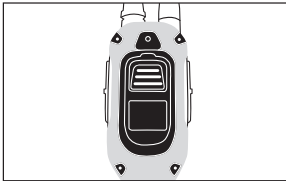

3. Place the new X-SHIELD on top of the unit to align with the screw holes.

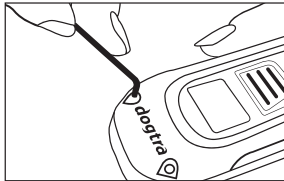

4. Use a tool to tighten the screws into the four holes.

## 10. HANDSFREE SQUARES PAIRING

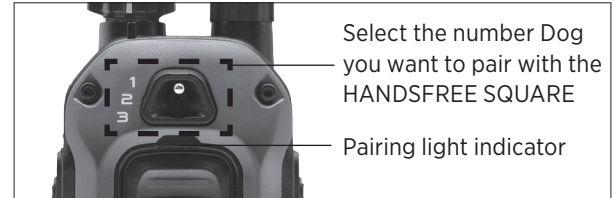

### HANDSFREE SQUARE PAIRING: NICK OR CONSTANT

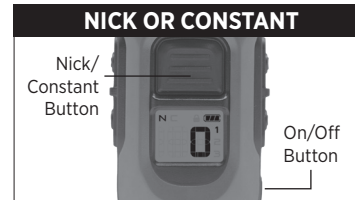

1. Turn the Remote On and set stimulation level to 0.
2. Select Nick or Constant by pressing and holding the POWER + CENTER (N/C) button for 5 seconds.
3. Once your desired function appears on the screen, **turn off** the remote transmitter.
4. Press and Hold the POWER + CENTER button until the rapid light blinks.
5. Press and hold the HANDSFREE SQUARE to code the desired function.

## HANDSFREE SQUARE Pairing: All other Functions

1. Begin with the remote transmitter turned off.
2. Press and hold the ON/OFF button + your desired function until you see the rapid light blink.
3. Press and hold the HANDSFREE SQUARE to code the desired function



Hold down the on/off button and the Boosted constant button.



Hold down the on/off button and the Pager button.



Hold down the on/off button and the Tone button.



Hold down the on/off button and the Light button.

### Range

The HANDSFREE SQUARE will need to be within 33 feet of the transmitter to work.

### Battery Life

The LED on the HANDSFREE SQUARE will blink when the button is pressed. Replace the battery in the HANDSFREE SQUARE when the LED no longer blinks.

### Caution!

Only 14 HANDSFREE SQUARES can be paired. When a 15th HANDSFREE SQUARE is paired, the initial 14 that were paired will reset and need to be paired again.

# HOW TO USE THE RECEIVER

## 1. RECEIVER FITTING

### Improper Fit

A loose fit can allow the receiver to move around on the dog's neck. When this happens, the contact points may rub against the skin and cause irritation. If the receiver is too loose, the contact will not be consistent and cause the corrections to be inconsistent. Dogtra uses medical grade stainless steel contact points and anti-microbial plastic to protect the dog's skin.

### Proper Fit

The receiver should be fitted so that the anti-microbial plastic contact points press firmly against the dog's skin. You should be able to fit two fingers underneath the collar strap. The Best location is on either side of the dog's windpipe.

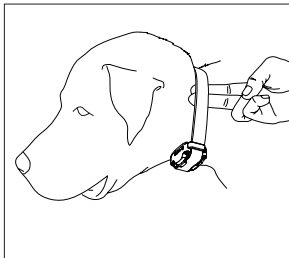

### Attention!

Leaving the receiver in the same location on the dog's neck for an extended period of time can cause skin irritation due to the sensitivity from the contact points. If the dog is to wear the receiver for long periods, occasionally reposition the receiver every few hours so that the contact points are moved to a different location on the dog's neck and remove the receiver after 8 hours of usage. Make sure you check for skin irritation each time you use the unit.

## 2. HOW TO INSERT THE STRAP

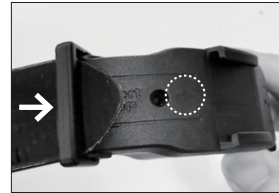

1. Insert the strap by looking at the direction of the arrow on the receiver.

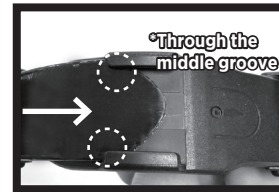

2. **Make sure to connect the middle groove of the receiver.** Holds the receiver steady without shaking



3. Attach the receiver to the strap by threading the strap through the opposite hole.

### 3. OBTAINING MAXIMUM DISTANCE

The operating range of the ARC-X is 3/4-mile. Depending on how you use the transmitter, the range of your transmitter may vary. For maximum range, hold the transmitter away from your body and avoid touching the antenna. Charge your device properly to maximize signal strength.

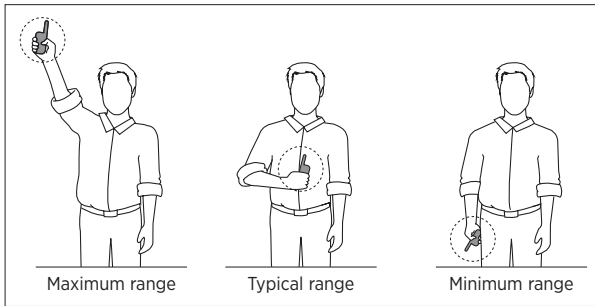

The range is reduced when the handheld transmitter's antenna is covered or in contact with your body. Refer to the following carrying methods for optimal range.

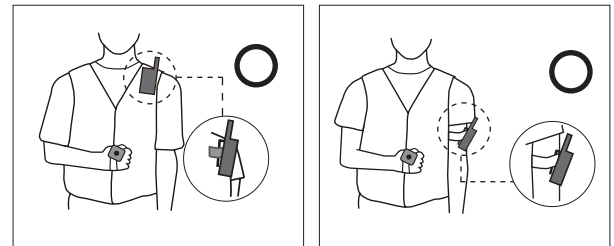

Carry the handheld transmitter with the antenna facing away from you.

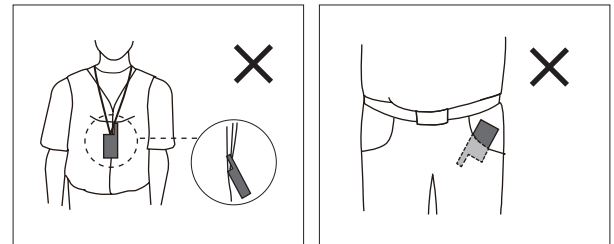

Do not place the handheld transmitter with the antenna touching your body or facing downwards.

#### 4. FINDING THE RIGHT STIMULATION LEVEL

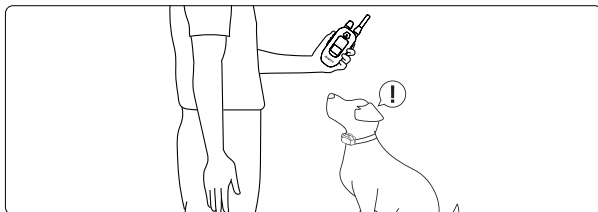

The ARC-X has a rheostat dial on the top of the transmitter. Always start at the lowest level and work your way up. You will find the right level when your dog responds to the stimulus with a mild response. You may also need to adjust intensity levels as your dog's demeanor changes, especially during times of increased excitement or distraction.

	<b>ARC-X</b>	Equivalent stimulation levels <b>ARC</b>
Max	<b>100</b>	127
	<b>90</b>	98
	<b>80</b>	86
	<b>70</b>	75
	<b>60</b>	62
	<b>50</b>	50
	<b>40</b>	32
	<b>30</b>	20
	<b>20</b>	13
Min.	<b>10</b>	9

#### 5. NON-STIMULATION CONTACTS



1. Please turn the contact points and remove them.



2. Place non-stimulation contacts in each place



3. Press non-stimulation contacts to secure the non-stimulation contacts

## 6. LED INDICATOR

The LED indicator flashes every 4 seconds when the receiver is on and ready for use. The LED indicator will blink on both the transmitter and the receiver when the transmitter buttons are pressed.

The LED indicator color indicates the battery life level.

**Green = Full charge**

**Amber = Medium charge**

**Red = Needs charge**

If the unit is used while the LED indicator is red, it may shut down automatically.



### Receiver Indicator Light

When the Constant button on the transmitter is pressed, the receiver indicator light will glow steadily (either green, amber, or red based on the remaining battery life), as long as you hold the button down, for up to 12 seconds. When the Nick button is pressed, the light comes on for a fraction of a second.

## 7. CARE FOR LCD TRANSMITTERS IN COLD TEMPERATURE

In cold temperatures (below 10°F), the transmitter's liquid crystal display (LCD) may appear dim or unresponsive. Wait until you see the display before selecting your training level. Even if the LCD screen goes dark or becomes unresponsive when you press a button, the transmitter still functions properly. In very cold weather, the LCD screen may take some time to respond, which may cause the intensity level to become stuck at the current level. Turning the rheostat dial will not change the level on the screen, but will change the actual intensity of the receiver.

## 8. BATTERY CHARGE

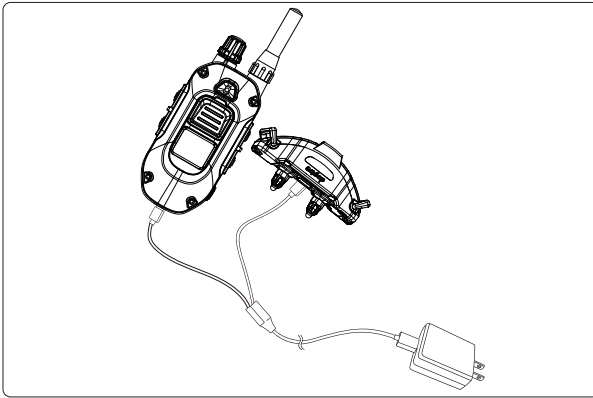

Dogtra ARC-X uses a lithium polymer battery. If the light is red, the device does not turn on, or the system does not stay on when you press the button, recharge the device.

**NOTE 1:** Use only Dogtra approved batteries, chargers and accessories with the Dogtra e-collar. This will prevent any damage that may occur if you try to use a different charger.

**Note 2:** The device will be partially charged when leaving the Dogtra facility. When you receive the system, be sure to give it an initial charge of 2 hours before using it for the first time in an area away from flammable materials.

**Note 3:** When the charger is not in use, unplug it from the power source. If the device will be stored unused for more than 3 months, fully charge the battery.

### To charge your system, follow the steps below:

1. Open the rubber plug on the battery charging port and connect the charging cable.
2. Connect the charger to a 120V wall outlet or, if using an automatic charger, to a cigarette lighter specifically designed for lithium polymer batteries (in Europe, use a 220V European charger). When connected properly, all lights will glow red and the device will automatically turn off during the charging process. After the device is fully charged and unplugged from the battery cable, the device must be turned on again before use.
3. The lithium polymer battery is fully charged within 2 hours. The light stays red while charging and turns green when the device is fully charged.
4. After charging, cover the battery charging socket with a rubber plug.

### Recharging is required in the following cases:

- The LED on the transmitter or receiver is red.
- The LED on the transmitter or receiver does not light.
- A low-battery sound occurs when the transmitter or receiver is powered off.

### Charger Info

Manufacturer: E-SUN

Manufacturing country: CHINA

Model name: MKC-0502500VT

INPUT: 100-240V-50/60Hz 0.4A

OUTPUT: 5V 2500mA

## 9. ATTACHING THE BELT CLIP

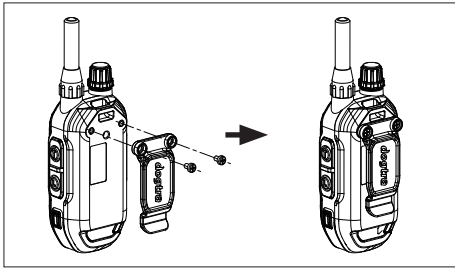

To attach the included belt clip, follow the instructions below.

1. Align the belt clip with the groove on the back of the transmitter.
2. Use a screwdriver to firmly tighten the screw of the belt clip.

### **Caution**

Firmly tighten both screws of the belt clip. Be careful not to overtighten.

## 10. USING THE TEST LIGHT



1. Turn on the receiver by pressing and holding the on/off button in the center of the contact terminal. The receiver's light will briefly turn on and then blink once every 4 seconds to indicate that the receiver is ready to use (if the light is red, the receiver needs to be charged).
2. Turn on the transmitter by pressing and holding the on/off button on the right side of the transmitter. The LED blinks every 4 seconds and the remaining battery life is displayed on the LCD screen. (If the battery icon on the LCD transmitter screen shows only 1 bar, it needs to be charged.)
3. Place the test light included in the package onto the contact points as shown.
4. Press the Nick button on the transmitter and observe the test light. It should only be on for a moment. (The higher the intensity, the brighter the test light.)
5. Observe the test light while pressing the Constant button on the transmitter. The button should light up as long as you hold it down. However, as a safety feature, if you press the Constant button for more

than 12 seconds, the receiver will automatically stop stimulation.

6. Turn the rheostat dial on the transmitter clockwise and then counterclockwise. The test light shines brighter at higher stimulus levels and dimmer at lower levels.

**Note:** The test light may not be visible if the intensity level is set below level ten.

## GENERAL TRAINING TIPS

Your dog must know some basic obedience commands before beginning training with the ARC-X. A dog learns by first being shown a command, followed by lots of repetition over an extended period. As the dog becomes proficient at these commands, the trainer can introduce distractions and different locations to strengthen the commands.

### **Obedience Training on the Leash**

Your dog must fully understand the obedience commands (sit, stay, here, heel, and kennel) before using the e-collar for reinforcement of these commands. A leash attached to a standard collar is used to "teach" the dog the basic obedience commands (sit, stay, here, heel, and kennel). A tug on the leash/collar is used to reinforce the command. When the dog complies with the command, use positive reinforcement/praise. Once the dog understands these commands, the e-collar can be used to reinforce them.

### **Beginning E-Collar Training**

When you feel your dog understands the obedience commands on the leash we can now start with the e-collar training. With the dog on the leash and wearing the e-collar, continue with your obedience drills. Apply light stimulation (Nick or Constant) when a command is given; the stimulation can be removed as the dog complies. Through repetition, the dog learns to perform the command.

The final step is the avoidance phase in which the dog learns that he can avoid the stimulation altogether by performing your commands. When these training procedures are complete, the e-collar is used as a reminder when the dog does not comply with your

commands at home or in the field. Keep your initial training sessions short and positive as dogs have a short attention span.

### **How Much Stimulation to Use**

Always start with low levels of stimulation and work your way up depending on the disposition of your dog and the given situation. By using the correct amount of stimulation to get your point across, you will have a more controllable environment and a dog that is under less stress. Animals (and humans) perform better in a less stressful environment.

**For more training information, please visit our website at [www.dogtra.com](http://www.dogtra.com).**

## **MAINTENANCE**

### **Basic Maintenance**

Make sure the rubber charging cap is securely in place when the system is in use. After each training session, carefully inspect the unit for any missing parts or damage to the casing. Damaged or broken casing may affect the waterproof guarantee on the unit. After confirming that there is no damage to the casing, rinse the receiver and clean out any dirt or debris.

### **Storage Maintenance**

The unit should be fully charged before storing for extended periods. While in storage, the unit should be given a full charge once a month and before the first use. Store the units in at room temperature. Do not keep the units exposed to extreme climates.

### **Troubleshooting**

If the unit is malfunctioning, please refer to the “Troubleshooting Guide” before sending it to Dogtra for service. If you have any questions or concerns, you may email them to [Info@dogtra.com](mailto:Info@dogtra.com), or call customer service at 1 (888) 811-9111.

# TROUBLESHOOTING GUIDE

## **1. My dog is not reacting to the system.**

- Make sure the receiver and transmitter are on.
- Make sure the collar strap is tight enough so both contact points are touching the dog's skin.
- The contact points may be too short for your dog's thick or long coat. You might need to trim down the hair on the dog's neck, so both contact points are touching the skin.
- The intensity level may be too low for your dog. Keep increasing the stimulation until the dog responds usually by neck movement, head shaking, looking over his shoulder, etc. (response may be very subtle so pay attention.)

## **2. The LED indicator light comes on, but I do not feel any stimulation.**

- The battery may be low, so check the LED light for battery life.

## **3. The transmitter has no range or stimulation is less when the dog is farther away.**

- The antenna(s) may be damaged. To order parts, please contact customer service at (888) 811-9111 or go to [www.dogtra.com](http://www.dogtra.com).
- The range indicated on the unit's box is for flat terrain. Heavy brush, trees, hills, or moisture will affect the range of your unit. For best range, hold the transmitter vertically above your head, and/or try moving to higher ground.
- Any electrical conductors will affect the range, such as cars, chain-link dog runs, metal structures, and radio towers. For best results, operate away from these objects.

## **4. My units are not holding a charge.**

- The batteries might not be charged properly, or the charger, splitter, and the charging port may not be functioning properly. You can send in your charging units to have us inspect them.
- The charging pin may be damaged. Inside the charging port, there is a metal pin that should be standing straight up and stiff. If the pin is wobbling, broken, or missing, you will need to send the unit in to the Repair Department. The charging port must be clean prior to charging; clean the dirt out with a cotton swab and some rubbing alcohol. If the dog is in saltwater, be sure to rinse the receiver and charging port with clean water.
- If the above does not resolve your issues, contact Dogtra customer service at [info@dogtra.com](mailto:info@dogtra.com) or (888) 811-9111.

## **5. My dog has skin irritation.**

- This may be due to an improper fit or from wearing the unit too long. If your dog exhibits signs of skin irritation, consult with a veterinarian. Once the dog's skin returns to a normal condition, continue to use the receiver and check your dog's neck each time you use the unit.

# FCC/ISED WARNING STATEMENT

## PART 15.19

This device complies with part 15 of the FCC Rules. Operation is subject to the following two conditions:

- (1) This device may not cause harmful interference, and
- (2) this device must accept any interference received, including interference that may cause undesired operation

## PART 15.21

Any changes or modifications (including the antennas) to this device that are not expressly approved by the manufacturer may void the user's authority to operate the equipment under FCC rules.

## PART 15.105

**Note:** This equipment has been tested and found to comply with the limits for a Class B digital device, pursuant to part 15 of the FCC Rules. These limits are designed to provide reasonable protection against harmful interference in a residential installation. This equipment generates, uses and can radiate radio frequency energy and, if not installed and used in accordance with the instructions, may cause harmful interference to radio communications. However, there is no guarantee that interference will not occur in a particular installation. If this equipment does cause harmful interference to radio or television reception, which can be determined by turning the equipment off and on, the user is encouraged to try to correct the interference by one or more of the following measures:

- Reorient or relocate the receiving antenna.
- Increase the separation between the equipment and receiver.
- Connect the equipment into an outlet on a circuit different from that to which the receiver is connected.
- Consult the dealer or an experienced radio/TV technician for help.

This device contains licence-exempt transmitter(s)/receiver(s) that comply with Innovation, Science and Economic Development Canada's licence-exempt RSS(s). Operation is subject to the following two conditions:

- (1) This device may not cause interference.
- (2) This device must accept any interference, including interference that may cause undesired operation of the device.

FCC and IC RF Radiation Exposure Statement: This equipment complies with FCC and IC RF Radiation exposure limits set forth for an uncontrolled environment.

This device and its antenna must not be co-located or operating in conjunction with any other antenna or transmitter.

# DOGTRA PRODUCT WARRANTY

## LIMITED WARRANTY

### For Dogtra Products Purchased from Dogtra Authorized Dealers

#### One-Year Warranty

Except as otherwise provided below, Dogtra warrants to the original retail purchaser ("You") that its Dogtra products shall be free of defects in materials and workmanship for a period of one (1) year from the date of purchase ("Warranty"). The Warranty covers the cost of repair (parts and labor) or replacement (if repair is not feasible) of a defective Dogtra product during said one-year period. For such repaired or replaced products, the remaining portion of the original warranty period, or ninety (90) days, whichever is longer, shall apply. Dogtra, at its sole discretion, shall determine whether to repair or replace a product covered by the Warranty.

#### Warranty Conditions

The Warranty is not transferrable and applies to your Dogtra product only if:

- (1) You are the original retail purchaser of the product,
- (2) You bought the product from a Dogtra authorized dealer, and
- (3) You present a receipt or other proof of purchase showing a valid purchase date, the name and address of the authorized dealer, and the purchased product identified by model and/or serial number.

#### Warranty Exclusions

The Warranty does not cover damage, loss, or deterioration to your Dogtra product caused: by misuse, neglect, abuse, or other improper handling of the product; by failure to follow use or care instructions; by use of the product for other than its intended purpose; by accident or natural forces such as fire or flooding; or by normal wear and tear such as scratches to the product surface.

The Warranty also does not cover Dogtra products that: are purchased from non-authorized dealers; are purchased outside of the United States or Canada; have been damaged during shipment (even if Dogtra paid or arranged for shipping); have been modified or tampered with in any manner; are opened or repaired by anyone other than Dogtra; or have serial numbers that have been altered or defaced.

#### Sole Warranty

This Warranty is the only warranty offered by Dogtra for its Dogtra products. Other than said Warranty, Dogtra makes no other representations or warranties whatsoever regarding its products, whether oral or in any

product manual, on any packaging, on any website, or in any other written material. No dealer of Dogtra products, nor any employee or agent of Dogtra, is authorized to make any additions, changes, or extensions to the Warranty. Dogtra, at its sole discretion and at any time, reserves the right to modify the Warranty.

#### **DISCLAIMER OF OTHER WARRANTIES**

**THE FOREGOING WARRANTY IS PROVIDED IN LIEU OF ALL OTHER WARRANTIES, WHETHER EXPRESS OR IMPLIED. DOGTRA DISCLAIMS ANY IMPLIED WARRANTIES INCLUDING, BUT NOT LIMITED TO, THE IMPLIED WARRANTIES OF MERCHANTABILITY AND FITNESS FOR A PARTICULAR PURPOSE.**

#### **Limitation of Remedies**

Dogtra's liability is limited to the cost of repair or replacement of the Dogtra product under Warranty. Any claim or action to enforce the Warranty must be commenced within thirty (30) days of the Warranty's expiration for your product. Dogtra will not be liable for any indirect, incidental, special, consequential, or similar damages based on breach of warranty, breach of contract, negligence, strict tort, or any other legal theory related to Dogtra and its products. Damages that Dogtra will not be responsible for include, but are not limited to: loss of income or profits; loss of revenue or savings; loss of use of the product or associated products; cost of any substitute products or services; inconvenience, downtime, or any other time; loss of goodwill; claims of third parties including customers; and damage to property.

#### **Legal Rights May Vary By State or Jurisdiction**

The Warranty gives You specific legal rights, and You may also have other rights which vary by state or jurisdiction. Some states or jurisdictions do not allow certain limitations of implied warranties or of incidental or consequential damages or other remedies, so certain of the foregoing limitations may not apply to You.

If any portion of the Warranty is held by a court to be invalid or unenforceable, the remaining portions of the Warranty shall remain in full force and effect and shall in no way be affected or invalidated, and the invalid or unenforceable portion shall be modified so as to most nearly achieve the intent of the Warranty.

#### **Product Registration**

Dogtra recommends that customers register their products as soon as possible after purchase. Product registration will facilitate any future warranty service. You may also receive useful information and updates

about your existing and future Dogtra products. To register your product, visit [www.dogtra.com/product-registration](http://www.dogtra.com/product-registration). If your product is not registered with Dogtra, You will be required to provide a receipt or other proof purchase (as provided above) to qualify for warranty service.

#### **How to Obtain Warranty Service**

Should your Dogtra product require warranty service, please contact Customer Service by phone or email for a warranty evaluation (see below for contact information). Upon approval of your warranty work, Dogtra will repair or replace (at Dogtra's election) your product without charge for labor or parts. You are responsible for shipping, including cost, of your product to Dogtra for warranty service. Dogtra will handle shipping, including cost, of the repaired or replaced product back to customers in the USA. Dogtra will not be responsible for shipping, including cost and/or applicable taxes or fees, for products sent to Canada. Such costs, taxes, or fees will be borne by the customer.

To register your product, visit [www.dogtra.com/product-registration](http://www.dogtra.com/product-registration).

#### **Dogtra Customer Service**

12322 Monarch Street, Garden Grove, CA 92841  
(888) 811-9111  
repair@dogtra.com  
Mon – Fri, 8:00 AM to 4:30 PM (PST)

© 2025 Dogtra. All rights reserved.