

ASSEMBLY INSTRUCTION

Step 1: Push the □ type door holder and pull up the bottom of the door in the direction separately as the arrow shows and secure safety latch as below picture.

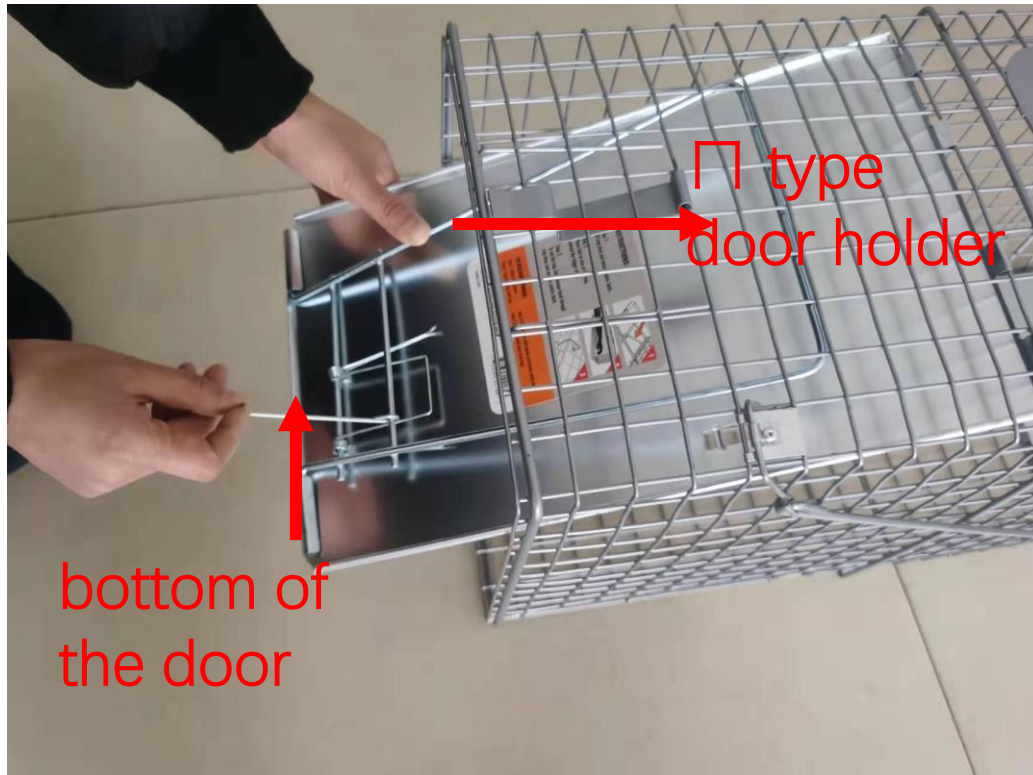

Step 2: Put the bait behind the trigger plate in the cage

Caution: Please be sure to secure safety latch in order not to get injured when placing bait.



Step 3: Pull the door up to the top and latch hook through trap door until the trigger settled.

Trigger:

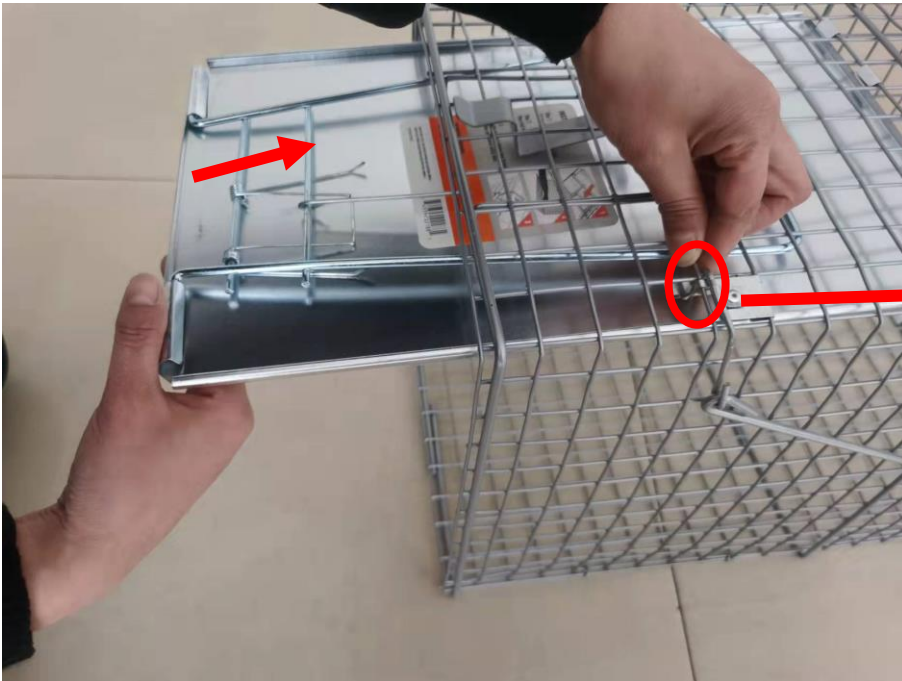

Step 4: Release the safety latch then the trap setting is finished.

