

STEP 9
REMOVE FOUR SETS OF HEXAGONAL NUTS, SPRING WASHERS AND BOWL WASHERS FROM MOTOR. SAVE THEM FOR STEP 10.

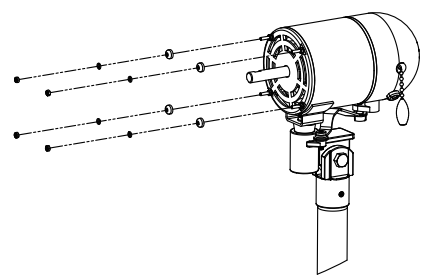

STEP 10
SET REAR GUARD IN PROPER POSITION WITH ITS SECURE HOLE DOWNWARD, AND FIX IT ON MOTOR BY RETIGHTENING THE HEXAGONAL NUTS, SPRING WASHERS AND BOWL WASHERS FROM STEP 9.

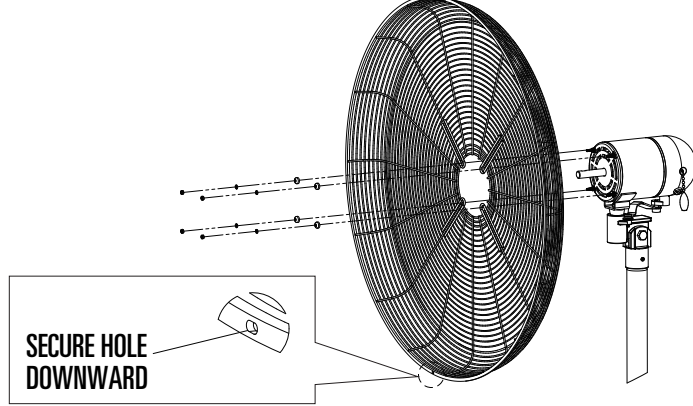

STEP 11
ASSEMBLE FAN BLADE ONTO MOTOR SHAFT BY TIGHTENING TWO SCREWS FROM BLADE. MAKE SURE THE SCREWS ARE TIGHTLY SECURED.

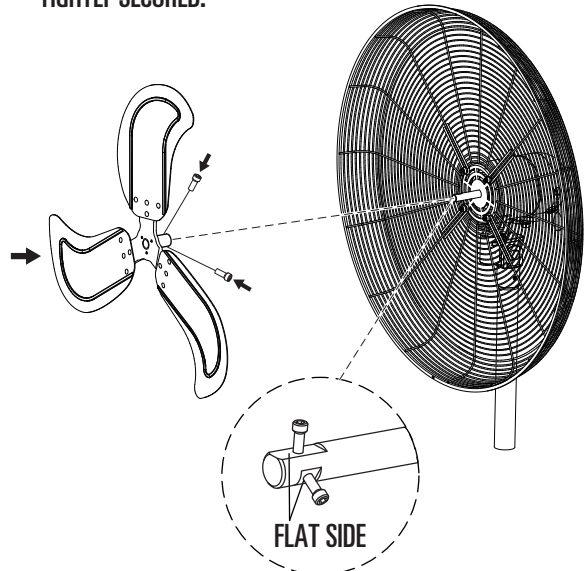

STEP 12
ASSEMBLE FRONT GUARD TO REAR GUARD BY FIXING BOTH GUARDS TOGETHER WITH CLIPS ON THE RIM OF FRONT GUARD.

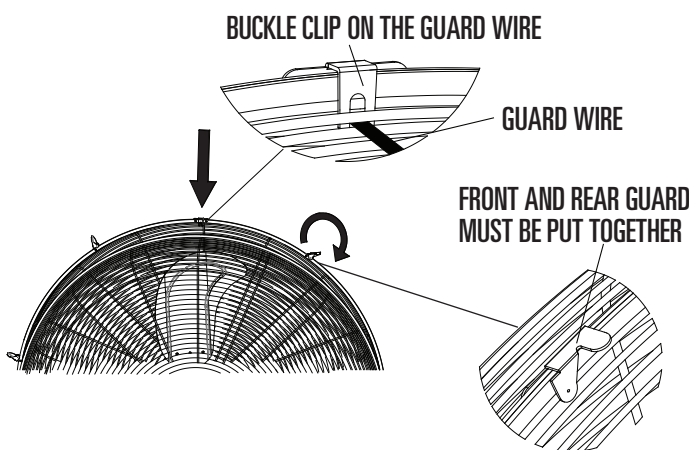

STEP 13
SECURE THE ASSEMBLY OF FRONT GUARD AND REAR GUARD BY TIGHTENING ONE SCREW M3*10, TWO START WASHER ϕ 3 AND ONE HEXANGULAR NUT M3.

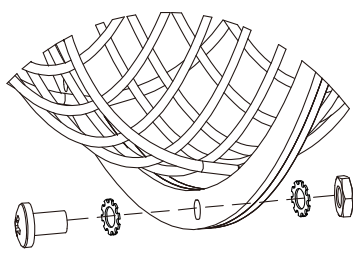

OPERATING INSTRUCTIONS

1. ADJUST THE DESIRED SPEED BY PULL CHAIN SWITCH WITH 3 SPEEDS CONTROL.
2. TO ADJUST THE HEIGHT, LOOSEN THE HEIGHT ADJUSTMENT KNOB. PULL UP OR PRESS DOWN THE EXTENSION PIPE TO YOUR DESIRED HEIGHT AND SECURE IT BY TIGHTENING BACK THE HEIGHT ADJUSTMENT KNOB.

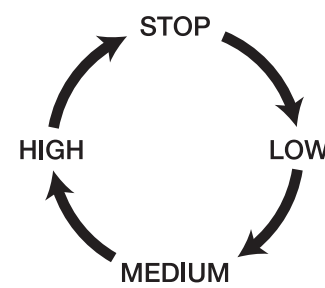

OPERATING INSTRUCTIONS

1. TO MAKE THE FAN HEAD OSCILLATE: LOOSEN THE SCREW AND MOVE THE POSITION A. TIGHTEN IT BACK.
NOTE: THE SCREW IS PRESET AT POSITION A AT THE FACTORY.
2. TO STOP THE FAN HEAD OSCILLATE: LOOSEN THE SCREW AND MOVE TO POSITION B. TIGHTEN IT BACK.
CAUTION: SWITCH OFF THE FAN BEFORE ADJUSTING FAN HEAD OSCILLATION.

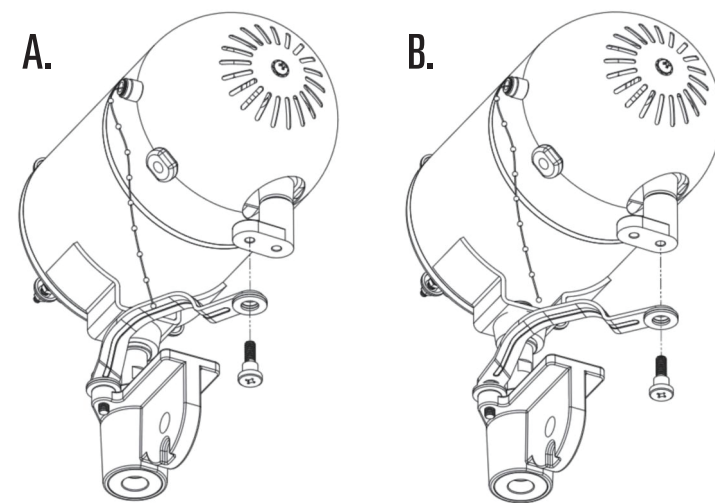

NOTE: FOR LONGER PARTS LIFE, AFTER 10 HOURS OF CONTINUOUS OPERATION, TURN FAN OFF FOR 15 MINUTES TO ALLOW MOTOR TO COOL.

TROUBLESHOOTING GUIDE

PROBLEM	POSSIBLE CAUSE	CORRECTIVE ACTION
THE FAN FAILS TO OPERATE	1. FAN MAY NOT BE PLUGGED IN.	1. MAKE SURE THE FAN IS PLUGGED IN AND ELECTRICAL OUTLET IS WORKING PROPERLY.
	2. THERE MAY SOME BE OBSTRUCTION IN THE FAN.	2. CHECK FOR ANY OBSTRUCTION. IF YOU FIND AN OBSTRUCTION, TURN THE FAN "OFF". UNPLUG THE FAN AND CAREFULLY REMOVE THE OBSTRUCTION. PLUG THE FAN IN AND TURN IT ON AGAIN, REFERRING TO THE OPERATION INSTRUCTIONS.

TECHNICAL DATA

MODEL NO.	BLADE DIA. SIZE	VOL./ Hz	SPEED	INPUT POWER
SFSI-750MW	30 IN./750MM	AC 120V /60 Hz	HIGH	240W
			MEDIUM	200W
			LOW	185W

USER MANUAL AND OPERATING INSTRUCTIONS



30 IN. INDUSTRIAL PEDESTAL FAN

SKU NO.: 5002308 MODEL NO.: SFSI-750MW

READ AND SAVE THESE INSTRUCTIONS FOR FUTURE USE

IMPORTANT: READ ALL INSTRUCTIONS CAREFULLY BEFORE ASSEMBLY, SERVICE OR USE OF THIS FAN. FAILURE TO COMPLY WITH THESE INSTRUCTIONS COULD RESULT IN SERIOUS PERSONAL INJURY AND/OR PROPERTY DAMAGE.

Distributed by:
TRACTOR SUPPLY COMPANY
5801 VIRGINIA ROAD
BENTWOOD, TN 37027
For customer support, call:
1-888-376-9601
www.TractorSupply.com
MADE IN CHINA

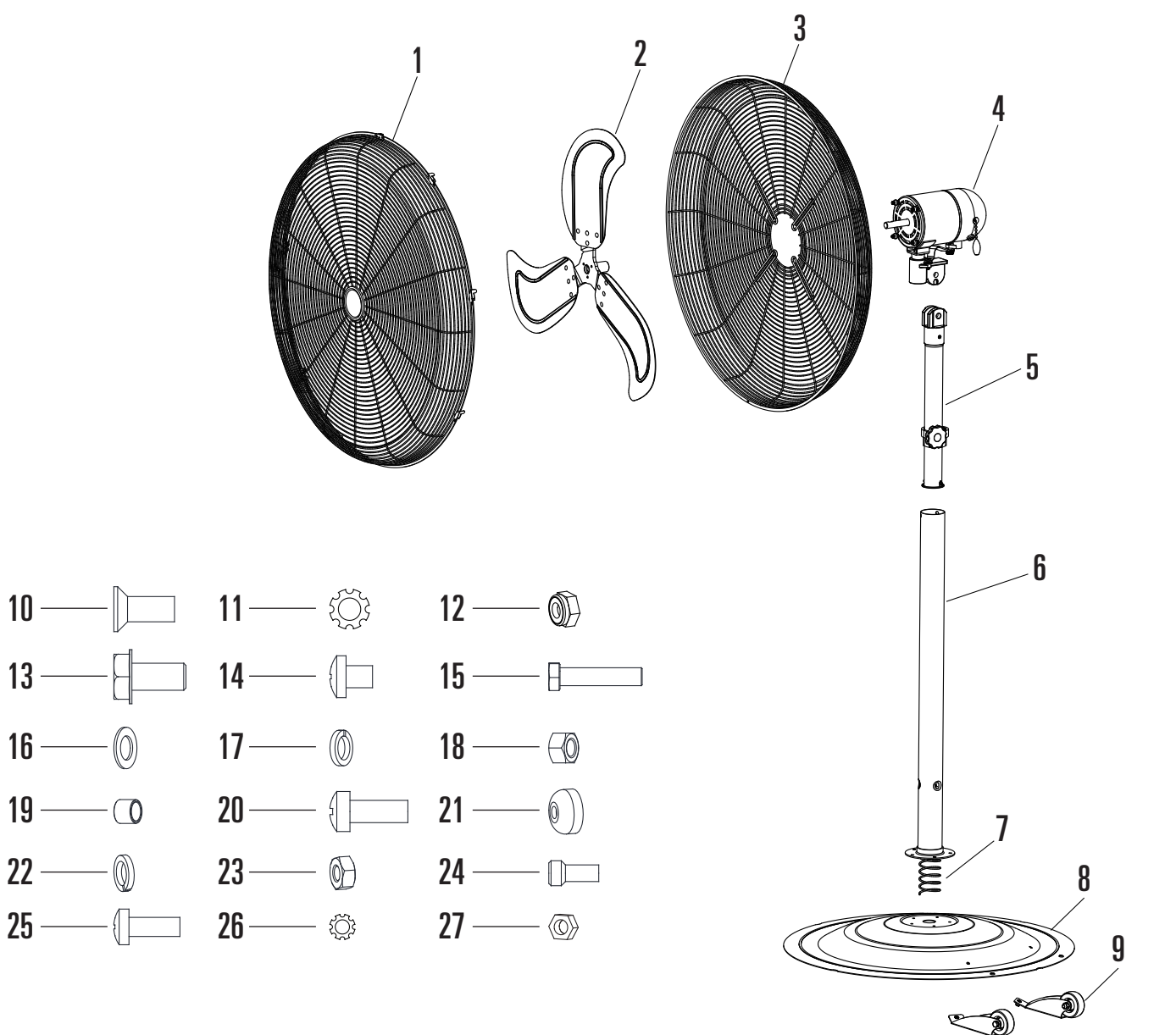

10	11	12
13	14	15
16	17	18
19	20	21
22	23	24
25	26	27

PART	DESCRIPTION	QUANTITY	PART	DESCRIPTION	QUANTITY	PART	DESCRIPTION	QUANTITY
1	FRONT GUARD	1	10	M5*12 SCREW	4	19	ϕ 19* ϕ 15 WASHER	1
2	BLADE	1	11	ϕ 5 STAR WASHER	4	20	M6*16 WASHER	1
3	REAR GUARD	1	12	M3 HEX LOCK NUT	4	21	ϕ 5.2 BOWL WASHER	4
4	MOTOR	1	13	M6*12 SCREW	5	22	ϕ 5 SPRING WASHER	4
5	EXTENSION PIPE	1	14	M5*5 SCREW	2	23	M5 HEXANGULAR NUT	4
6	SUPPORT POST	1	15	M12*55 SCREW	1	24	M6*12 SCREW	2
7	SPRING	1	16	ϕ 12 FLAT WASHER	1	25	M3*10 SCREW	3
8	BASE	1	17	ϕ 12 SPRING WASHER	1	26	ϕ 3 STAR WASHER	6
9	WHEEL	2	18	M12 HEXANGULAR NUT	1	27	M6 HEXANGULAR NUT	3

SAFETY INFORMATION

- WARNING:**
1. THIS UNIT IS DESIGNED FOR INDOOR USE ONLY. DO NOT EXPOSE TO ELEMENTS OR ALLOW TO BECOME WET.
 2. TO GUARD AGAINST ELECTRIC SHOCK WHILE OPERATING, DO NOT ALLOW FAN TO COME IN CONTACT WITH OTHER GROUNDED OBJECTS SUCH AS PIPES, RADIATORS, ETC.
 3. TO REDUCE THE RISK OF ELECTRICAL SHOCK, DO NOT USE WITH AN AUXILIARY SOLID STATE SPEED CONTROL DEVICE.
 4. DO NOT USE TO EXHAUST HAZARDOUS CHEMICALS OR USE NEAR ANY FLAMMABLE LIQUIDS OR GASES AS SPARKS FROM MOTOR MAY IGNITE FUMES.
 5. TURN OFF UNPLUG UNIT, AND WAIT FOR FAN TO STOP BEFORE MOVING, STORING, AND/OR CHANGING OPERATING LOCATIONS.
 6. DO NOT INSERT YOUR HAND OR OTHER OBJECTS INTO THE GUARD OR THE MOVABLE PARTS.
 7. BEFORE OPERATING ALWAYS CHECK FAN FOR LOOSE OR DAMAGED PARTS. INSPECT POWER CORD FOR ANY DAMAGE. NEVER USE FAN IF ANY PARTS ARE DAMAGED OR MISSING. NEVER USE FAN WITHOUT SAFETY GUARDS ATTACHED.
 8. WHEN USED WITH AN EXTENSION CORD, USE ONLY CORD OF PROPER SIZE (AMP RATING), UL LISTED, AND WITH RECEPTACLE TO ACCEPT THREE PRONG GROUNDED PLUG FURNISHED ON THE FAN'S POWER CORD. ALWAYS KEEP POWER CORD AND EXTENSION CORDS AWAY FROM HEAT, OIL, AND SHARP EDGES. INSPECT CORDS PERIODICALLY AND REPLACE IF DAMAGED.
 9. DISCONNECT FAN FROM POWER SOURCE WHEN NOT IN USE, BEFORE SERVING AND WHEN CLEANING OR REPAIRING.
 10. REPAIR OF THIS APPLIANCE SHOULD BE DONE BY A QUALIFIED ELECTRICIAN.
 11. IN CASE OF POWER FAILURE, TURN FAN OFF AT POWER KNOB OR CHAIN TO PREVENT UNEXPECTED RESTARTING AND COMPONENT DAMAGE.
 12. KEEP CHILDREN AWAY FROM FAN AT ALL TIMES.
 13. DO NOT USE HIGH PRESSURE HOSE TO SPRAY THE FAN FOR CLEANING.
 14. DO NOT OPERATE ANY FAN WITH A DAMAGED CORD OR PLUG. DISCARD FAN OR RETURN TO AN AUTHORIZED SERVICE FACILITY FOR EXAMINATION AND/OR REPAIR.
 15. DO NOT RUN CORD UNDER CARPETING. DO NOT COVER CORD WITH THROW RUGS, RUNNERS, OR SIMILAR COVERINGS. DO NOT ROUTE CORD UNDER FURNITURE OR APPLIANCES. PLEASE ARRANGE CORD AWAY FROM TRAFFIC AREA AND WHERE IT WILL NOT BE TRIPPED OVER.
 16. TO REDUCE THE RISK OF FIRE, ELECTRIC SHOCK OR INJURY TO PERSONS, DO NOT USE REPLACEMENT PARTS THAT HAVE NOT BEEN RECOMMENDED BY THE MANUFACTURER (E.G. PARTS MADE AT HOME USING A 3D PRINTER).

CAUTION:

1. PRIOR TO CLEANING, UNPLUG THE FAN FROM THE SOCKET.
2. DO NOT IMMERSE THE FAN IN WATER.
3. ENSURE GUARD IS SECURELY TIGHTENED ONTO FAN BEFORE USE.

CARE AND MAINTENANCE

UNPLUG THE APPLIANCE BEFORE CLEANING. SLIGHTLY MOISTEN A CLOTH AND THEN WIPE OFF THE SURFACES OF THE FAN. IN ORDER TO REMOVE THE DUST FROM THE PROTECTIVE GUARD, USE A VACUUM CLEANER OR REMOVE THE FRONT PROTECTIVE GUARD BY REMOVING THE SECURING SCREW ON THE EDGE OF THE GUARD WITH A SCREWDRIVER. AFTER CLEANING, REMOUNT THE SAFETY GUARD. AFTER DOING THIS, FASTEN THE SECURING SCREW ON THE EDGE OF THE PROTECTIVE GUARD.

SAVE THIS INSTRUCTIONS

ASSEMBLY INSTRUCTION

STEP 1
PUT THE WHEELS ON BASE. FASTEN THEM BY M5*12 SCREWS, ϕ 5 STAR WASHERS AND M5 NUTS.

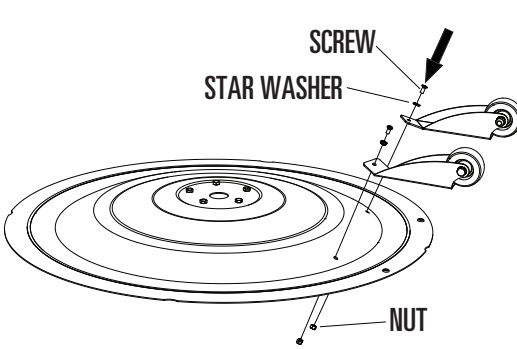

STEP 2
THROUGH THE BOTTOM OF BASE BY M5*12 SCREWS AND ϕ 5 STAR WASHERS, AND FASTEN THE WHEELS WITH M5 NUTS.

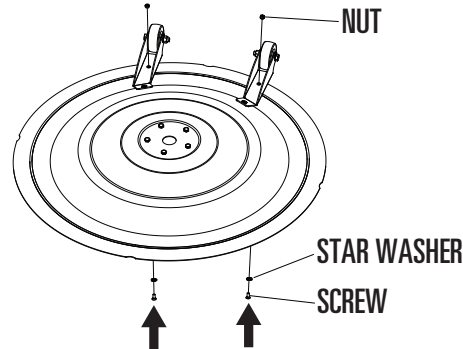

STEP 3
REMOVE FIVE SCREWS FROM BASE. SAVE THEM FOR STEP 4.

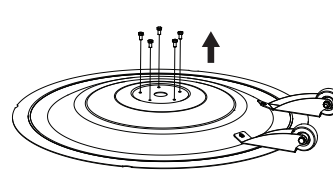

STEP 5
INSERT THE SHOCK ABSORBENT SPRING INTO THE LOWER POLE AS SHOWN IN THE PICTURE.

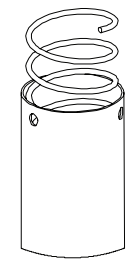

STEP 7
INSERT EXTENSION PIPE INTO LOWER POLE. FIX BLACK RING ONTO LOWER POLE BY TIGHTENING BACK TWO SCREWS FROM STEP 6. ADJUST EXTENSION PIPE TO YOUR DESIRED HEIGHT AND SECURE IT BY TIGHTENING BACK THE HEIGHT ADJUSTMENT KNOB. WARNING: TO AVOID INJURY AND PREVENT FROM CUTTING, NEVER PUT YOUR HEAD OVER THE EXTENSION PIPE DURING OR BEFORE THE EXTENSION PIPE WAS SECURED ONTO THE LOWER POLE TIGHTLY.

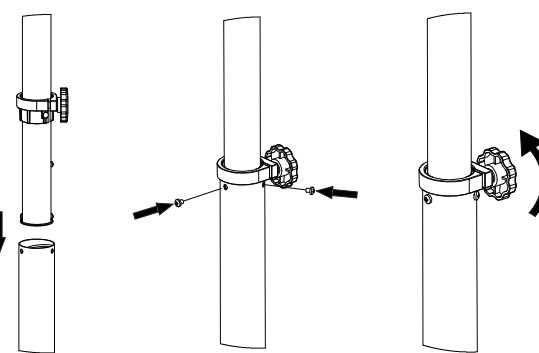

STEP 8
MOUNT THE FAN HEAD ONTO THE EXTENSION PIPE BY TIGHTENING THE SCREWS, WASHER AND NUTS. THE SCREWS, WASHER AND NUTS STOCKED IN THE MOTOR BOX.

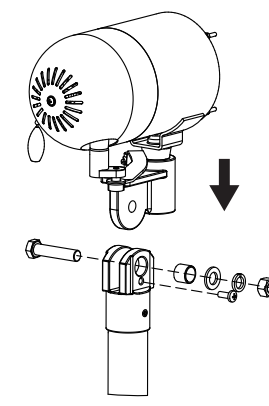

TSF TRACTOR SUPPLY CO.	ITEM NUMBER:	5002308
	DESCRIPTION:	30in Industrial Pedestal Fan
CMYK CMYK PANTONE	INSTRUCTION MANUAL SIZE:	630mm(W) x 297mm(H)
	COLOR:	1C + 1C
PANTONE PANTONE PANTONE	MATERIAL:	80gsm Woodfree Paper (80磅書紙)
	FINISHING:	NIL
PANTONE PANTONE PANTONE	DATE:	Dec 16, 2013
	VERSION:	1.7
PANTONE PANTONE PANTONE	RELEASED DATE:	Dec 19, 2013