



protect. teach. **love.**

# Indoor Bark Control

operating and training guide

Model Number  
PBC-1000

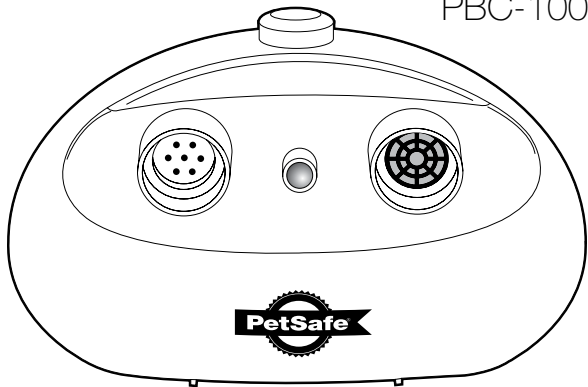

PLEASE READ THIS ENTIRE GUIDE BEFORE BEGINNING

# Important Safety Information

## Explanation of Attention Words and Symbols used in this guide



This is the safety alert symbol. It is used to alert you to potential personal injury hazards. Obey all safety messages that follow this symbol to avoid possible injury or death.

### **⚠️ WARNING**

**WARNING** indicates a hazardous situation which, if not avoided, could result in death or serious injury.

### **⚠️ CAUTION**

**CAUTION**, used with the safety alert symbol, indicates a hazardous situation which, if not avoided, could result in minor or moderate injury.

### **CAUTION**

**CAUTION**, used without the safety alert symbol, indicates a hazardous situation which, if not avoided, could result in harm to your pet.

---

### **⚠️ WARNING**

**Risk of explosion.** Do not short circuit, mix old and new batteries, dispose of in fire, or expose to water. When batteries are stored or disposed, they must be protected from shorting. Dispose of used batteries properly.

### **⚠️ WARNING**

**Not for use with aggressive dogs.** Do not use this Product if your dog is aggressive, or if your dog is prone to aggressive behavior. Aggressive dogs can cause severe injury and even death to their owner and others. If you are unsure whether this product is appropriate for your dog, please consult your veterinarian or certified trainer.

### **⚠️ CAUTION**

Humans cannot hear the ultrasonic sound, however, precautions should be taken when preparing the Indoor Bark Control for use.

- Keep at arms length away from the human ear to avoid hearing damage if a dog begins barking during setting up or when the Indoor Bark Control is operational.

- : This device is intended for use only with dogs. Never attempt to use it for any purpose not described in this manual.
- : All pets within hearing range will be affected by the ultrasonic tone.
- : For best results, use indoors only. Please visit our website or contact the Customer Care Center for information on PetSafe® outdoor bark control products.
- : The Indoor Bark Control is not a toy. Keep it out of the reach of children. Use it only for its bark control purpose.

Thank you for choosing the PetSafe® brand. You and your pet deserve a companionship that includes memorable moments and a shared understanding together. Our products and training tools promote a lifestyle of protection, teaching, and love—essentials that influence memories for a lifetime. If you have any questions about our products or training your pet, please visit our website at [www.petsafe.net](http://www.petsafe.net) or contact our Customer Care Center at 1-800-732-2677.

To get the most protection out of your warranty, please register your product within 30 days at [www.petsafe.net](http://www.petsafe.net). By registering and keeping your receipt, you will enjoy the product's full warranty and should you ever need to call the Customer Care Center, we will be able to help you faster. Most importantly, PetSafe® will never give or sell your valuable information to anyone. Complete warranty information is available online at [www.petsafe.net](http://www.petsafe.net).

---

## **Table of Contents**

Components.....	5
Features .....	5
How It Works .....	5
Key Definitions .....	6
To Insert and Remove the Battery.....	6
Setup.....	7
What to Expect During Use of the Indoor Bark Control .....	7
Eliminating Unwanted Behavior .....	8
Tips and Maintenance .....	8
<b>Frequently Asked Questions</b> .....	9
Terms of Use and Limitation of Liability .....	10
Customer Care International .....	11
Battery Disposal .....	11
FCC .....	11

# Components

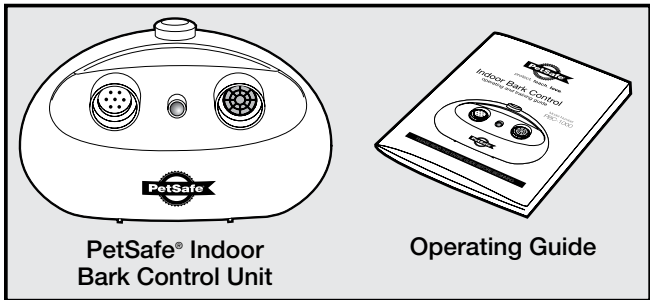

PetSafe® Indoor  
Bark Control Unit

Operating Guide

## Features

- : Automatically corrects excessive barking
- : Activated automatically or manually
- : No receiver collar needed
- : Detects barks up to 25 feet away

## How It Works

When the Indoor Bark Control unit is within range of a barking dog, an internal microphone picks up the sound. The unit automatically emits an ultrasonic tone that can be heard by dogs but is silent to most humans. Startled by the high-pitched tone, the dog should stop barking. In time it will associate its bark with this unpleasant noise. When the dog stops barking, the ultrasonic tone also stops. It is effective up to 25 feet.

You may also use the Indoor Bark Control unit as a remote trainer. When your pet exhibits inappropriate behavior, press the manual control button on top of the unit to emit an ultrasonic tone. The dog should be startled by the high-pitched tone and stop his poor behavior.

*Note: If the dog is deaf or hearing impaired, he may not react to the Indoor Bark Control.*

## Key Definitions

**Microphone:** Detects barking up to 25 feet away.

**Two Color LED:** Shows good or low battery. Also lights when activated.

**Speaker:** Produces the ultrasonic sound.

**Button:** Manual control activates an ultrasonic tone on demand.

**Battery Door:** Used to enclose the 9v battery.

**Keyholes:** Provision for wall mounting.

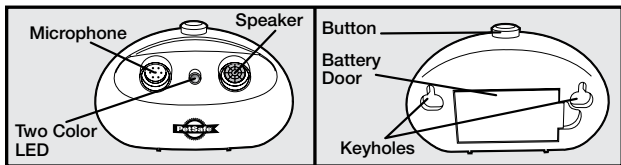

## To Insert and Remove the Battery

1. The Indoor Bark Control requires a 9-volt battery (not included).
2. Pull the battery door open and install the 9-volt battery with the positive side oriented as shown.
3. Replace the battery door by positioning the left edge, and snap the battery door into place.

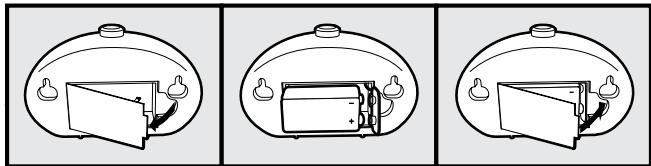

## Battery Life

Average battery life is 2 months, depending on how often the dog barks. To conserve battery life, remove the battery when the Indoor Bark Control is not in use.

### **⚠ WARNING**

Do not attempt to cut into or pry open the battery. Be sure to discard the used battery properly.

## Two Color LED Function and Response

LED Function	Red LED	Green LED
Normal Operation	Off	1 Flash every 5 seconds
Low battery	3 Flashes every 5 seconds	Off
Noisy Environment	1 Flash every ½ second	Off
Correction	On length of correction	Off

### Setup

The PetSafe® Indoor Bark Control should be placed facing the dog, within a range not to exceed 25 feet. For best results, the area between the Indoor Bark Control and the dog should be free of any large obstacles.

---

### What to Expect During Use of the Indoor Bark Control

Place the PetSafe® Indoor Bark Control within 25 feet or less of the dog. When the microphone picks up the constant bark of the dog, it will emit a 2-second high-pitched ultrasonic tone. While the tone cannot be heard by most humans, it should startle the dog. Most dogs will understand very quickly that the Indoor Bark Control is disrupting their urge to bark and will relax and stop barking.

You should notice a reduction in the dog's barking within the first 2 weeks that the Indoor Bark Control is in use. Please note this product may not work on deaf or hearing impaired dogs.

Excessive barking can cause a real strain on your family's relationship with your pet. Please visit [www.petsafe.net](http://www.petsafe.net) to view other customized solutions to the problem of too much barking.

# Eliminating Unwanted Behavior

To eliminate unwanted behavior other than barking (i.e. jumping on furniture), the manual activation function can be used.

As soon as your pet begins the earliest sign of misbehavior, press the manual control button. For example, if you want to teach your dog to stay off the couch, press the button as soon as he puts one paw on the seat. Do not wait until he is completely on the couch.

1. Hold the manual button for up to 2 seconds, releasing the button as soon as your pet stops the misbehavior.
  2. If your pet has not stopped the misbehavior after 2 seconds of correction, release the manual button; then press it again for up to 2 seconds.
  3. Continue this sequence until the misbehavior has stopped.
  4. Once the misbehavior has stopped, reward your pet with praise.
- 

## Tips and Maintenance

- : Before playing with your dog, remove the battery from the unit. The activity may cause your dog to bark, which could lead to him associating the play with the correction.
- : Remove the battery while not in use.
- : If your pet is injured or its mobility is otherwise impaired, contact your veterinarian or professional trainer before use.
- : Do not leave your device unattended where your dog could accidentally damage it through chewing.
- : Do not attempt to repair the device yourself. This will invalidate the warranty and make repairs more difficult.
- : Remove the battery before cleaning.
- : Clean the PetSafe® Indoor Bark Control with a damp cloth.
- : Do not use any kind of spray chemicals or solvent to clean.
- : Do not immerse in water or any other liquid.

*Note: The Indoor Bark Control is weather-resistant, not waterproof. However, if water enters into the microphone it may disrupt the unit's operation. After the microphone dries, it will resume working properly.*



# Frequently Asked Questions

<b>What is the range for the PetSafe® Indoor Bark Control?</b>	: The PetSafe Indoor Bark Control detects barking and sends the ultrasonic tone up to 25 feet.
<b>Is the Indoor Bark Control effective on all dogs?</b>	: The product may not work on deaf or hearing impaired dogs.
<b>Will the Indoor Bark Control work for multiple dogs?</b>	: Yes, it is effective on all dogs within the 25 foot range.
<b>Can I use the Indoor Bark Control outdoors?</b>	: No, we do not recommend keeping the product outdoors. PetSafe's Outdoor Bark Control products are waterproof and can work up to 50 feet from a barking dog. Please visit our website at <a href="http://www.petsafe.net">www.petsafe.net</a> or contact our Customer Care Center for more information.
<b>Can a dog become desensitized to the ultrasonic sound?</b>	: There are some situations where dogs become desensitized. To avoid this, only use the Indoor Bark Control during periods of unwanted barking (i.e., remove the battery when you are away).

# **Terms of Use and Limitation of Liability**

## **1. Terms of Use**

This Product is offered to you conditioned upon your acceptance without modification of the terms, conditions and notices contained herein. Usage of this Product implies acceptance of all such terms, conditions, and notices.

## **2. Proper Use**

This Product is designed for use with pets where training is desired. The specific temperament of your pet may not work with this Product. If you are unsure whether this is appropriate for your pet please consult your veterinarian or certified trainer.

Proper use includes reviewing the entire Guide provided with your Product and any specific Caution statements.

## **3. No Unlawful or Prohibited Use**

This Product is designed for use with pets only. This pet training device is not intended to harm, injure or provoke. Using this Product in a way that is not intended could result in violation of Federal, State or local laws.

## **4. Limitation of Liability**

In no event shall Radio Systems® Corporation be liable for any direct, indirect, punitive, incidental, special or consequential damages, or any damages whatsoever arising out of or connected with the use or misuse of this Product. Buyer assumes all risks and liability from the use of this Product.

## **5. Modification of Terms and Conditions**

Radio Systems® Corporation reserves the right to change the terms, conditions and notices under which this Product is offered.

# Customer Care International

USA & Canada - Tel: 800-732-2677

Monday - Friday 8 AM - 8 PM / Saturday 9 AM – 5 PM

Australia - Tel: 1800 786 608

Monday - Friday 8:30 AM - 5 PM

New Zealand - Tel: 0800 543 054

Monday - Friday 10:30 AM - 7 PM

This product has the benefit of a limited manufacturer's warranty. Details of the warranty applicable to this product and its terms can be found at [www.petsafe.net](http://www.petsafe.net) and/or are available by sending a stamped addressed envelope to PetSafe® Ltd. Redthorn House, Unit 9, Chorley West Business Park, Ackhurst Road, Chorley, Lancashire PR7 1NL, United Kingdom.

---



## Battery Disposal

Separate collection of spent batteries is required in many regions; check the regulations in your area before discarding spent batteries. At the end of the product life, please contact our Customer Care Center to receive instructions on proper disposal of the unit. Please do not dispose of the unit in household or municipal waste. For a listing of Customer Care Center telephone numbers in your area, visit our website at [www.petsafe.net](http://www.petsafe.net).

---

## FCC

This device complies with IC ES-003; this device complies with Part 15 of the FCC Rules. Operation is subject to the following two conditions:

1. This device may not cause harmful interference.
2. This device must accept any interference received including interference that may cause undesirable operation.

Radio Systems® Corporation  
10427 PetSafe Way  
Knoxville, TN 37932  
1-800-732-2677  
[www.petsafe.net](http://www.petsafe.net)  
400-1555

©2008 Radio Systems Corporation