



**YOUR EVERYDAY  
TRAINING PARTNER**

**200iq**

**QUICK START GUIDE**

**Dogtra Company**

12322 Monarch Street, Garden Grove, CA 92841

Tel. 310.534.0101

Fax. 310.534.9111

Toll Free. 1.888.811.9111

[www.dogtra.com](http://www.dogtra.com)

Copyright © 2025 All rights reserved.

## OVERVIEW



**200iQ**  
**Transmitter**

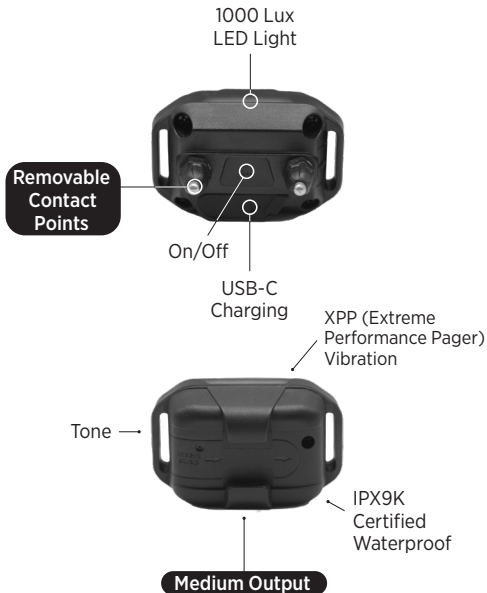

**200iQ**  
**Receiver**

## HERE IS OUR CHECKLIST FOR YOU TO START



Always double-check the battery life and connection of the unit



Pass the strap through the left, center, and right loops according to the direction of the arrow and fasten it



The best position is on either side of the dog's neck. Ensure a snug fit making skin contact \*



Know your dog's conditioning level \*\*

 Please reference the following chapters in the online manual for more details: \*<How to use the receiver> \*\*<Get Maximum Distance>



Make sure your dog understands dog commands before layering in the e-collar



Use positive reinforcement as needed when training with the e-collar



Don't go completely off-leash until you have proved the recall on a long leash with distraction

**\*Safety & Comfort Tip: Do not attach leash to e-collar strap.**

For more details & troubleshooting, check out the full online manual here!



## TURNING THE UNIT ON/OFF



**Green = Full charge**  
**Amber = Medium charge**  
**Red = Needs charge**

The transmitter does not have an on/off button and it will only activate when the buttons are pressed. The receiver's collar power button is located between the contact points. Press and hold the power button for 2 seconds to turn it on or off. The LED indicator will turn solid green with a tone when the unit powers on and a red light with a tone when it powers off. (Press the power button briefly to turn on the backlight.)

## SIDE BUTTONS



### 1) Nick

When the Nick button is pressed, the receiver emits a single rapid pulse of static stimulation.

### 2) Tone

The tone button emits a beeping sound when held, lasting up to 12 seconds maximum.

### 3) Constant

Constant button emits a continuous stream of stimulation when held, lasting up to 12 seconds maximum.

### 4) Light

There are two light modes:

- Continuous Beacon Mode:

Emits continuous blinking, every 4 seconds.

Tap the Locate Light button once.

To disable the continuous blinking, tap the Locate button again.

- Manual Light Mode:

To manually enable the beacon light, press and hold the Locate Light button which emits for up to 12 seconds maximum.

### 5) Vibration

The pager button emits non-stimulating vibration when held, lasting up to 12 seconds maximum.

## FINDING THE RIGHT STIMULATION



The 200iQ has a Rheostat Dial on the front of the transmitter (0 is the lowest level and 100 is the highest level). Remember that you will need to

adjust the level setting (up or down) depending on your dog's temperament and sensitivity. Always start at the lowest level and work your way up.

## CHARGING THE BATTERY

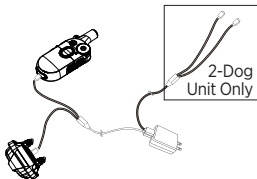

Use the 2-port USB-C battery charger to charge the receiver and transmitter concurrently. You can use a USB-C cable to charge individually. For optimal performance, only use Dogtra-approved batteries and accessories for your Dogtra e-collars.

## ADD ADDITIONAL RECEIVER DEVICES



1. Set the Dial to 0 and place the toggle switch in "1(or 2)" position.



2. To begin pairing, the receiver must be turned off. Initiate the pairing mode by pressing and holding the power button for 5 seconds until the LED starts blinking and then release.



3. While the green LED on the receiver is rapidly blinking, simultaneously press both side buttons on the transmitter (Nick and Constant). Once coding is complete, the LED indicator on the receiver will blink every 4 seconds.

**Repeat the pairing process if the pager vibration test is unsuccessful. The pairing between the devices has timed out or failed.**

## IMPORTANT SAFETY AND PRODUCT INFORMATION

### WARNING

**Please read all safety and product information below before using your Dogtra product. Failure to follow these safety instructions could result in injury to you, your dog and others, or it could result in damage to your Dogtra product or other property.**

### PRODUCT SAFETY

#### Training Methods

Dogtra products may be used with a variety of training methods. However, each dog may have a different reaction to training methods and to Dogtra products. Closely observe your dog when determining the right training method to use with your Dogtra product.

#### Aggressive Dogs

Do not use Dogtra products with aggressive dogs as such dogs may react adversely and cause injury to people or other dogs. Seek the assistance of a dog-training specialist or veterinarian when dealing with aggressive dogs.

#### Children

Dogtra products are not toys. Adult supervision and close attention are necessary when Dogtra products are used by or near children.

### PRODUCT DAMAGE

#### Electrical Product

Your Dogtra product contains electrical components and batteries. Do not use or keep your product near heat or flammable sources. Such use or storage may damage your product and/or cause fire, explosion, injury, or property damage.

#### Medical Device Interference

Dogtra products contain electrical and magnetic components that emit low level electromagnetic waves and radio frequencies. These electromagnetic waves or radio frequencies may interfere with pacemakers, defibrillators, or other medical devices. Consult your physician or medical device maker before using your medical device around a Dogtra product. If you think that your Dogtra product is

interfering with your pacemaker, defibrillator, or other medical device, stop using the Dogtra product.

#### Inadvertent Activation

The digital microprocessor offers thousands of unique codes to eliminate frequency match-up with other Dogtra e-collars. The Constant button will automatically shut down after being held down for 12 seconds or more as a safety feature.

### UNAUTHORIZED USE

Your Dogtra product should be used only in a humane manner to train and educate your dog. Dogtra products are not intended for use in any other manner nor are they intended for use with other animals or with humans.

### BATTERY

Your Dogtra product contains batteries. Take care when removing and installing batteries as your fingers may get caught. Dispose of batteries as provided by your local regulations. Do not disassemble, crush, heat, or otherwise alter the battery as it may cause fire, injury or property damage.

### FCC/ISED WARNING STATEMENT

This device complies with part 15 of the FCC Rules. Operation is subject to the following two conditions:

- (1) This device may not cause harmful interference, and
- (2) this device must accept any interference received, including interference that may cause undesired operation.

**Happy Training!  
Share your remote  
training experience by  
leaving us a review!**

