

ENERGIZER

by RentACoop®

USER MANUAL

For Energizer Models:

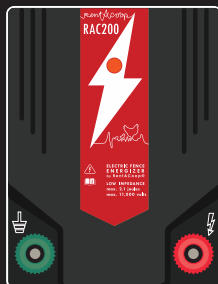

SPECIFICATIONS	RAC60	RAC200
MAXIMUM STORED ENERGY	0.6 Joules	2.1 Joules
OUTPUT VOLTAGE	7,000 Volts	11,000 Volts
INPUT CURRENT	1 Watt	2 Watts
PULSES PER MINUTE	45	45

KEEP THIS MANUAL IN A SAFE LOCATION FOR FUTURE REFERENCE.

READ THIS MANUAL IN ITS ENTIRETY BEFORE USING THIS PRODUCT. FAILURE TO FOLLOW THE INSTRUCTIONS AND SAFETY PRECAUTIONS IN THIS MANUAL CAN RESULT IN SERIOUS INJURY OR DEATH.

DISCLAIMER: WHILE EVERY EFFORT HAS BEEN MADE TO ENSURE ACCURACY, NEITHER RENTACOO, LLC OR ANY EMPLOYEE OF THE COMPANY WILL BE LIABLE ON ANY GROUND WHATSOEVER TO ANY PARTY IN RESPECT OF DECISIONS OR ACTIONS THEY MAY MAKE AS A RESULT OF USING THIS INFORMATION.

IN ACCORDANCE WITH RENTACOO'S POLICY OF CONTINUING DEVELOPMENT, DESIGN AND SPECIFICATIONS ARE SUBJECT TO CHANGE WITHOUT NOTICE.

READ ALL WARNINGS BEFORE USE!

USER WARNINGS:

MOUNT ENERGIZER OUT OF REACH OF CHILDREN AND PETS!

THIS APPLIANCE IS NOT INTENDED FOR USE BY PERSONS (INCLUDING CHILDREN) WITH REDUCED PHYSICAL, SENSORY, OR MENTAL CAPABILITIES, OR LACK OF EXPERIENCE AND KNOWLEDGE, UNLESS THEY HAE BEEN GIVEN SUPERVISION OR INSTRUCTION CONCERNING USE OF THE APPLIANCE BY A PERSON RESPONSIBLE FOR THEIR SAFETY.

CHILDREN SHOULD BE SUPERVISED TO ENSURE THAT THEY DO NOT PLAY WITH THE APPLIANCE.

NEVER TOUCH AN ELECTRIC FENCE WITH YOUR HEAD, MOUTH, NECK OR TORSO. DO NOT CLIMB OVER, THROUGH, OR UNDER AN ENERGIZED FENCE. NEVER ALLOW ANYONE ELSE TO DO SO. INSTRUCT ALL VISITORS AND CHILDREN TO NEVER DO SO.

NEVER PLACE YOUR HEAD OR UPPER SPINE NEAR AN ELECTRIFIED WIRE. ACCIDENTAL HEAD OR NECK CONTACT CAN OCCUR WHEN PUSHING A VOLTAGE PROBE INTO THE SOIL. USE CAUTION WHEN DOING SO TO AVOID HEAD-TO-WIRE CONTACT!

NEVER ENCOURAGE ANYONE TO TOUCH AN ELECTRIC FENCE.

ENERGIZER WARNINGS:

THIS PRODUCT HAS BEEN DESIGNED SPECIFICALLY FOR USE WITH RENTACOOB'S FENCING ONLY.

THE ENERGIZER SHOULD ONLY BE OPENED OR REPAIRED BY QUALIFIED PERSONNEL.

DO NOT CONNECT ENERGIZER TO MAINS-OPERATED EQUIPMENT. DO NOT CONNECT SIMULTANEOUSLY TO A FENCE AND TO ANY OTHER DEVICE SUCH AS A POULTRY TRAINER. CONNECT ENERGIZER TO ONLY ONE DEVICE AT A TIME. OTHERWISE, LIGHTNING STRIKING YOUR FENCE WILL BE CONDUCTED TO ALL OTHER DEVICES.

DO NOT USE ENERGIZER WITH AN EXTENSION CORD. USE ONLY WITH A POWER SUPPLY THAT HAS BEEN INSTALLED BY A QUALIFIED ELECTRICIAN.

NEVER USE HOUSEHOLD ELECTRICAL CABLE: IT IS NOT MEANT TO WITHHOLD THE AMOUNT OF VOLTAGE PRODUCED BY THE ENERGIZER AND WILL LEAK ELECTRICITY. **USE HIGH VOLTAGE LEAD-OUT CABLE WIRE** IN BUILDINGS TO EFFECTIVELY INSULATE FROM THE EARTHED STRUCTURAL PARTS OF THE BUILDING AND WHERE SOIL COULD CORRODE EXPOSED GALVANIZED WIRE.

ELECTRIC FENCE WARNINGS:

DISCONNECT THE ENERGIZER FROM ITS POWER SUPPLY BEFORE MAKING ANY CHANGES TO THE GROUND SYSTEM OR ELECTRIC FENCE.

DO NOT PLUG IN ENERGIZER BEFORE NETTING/FENCING SETUP. FINISH SETUP OF POULTRY NETTING BEFORE CONNECTING THE ENERGIZER TO A POWER SOURCE.

DO NOT SUPPLY AN ELECTRIC FENCE FROM TWO ENERGIZER UNITS. ONLY CONNECT ONE ENERGIZER TO A FENCE.

DO NOT PLACE COMBUSTIBLE MATERIALS NEAR THE FENCE OR ENERGIZER CONNECTIONS. IN TIMES OF EXTREME FIRE RISK, DISCONNECT ENERGIZER.

IF THERE IS DANGER OF OVER-FLOODING, THE ENERGIZER MUST BE TURNED OFF AND UNPLUGGED.

NEVER USE BARBED WIRE FOR ELECTRIC FENCE WIRE BECAUSE PEOPLE OR ANIMALS COULD EASILY BECOME ENTANGLED IN IT. AN ELECTRIC FENCE CAN BE HAZARDOUS WHEN THERE IS A RISK OF ENTRAPMENT OR ENTANGLEMENT. SERIOUS INJURY OR DEATH MAY RESULT. TAKE ALL STEPS TO AVOID THE RISK OF ENTRAPMENT OR ENTANGLEMENT.

ELECTRIC FENCES BORDERING PUBLIC THOROUGHFARE ARE REQUIRED TO HAVE A WARNING SIGN AT LEAST EVERY 295 FEET WHERE THE PUBLIC HAS ACCESS TO ELECTRIC FENCES, SUCH AS A LONG ROADS. **CHECK WITH YOUR LOCAL AUTHORITY FOR SPECIFIC REGULATIONS AND CHECK YOUR INSTALLATION TO ENSURE THAT IT COMPLIES WITH ALL LOCAL SAFETY REGULATIONS.**

CHECK YOUR LOCAL ORDINANCE ON FENCING LAWS: LOCAL LAWS MAY REQUIRE A PERMIT BEFORE USE.

GROUND ROD WARNINGS:

THIS ENERGIZER MUST BE GROUNDED USING GALVANIZED METAL GROUND RODS TO ENSURE THE ELECTRIC FENCE WORKS CORRECTLY. DO NOT USE COPPER LEAD-OUT WIRE OR COPPER GROUND RODS.

DO NOT PLACE YOUR GROUND ROD WHERE THEY ARE LIKELY TO BE HIT BY EQUIPMENT.

DO NOT PLACE GROUND ROD NEAR FERTILIZER, ANIMAL URINE, OR MANURE – RISK OF CORROSION.

DO NOT USE RUSTY OR CORRODED GROUND RODS.

Thank you for purchasing a RentACoop® Energizer

This RAC Energizer will power your fencing system. It connects to and sends electrical pulses along the fence line at approximately one-second intervals. These pulses give your livestock a brief but safe shock. Your livestock will remember the shock and avoid the fence. It will also protect your animals against predators.

TABLE OF CONTENTS

WARNINGS	2
NECESSARY & RECOMMENDED EQUIPMENT	5
PACKAGE CONTENTS	6
KEY SYMBOLS ON THE ENERGIZER UNIT	7
QUICK START GUIDE	8
INSTALLATION INSTRUCTIONS	10
HOW TO TEST YOUR FENCE USING RENTACOOB'S DIGITAL VOLTMETER	17
FREQUENTLY ASKED QUESTIONS	18
CONTACT INFORMATION	BACK COVER

VIDEO INSTRUCTIONS & MORE



NECESSARY EQUIPMENT

- Galvanized Steel Ground Rod[s]
 - one 3' ground rod (if using RAC60)
 - two 3' OR one 6' ground rod[s] (if using RAC200)
- Voltmeter Fence Tester

RECOMMENDED EQUIPMENT

- 20,000-Volt Insulated Hook-up Cable Wire (only if the provided wires are not long enough for your setup)
 - long enough to connect the energizer to your grounding system
 - another long enough to connect the energizer to your electric fence
- Wire Stripper (only if using your own insulated wire)
- Lightning Diverter *
- GFCI Voltage Spike (Surge) Protector *

* The lightning diverter and surge protector are also recommended but are not required to use the product. They will ensure the longevity of the product as well as help to keep you safe.

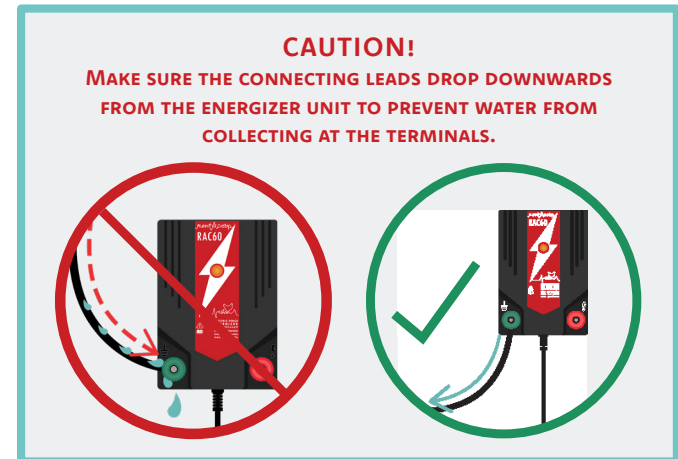

PACKAGE CONTENTS

ENERGIZER UNIT

GROUNDING CABLE

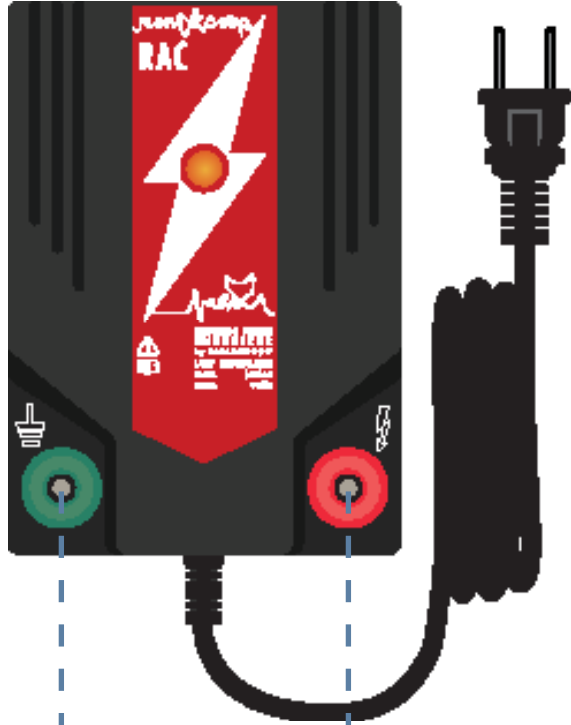

ELECTRIC FENCE CONNECTER CABLE



GROUND
TERMINAL
[NEGATIVE]

FENCE
TERMINAL
[POSITIVE]

KEY SYMBOLS ON THE ENERGIZER UNIT



RISK OF ELECTRIC SHOCK! THIS UNIT SHOULD BE OPENED OR REPAIRED ONLY BY QUALIFIED PERSONNEL. NO USER SERVICEABLE PARTS.



LIVE TERMINAL (RED) FOR CONNECTING THE ENERGIZER TO THE POULTRY NETTING ELECTRIC FENCE.



GROUND TERMINAL (GREEN) FOR CONNECTING THE ENERGIZER TO THE GROUND SYSTEM.



READ FULL INSTRUCTIONS BEFORE USE.

QUICK START GUIDE

If you already have your grounding system and electric fence in place and you understand how energizers work, this section is to help you complete your setup quickly using RentACoop's Energizer.

FOR MORE DETAILED INSTRUCTIONS, TURN TO PAGE 10

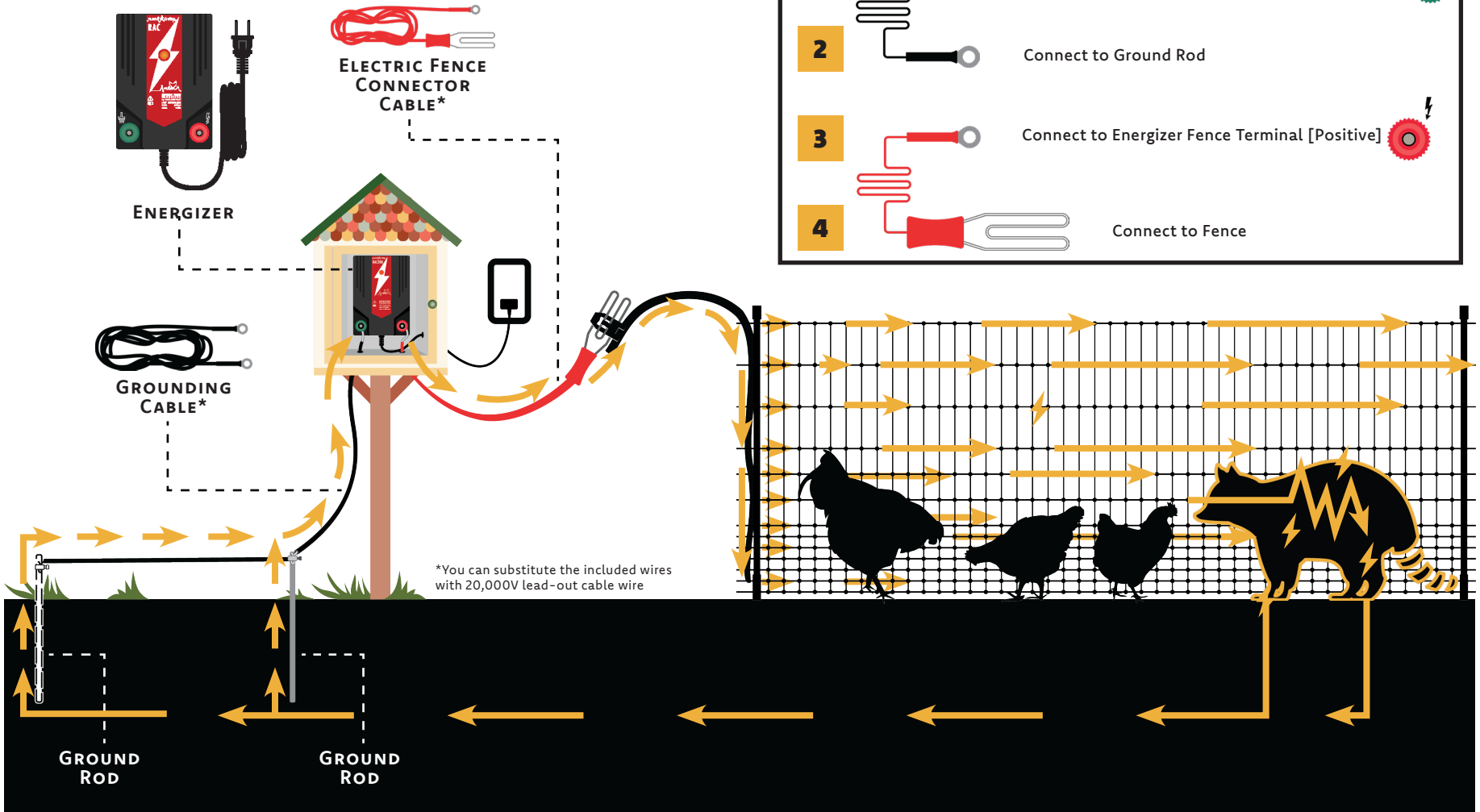

INSTALLATION INSTRUCTIONS

PART 1

LOCATE A PLACE FOR THE ENERGIZER

- The RentACoop® Energizer can be placed either inside or outside of a building wherever there is access to a power outlet. **Do not connect the energizer to just any regular AC outlet or extension cord, they must be a ground fault circuit interrupter (GFCI) outlet or GFCI extension cord.**

- ⚠ **DO NOT place in an area where there is risk of fire and/or flood.**



?

A GFCI outlet is a type of circuit breaker that automatically shuts off power directly at the outlet when an electrical fault is detected.

GFCI outlets are normally installed in potentially wet or damp areas such as basements, bathrooms, garages, outdoors, and workshops.

Damp areas increase the risk of dangerous electric shock but using a GFCI outlet can significantly reduce your risk of injury.

Consult your local hardware store for more information about GFCI outlets.

- ⚠ **Choose a place or area where the energizer is protected from direct sunlight, rainfall, and other weather elements. The energizer is water-resistant, but it is not waterproof.**



- ⚠ **Mount energizer out of reach of children and pets!**

PART 2

MOUNT THE ENERGIZER

We recommend that you mount the energizer vertically on a wall or other surface, within reach of a GFCI AC power outlet, and shielded from weather.

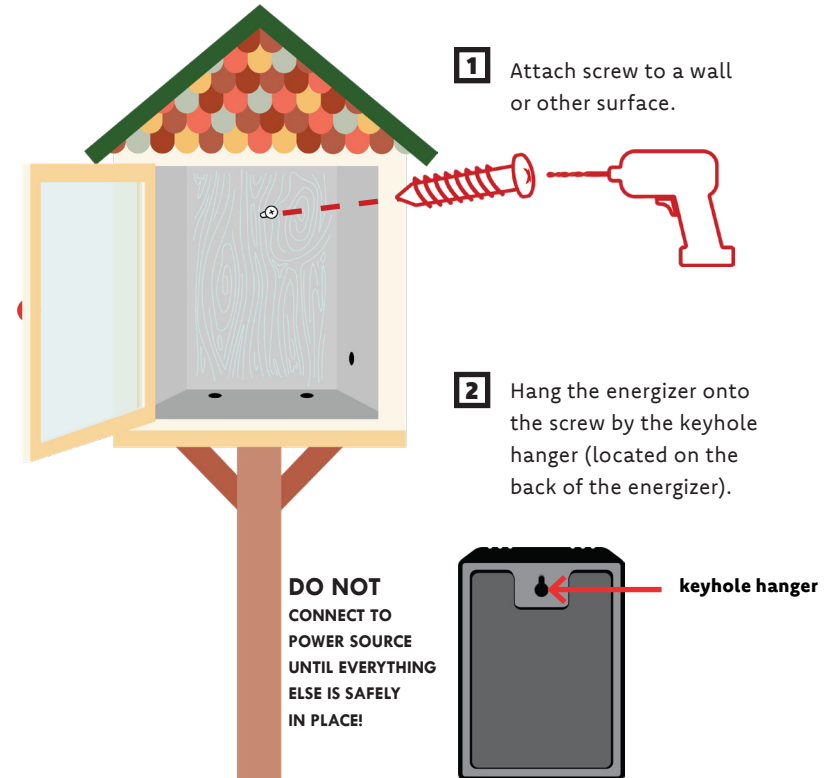

PART 3

INSTALL GROUND ROD & CONNECT TO ENERGIZER

The purpose of a ground rod (or multiple ground rods) is to have a planned electrical path to dissipate any extra voltage from the energizer into the earth, or ground – hence, “ground” rod.

Minimum Ground Rod Length Requirement

You will need a minimum of 3' of ground rod for every 1.0 joule of energy released.

Energizer Unit Output	Amount / Length of Ground Rod[s]
≤ 1.0 Joule	Use one 3.0' ground rod*
> 1.0 Joule ≤ 2.0 Joules	Use two 3.0' ground rods spaced 6' apart in a straight line or one 6' ground rod*

*If using 3' grounding rods, any additional 3' rods should be spaced at least 6' apart in a straight line. Use 3' rods for smaller energizers and lightning diverters. If using 6' groundrods, any additional 6' rods should be spaced at least 8' apart in a straight line. Use multiple 6' rods for large energizers. If using multiple ground rods, link the grounds rods together using leadout wire so that energy can travel from one rod to the next.

- 1** Insert the ground rod[s] into conductive, ideally moist, soil. ?

The drier your soil is, the less conductive it will be which will result in a weaker electrical pulse.

Avoid installing ground rods in locations where the ground is mostly rock and/or sandy. Rocks and rocky soils create a physical barrier for the electrons to travel so that the pulse will travel around the rocks, reducing available energy along the way. Sandy soils do not retain moisture well, limiting conductivity. To remedy this, use more ground rods.

- ?** How deep do I install the rods into the ground?

Ground rods should be installed all the way into the earth with 4" to 6" sticking out.

~ 4" – 6"

- ?** Galvanized Steel Ground Rods or Copper Ground Rods?

- Galvanized steel rods will remain rust-free for a very long time, but will eventually rust.
- Copper is more conductive but will corrode quicker, interrupting the energized circuit.

- ?** HOW DO I KNOW IF I HAVE ENOUGH GROUND RODS? SEE FAQs (PAGE 16)

- ?** HOW CAN I PURCHASE THIS 3-FOOT GROUND ROD?



- 2** If your ground rod is *less than* 40" away from your energizer, use the included 40" black grounding cable. If your ground rod is *more than* 40", measure the appropriate length of insulated leadout wire needed to go from your energizer to your ground rod and strip off 3" of insulation from each end of the measured leadout wire.

? Insulated wire is wire covered in a layer (or layers) of insulated material. This insulation provides protection from the elements (such as high heat and low temperatures), reduces energy leakage, increases efficiency, all while protecting you against electric shock.

- 3** Unscrew the negative ground terminal (LEFT GREEN KNOB) on the energizer.

- 4** Connect one end of the grounding wire you are using to the exposed negative ground terminal on the energizer. See examples below for how to connect.

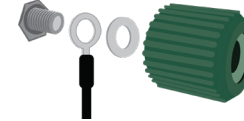

Grounding Cable	Stripped Insulated Wire
If using the included 40" grounding cable, place one end of the ring terminals over the exposed ground terminal on the energizer unit.	If using your own insulated wire, wrap one end of the stripped leadout wire around the base of the energizer's exposed ground terminal.

- 5** Screw the ground terminal closed, ensuring that the ring terminal or stripped wire is firmly clamped between the metal washer and the base of the terminal.

INSTALL GROUND ROD & CONNECT TO ENERGIZER CONTINUED...

- 6** Connect the other stripped end of the insulated leadout wire (or grounding cable if using) to the ground rod.

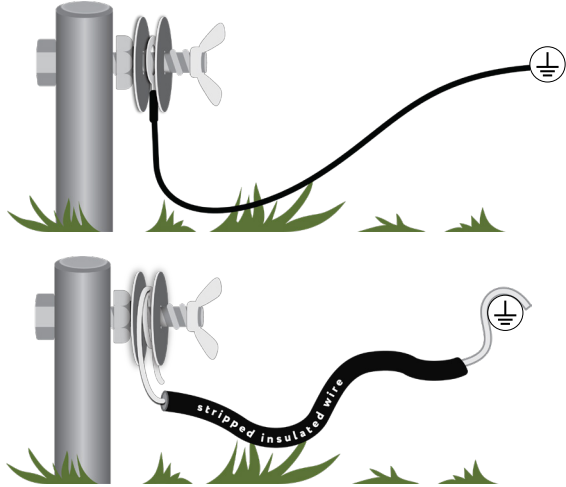

NOTE: There are many different styles and varying materials of ground rod clamps. If you are using a galvanized steel ground rod, pair it with a galvanized or stainless steel ground rod clamp. If you are using a copper ground rod, pair it with a brass ground rod clamp. **Combining incompatible metals can and will accelerate corrosion and rust.**

PART 4

CONNECT ENERGIZER TO ELECTRIC FENCE

- 1** If your energizer is *less than 40"* away from your electric fence, use the included 40" red electric fence connector cable. If your energizer is *more than 40"*, measure the appropriate length of insulated leadout wire needed to go from your energizer to your fence and strip 3" of insulation from each end of the wire.

CONNECT ENERGIZER TO ELECTRIC FENCE CONTINUED...

- 2** Unscrew the positive fence terminal (RIGHT RED KNOB) on the energizer. ⚡

- 3** Connect one end of the wire you are using [the 40" red fence connector cable OR the insulated leadout wire] to the exposed positive fence terminal on the energizer.

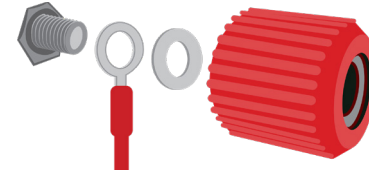

- 4** Screw the fence terminal closed ensuring that the connection is firmly clamped.

- 5** Connect the opposite end of the cable wire you are using to one the metal clip[s] located on your electric fence. See examples below for how to establish a good connection between the energizer and fence.

Electric Fence Connector Cable	Stripped Insulated Wire
If using the included 40" fence connector cable, connect the electric fence connector clip to the metal clip[s] located on your fence.	If using your own insulated wire, tightly wrap the opposite stripped end of the wire multiple times around the fence's metal clip[s].

PART 5

CONNECT ENERGIZER TO AC POWER OUTLET

- 1 Plug the energizer into a nearby GFCI 110V power outlet (USA Type B) or GFCI extension cord and be sure to cover the connection between the energizer and extension from rain/the elements.

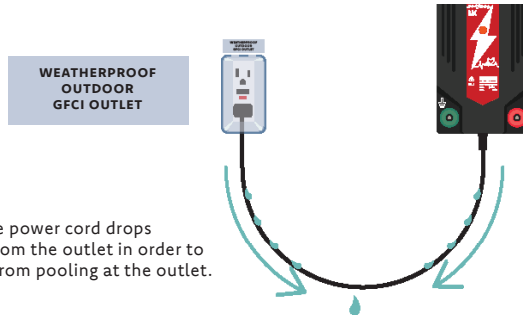

- 2 Check that the light on the front of the energizer is flashing.
- 3 Test fence to ensure it is properly energized. ?

It is important to test your electric fence system regularly to ensure it is operating properly, and your animals are contained safely. You can use RentACoop's Digital Voltmeter Fence Tester to measure fence line and fence controller (energizer) voltage, as well as determine if you have adequate voltage on your fence line.

Follow the instructions that came with your fence tester or voltmeter. The reading should register at least 3,000 volts in order to deter furry predators.



When using the fence voltage tester, DO NOT grab the ground probe while the tester is still on the fence. First, remove the tester from the live wire so that there is no longer any active current to your tester, and then pull the ground probe out of the soil.

HOW TO TEST YOUR FENCE USING RENTACOOB'S DIGITAL VOLTMETER

Use a voltmeter to test that your electric fence is working properly. Make sure to use a voltmeter that is specifically designed for electric fences and can handle large voltages. Below are steps on how to use RentACoop's Digital Voltmeter:

NEVER PLACE YOUR HEAD OR UPPER SPINE NEAR A "LIVE" WIRE.
This can occur by accident when you are testing your fence. Use caution.



IMPORTANT: After you're done using the voltmeter, make sure to dismount the test probe BEFORE disconnecting the ground probe.

TEST THE FENCE

1. See that the energizer is on. *
2. Stick the ground probe into the earth.
3. Touch the test probe to the live fence wire.
4. Read measured voltage on the digital screen.
5. Remember to remove the test probe BEFORE removing the ground probe.

If your voltmeter is reading less than 3,000 Volts, see FAQs (p.18 B) to resolve your fence issues. If your fence is not getting any power, please follow the instructions below to test the energizer.

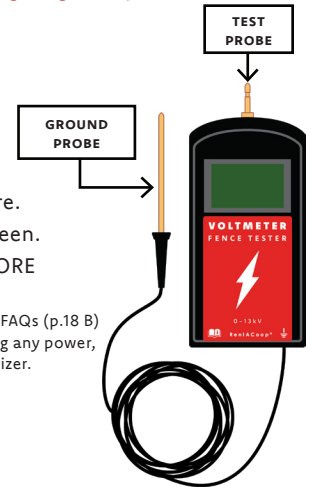

TEST THE ENERGIZER

1. Unplug the energizer and disconnect it from the fence.
2. Remove the leads from the positive (red) terminal. ⚡
3. Remove the leads from the negative (green) terminal. ⚡
4. Plug in the energizer.
5. Touch the ground probe to the negative terminal. ⚡
6. Touch the test probe to the positive terminal. ⚡
7. Read measured voltage on the digital screen.
8. Remember to disconnect the test probe BEFORE removing the ground probe.

FREQUENTLY ASKED QUESTIONS

A. WHAT DOES IT MEAN IF THE ENERGIZER'S LIGHT IS BLINKING?

This is normal. The energizer only emits a current every second or so because it is a pulse-type, low-impedance, energizer and not a continuous current. Every time it sends out an electric pulse, the light turns on.

B. THE FENCE ISN'T WORKING. HOW DO I KNOW IF THE PROBLEM LIES WITH THE ENERGIZER OR THE FENCE?

Test the fence (p.17) and energizer (p.17) using a voltmeter. If you do not own a voltmeter, use these methods:

1. Connect ground lead from energizer ground terminal to ground rod(s).
2. Connect fence lead with clip from the energizer fence terminal to one of the metal clips at one end of the net.
3. Turn on the energizer by flipping the switch and test the fence to ensure that it is properly electrified.

Remember that with a net fence, the metal clip at the end of your fence DOES NOT connect back to the metal clip at the beginning of your net. Test the end of the fence to ensure adequate voltage.

C. HOW MANY VOLTS ARE NEEDED TO KEEP PREDATORS OUT?

The minimum output to keep short-haired animals out of your fencing area is 3,000 Volts. If installed correctly with no vegetation touching the fence, this energizer will keep multiple 164' electric poultry fences at 3,000 Volts or above. This voltage will keep out common predators such as foxes, raccoons, dogs and cats.

Wolves and bears require 5,000 Volts. This energizer with one fence set up properly with no grass or weeds touching the fence puts out 7,500 Volts.

D. HOW TO TELL IF YOU HAVE ENOUGH GROUND RODS?

You can tell if you have enough ground rods by creating a "worst-case" scenario and measuring the amount of voltage build-up around your ground rod[s]. Create a "worst-case" scenario and test for adequate grounding by following the directions below:

1. **IMPORTANT:** Make sure the energizer is OFF.
2. Walk down your fence line at least 500 feet from the energizer.
3. Insert a galvanized rod into the earth.
4. Attach one end of insulated wire to the rod,
5. Connect the other end to a live-wire on the fence.
6. Attach a second wire to the ground rod.
7. Push the other end of the wire into the soil 10 feet away from your ground rod, to establish a connection between the rod and the earth.
8. Turn the energizer on.

You've temporarily created a dead short on the fence. All the energy will travel out of the fence and into the soil via the wire.

If you don't have adequate grounding, energy will "pile up" around the ground rods creating voltage.

If the existing ground rods are adequate in total length and depth, you should be able to attach a fence voltmeter between the ground rods and the temporary wire and get a reading of less than 300 volts.

If the reading is more than 300 volts, add more ground rod[s].

E. MAINTENANCE

For a safe reliable electric fencing system, we recommend following these tips:

- Regularly wipe down the unit with a soft damp cloth to ensure that there is no build-up of mold, etc.
- Do not use any abrasives which may damage the coating of the energizer
- Clean any connections and terminals that are showing signs of corrosion
- Perform a thorough test of the ground system at least ONCE every year and also during dry seasons
- Inspect fence lines regularly, clearing any weeds, low hanging branches or other vegetation in direct contact with the wire
- Check fence wire positions and tensions to ensure the fence lines are taught and above vegetative growth.
- Ensure all fence wire insulators are intact and in good condition.



RentACoop®

QUESTIONS?

CONTACT OUR
EGG - SPERTS

info@rentacoop.com

1 800-642-3571

M-F 9-5 EST

SHARE YOUR SETUP WITH
RENTACOOB'S CHICKEN
COMMUNITY ON AMAZON!

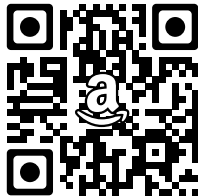

@RENTACOOB
#RENTACOOB