

## Hessaire Warranty

Five year warranty on evaporative cooler housing

All other components are covered for one year from date of purchase.

If a component is found to be defective within the periods described above, the defective part will be provided free of charge. Replacement parts are available through authorized dealers or online. Copy of proof of purchase and serial label number will be needed for all warranty claims.

### Items Not Covered / Conditions:

Hessaire will not be responsible or liable for damage to contents, flooring, carpet, walls, ceilings, structure/foundations or any other consequential loss or damage—either direct or indirect resulting from operation, neglect, or misuse of the evaporative cooler.

Not covered is damage due to outside elements/factors such as rain, wind, lightning, storms, floods, power surges, brownouts, etc—which are not considered to be defects in materials or workmanship and in turn are not covered under the Hessaire warranty.

Hessaire does not cover labor costs associated with troubleshooting or cooler repairs—regardless if the product is under warranty or not.

Warranty does not apply to media pads

### Returns: Please Do Not return your cooler to Hessaire.

Return transportation costs are the responsibility of the purchaser.

Return authorization must be obtained from the seller/distributor where the unit was purchased from.

All returns should be sent directly to the distributor/store where purchased.

### Damaged Shipments:

Hessaire is not responsible for damaged shipments or shortages resulting from carrier mishandling. Notify your carrier immediately to file a freight claim in the event of damage. Keep damaged product for inspection until advised by the carrier as to disposal.

### Assistance:

Instructional videos and parts replacement information available on [hessaire.com](http://hessaire.com).

Visit [hessaire.com](http://hessaire.com) for processing warranty claims / service parts:

***([Hessaire.com/Warranty/Replacement Parts Request](http://Hessaire.com/Warranty/ReplacementPartsRequest): fill in form, submit)***

Serial Number Location On Label  
(label on lower back side of cooler)



EN7

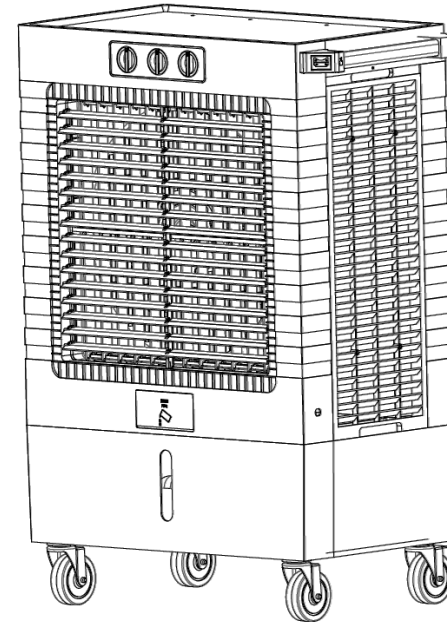

## Mobile Evaporative Cooler

5300 CFM

### Use & Care Guide

M270

(color will vary by model)

## INDEX

Safety Rules.....	1
Quick Start.....	2
Features.....	3
Maintenance.....	4
Troubleshooting....	5
Cooler Parts.....	6
Warranty.....	7



## General Safety Precautions



**Read and follow all instructions, cautions and warnings. Failure to do so could result in personal injury, death or property damage.**

Unit must be in **OFF** position and **UNPLUGGED** from power receptacle before performing any maintenance / service or before **REMOVING** access panels.

Make sure the electrical power source conforms to the requirement of the evaporative cooler as well as local codes.

To reduce risk of fire or electrical shock, do not expose electrical connections to water.

Do not touch electrically live components.

Ensure all power cords do not touch sharp edges, hot surfaces or chemicals. Immediately replace damaged parts.

No Automatic Pump Shut Off. Running pump dry is not recommended.

Continuous fill not to be used indoors or unattended.

Never leave unit unattended.

## Operation Tips

Hessaire coolers are highly recommended for outdoor use. If used indoors, position cooler in front of window or open door for fresh intake air. Ensure there is an open door or window through which the air can exhaust from the room.

Clean media pads and tank frequently.

When shutting down unit, run without pump for 30 minutes to properly dry media pads.

Prior to long term storage:  
Drain tank and wipe clean  
Dry and clean rigid media pads

**Indoor Use:** Do Not Use Garden Hose Attachment / Continuous Fill Indoors.

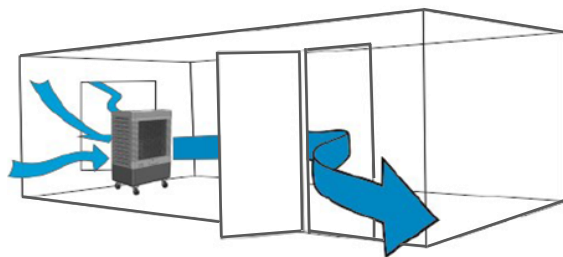

EN1

## Cooler Parts

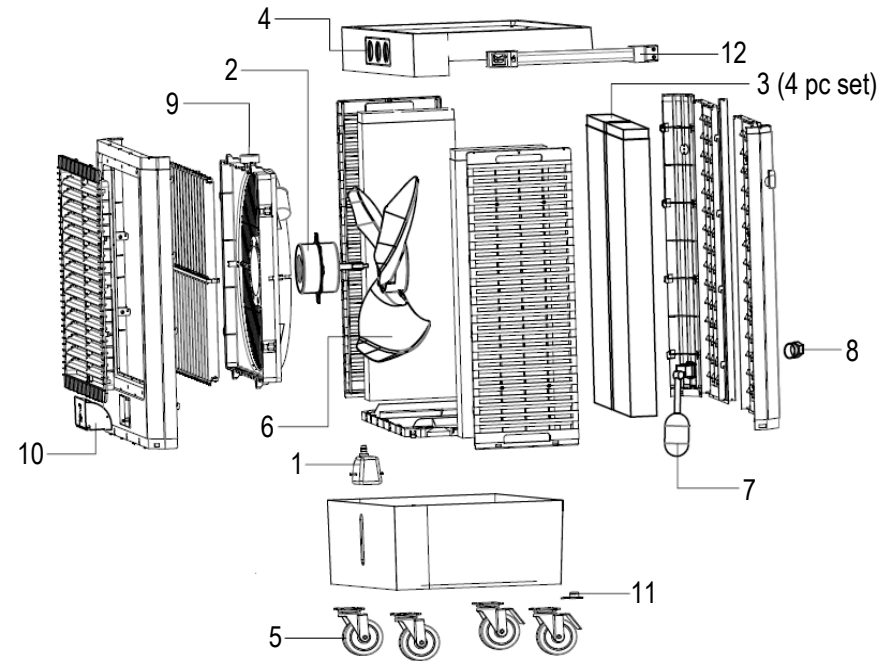

#	Parts Description	M270
1	Pump: 5300 cfm cooler	6060050
2	Motor: 5300 cfm cooler	6615100
3	Rigid Media Set (4 pcs)	CP610
4	Control Panel	6061069
5	Caster Set (4 pcs)	6276100
6	Fan Blade	6061052
7	Float Valve Kit (float valve, hose adapter)	6018058
8	Brass Hose Adapter	6018088
9	Oscillator Motor	6375700
10	Manual fill door	6061076
11	Drain plug	6017081
12	Handle	HD270

EN6

COOL AIR ANYWHERE



## Troubleshooting

Problem	Cause / Remedy
Cooler won't turn on	Ensure unit is plugged in and switched on. Receptacle breaker might need to be reset. If unit is equipped with a GFCI plug, reset. If unit has a timer, ensure it is off. Wire to switch might be disconnected. Reconnect. Fan switch might need to be replaced.
Fan will not operate	Ensure fan function is on. Make sure nothing is obstructing fan blade. Fan motor might need to be replaced. Wire to switch might be disconnected. Reconnect. Fan switch might need to be replaced. Slow running - may need capacitor replaced.
Cooler does not pump	Ensure pump switch is turned on. Make sure water level is not low. Add water. Make sure hoses are connected and free of debris. Wire to switch might be disconnected. Reconnect. Pump might need to be replaced. Pump switch may need to be replaced.
Swing does not work	Ensure swing switch is turned on. Make sure the linkage is connected. Wire to switch might be disconnected. Reconnect. Oscillation switch might need to be replaced. Oscillation motor might need to be replaced.
Water leakage	Make sure drain plug is securely in place. Make sure cooler is level. Inspect tank for cracks. Check media pads for water running on outside of unit. Check for leaks in water distribution hose connections. Check spreaders for build up causing spill over of water into the airstream.
Water level high or low	Adjust nut on float valve. Float valve might need to be replaced.

**CAUTION:** Max. water pressure to unit: 65 psi. Must use regulator for water pressure exceeding 65 psi.

EN5

## Inspection

After unpacking your cooler, carefully inspect for any damage that may have occurred during transit. Inspect for loose, missing or damaged parts. *Note: wheels & hardware are located in a compartment on the bottom side of the cooler. Refer to pics at the bottom of this page.*

Contents: Evaporative Cooler (1), Hardware Bag/Hose Adapter (1), Caster Wheels (4), Handle Assembly (1), Tool Top Liner (1).

Visit [Hessaire.com](http://Hessaire.com) to request replacement or missing parts.

### Set Up: Attach Wheels & Handle

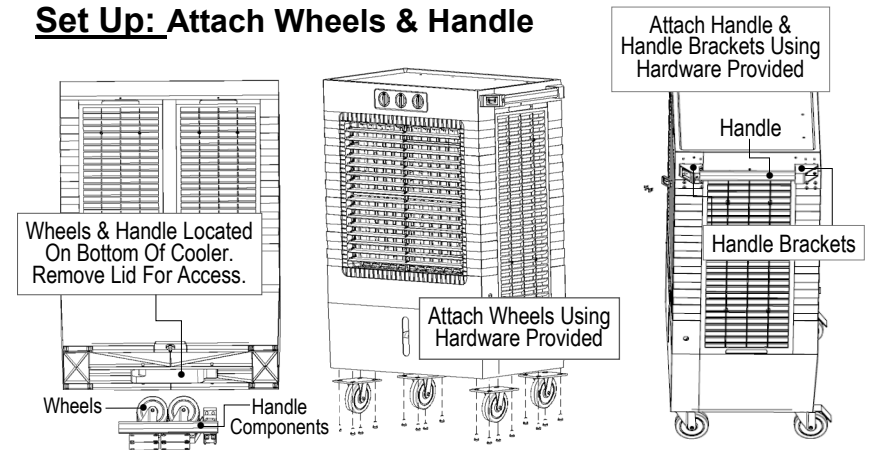

### Start Up

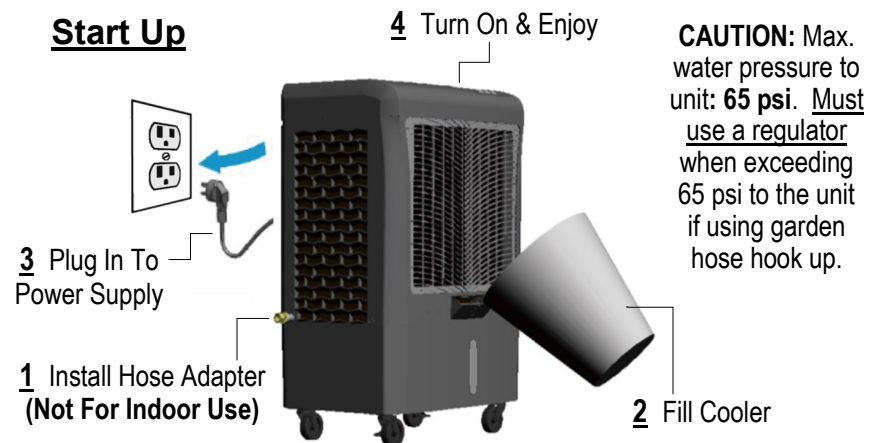

**CAUTION:** Max. water pressure to unit: 65 psi. Must use a regulator when exceeding 65 psi to the unit if using garden hose hook up.

**Float is fixed. No adjustment necessary.**

EN2

COOL AIR ANYWHERE



## Control Panel

Switch for Fan Speeds: 4 Positions (OFF, LOW, MED, HIGH)

Switch for Pump: ON/OFF

Switch for Swing (oscillation): ON/OFF

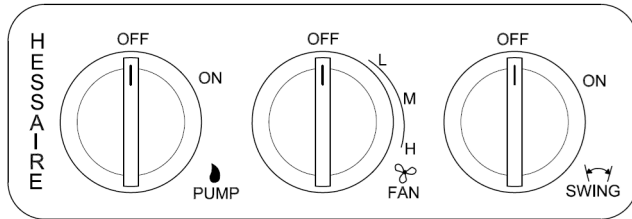

## Features

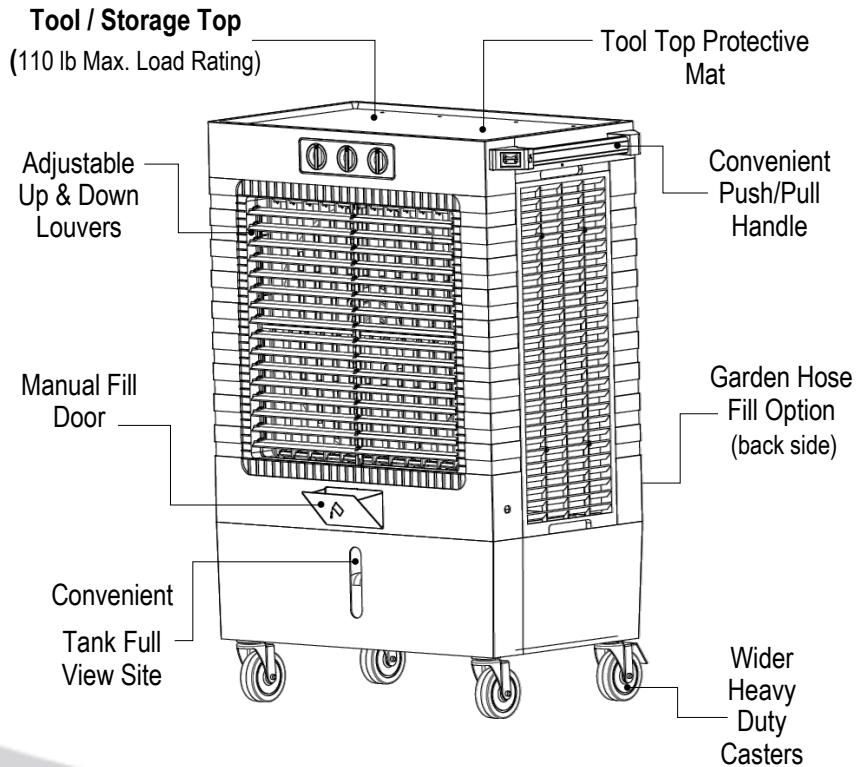

EN3

## Maintenance

**⚠ WARNING** *Disconnect from power source before attempting any maintenance or routine service. NEVER remove any access panels while cooler is in operation. Failure to do so could lead to SERIOUS INJURY.*

### Cleaning Cooler & Rigid Media Pads:

The removable panel(s) & pads can be gently sprayed off to remove build up. A soft bristle brush can also be used.

**NEVER spray pads with water while cooler is in operation. Damage can occur to the motor and will void the warranty.**

*Note: Vinegar is recommended for cleaning of cooler and can be periodically cycled through during normal use.*

### Removal Of Back Panel:

**Disconnect power supply.** Remove the phillips screws from the upper back side of cooler.

Push panels up and pull bottom out to remove.

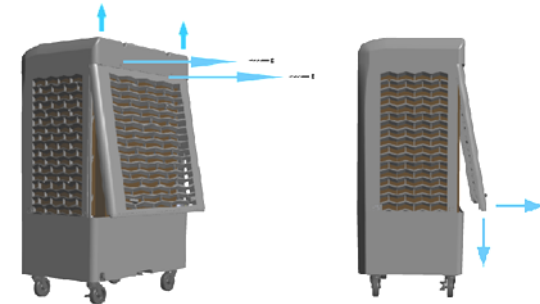

### Removal Of Rigid Media:

Once back is removed, the media pads will be accessible. *Note: some pads may be held in place with pins (media keepers) which will need to be removed to free up the pads.*

### Storage:

Drain tank and wipe dry. Plug is located on bottom of cooler. Ensure pads are dry by running fan without pump for at least 30 minutes.

**Visit [Hessaire.com](http://Hessaire.com) for additional maintenance tips and service videos.**

EN4

COOL AIR ANYWHERE