

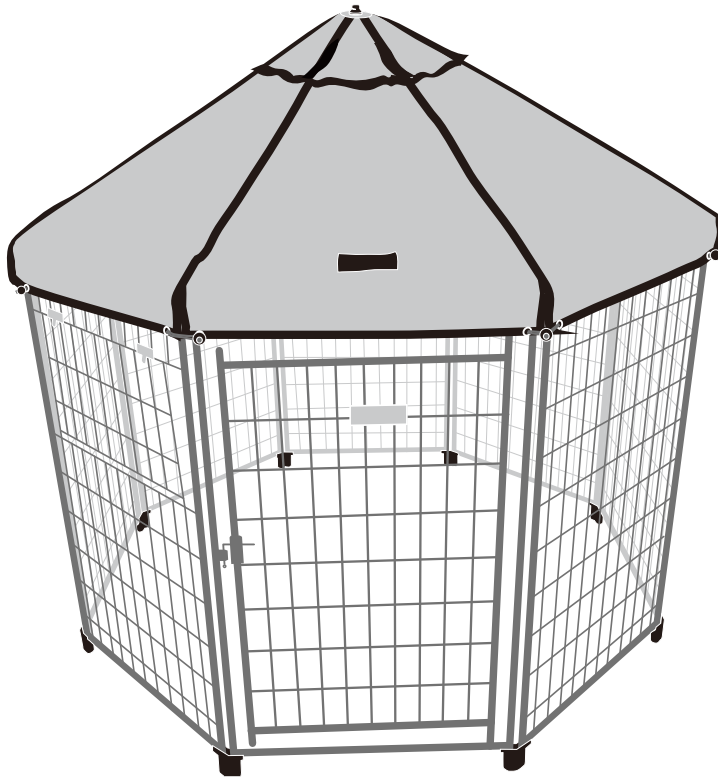

THE PET GAZEBO<sup>®</sup>

# INSTRUCTION MANUAL



23403,23404,23405

[www.petgazebo.com](http://www.petgazebo.com)

---

# THE PET GAZEBO

## PARTS SECTION:

A	Gate Panel	x 1
B	Latching Window Panel	x 1
C	Side Panel	x 6
D	Nylon Connector	x 16
E	Roof Support Hub	x 1
F	Roof Arm Support	x 8
G	Ball Ties	x 8
H	Canopy	x 1
I	Roof Support Cap	x 1

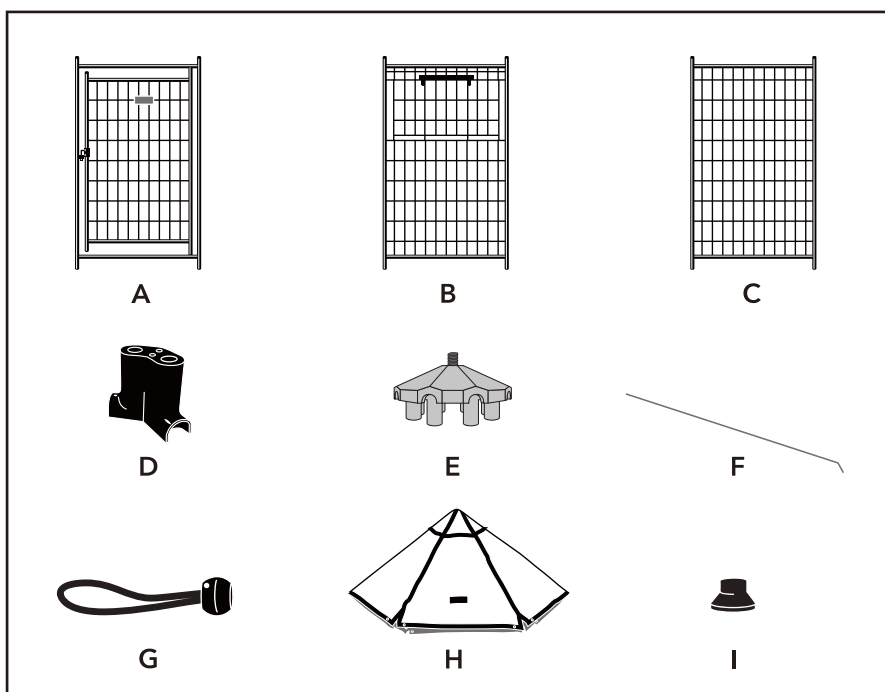

## CONGRATULATIONS! WELCOME TO THE PET GAZEBO® FAMILY

The PET GAZEBO® provides your pet with a safe and secure place to play or rest. Whether you are using it indoors as a crate or outdoors in place of an ordinary exercise pen or kennel The PET GAZEBO® adds piece of mind with a flare for style.

Make sure to check out [www.petgazebo.com](http://www.petgazebo.com) regularly for the latest and greatest accessories to CUSTOMIZE your pets experience and make your life easier.

## ASSEMBLY INSTRUCTIONS:

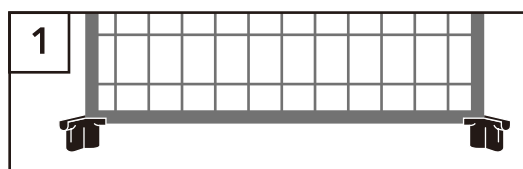

- 1 Begin with two **Side Panels**. Place **Nylon Panel Connectors** on the bottom of both ends of one panel.

Note: All **Nylon Panel Connectors** are identical

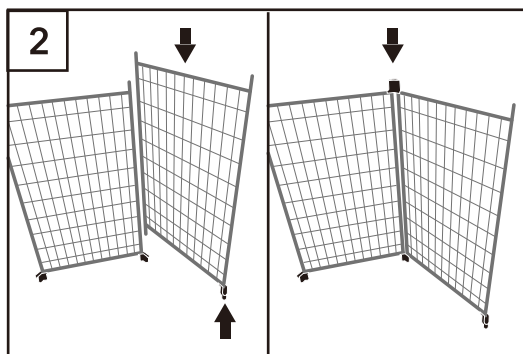

- 2 Place a Nylon Panel Connector on to one side of another Side Panel and insert the second Side Panel into a Nylon Panel Connector of the first Side Panel.

Attach a Nylon Panel Connector to join the 2 Side Panels at the top so the unit can stand freely.

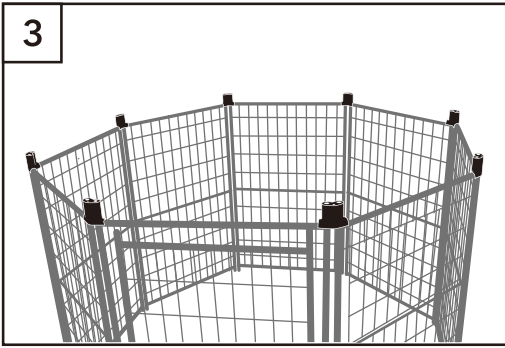

3 Repeat these steps until you have an octagonal shape. Make sure the **Gate Panel** and **Latching Window Panel** are placed where both panels can be opened from the outside.

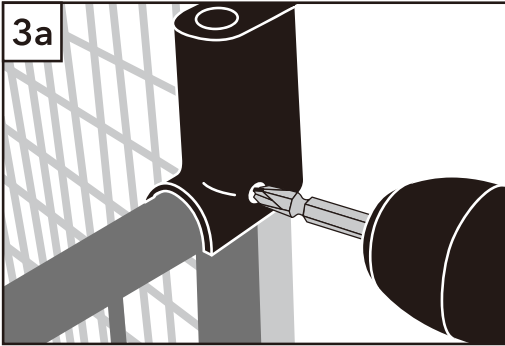

3a **OPTION.** To turn your PET GAZEBO into a more permanent structure, purchase 16 small self tapping screws measuring 3.5mm x 13mm and use a power drill to attach the nylon connectors to the feet of the panels.

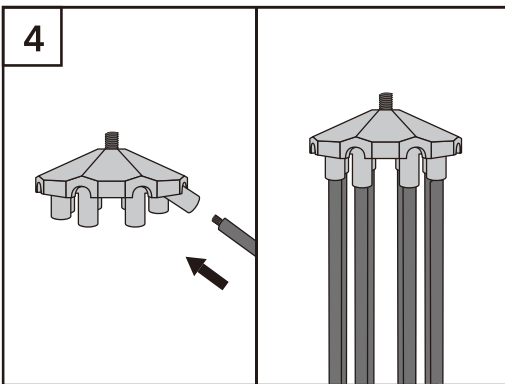

4 Connected the 3 parts of **Roof Support Arm** together as this diagram.

Insert the tip of the **Roof Support Arm** into the sleeve of the **Roof Hub** and screw into place by turning the **Support Arm** to the right (clockwise). Screw the arm in completely and make sure the angled end of the **Roof Arm** is pointing in towards the **Roof Hub**.

Repeat this step for the remaining 7 **Roof Support Arms**.

Once the **Roof Support Arms** are in place, it is recommended to leave them in the **Roof Hub** for future use.

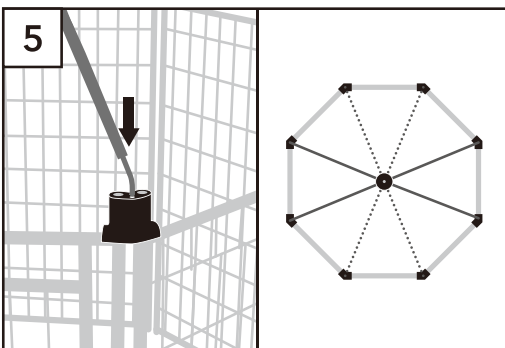

5 Insert the end of a **Roof Support Arm** into the larger hole of the **Nylon Panel Connector**.

**Roof Support Arms** into place in the **Nylon Panel Connectors**.

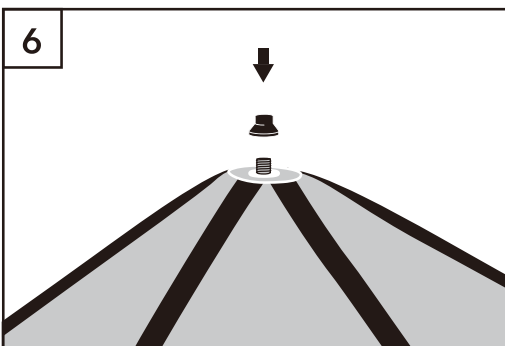

6 Make sure the **Canopy** is oriented with the Pet Gazebo logo outward. Locate the center eyelet and line it up with the center of the **Roof Support Hub**.

Screw on the **Roof Support Cap** to attach the **Canopy** to the kennel.

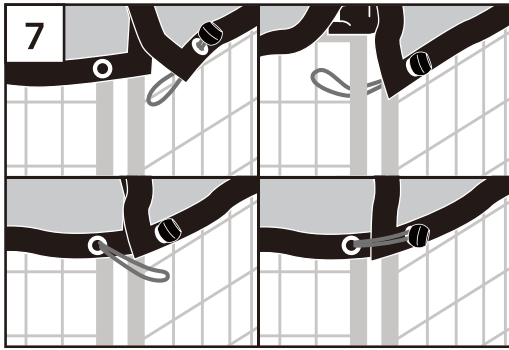

- 7 Using the Ball Ties provided attach the Canopy to the posts of the kennel.

**Note:** Align the ribs of the Canopy with the posts of the panels. Insert a Ball Tie through the eyelet below the horizontal frame bar and wrap around the vertical frame post connecting two (2) Panels together.

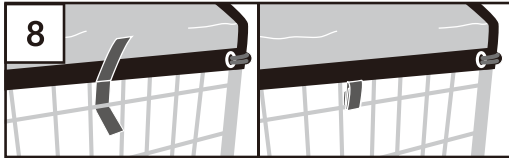

- 8 Pass the inside strap underneath the second horizontal bar from the top. Fold top of strap over bottom to secure.

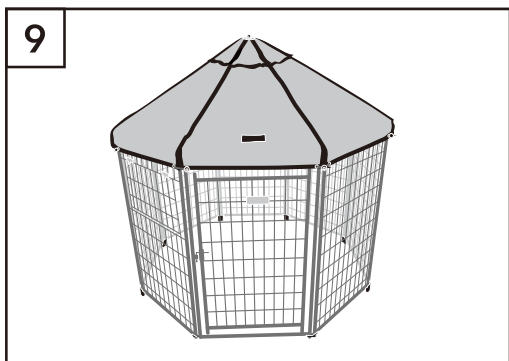

- 9 Your Pet Gazebo is now ready to use!

**Note:** For safety and stability when used outdoors the Pet Gazebo should be secured to the ground with steel ground stakes ([www.petgazebo.com](http://www.petgazebo.com), item No. 23396 & 23397).

### CONNECTING MULTIPLE PET GAZEBOS TOGETHER

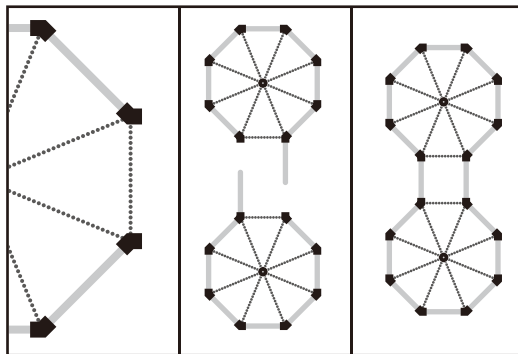

- 1 Detach a single Side Panel and its Nylon Panel Connectors from a fully assembled gazebo, then re-attach the Nylon Panel Connectors so that they turn away from the side panel, rather than inward.
- 2 Re-attach a Side Panel to each gazebo so that the panels face outward and are on opposite sides.
- 3 Attach gazebos together by inserting the outward facing Side Panels in the available Nylon Panel Connectors.

### LIMITED WARRANTY

Steel panels (side panel, gate panel, window panel)  
 Canopy 23400 series (Market top Polyester)  
 Nylon connectors, roof support hub, cap, arms, ball ties

**5 YEARS**  
**3 YEARS**  
**1 YEAR**

To activate your warranty: register your product at [advantekpet.com/warranty](http://advantekpet.com/warranty). To request warranty replacement email [customerservice@petgazebo.com](mailto:customerservice@petgazebo.com). Be sure to include a copy of your receipt, a photo of defective part(s) and a listing of part(s) needed. Be sure to include your name and contact information.

**Any questions or problems, please contact [customerservice@petgazebo.com](mailto:customerservice@petgazebo.com), or call 949 922 6706.**

[www.petgazebo.com](http://www.petgazebo.com)