

WARNING & NOTICE

1. Do not look directly at the LED lights, or it may damage your eyes.
2. Do not attempt to disassemble or remodel the product. Any changes can be dangerous and will void the warranty.
3. Please keep away from any flammable items, or explosion, property damages, or casual injuries may occur.
4. Please install the product according to the user manual.

PRODUCT SPECIFICATION

Material	ABS	Solar Panel	5.3 x 3.0 inches / 1.5 W
Battery	Li-ion battery 18650 1200mAh/pc * 2pcs	Waterproof Performance	IP65
Size	11.4 x4.4 x 3.9 inches	Accessories	1*Solar security light 3*Screws / 3*Anchors 1*Mounting stickers 1*User manual

This product has a 1-year limited warranty. For further information please visit our website at www.techkogroup.com

Copyright Reserved

☎ 1-888-883-2456

✉ support@techkogroup.com

Solar Security Light -Twin Light

USER MANUAL

TECHKO®

Model: SSL-308

▲ Please carefully read this manual before using the product.

▲ Keep this manual with you for reference as needed.

PLEASE FULLY CHARGE THE PRODUCT BEFORE USING

1. Please turn the product ON by selecting any of the three modes (see below) and fully charge under direct sunlight before use.
2. Charging time may vary depending on the weather, temperature, and seasons.
3. Do not charge the product indoors or any place where direct sunlight can't reach. Otherwise, the product will not charge properly.
4. Please keep the solar panel clean to make sure the product can be properly charged. Frequently clean the solar panel as needed. Avoid scratching the panel or it may lower charging efficiency.

INSTALLATION INSTRUCTIONS

Please make sure the location where the unit is to be installed has enough space for it to fit in before installing.

The solar panel and LED panel can be adjusted up to 90° angles.

When adjusting the unit, secure the screw to hold the panel in the correct position.

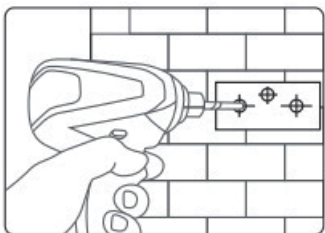

1. Place the mounting sticker in a location where the product will be installed to. Then drill 3 holes into the guides shown on the mounting sticker.

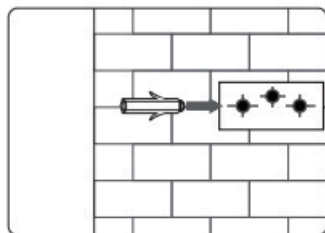

2. Insert the supplied anchors into the drilled holes.

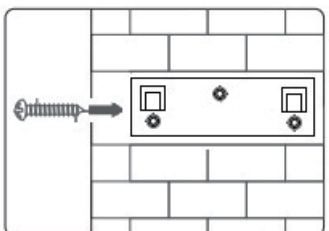

3. Use a screwdriver to secure the supplied screws into the support frame.

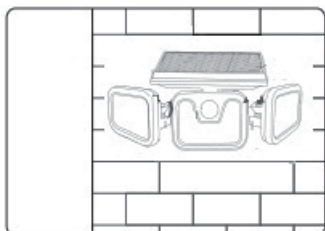

4. Hang the unit on the installed support frame corresponding to the holes behind the unit.

▲ Please install the unit in a place where the solar panel can be continually exposed to the sun.

▲ Avoid placing the unit where shade from buildings or objects would block the solar panel.

Switch & Functions

Mode 1: Press the button once to enter the first mode. The light will turn on at 100% brightness and automatically turn off after 20 seconds. When the PIR sensor detects motion, the light will return to 100% brightness. After the person moves away, the light will turn off again after 20 seconds.

Mode 2: Press the button a second time to enter the second mode. The light will turn on at 100% brightness and then dim to 20% brightness after 20 seconds. When the PIR sensor detects motion, the light will brighten to 100% again, then return to 20% brightness after the person leaves and 20 seconds have passed.

Mode 3: Press the button a third time to enter the third mode. The light will turn on at 100% brightness, then dim to a continuous 30% brightness after 20 seconds. In this mode, the light stays at 30% brightness at all times, regardless of motion detection.

Power Off: Press the switch a fourth time to turn off the light completely.

▲ The product can be charged in all operating modes.

