

OWNER'S MANUAL
POOL & SPA TEST STRIPS
Model No.58142E

TEST FACTORS:

Free chlorine: The ideal free chlorine range is 2.0-4.0ppm.

pH: The ideal pH level is 7.4 to 7.6.

Total Alkalinity: The ideal alkalinity range for pool and spas is 80-120ppm.

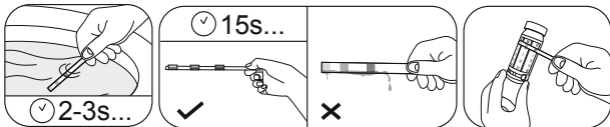

NOTES:

1. When removing strips from the bottle be sure to quickly reseal the lid.
NOTE: Keep bottle seal between uses.
2. Keep test strips dry. Do not use wet fingers to remove strips from the bottle.
NOTE: Strips will automatically react if they are exposed to water or moisture.
3. Read results in natural daylight. Sodium vapor light bulbs can make color matching difficult. Also, remove sunglasses since they can make color matching difficult.
4. A color that appears on the strip pad maybe between two chart values. If this happens, record the result as a number in-between the values shown.
5. Store in a cool, dry place, preferably indoors.
NOTE: Extreme heat and moisture could reduce the shelf-life of the strips.
6. Never remove the package of drying agent from the bottle.

©2023 Bestway Inflatables & Material Corp.

All rights reserved

Trademarks used in some countries under license from Bestway Inflatables & Material Corp., Shanghai, China

Exported by Bestway (Hong Kong) International Ltd./Bestway Enterprise Company Limited

Suite 713, 7/Floor, East Wing, Tsim Sha Tsui Centre, 66 Mody Road, Kowloon, Hong Kong

Distributed in North America by Bestway (USA) Inc., 3435 S. McQueen Road, Chandler, AZ 85286, United States of America

Tel: +86 21 69135588

www.bestwayusa.com

Bestway

303021320605