

Check that you have all your parts and accessories.

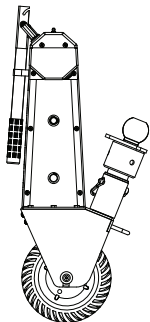

MV PRO UNIT

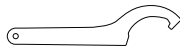

SPANNER WRENCH



DRILL ATTACHMENT



ROTATION PIN



BALL CONVERTER



COUPLING PLATE



2" HITCH BALL



BALL BASE

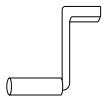

HAND CRANK



MANUAL



TRAILER VALET MV PRO

Quick Start Guide

Rev 7.01.24

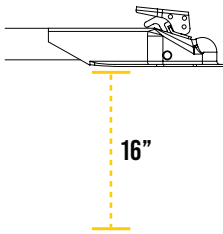

1. Check trailer height and raise the trailer tongue to where the frame is about 16 inches off the ground to give adequate space to attach the dolly.

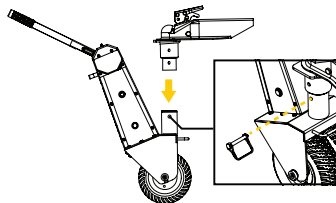

4. Using your trailer jack, lower the hitch towards the unit's rotating coupler and attach rotation pin to secure.

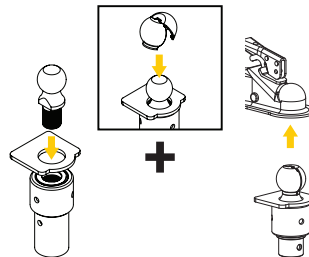

2. Set up hitch ball and ball base. Then attach to coupler.
Optional: For 2-5/16" couplers, attach ball converter to hitch ball.

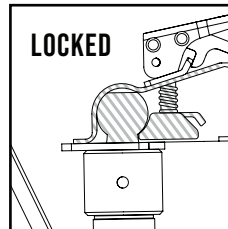

5. Make sure the MV Pro is securely tightened and not rocking.

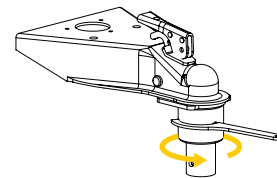

3. Use spanner wrench and tighten that base firmly!

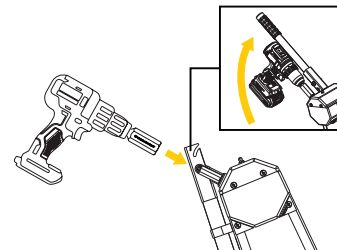

6. Align and insert the drill adapter to the drill adapter driveshaft. Lift the steering handle to disengage brakes, and start moving!

IMPORTANT SAFETY INFORMATION

For information and assistance, please visit our support page at TrailerValet.com or give us a call at (844) 846-9344. Scan the QR code to the right for detailed safety and usage information.



Check that you have all your parts and accessories.



SPANNER WRENCH



DRILL ATTACHMENT

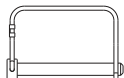

ROTATION PIN

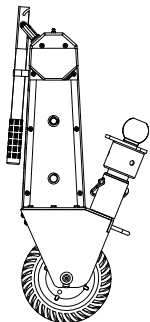

MV PRO UNIT



BALL CONVERTER



COUPLING PLATE



2" HITCH BALL



BALL BASE

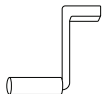

HAND CRANK



MANUAL



TRAILER VALET MV PRO W/ JX SIDE

Quick Start Guide

Rev 7.01.24



- 1.** Follow your JX Manual for instructions on how to install the JX unit to your trailer.

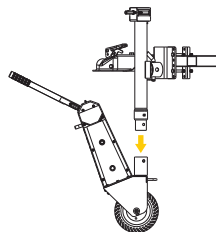

- 2.** Lower the hitch and connect the JX Side to the MV Pro's rotating coupler.

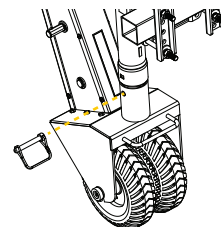

- 3.** Attach rotation pin to secure.

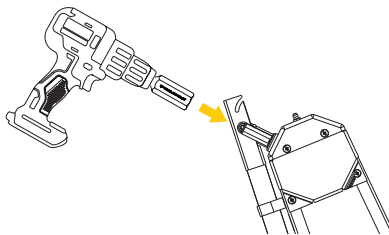

- 4.** Align and insert the drill adapter to the drill adapter driveshaft.

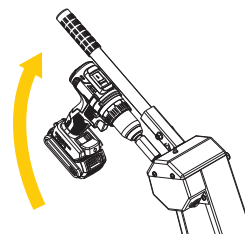

- 5.** Lift the steering handle to disengage brakes, and start moving!

IMPORTANT SAFETY INFORMATION

For information and assistance, please visit our support page at TrailerValet.com or give us a call at (844) 846-9344. Scan the QR code to the right for detailed safety and usage information.

