

Litheli FrozenPack Portable Fridge

SKU: U20HW05-0A101 / U20HW05-0A001

MODEL NO.: EHW040002

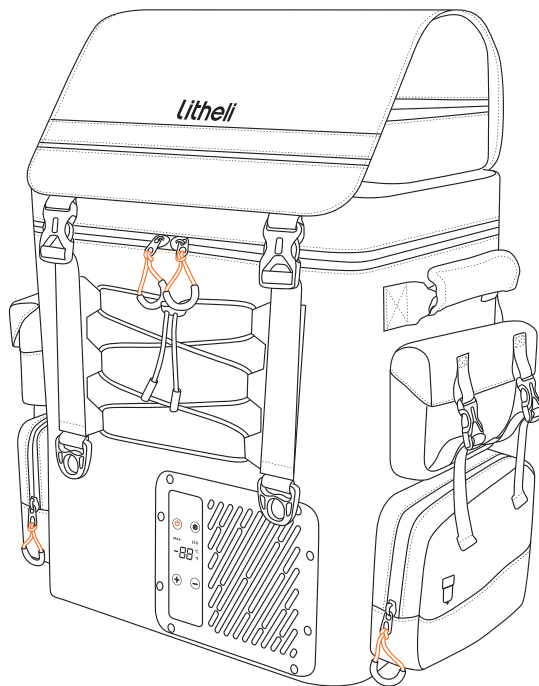

! **WARNING:** To reduce the risk of injury, the user must read and understand the user manual before using this product. Save this manual for future reference.

TABLE OF CONTENTS

What's in the Box.....	02
Know Your Portable Fridge.....	03
Powering Your Portable Fridge.....	04
Accessory Attachment.....	05
Operation.....	07
Safety Instructions.....	09
Maintenance And Storage.....	11
Troubleshooting.....	12
Warranty.....	14

WHAT'S IN THE BOX

Please kindly check all accessories are complete, if any accessories missing, please feel free to contact us at: service@litheli.com

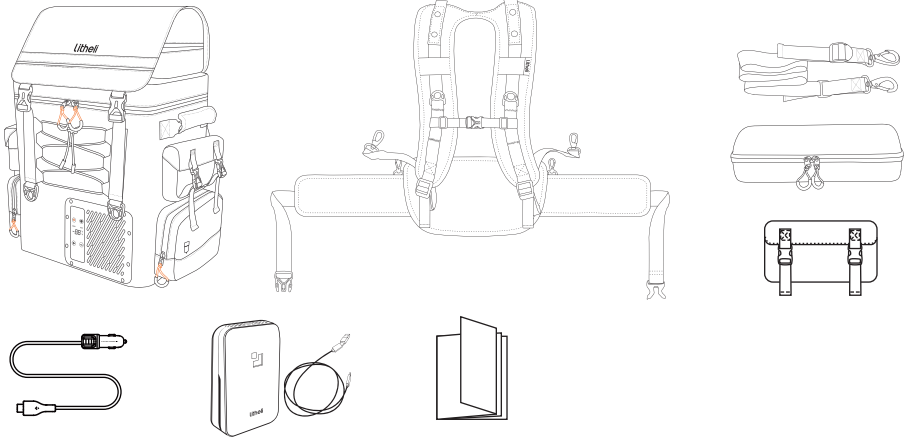

SKU	U20HW05-0A101	U20HW05-0A001
Model No.	EHW040002	EHW040002
Litheli FrozenPack Portable Fridge	1	1
Vehicle Charging Cable	1	1
U20 IPS SUPER BATTERY	1	0
Charging Cable	1	0
Backpack Suspension System	1	1
Detachable Top Box	1	1
Detachable Side Bag	2	2
Strap	1	1
Operating Manual	1	1

Unpacking

- Take out all items. Make sure that all items listed in the parts list are included.
- Inspect the product carefully to make sure that no breakage or damage has occurred during shipping.
- Do not discard the packing material until you have carefully inspected and satisfactorily operated the product.
- If any parts are damaged or missing, please return the product to the place of purchase.

KNOW YOUR PORTABLE FRIDGE

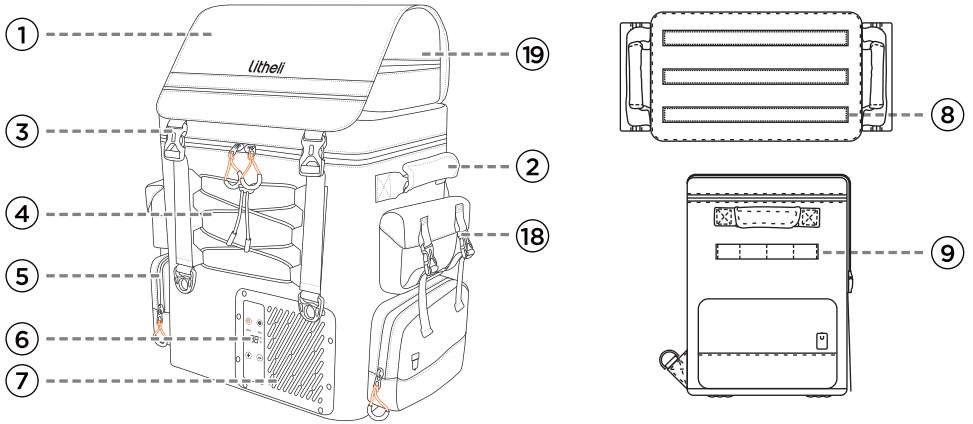

Backpack Suspension System

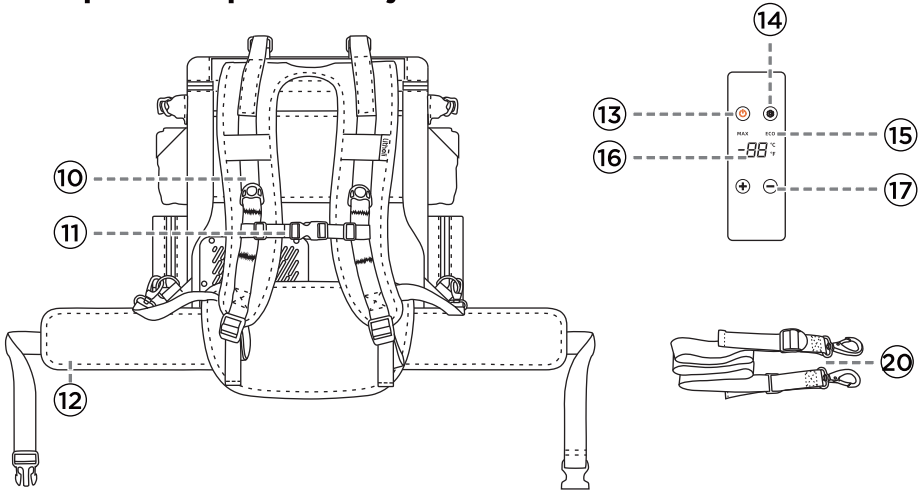

- 1.Top Cover
- 2.Side Handle
- 3.Compression Buckle
- 4.Front Stretch Strap
- 5.Side Bag
- 6.Control Panel
- 7.Ventilation Opening
- 8.Patch Area
- 9.MOLLE Loading System

- 10.Shoulder Strap
- 11.Chest Sliding Adjustment Buckle
- 12.Hip Belt
- 13.Power Button
- 14.Setting Button
- 15.Max/Eco Mode Indicator
- 16.Status Display
- 17.Adjustment Buttons
- 18.Detachable Side Bag
- 19.Detachable Top Box
- 20.Strap

Technical data

SKU	U20HW05-0A101 / U20HW05-0A001
Model No.	EHW040002
Capacity	17 qt. (16 L)
Cooling Range	-4 °F-68 °F (-20 °C-20 °C)*
Rated Power for Cooling	55 W
Refrigerant Type/Amount	R134a / 0.07 lbs (30 g)
Car Charging Input	12/24V, 5A, 55W
Noise Level	≤ 35 dB
Dimensions	18.5 x 11.8 x 16.9 " (470 x 300 x 430 mm)
Net Weight	24.3 lbs (11 kg)

*Under specific conditions, the fridge can reach -20 degrees Celsius.

POWERING YOUR PORTABLE FRIDGE

- This product can be powered by the U20 IPS SUPER BATTERY or by connecting the included car charger for charging purposes.
- When both the U20 IPS SUPER BATTERY and the car charger are connected, the car charger takes priority for charging.

Powering with the U20 IPS SUPER BATTERY:

⚠ WARNING: Charge the battery in a dry and ventilated room, far away from combustibles and ignition sources.

NOTICE: The charger is not supplied with this appliance. You should prepare a charger to work with the supplied charging cable for charging. Make sure the charger meets the charging requirements of the battery pack. If you have any questions, please contact Litheli Customer Service for assistance.

NOTICE: Lithium-ion batteries are shipped partially charged. Before using it the first time, fully charge the battery.

NOTICE: Please refer to the Charging Your Battery section of the battery manual for details of the indicated lights display and charging considerations.

There is only one way to install the battery. When inserting the battery, carefully observe that the battery contacts underneath align properly. Ensure that the grooves on the battery align with the protrusions in the battery compartment before placing it inside.

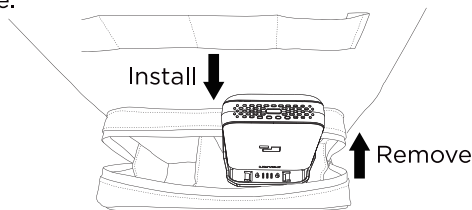

Powering with the Car Charge:

NOTICE: The power input via the Vehicle Charging Port of Portable Fridge must not exceed 100W. The Vehicle Charging Port supports automotive batteries of 12/24V (It must only be supplied at safety extra low voltage corresponding to the marking on the appliance.) , with an electric current of 12V/5A , 24V 2.5A at most.

WARNING: While using the Vehicle Charging Port to charge the product, make sure the car engine is running, otherwise the automotive battery may be depleted.

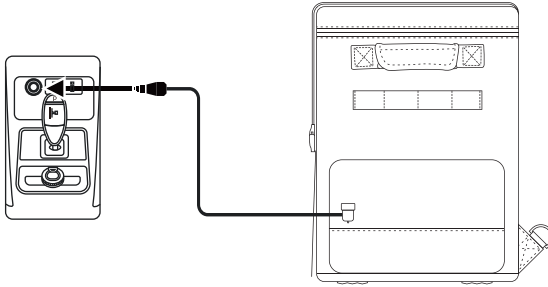

ACCESSORY ATTACHMENT

NOTICE: The Backpack Suspension System is only for moving the refrigerator. It should be removed when the refrigerator is placed for use.

Shoulder Strap Attachment

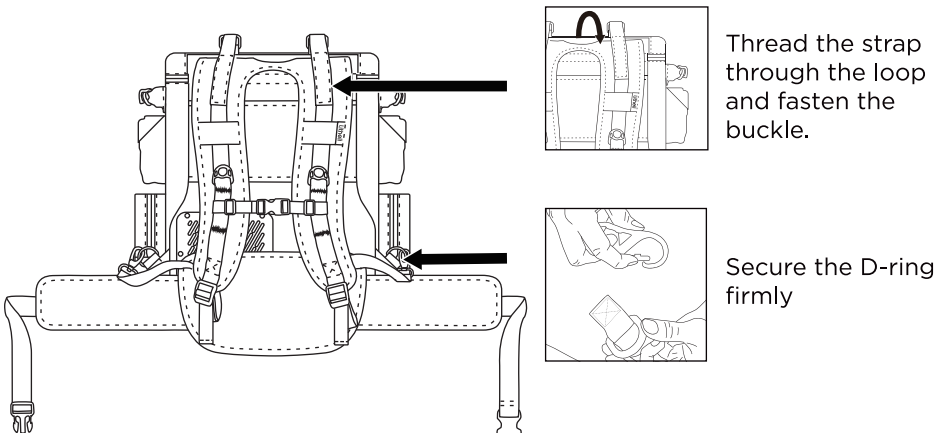

Hip Belt Attachment

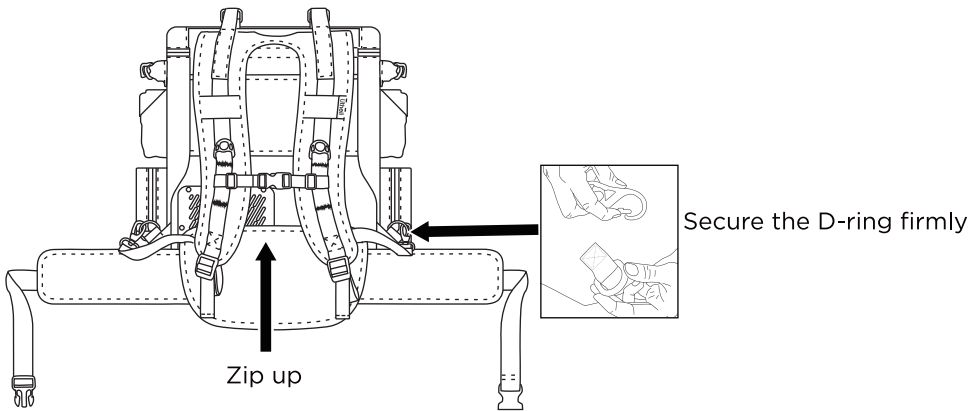

Detachable Box / Bag Attachment

- Secure the detachable top box on the Patch Area as shown and tighten.
- Secure the detachable side bag straps through the MOLLE loops as shown and tighten.

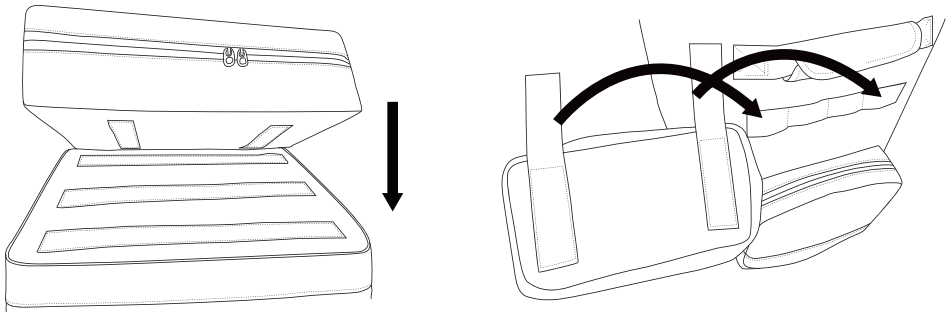

Strap Usage

The strap length is adjustable and is used for securing the refrigerator during movement to prevent tipping.

1. When placing the refrigerator on the car seat

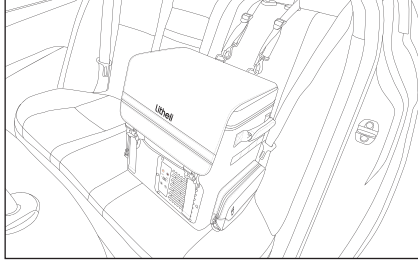

2. When placing the refrigerator in the car trunk

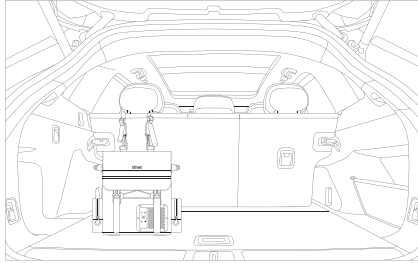

OPERATION

⚠WARNING: Do not attempt to modify this product or create accessories not recommended for use with this product. Any such alteration or modification is misused and could result in a hazardous condition leading to serious injury.

⚠WARNING: Do not allow familiarity with this product to make you careless. Remember that a careless fraction of a second is sufficient to inflict injury.

⚠WARNING: Do not use any attachments or accessories not recommended by the manufacturer of this product. Use of attachments or accessories not recommended can result in serious personal injury.

Power On/Off

Press the Power Button briefly to turn on/off.

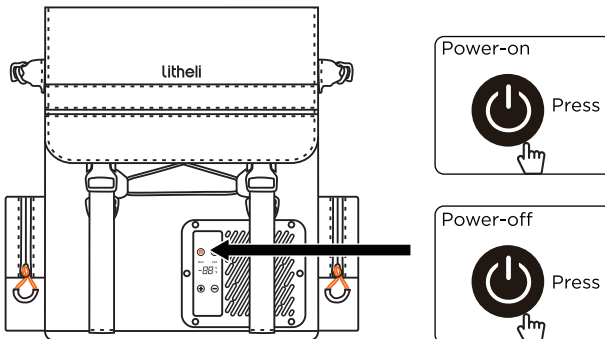

Temperature Setting

1. Upon powering on, the real-time temperature inside the Portable Fridge is displayed.
2. Press the + or - button to adjust the temperature setting; each short press changes the temperature by one degree, while a long press of the Setting Button enables quick adjustment.
3. Changes are saved automatically after three seconds of inactivity.

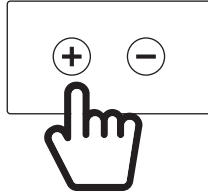

Max/Eco Mode Switch

Press the setting button once to toggle between Max and Eco modes.

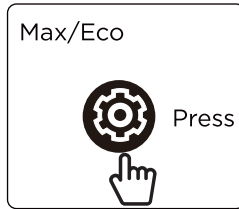

Car Charger Voltage Mode Switch

1. Long press the Setting Button for three seconds to enter battery protection mode.
2. Press the + or - button to adjust between high, medium, and low voltage settings.

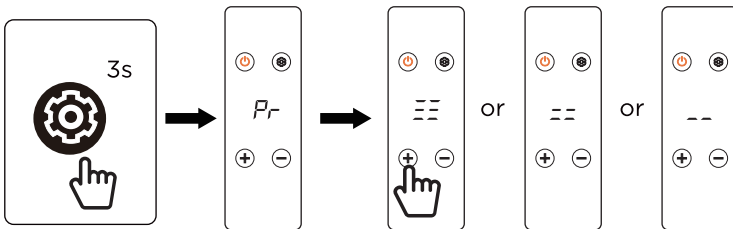

VOLTAGE	PROTECTION POSITION	LOW	MED	HIGH
12V	CUT OFF (V)	9.6	10.4	11.1
	CUT IN (V)	10.9	11.7	12.4
24V	CUT OFF (V)	21.3	22.8	24.3
	CUT IN (V)	22.7	24.2	25.7

Temperature Unit Switch

1. Long press the Setting Button for three seconds to enter battery protection mode, then briefly press it to enter the temperature unit switch mode.
2. Press the + or - button to toggle between Fahrenheit and Celsius. Changes are saved automatically after three seconds of inactivity.

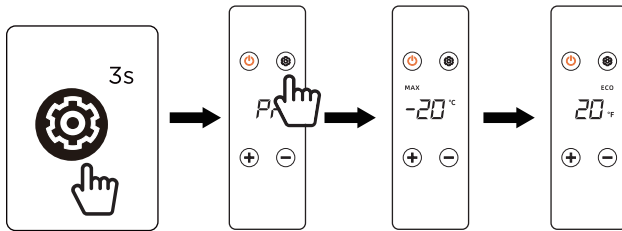

SAFETY INSTRUCTIONS

Electrical Hazards

1. Do not operate the cooling device if it is visibly damaged. Immediately stop the device and switch off all power supplies.
2. If this cooling device's power cable is damaged, it must be replaced to prevent safety hazards.
3. This cooling device may only be repaired by qualified personnel. Improper repairs can lead to considerable hazards.

Fire Hazards

1. When installing or positioning the device, ensure the supply cord is not trapped or damaged.
2. Keep the ventilation openings on the device housing free of obstructions.
3. Do not place the cooling device near naked flames or other heat sources (heaters, direct sunlight, gas ovens etc.).
4. Do not use sharp tools to defrost; Do not damage the refrigerant circuit.
5. This device can be used by children aged from 8 years and above and persons with reduced physical, sensory or mental capabilities or lack of experience and knowledge if they have been given supervision or instruction concerning use of the device in a safe way and understand the hazards involved.
6. Check that the voltage specification on the data plate corresponds to that of the power supply.
7. Do not place heavy objects or objects harmful to the refrigerator (containers containing liquids) on the refrigerator, so as to avoid injury, fire, or electric shock due to falling objects when opening and closing the refrigerator doors.
8. Never put your hands or metal rods into the cold air outlet, lid, bottom of the refrigerator, and the heat shields (vents) on the sides.
9. The cooling device is not suitable for storing caustic materials or materials containing solvents.
10. The insulation of the cooling device contains flammable cyclopentane and requires special disposal procedures. Deliver the cooling device at the end of its life-cycle to an appropriate recycling center.

Risk of Overheating

Ensure at all times that there is a minimum of 4 in (100 mm) ventilation on all four sides of the cooling device. Keep ventilation openings, in the appliance enclosure or the built-in structure, clear of obstructions. Do not place the cooling device in closed compartments or areas with zero or minimal airflow.

1. Ensure that the ventilation openings are not covered.
2. Never immerse the cooling device in water.
3. Protect the cooling device and cables against heat and moisture.
4. The device shall not be exposed to rain.

Battery Handling

1. Use only Litheli's designated battery with this product.
2. Follow the manual instructions for removing and inserting the battery.
3. Remove the rechargeable battery from the portable fridge before charging.
4. Do not use a battery with low power; remove and recharge promptly. Refer to the battery manual for usage and charging instructions.
5. Ensure the battery is inserted with correct polarity as indicated.
6. Remove and safely dispose of a damaged battery from the portable fridge.
7. If storing the portable fridge unused for a long period, remove the battery.
8. Avoid short-circuiting the portable fridge's supply terminals

Health Instructions

To avoid contamination of food, please respect the following instructions:

1. Please check if the cooling capacity of the device is suitable for storing the food or medicine you wish to cool.
2. Food should only be stored in its original packaging or in suitable containers.
3. Opening the cooling device for long periods can significantly increase the temperature in the compartments of the device.
4. Regularly clean surfaces that can come in contact with food and accessible drainage systems.
5. If the device is left empty for long periods:
 - Turn off the device.
 - Defrost the device.
 - Clean and dry the device.
 - Leave the door open to prevent mold developing within the device.

Intended Use

The refrigeration device is intended to be used in household, outdoor, vehicle, boat and similar applications such as:

1. Staff kitchens in stores, offices and other work areas
2. Farmhouses
3. By clients in hotels, motels and other residential type environments
4. Bed and breakfast type environments
5. Catering and similar non-retail applications
6. Camping use:
 - suitable for camping use;
 - the appliance shall not be exposed to rain.

WARNING: This appliance is not intended for use by persons (including children) with reduced physical, sensory or mental capabilities, or lack of experience and knowledge, unless they have been given supervision or instruction concerning use of the appliance by a person responsible for their safety. Children should be supervised to ensure that they do not play with the appliance.

MAINTENANCE AND STORAGE

⚠WARNING: When servicing, use only identical replacement parts. Use of any other parts may create a hazard or cause product damage. To ensure safety and reliability, all repairs should be performed by a qualified service technician.

⚠WARNING: For the user's safety, worn or damaged parts must be replaced. Replace with original replacement parts only.

⚠WARNING: To prevent serious injury from product failure, do not use damaged equipment. If abnormal noise or vibration occurs, correct the problem before further use.

CLEANING

1. Please disconnect all power before cleaning to ensure safety.
2. Wipe with a soft cloth dampened with a neutral detergent. Do not use cleaning powder, benzene, hydrochloric acid, hot water, rough brushes, abrasive cleaning agents or hard objects to clean the refrigerator. Otherwise, it will damage or corrode the refrigerator.
3. Regularly clean the inside and outside of the refrigerator with a damp cloth.
4. Never clean the device under running water or immerse it in water.
5. Ensure that the air inlets and outlets on the refrigerator are free of any dust and dirt for good ventilation.
6. Do not directly touch the interior of the freezer or metal containers with wet hands. Otherwise, it may cause frostbite.
7. After cleaning, please check whether the power cable is damaged or wet, and whether the power plug is overheated. You can plug in the power supply only after confirming that everything is normal.

STORAGE TIPS

1. Disconnect power, remove batteries, and clear out the fridge.
2. Regularly clean and ventilate to prevent moisture buildup and odors.
3. Use a dust cover for added protection.
4. Maintain battery/circuit health by regular charging.
5. Avoid direct sunlight exposure and periodically check its condition.

DISPOSAL



It is prohibited to dispose of this appliance as household waste. Instead, it should be taken to the appropriate waste collection point for the recycling of electrical and electronic equipment. By ensuring this product is disposed of correctly, you will help prevent potential negative consequences for the environment and human health, which could otherwise be caused by the inappropriate waste handling of this product. For more detailed information about the recycling of this product, please contact your local council your household waste disposal service, or the shop where you purchased the product.

TROUBLESHOOTING

The following table gives checks and actions that you can perform if your device does not operate correctly. If these do not identify/remedy the problem, contact Litheli Customer Service at service@litheli.com.

⚠WARNING! Switch off the device and remove the batteries before any troubleshooting.

Fault Code Display	Reason	Remedy
E1	Low Car Charger Voltage Protection (Module input voltage below the set value)	Check the power interface connection; check the car battery level; try reconnecting the car charger; if the problem persists, please contact customer service.
E2	Fan Malfunction	Check if the fan is obstructed by foreign objects; if the problem persists, please contact customer service.
E3	Compressor Startup Failure	Disconnect the power connection, remove the battery, wait for five minutes, and try to restart.
E4	Refrigeration System Overload	Disconnect the power connection, remove the battery, wait for five minutes, and try to restart.
E5	High/Low Temperature Protection	Check if the ventilation openings are clear; turn off the power switch, remove the battery, move the refrigerator to a cool/warm place, and restart it after it returns to normal temperature.
E6	NTC Malfunction	Reconnect the power supply. If the problem persists, please contact customer service.
E7	Communication Failure	Reconnect the power supply. If the problem persists, please contact customer service.
E8	Tilt Protection	Place the refrigerator steadily, and the warning will be released after one minute.
LO	Low Battery Warning	Replace the battery pack with sufficient power.

Tips:

1. Check and operate the product following this manual closely to avoid unnecessary failures.
2. If the product still fails to work, contact the Litheli Customer Service.

WARRANTY

Litheli WARRANTY POLICY FOR U20 PRODUCT

For this Litheli U20 product (battery excluded) used for personal and household purposes, 1-year limited warranty is available.

Please contact Litheli Customer Service any time you have questions or warranty claims.

LIMITED WARRANTY SERVICE

FOR ONE YEAR from the date of original retail purchase, this Litheli product is warranted against defects in material or workmanship. Defective product will receive free repair or will be exchanged.

- 1.This warranty only covers Litheli products used for residential purposes.
- 2.This warranty does not cover consumables such as but is not limited to charging cables.
- 3.This warranty does not cover the damage resulting from modification, alteration or unauthorized repair.
- 4.This warranty only covers defects arising under normal usage and does not cover any malfunction, failure or defect resulting from misuse, abuse (including overloading of the product beyond capacity and immersion in water or other liquid), accidents, neglect or lack of proper installation, and improper maintenance or storage.
- 5.This warranty does not cover normal deterioration of the exterior finish including but not limited to scratches, dents, paint chips, or to any corrosion or discoloring by heat, abrasive and chemical cleaners.
- 6.This warranty applies only to the original purchaser from an authorized Litheli shop and may not be transferred.

WARRANTY CLAIM

For warranty claims, please contact Litheli Customer Service. You will need to submit a registration document or proof of purchase in the form of a valid receipt that displays the date and place of purchase. Replacement products do not come with a new warranty. The warranty of the products will continue from the date of the original purchase.

Electrical schematic

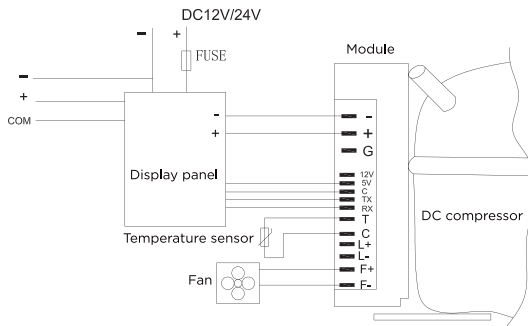

litheli tool