

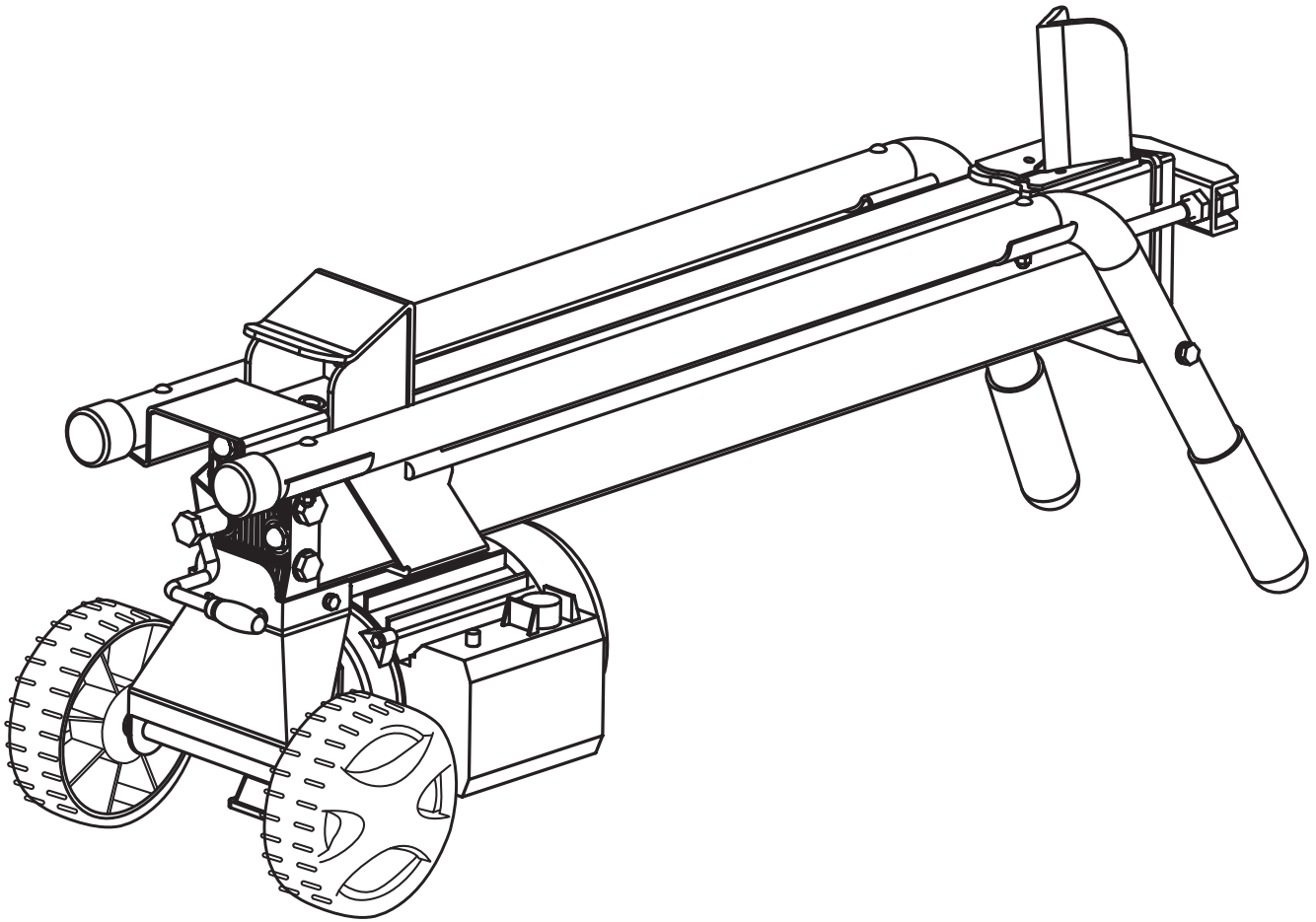

Item No. PTG3506

6.5 TON ELECTRIC LOG SPLITTER OPERATOR'S MANUAL



WARNING: All operators must read this manual before operating this log splitter.
Follow the safety instructions in the manual and in decals attached to the product.
Failure to do so could result in serious injury or death.

support@pulsar-products.com

Table of Contents

	Page(s)
Important Safety Information.....	1-6
Intended Use	1
Personal Protective Equipment	1
General Safety	1
Safety Decals	2
Preparation of the Log	3
Work Area	3
Operation of the Log Splitter	3-4
Repair and Maintenance Safety	5
Hydraulic Safety	6
Fire Prevention	6
Transportation	6
Assembly Instructions	7
Operating Instructions	7-10
Directions for Filling Hydraulic System	10
Storage	10
Operation	8
Maintenance	11
Replacement Parts	11
Notes	12
Warranty Information	12
Specifications	Back Cover



IMPORTANT SAFETY INFORMATION



WARNING: Read and thoroughly understand all instructions and safety information before assembling or operating this log splitter. Failure to do so may cause serious injury or death. Do not allow anyone to operate this log splitter who has not read this manual. As with all power equipment, a log splitter can be dangerous if assembled or used improperly. Do not operate this log splitter if you have doubts or questions concerning safe operation. Call our customer service department at 866-591-8921 to address these concerns.

INTENDED USE

NEVER use this log splitter for any other purposes than splitting wood. It is designed for this use **only**. Any other use can cause serious injury or death.

PERSONAL PROTECTIVE EQUIPMENT



BEFORE operating this log splitter make sure that you wear safety gear such as goggles or safety glasses, steel toed shoes and tight fitting gloves (without loose cuffs or draw strings). Always wear a protective hearing device when operating this log splitter.

NEVER wear loose clothing or jewelry that can be caught by moving parts of the log splitter. Keep clothing and hair away from all moving parts when operating this log splitter.

GENERAL SAFETY

Failure to follow these instructions may result in serious injury or death.

NEVER allow children to operate this log splitter. **NEVER** allow adults lacking proper instructions and understanding to operate this log splitter.

KEEP all people and pets a minimum of 10 feet away from your work area when operating this log splitter. Only the operator is to be near the log splitter during use.

If a helper is assisting in loading logs, **NEVER** actuate the control until the helper is clear of the work area.

NEVER operate the log splitter when under the influence of alcohol, drugs or medication.

NEVER allow a person who is tired or otherwise not alert to use your log splitter.

ALWAYS unplug your log splitter when finished. Do not pull on power supply cable to unplug your log splitter.



IMPORTANT SAFETY INFORMATION

SAFETY DECALS

Make sure that all safety warning decals are in good condition and readable. Always replace missing or defaced decals. Write us or call 866-591-8921 and they will be sent to you at no charge.



LOCATION: FRONT, OPERATOR'S SIDE OF BEAM

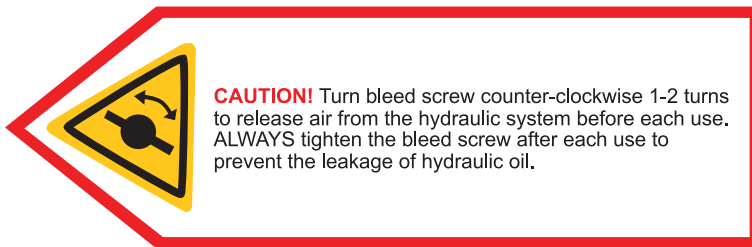

LOCATION: FRONT, NON-OPERATOR'S SIDE OF BEAM

SERIAL NUMBER TAG

PuSAR		6.5 TON LOG SPLITTER			
Item No. PTG3506					
120V~	60Hz	1500W	15A	IP54	
Splitting Force		6.5 Tons	CLASS B		
Max. Log Size		20-1/2"	 		
Net Weight		98 lbs.			
Serial No.		   			
<small>WARNING: For safe operation, read owner's manual prior to use.</small> <small>CALIFORNIA PROPOSITION 65</small> <small>WARNING: Cancer and Reproductive Harm - www.P65warnings.ca.gov</small>					
Made In China					



IMPORTANT SAFETY INFORMATION

PREPARATION OF THE LOG

Both ends of the log should be cut as square as possible to help prevent the log from riding out of the splitter during operation. Do not split logs greater than 20 in. in length.

WORK AREA

NEVER operate the log splitter on slippery, wet, muddy or icy ground.

ONLY operate your log splitter on a level surface. Operating on a slope could cause the log splitter to roll over or logs to fall off.

ALWAYS keep children away from the log splitter. All visitors should be kept a safe distance from the work area.

NEVER operate your log splitter in a damp or rainy environment to avoid electric shock or short circuit.

ALWAYS block the wheels to prevent movement of the log splitter while in operation.

ONLY operate your log splitter in daylight or under good artificial light.

ALWAYS keep the work area clean. Remove split wood around your log splitter immediately so that you don't stumble over it. Cluttered areas and benches invite accidents.

OPERATION OF THE LOG SPLITTER

ALWAYS make sure the power switch is in the OFF position before plugging in the cord to avoid unintentional starting.

ALWAYS ensure the motor is properly grounded or apply protection device. Only use rubber-jacketed cable of sufficient lead cross section as an extension cable.

ALWAYS split wood in the direction of the grain only.

ALWAYS hold the sides of the log when loading it on the splitter.

KNOW how to stop the log splitter and disengage the controls before operating it.

NEVER place hands, feet or any body part between the ram and splitting wedge during forward or reverse stroke. Serious injury or death could result.

ALWAYS keep hands away from the ram, wedge and partly split logs.

NEVER straddle or step over the log splitter during operation.

NEVER move the log splitter while the motor is running. Shut off the motor even if you are leaving the log splitter for a short period of time.

NEVER leave the machine unattended during operation. Turn power off and wait until it comes to a complete stop.

ALWAYS operate this log splitter from the "operator zone." This is the area behind the wheels and control handle.



IMPORTANT SAFETY INFORMATION

ALWAYS check for damaged parts before operation. Do not operate until it is repaired.

NEVER use an extension cord longer than 25 feet. Minimum cord gauge must be 16. An undersized cord will cause a drop in line voltage resulting in loss of power and overheating.

NEVER stand or ride on the log splitter. Serious injury could result if the unit is tipped over or if the cutting wedge is contacted.

ALWAYS keep guards in place. Do not remove.

NEVER force or push the log when splitting. It will do a better and safer job at the rate for which it was designed.

ALWAYS wear safety glasses when operating this log splitter.

ALWAYS use the tow handle to move the log splitter around.

NEVER reach or bend over the log splitter to pick up a log.

NEVER try to split two logs on top of each other. Keep proper footing and balance at all times.

NEVER try to cross split a second log.

NEVER allow one person to operate the valve while another is positioning the log.

NEVER attempt to load your log splitter when the ram is in motion.

ALWAYS use your hand to operate the control lever and the switch. **NEVER** use your foot, a rope or any extension device.

NEVER use this product for anything other than splitting wood.

NEVER use improper accessories with this log splitter. Check owner's manual for recommended accessories.

NEVER modify the plug provided if it will not fit the outlet. Have the proper outlet installed by a qualified electrician.

ALWAYS use a 3-wire extension cord with 3-prong grounded plugs and a 3-pole receptacles that accept this plug.

NEVER loosen or remove the hydraulic fittings or the cap of the hydraulic tank while the log splitter is running.

REPAIR AND MAINTENANCE SAFETY

NEVER operate your log splitter when it is in poor mechanical condition or in need of repair.

ALWAYS unplug the power cable before performing any maintenance and repair.

Periodically check that all nuts, bolts, screws, hydraulic fittings and hose clamps are tightened.

NEVER alter your log splitter in any manner such as adding a rope or extension to the control lever or adding to the width or height of the wedge. Such alterations may cause your log splitter to be unsafe and will void the warranty.

Perform all recommended maintenance procedures before using your log splitter.

Replace all damaged or worn parts immediately with the original equipment manufacturer's parts only.

NEVER tamper with the motor to run it at excessive speeds. The maximum motor speed is preset by the manufacturer and is within safety limits.

NEVER adjust the hydraulic valve. The system is preset at the factory and is within safety limits.

ALWAYS check the level of hydraulic oil before operation.

ALL replacement parts must meet manufacturer's specifications.

ALWAYS repair or replace a damaged power cord immediately.



IMPORTANT SAFETY INFORMATION

HYDRAULIC SAFETY

The hydraulic system of your log splitter requires careful inspection along with the mechanical parts. Be sure to replace frayed, kinked, cracked or otherwise damaged hydraulic components.

NEVER check for leaks of hydraulic fluid with your hand. Fluid escaping from a small hole can be almost invisible. Escaping fluid under pressure can have sufficient force to penetrate skin causing serious personal injury or even death. Leaks can be detected by passing a piece of cardboard over the suspected leak and looking for discoloration.

ALWAYS seek professional medical attention immediately if injured by escaping hydraulic fluid. Serious infection or reaction can develop if proper medical treatment is not administered immediately.

ALWAYS be sure to relieve all pressure by shutting off the engine and moving the valve control handle back and forth should it become necessary to loosen or remove any hydraulic fitting.

NEVER remove the cap from the hydraulic tank or reservoir while the log splitter is running. Hot oil under pressure could result in serious injury.

NEVER adjust the hydraulic valve. The pressure relief valve on your log splitter is preset at the factory. Only a qualified service technician should perform this adjustment.

FIRE PREVENTION

NEVER operate your log splitter near a flame or spark. Hydraulic oil is flammable and can explode.

ALWAYS take a Class B fire extinguisher with you when operating this log splitter in dry areas as a precautionary measure against possible flying sparks.

TRANSPORTATION

NEVER move this log splitter while the motor is running.

NEVER carry any cargo or wood on your log splitter.

NEVER allow anyone to sit or ride on your log splitter.

Be careful when moving your log splitter on rugged and rough terrain. Keep your log splitter upright.

ASSEMBLY INSTRUCTIONS

NOTE: This log splitter was completely assembled at the factory. The product has been filled with hydraulic oil at the factory. Refer to the photo and parts list should it become necessary to disassemble the unit for repair or replacement of parts. Remove the log splitter from the shipping container. Inspect it for shipping damage. If anything is damaged, contact your dealer or delivering carrier.

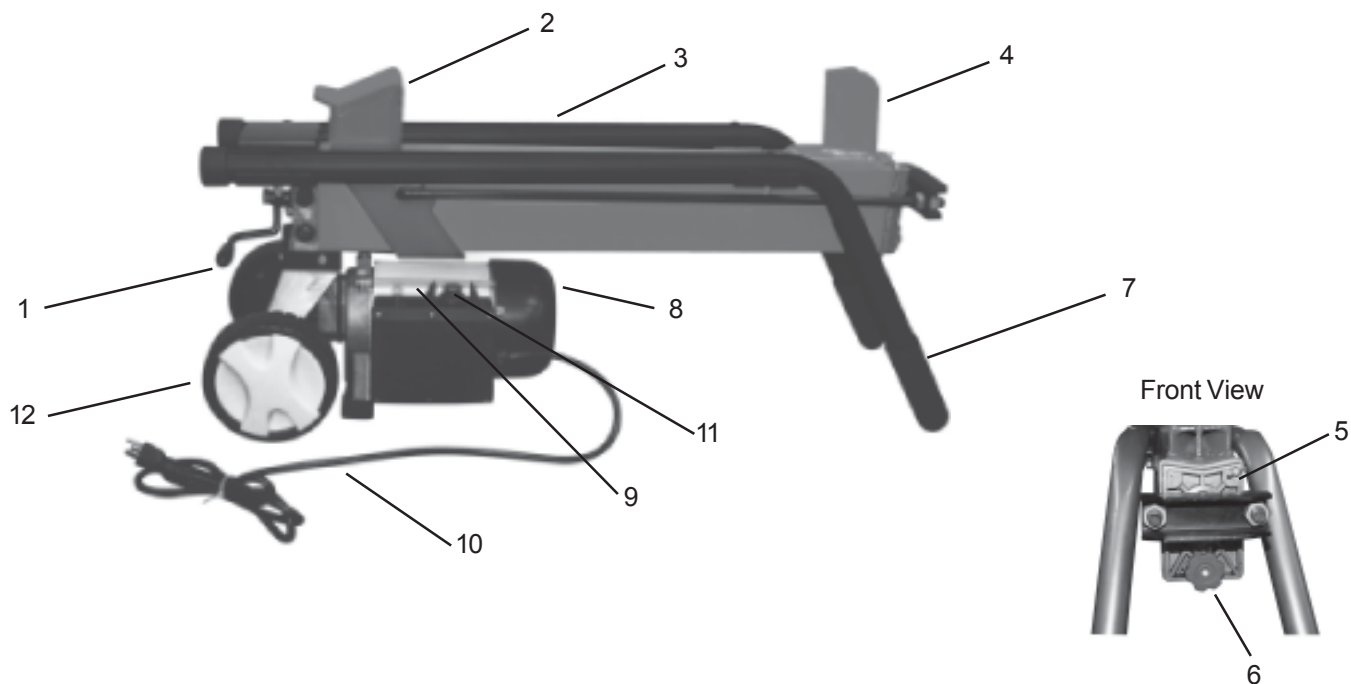

- 1 Hydraulic Control Lever
- 2 Push Plate
- 3 Work Table Guards
- 4 Wedge
- 5 Bleed Screw
- 6 Fluid Drain Knob w/ Dipstick
- 7 Lift Handles
- 8 Motor Housing
- 9 Circuit Breaker
- 10 Power Cord
- 11 ON/OFF Push Button
- 12 Rear Wheels

OPERATING INSTRUCTIONS

NOTE: This machine is only intended for homeowners and non-commercial users to split firewood as detailed in the instructions and not for any other purpose.

Preparation

NOTE: Ensure the power supply is not connected while preparing the log splitter for use.



WARNING: Read and thoroughly understand all instructions and safety information before operating this log splitter. Failure to do so may cause serious injury or death. Do not allow anyone to operate this log splitter who has not read this manual. As with all power equipment, a log splitter can be dangerous if assembled or used improperly. Do not operate this log splitter if you have doubts or questions concerning safe operation. Call our customer service department at 866-591-8921 to address these concerns.



CAUTION: NEVER START OR RUN THE LOG SPLITTER WITHOUT OIL IN THE HYDRAULIC RESERVOIR. ALWAYS CHECK THE LEVEL OF THE HYDRAULIC RESERVOIR BEFORE OPERATION.

NOTE: If hydraulic oil is difficult to obtain, Dextron automatic transmission fluid can be substituted. Use only clean oil and take care to prevent dirt from entering the hydraulic reservoir. Do not mix AW32 hydraulic fluid with Dextron transmission fluid. Log splitter is shipped with AW32 hydraulic oil. Drain the system if you wish to use Dextron transmission fluid.

IMPORTANT: Before operating the log splitter turn the bleed screw as shown below one or two turns to allow air to be released from the hydraulic system. A flow of air through the bleed screw should be detectable while the log splitter is in use. Close the bleed screw after operation. Make sure that the bleed screw is closed before and during moving. Hydraulic fluid may leak through the bleed screw opening if the bleed screw is not fully tightened.

Failure to loosen the bleed screw will cause pressure to build up in the hydraulic tank and could damage the seals and affect the operation of the log splitter.

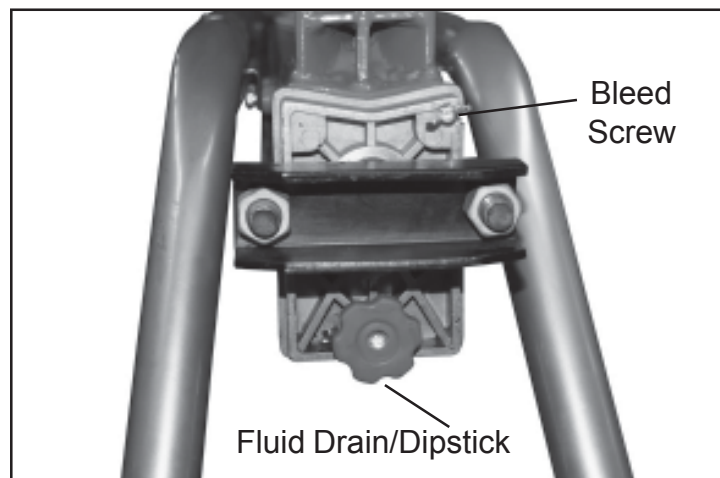

OPERATION



WARNING:

ALWAYS WEAR SAFETY GLASSES, SAFETY GLOVES, SAFETY SHOES AND SUITABLE WORK CLOTHING WHEN OPERATING THIS LOG SPLITTER. NEVER WEAR JEWELRY, NECKTIES OR OTHER LOOSE CLOTHING WHICH COULD GET CAUGHT IN MOVING PARTS.



DANGER:

KEEP HANDS AND FEET CLEAR OF RAM AND WEDGE AT ALL TIMES.



WARNING:

KEEP AWAY FROM FLAMMABLE LIQUIDS AND GASES BEFORE STARTING MACHINE

- 1) Place the log splitter on a sturdy, level surface. Block the wheels to prevent movement of the log splitter during operation.
- 2) Make sure the handle is free of oil, grease and resins.
- 3) Oil the wedge and the top of the beam for smoother operation.
- 4) Ensure the equipment is in safe working condition. Operate the unit without loading to make sure it is working normally. Check all nuts, bolts and hydraulic fittings are tight. Check the switch, power cable and plug for damage to avoid electric shock. Check that all safety shields are in proper position.
- 5) Check that the outlet's main voltage and frequency match the data stated on the model plate (or "Technical Specifications" in this manual).
- 6) Plug in the power cable and switch on the motor. NEVER use an extension cord longer than 25 feet. Minimum cord gauge must be 16. The power supply for this log splitter must have a protection device (circuit breaker) for over or under voltage.
- 7) Place a log on the beam against the push plate. Make sure that the log is securely on the beam and up against the push plate. Logs should be cut with square ends and to a maximum length of 20 in. in advance. Always use extra care when splitting logs with unsquare ends. See illustration below.
- 8) Two controls must be activated to operate the log splitter. The hydraulic control lever and the ON/OFF push button must be held during the splitting process. If either control is released, the log splitter will stop operating.
- 9) Loosen the bleed screw one or two turns if necessary.
- 10) Depress and hold the ON/OFF push button with your right hand and allow the motor to cycle up to speed.
- 11) Push down on the hydraulic control lever.
- 12) Release the ON/OFF button and the control lever when the log is split. The push rod will then retract.

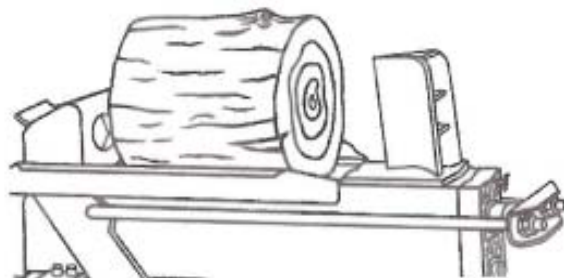



CAUTION:

ALWAYS SPLIT THE LOG ALONG ITS GRAIN. IF SPLIT ACROSS THE GRAIN SOME TYPES OF WOOD MAY BURST OR FLY OUT RESULTING IN INJURY.



CAUTION:

IF THE LOG IS STUCK ON THE WEDGE, RELEASE BOTH HANDS AND UNPLUG THE POWER CABLE IMMEDIATELY. KNOCK OFF THE LOG WITH A HAMMER. DO NOT USE YOUR HANDS.



When finished splitting the logs, switch the motor off and unplug the power cable.

NOTE: Switch off and unplug the power cable quickly if the machine is acting abnormal. Contact our customer service department at 866-591-8921 to address these concerns.

DIRECTIONS FOR REPLACING HYDRAULIC FLUID

- 1) Place a large pan under the motor end of the log splitter.
- 2) Use the included hex wrench to loosen the fluid drain bolt and remove the bolt with the attached dipstick.
- 3) Raise the splitting wedge end of the log splitter to allow the fluid to drain in to pan. Lower the splitter when it is empty. (Illustration A.)
- 4) Dispose of the used fluid properly.
- 5) Raise the motor end of the splitter and make sure it is secure. (Illustration B.)
- 6) Pour approximately 3.2 liters of approved hydraulic fluid into the tank.
- 7) Check the fluid level of the dipstick. Add more fluid if needed.
- 8) Replace the fluid drain bolt and tighten securely.
- 9) Lower the log splitter.

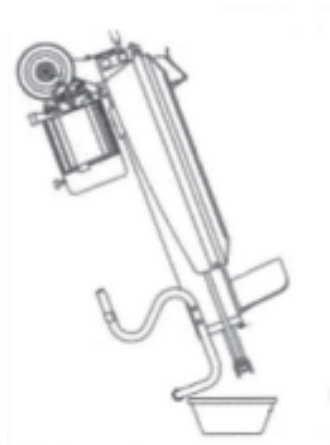

Illustration A

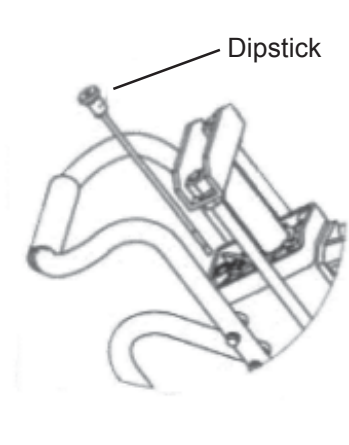

Illustration B

STORAGE

Store the log splitter switched off and unplugged.

Allow the log splitter to cool for 5 minutes after use before storing.

Protect the power supply cable from heat, sunshine, aggressive liquids and sharp edges.

Store unit in a clean, dry area. Don't store it unprotected outdoors, next to corrosive materials or in a damp environment.

Store this log splitter where children can not start it.

MAINTENANCE

- 1) Switch off and unplug power cable before performing any maintenance, adjustment or repair. Make sure to remove any tools and accessories from the work area when done.
- 2) Always check the oil level of the hydraulic reservoir before operation. Operating the log splitter without an adequate oil supply will cause severe damage to the pump.
- 3) Wipe the unit after use with an oiled rag to prevent rust.
- 4) The hydraulic system is preset at the factory. Do not adjust the valve.
- 5) If the ram moves slowly or erratically, there may be air in the system or insufficient hydraulic oil. Check the level of the hydraulic oil with the dipstick.
- 6) For other hydraulic and motor problems not addressed in this manual, please contact a qualified specialist.
- 7) If the wedge becomes dull or nicked, it can be sharpened. ALWAYS wear safety gloves while handling the wedge.
- 8) See also Repair and Maintenance Safety in the Safety Information section of this manual on page 5 of this manual.
- 5) All replacement parts must meet manufacturer's specifications.

NOTE: If the motor is overloaded for a long time, the thermal protector will disconnect the power of the motor. Switch off and unplug the power cord to cool down the motor for 30 minutes. Restart the motor and the log splitter should operate again.

NOTE: Switch off and unplug the power cable quickly if the machine is acting abnormal. Contact our customer service department at 866-591-8921 to address these concerns.

IMPORTANT NOTICE

We, the manufacturer, reserve the right to change the product and/or specifications in this manual without notification. The manual is for information usage only and the pictures and drawings depicted herein are for reference only.

2 YEAR LIMITED WARRANTY

This log splitter is guaranteed to be free from defects for two full years from the date of purchase.
1-Year Parts and labor 2nd Year Parts Only

Do not return this product to the store for warranty issues or repair. Call 866-591-8921 for the location of the nearest service center.

== NOTES ==

Record the information below for future reference.

Model No. _____

Serial No. _____

Date of Purchase _____

Place of Purchase _____

TECHNICAL SPECIFICATIONS

MAXIMUM SPLITTING FORCE*	6.5 Tons
ELECTRICAL REQUIREMENT	120V/60hZ
POWER OUTPUT	1500W
RATED CURRENT	15A
MOTOR SPEED	3400 RPM
POWER CABLE	SJTW 14AWG (2.08MM ²)
HYDRAULIC CAPACITY	2.8 Quarts (3.2L)
CYCLE TIME*	25 seconds
MAXIMUM LOG LENGTH	20.5"
MAXIMUM LOG DIAMETER	10"
HYDRAULIC PRESSURE	3000 PSI
MAXIMUM CYLINDER STROKE	18"
TIRE SIZE	7"
MACHINE DIMENSIONS (LXWXH)	38-1/4" x 11" x 18"
NET WEIGHT	99 lbs.

* Tonnage and cycle times may vary dependent upon mechanical and environmental conditions.