

## Warranty Registration

To register your product for the warranty, visit our website at [123filter.com](http://123filter.com) and go to the "Warranty" tab.

We provide a 30-day money-back guarantee, a 1-year manufacturer warranty, and lifetime tech support for all of our products. However, we do not have order information from websites other than 123Filter.com (Amazon, Home Depot, etc.), so please fill in that information upon registering your system. If you have any questions or concerns about your product, please call or email us, or put it in the notes/comments upon registering your warranty. Your satisfaction is our business!

**If you are happy with our products and service, please show your support by writing a product review on Amazon, even just a single line. It takes you just a minute but it means a lot to us. Thank you!**

[www.123Filter.com/warranty](http://www.123Filter.com/warranty)

678-261-7611  
M-F 9-5 EST

Atlanta, GA USA

[support@123filter.com](mailto:support@123filter.com)

**Water's Good™**



Scan this QR code  
to visit our website



Scan and see  
installation video



**iSpring** Water  
Systems

# iSpring DF Series Faucet Water Filter Installation Guide

Ver. 01/2022

## Packing List and Components

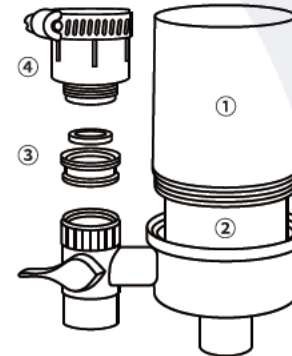

Part	Description	Qty
① Filter Housing	with base and spout	1
② Pre-installed Filter Cartridge	carbon fibers with GAC	1
③ Faucet Thread Adapter	male to male, with o-ring	1
④ Universal Faucet Adapter	with gasket	1

## Product Features

Item	Specification	Note
Model	DF 1&2 series	<ul style="list-style-type: none"> <li>Filter needs to be replaced every 6 - 8 months.</li> <li>The water flow rate will vary depending on the incoming water quality, which will also limit the performance of the system and reduce filter life.</li> </ul>
Working Pressure	10 - 80 psi	
Working Temperature	41 - 100 °F	

## Precautions

- Before use, check that the system is properly installed and not leaking.
- The operating temperature range is 41 - 100°F. If the ambient or water temperature falls below 41°F, immediately shut off the inline water supply, and drain the remaining water from the system.
- If leaking occurs, shut off the inline water supply by turning off the faucet. Then disconnect the system and contact iSpring customer service.
- Only use authorized iSpring parts and filters. Using unauthorized or aftermarket components will void the product warranty.
- Unauthorized modification and disassembly are strictly prohibited and will void the warranty.
- Performance data was tested under standard laboratory conditions; actual performance may vary.

- Do not use detergent, ethanol or other cleaning products to clean the product.
- ▲ Choking hazard. Small parts are included in the packaging. Please keep out of reach from small children at ALL times.

## Installation

### Step 1: Preparation

- Check the packing list to confirm all accessories are included. Contact the iSpring customer service team if any components are missing.
- Ensure the system is installed INDOORS using a cold water supply.
- Wash and dry your hands thoroughly to ensure all open cuts are covered. This prevents the filter cartridge and housing from becoming contaminated.

**Note:** The countertop filter systems are easy to install. No tools are required.

### Step 2: Installing the System to the Faucet

- Remove the aerator from the faucet. Your hands should be enough, but pliers can be used. Save the aerator, which may be needed if the filter is removed.

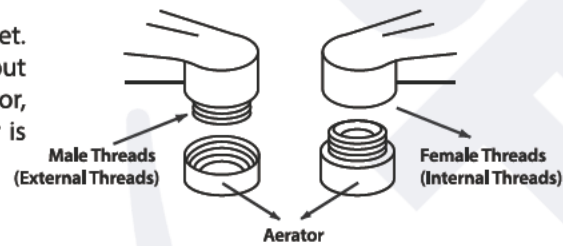

- For faucets with male threads (external threads), screw the diverter valve of the system onto the faucet. For faucets with female threads (internal threads), use the adaptor and gasket to fit the faucet, then install the diverter valve of the filter housing. For faucets without aerators, install the universal adaptor directly to the faucet and then install the diverter valve of the filter housing. Usually, the adaptor and diverter valve can be hand tightened; if necessary, use a hex screwdriver.

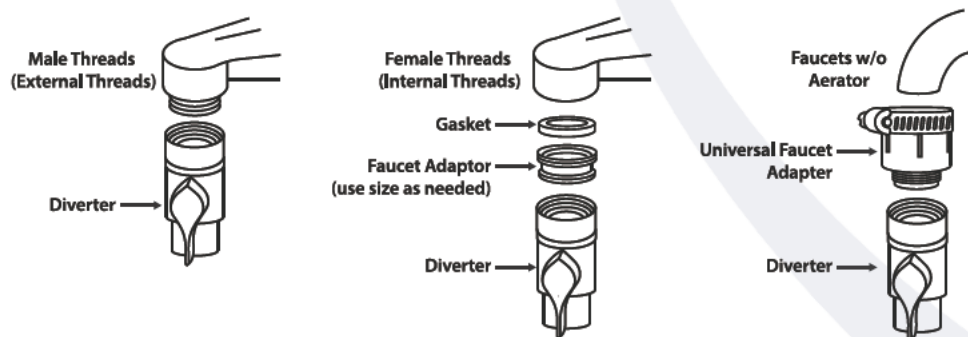

## Using the System

### Starting for the First Time

Allow water running into the sink for at least 10 minutes. Then the filter is ready for regular use.

### Routine Maintenance

- Let water run for 10 seconds before daily use.
- Let water run for at least 1 minute before use if the system has not been used for more than two days.
- If the system will not be used for more than one week, place the filter into water to maintain its function.
- By controlling the diverter valve stem, the system can produce filtered water through the spout of the filter and unfiltered water directly from the faucet.

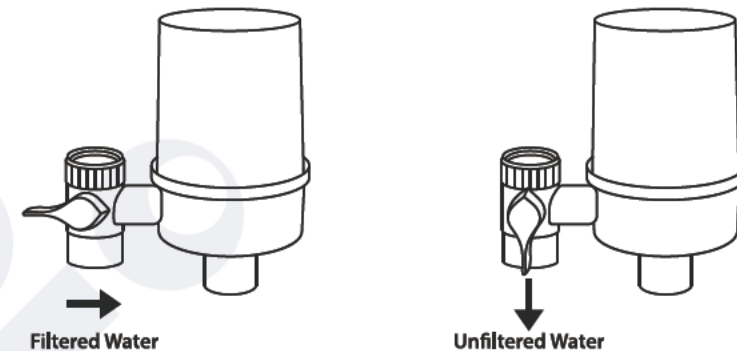

#### \*\*Caution\*\*

- Use cold water ONLY. Do NOT direct hot water into the unit.
- Do NOT close the diverter knob while the cold-water faucet is on. Always close the faucet to prevent damaging the diverter.

### Changing the Filters

- Disconnect the water supply and hold the filter unit over the sink.
- Unscrew the housing cap - care must be taken as the housing will be full of water, as well as evidence of minor leakage.
- Gently remove and replace the cartridge.
- Repeat the steps as described in **Starting for the First Time** section.