

YOUNG
Electric

MANUAL

Hitch Bike Rack - FELLOW

Parts

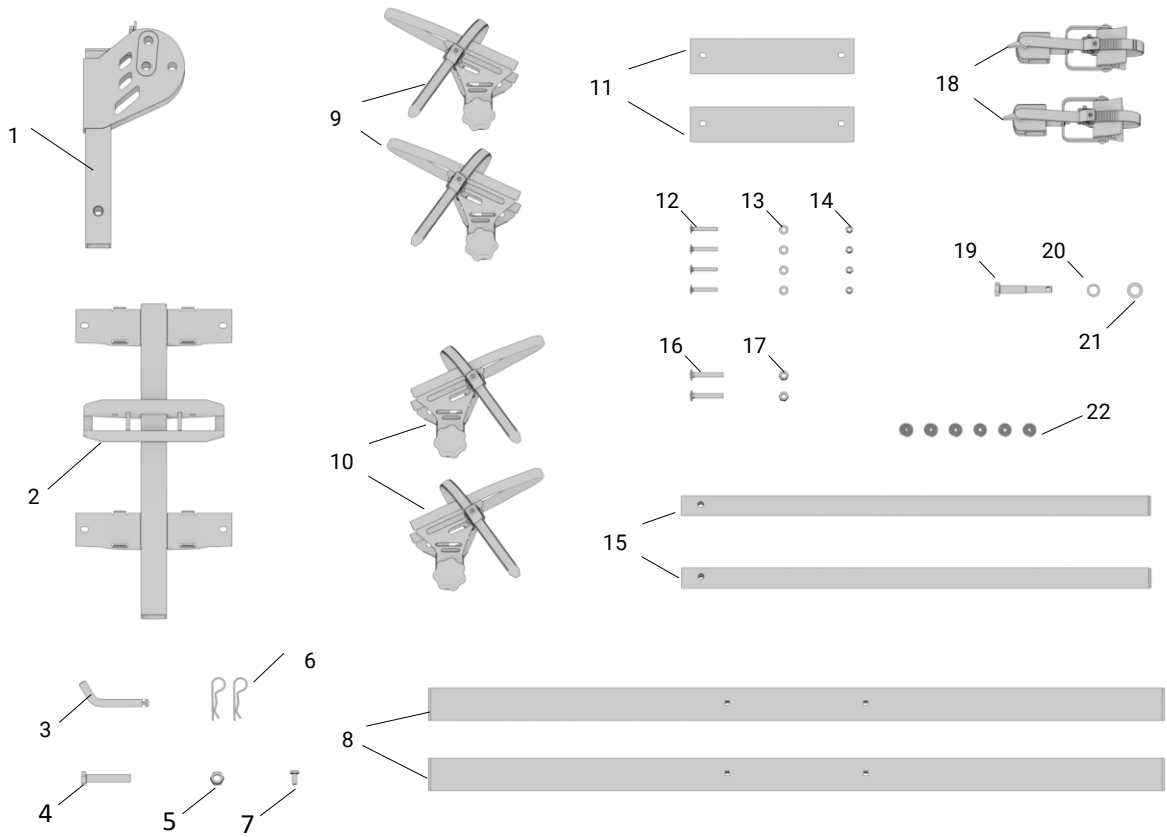

Parts List

Part#	Description	Qty
1	Rotating Group	1
2	Bottom Fixing Bracket	1
3	φ16 Bent Pin	1
4	M16*85 Hexagon Bolt	1
5	M16 Lock Nut	1
6	φ3.8 Pin	2
7	M10 Short Outer Hexagon Bolt	1
8	Beam Assembly	2
9	Left Wheel Holder	2
10	Right Wheel Holder	2
11	Reinforcement Plate	2
12	M8 Carriage Bolt	4
13	8 Flat Pad	4
14	M8 Lock Nut	4
15	Middle Support Tube	2
16	M10*60 Bolt	2
17	M10 Lock Nut	2
18	Connecting Block	2
19	M16 Shockproof Bolt	1

Part#	Description	Qty
20	φ16 Spring Washer	1
21	φ16 Flat Washer	1
22	Velcro	6

Required Tools (Not included)

Name	Imperial	Metric
Monkey Wrench	12"	300mm
Open Wrench	7/16"	11mm
Open Wrench	11/16"	17mm
Open Wrench	15/16"	24mm

STEP1

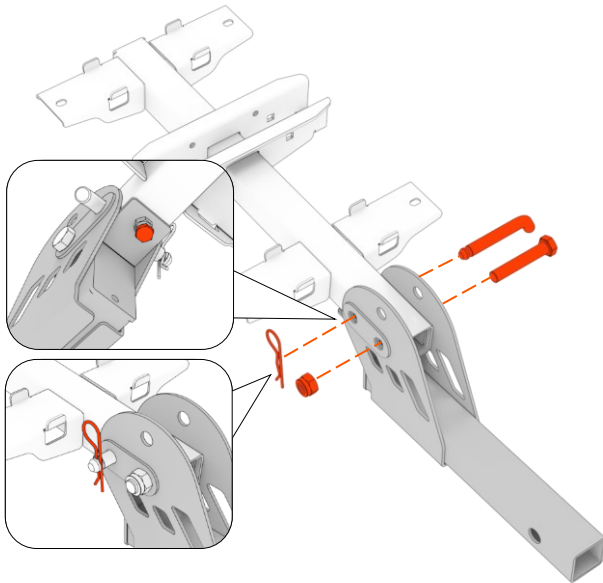

Align the **Bottom Fixing Bracket (2)** with the hole of the **Rotating Group (1)**, insert the **M16*85 Outer Hexagon Bolt (4)** into the hole at the bottom, and then screw on the **M16 Lock Nut (5)**. Insert the **φ16 Bent Pin (3)** and the **φ3.8 Pin (6)** at the same time, and use the **M10 Short Outer Hexagon Bolt (7)** to screw into the

bottom as shown in the figure to eliminate the gap between the **Bottom Fixing Bracket (2)** and the **Rotating Group (1)**.

Note: Do not overtighten the bolts to prevent the **Bottom Fixing Bracket (2)** and the **Rotating Group (1)** components from rotating easily.

STEP2

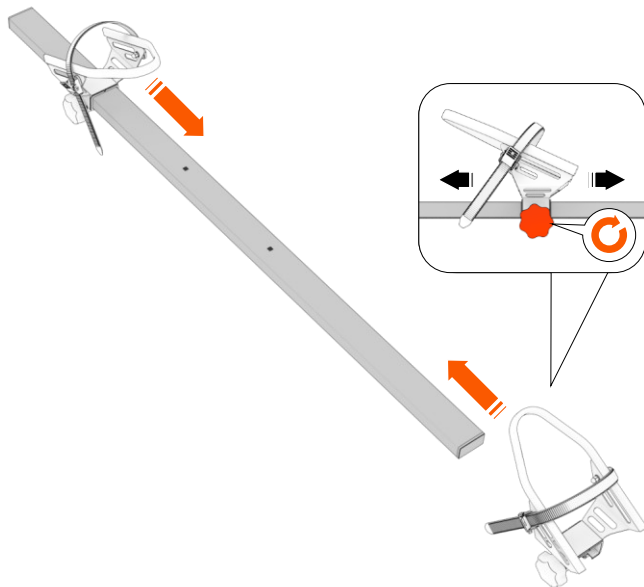

Insert the **Left and Right Wheel Holder (9, 10)** into the **Beam Assembly (8)** respectively, then center them appropriately to fit the distance between bike tire.

Note: Two hand wheels are on the same side.

STEP3

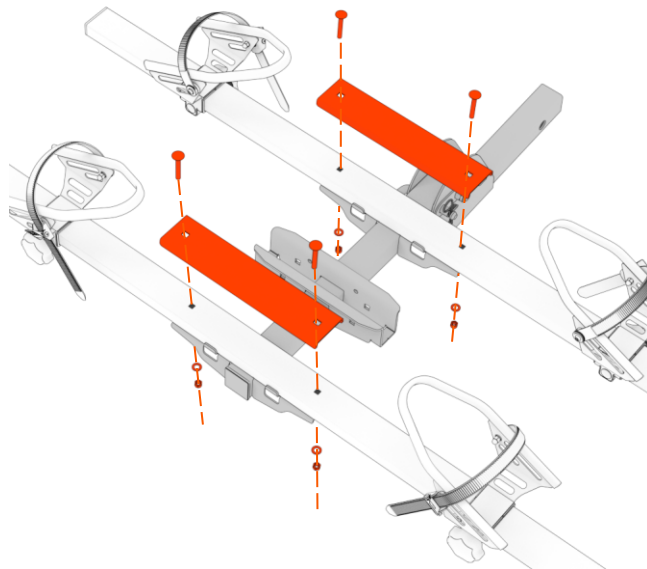

Insert the component in step 2 into the component in step 1, and fasten them with the **Reinforcement Plate (11)**, put the **8 Flat Plate (13)** under the plate, then align the holes, insert the **M8 Carriage Bolt (12)** and screw it into the **M8 Lock Nut (14)** tightly for fixing, as shown in the figure.

STEP4

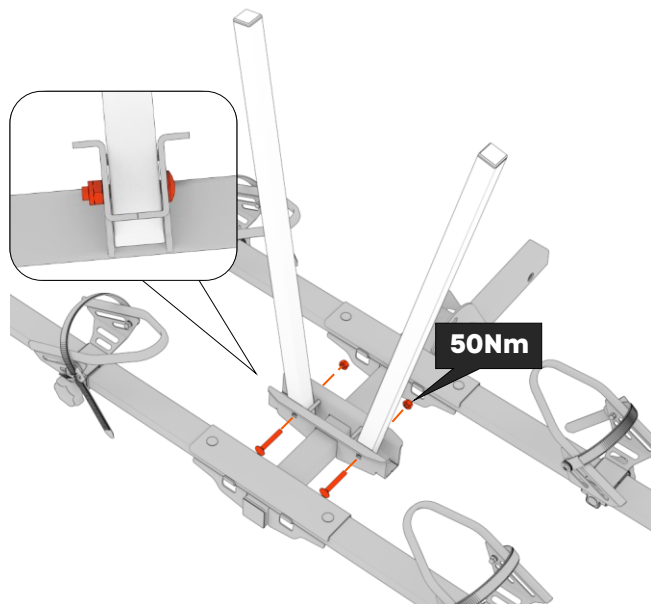

Insert the **Middle Support Tube (15)** into the base of the **Bottom Fixing Bracket (2)**, then fix them with the **M10*60 Bolt (16)** and the **M10 Lock Nut (17)**.

STEP5

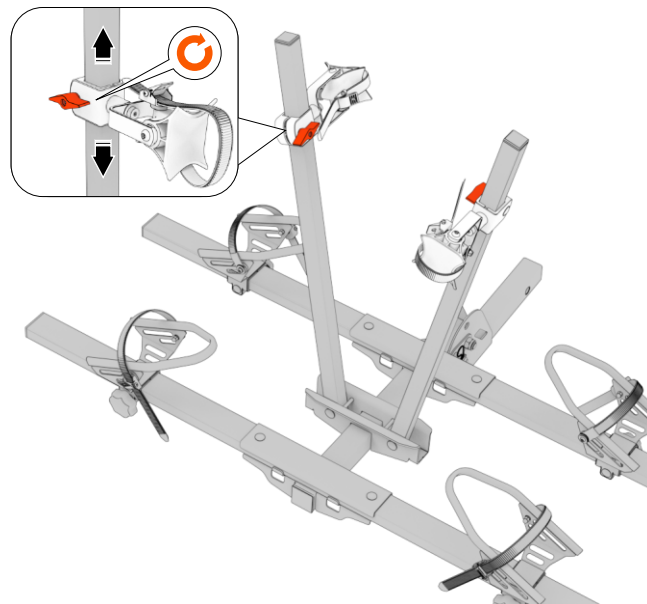

Install the adjustable **Connecting Block (18)** to the **Middle Support Tube (15)**, then tighten the knob from the **Connecting Block (18)**.

STEP6

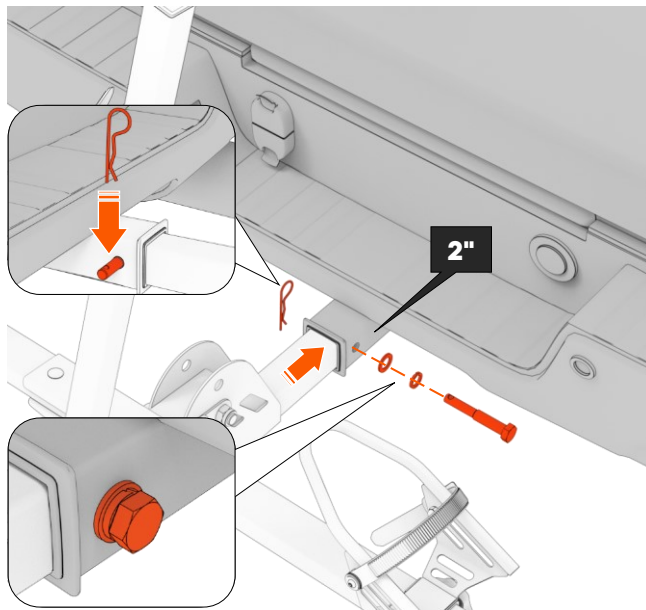

Align the holes of the folding tube with the holes on the vehicle's **2" hitch receiver**, then connect the two parts as shown below. Place an **M16 Shockproof Bolt (19)**, through the **φ16 Spring Washer (20)**, **φ16 Flat Washer (21)** and the align the holes. Screw the bolt in place by **Monkey Wrench (Not included)** and

secure it with the **φ3.8 pin (6)**, making sure to place the pin through the holes on the bolt.

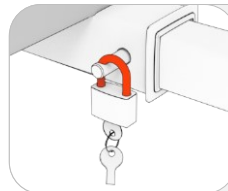

- ⚠ The diameter of lock beam should be less than **7mm**.
- ⚠ The lock is not included.

Folding Steps

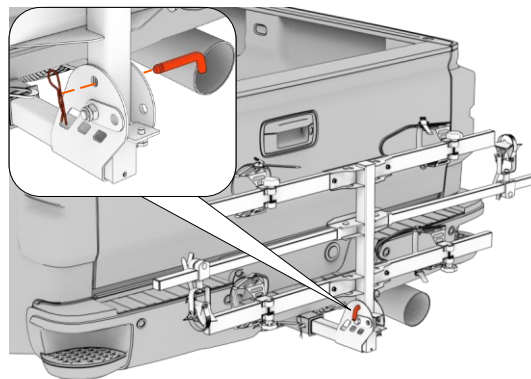
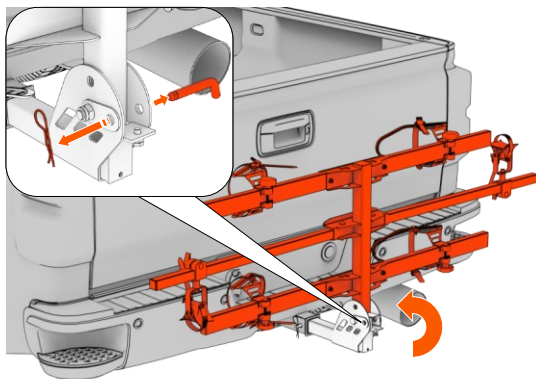
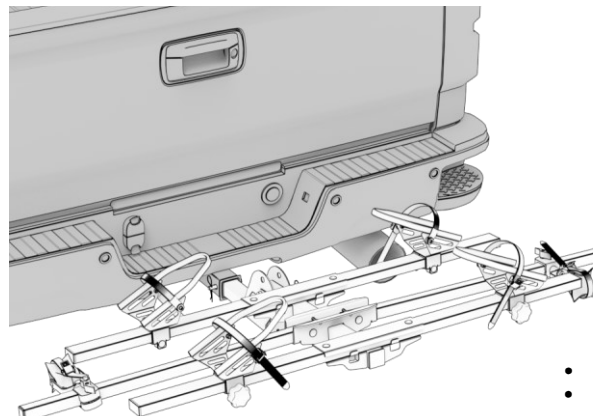
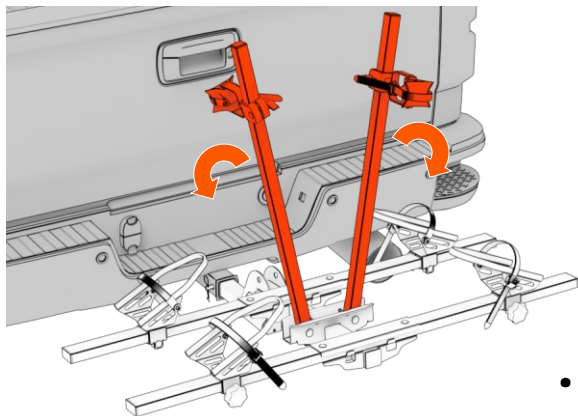

Bike Installation Instructions

- ❗ Snap the front tire of the ebike into the front wheel holder, place the rear tire in the beam, and then use the ratchet wheel straps to fix the front wheel, rear wheel, and seat tube of the bicycle as shown in the figure below.
- ❗ Please place one bike on the side which is close to the vehicle first, and install the **Connecting Block (18)** after the bike is fixed.
- ❗ It's generally recommended that using the ratchet wheel strap to fix the crossbar (if applicable) or the middle tube (or seat post). Considering that some electric bikes have thicker downtubes, please do not strap the downtube.

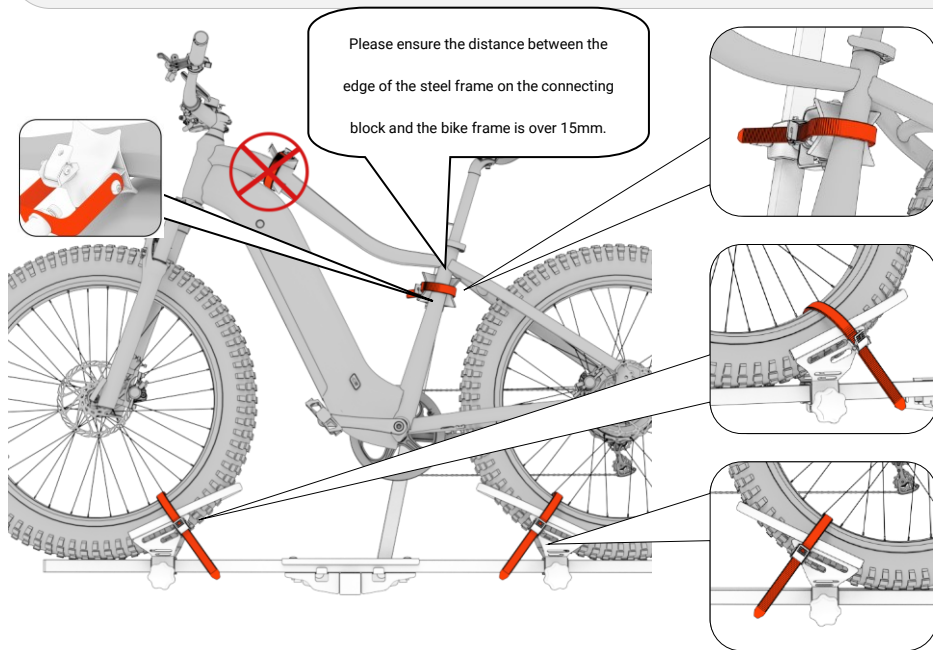

Note: Use the ratchet wheel strap to fix and tighten the seat tube, middle tube, or the position of the crossbar near the seat tube/middle tube of the bicycle.

Note: Use the ratchet wheel strap to fix and tighten the front wheel of the bicycle.

Note: Use the ratchet wheel strap to fix and tighten the rear wheel of the bicycle.

Bike Installation Instructions (tire width < 2.5")

❗ If your tire width is less than 2.5", please use velcros to fasten the front and rear tires.

❗ Only 4pcs of **Velcro(22)** are required to fix the tires, the rest are for spare. Please keep the fixing method of velcro the same for the bike on the other side.

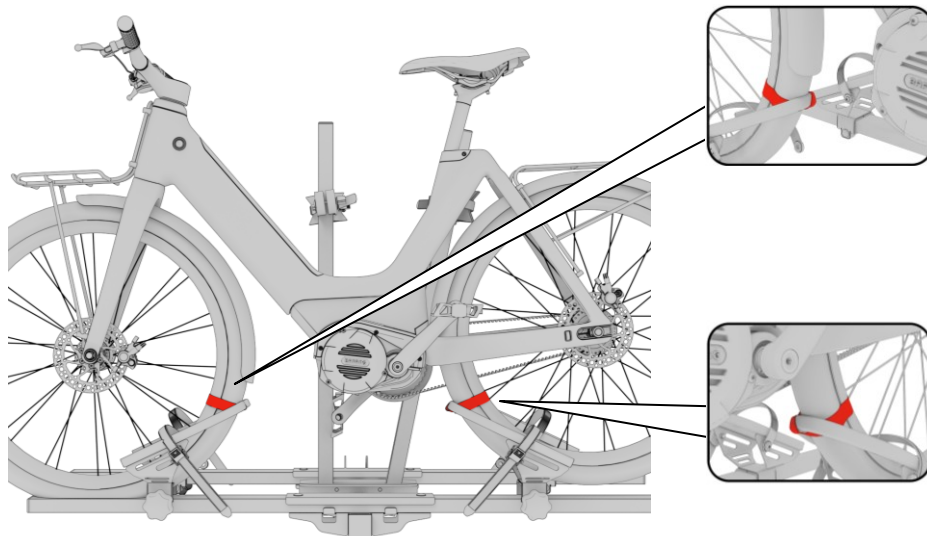

Note: The velcro fixes the front tire as illustrated

Note: The velcro fixes the rear tire as illustrated

Dimension

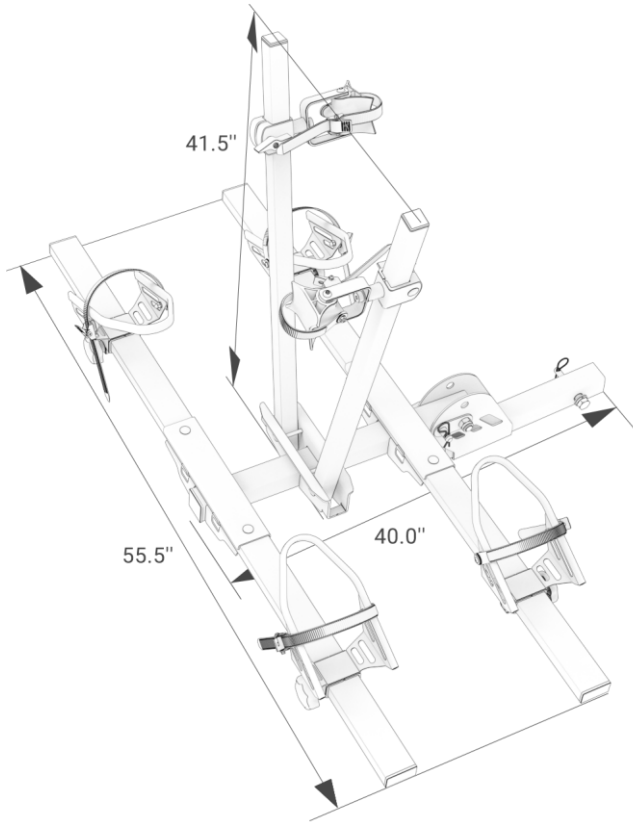

Technical Specifications

- Maximum Load: Bicycle under 200LBS
- Maximum bicycle wheelbase 50"
- Applicable Types of Hitched Bike: Electric Bike/Regular Bike
- Not intended for use with mopeds, motorcycles or 3 wheels bikes
- Applicable for tires width within 5", extra velcros (included) need to be applied for tires within 2.5"

Model Name	YOUNG ELECTRIC Fellow
Description	2" Hitch 2-Bike Rack
Material	Steel
Maximum Weight Capacity	200lbs
Applicable Vehicles	Vehicles with 2" receiver
Package Size	57.7x14.7x7.3in
Package Weight	64.6lbs

⚠️ WARNINGS ⚠️

- Do not overload beyond the bike rack's weight capacity of 200lbs.
- Do not carry more than 2 bikes on the carrier.
- The bike rack is not intended for transporting humans or animals.
- If you are planning to load only one bike, it is recommended to place it in the position closest to the vehicle.
- All bikes must be secured properly before operating the vehicle.
- Make sure the front of the bike(s), when mounted, are at or above the bottom of the bumper to avoid damage to the bike(s).
- Do not carry flammable items on the bike rack.
- If using the bike rack to transport electric bicycles, please remove the batteries from the bicycles prior to transporting them. This will help reduce the weight supported by the carrier.
- During long trips, frequently check the straps and bike position, especially if traveling on rough terrain.
- Please do not make alterations to the product, as it can pose potential hazards to your safety.
- Failure to heed these warnings may result in personal injury and/or property damage.
- To prevent serious injury or death, inspect the bike rack for any signs of wear, corrosion and fatigue before each use. Do not use the bicycle rack if parts are bent, broken, deformed or missing. If parts are bent, broken, damaged or missing, remove the rack from your vehicle before operating the vehicle.

Young Electric Warranty Policy

Young Electric is committed to providing our customers with a quality shopping experience, for the products we sell, we provide a 2-year warranty from the date of purchase, which includes non-artificial product defects. This warranty does not cover issues caused by normal wear and tear including (but not limited to) weather, scratches, dents, rust, accidents, unlawful vehicle operation, misuse, abuse, neglect, theft, unauthorized modifications, or unauthorized repair.

Please strictly follow the instructions on how to use it, no warranty and responsibility are provided for defects caused by improper fit, improper vehicle installation, installation on an "unsuitable" vehicle, incorrect installation of the bike on the rack, or overloading of the weight limit of the rack. This warranty terminates if the purchaser transfers the product to any other person.

If a product is believed to be defective, the purchaser should directly contact Young Electric Team at 888-933-8899 or through support@youngelectricbikes.com

Disclaimer of Liability: Repair or replacement of a defective product or the issuance of a refund or credit (as determined by Young Electric) is a purchaser's exclusive remedy under this warranty.

Young Electric shall not be liable for any direct, indirect, consequential, incidental, special, punitive or any other damages in connection with the purchase, use or handling of this product.

Some states do not allow the exclusion or limitation of consequential or incidental damages, and the above limitation may not apply to you. This Limited Warranty gives you specific legal rights, and you may have other rights that vary from state to state.

Get Support



<https://youngelectricbikes.com>
support@youngelectricbikes.com
Toll Free Number: 888-933-8899

YOUNG
Electric

VERSION: 23.09.26