



**Instruction Manual
&
Parts Catalog**

Swing Back Trailer Jack

Model 110196



Read and understand this entire manual before assembling, installing, operating, or servicing this product.

SAVE THIS MANUAL

Copyright© 2024 by AVITEC. All rights reserved. No portion of this manual or any artwork contained herein may be reproduced in any shape or form without the express written consent of AVITEC. Due to continuing improvements, actual product may differ slightly from the product described herein. Tools required for assembly and maintenance may not be included.

IMPORTANT SAFETY INFORMATION

This is a **SAFETY ALERT** symbol.



It is used to alert you to potential personal injury hazards. Obey all safety messages that follow this symbol to avoid possible injury or death.



DANGER indicates a hazardous situation which, if not avoided, will result in death or injury.



WARNING indicates a hazardous situation which, if not avoided, could result in death or serious injury.



CAUTION indicates a hazardous situation which, if not avoided, could result in minor or moderate injury.



NOTICE indicates important information which, if not followed, may cause damage to equipment.

SAVE THIS MANUAL

Keep this manual for the safety warnings and precautions. The manual offers important information on how to assemble, use and maintain this product.

Write the product's model number and purchase date on the cover page of this manual.

Keep this manual (and your purchase receipt) in a safe place.

UNPACKING

The shipment should be thoroughly inspected as soon as it is received. The signed "bill of lading" is acknowledgement by the carrier of receipt in good condition or shipment covered by our invoice. For your own protection, if any of the goods called for on the bill of lading are shorted or damaged, do not accept them until the carrier makes a notation on the freight bill of the shorted or damaged goods.

Notify AVITEC immediately if any hidden loss or damage is discovered after receipt.

Definition of Symbols



WARNING concerning Risk of Eye Injury. Wear ANSI approved eye protection.



WARNING concerning Risk of Hearing Loss. Wear hearing protection.



IMPORTANT SAFETY INSTRUCTIONS



1. **Read and understand all safety warnings and instructions.** Failure to follow the warnings and instructions may result in serious injury or death. Save all warnings and instructions for future reference.

2. **Personal and Work Area Safety**



A. **Always wear ANSI approved safety goggles.**



B. **Always wear hearing protection when working in noisy environments.** Prolonged exposure to high intensity noise can cause hearing loss.



C. **Use safety equipment.** Safety shoes, hard hat and work gloves must be used for applicable conditions.

D. **Dress appropriately.** Never wear loose fitting clothing or jewelry when working. Contain long hair, and keep hair, clothing and gloves away from moving parts.

E. **Use common sense when working.** Stay alert and concentrate when assembling and using the Trailer Jack. Never work while under the influence of alcohol, drugs or medications.

Personal and Work Area Safety (continued)

F. While assembling and using the Trailer Jack keep work area clean and well lighted. Keep spectators and children out of the work area.

3. Use of the Trailer Jack

A. Trailer tongue weight (TW) is the downward pressure that the trailer coupler places on the hitch ball. Usually, TW is about 10% of the Gross Trailer Weight (GTW); GTW is the weight of the trailer when fully loaded.

Only use a Trailer Jack that has a capacity that matches or exceeds the trailer tongue weight (TW).



Do not exceed this Trailer Jack's 1500 Lbs. maximum capacity.

B. When assembling and setting-up the Trailer Jack, the trailer must be on a flat, solid surface.

C. Use this Trailer Jack in accordance with Department of Transportation (DOT) rules and regulations. More information can be found at www.dot.gov/regulations.html.

D. The Trailer Jack is designed to be mounted to the trailer's tongue and is used when hitching and unhitching the trailer's hitch ball from the vehicle. The two wheel design allows for short distance positioning of the trailer. Use of the Trailer Jack for operations other than those intended could result in serious personal injury and property damage. The Trailer Jack is not for aircraft applications.

E. Frequently check and maintain the Trailer Jack. Check for loose hardware, misalignment or binding of moving parts and damage to components. If the Trailer Jack needs

servicing, it should only be performed by a qualified service technician.

F. Chock trailer wheels when setting up this product and when using the Trailer Jack to raise or lower the trailer tongue.

G. Keep clear of the underside of trailer, and a safe distance from the Trailer Jack when raising or lowering the load and when re-positioning the trailer.

H. Trailer Jack must be locked in vertical position before the load is applied. Before moving the trailer, the Trailer Jack must be secured properly in its horizontal position.

I. The trailer must be on a solid, level surface when the Trailer Dolly is used for short distance re-positioning. Take safety precautions to prevent unsafe movement of the trailer when it is being re-positioned. People and animals are not to be in the trailer while it is being re-positioned.

J. Always wear ANSI approved safety glasses when assembling and using the Trailer Jack. Keep spectators and children away when using the Trailer Jack.

K. Be aware of the danger of "dynamic loading". This situation arises when a load is dropped onto the Trailer Jack, resulting in a short term excessive load. Dynamic loading can result in damage and failure of the Trailer Jack and/or trailer tongue, and personal injury to the person using the Trailer Jack.

L. If Trailer Jack is used on a boat trailer, never disconnect the trailer from vehicle and use the Trailer Jack to maneuver the boat down a boat ramp.

Keep in mind that the warnings previously discussed cannot cover all possible events and circumstances. It is important that the person using this product

use common sense at all times.

AVITEC is not responsible for the attachment or the installation of this product. The attachment of this product is critical and beyond the control of Maxxhaul. It neither guarantees, nor will it be liable for any damage resulting from its attachment or improper use.

Assembling the Trailer Jack

1. Assemble Wheels (5): Slide Bushing (17) into axle opening of each Wheel. Place each Wheel into fork of Inside Frame (2). Secure Wheels in place by using Axle Bolt, Washer and Nut (16).
2. Attach Handle (3) to the Handle crank using the included locknut.

Mounting the Trailer Jack

1. Plan carefully where the Trailer Jack is to be mounted. It is designed to mount to the side of the trailer tongue (see photo below). The beam of the tongue must be rectangular or square. This Trailer Jack will fit up to 3" wide x 4" high trailer tongues. Trailer Jack's Rotating Plate (6) has various mounting configurations and can be mounted either vertically, or horizontally against the trailer tongue.



2. Do not attempt to modify the trailer tongue; making changes or drilling holes in the trailer tongue could result in failure of this component.
3. Never mount the Trailer Jack on a cylindrical trailer tongue. The Rotating Plate and Back Plates (4) will only mount properly on a rectangular or square tongue beam.

4. When planning the location of the Trailer Jack, take into account that the Trailer Jack will swing upward to a horizontal position; allow room for this. Make sure that the Trailer Jack will not interfere with the trailer or vehicle when turns are made, or when the trailer travels over speed bumps or up and down boat ramps.

5. The best way to install the Trailer Jack is when the trailer is attached to the tow vehicle and both are located on a flat, level solid surface.

6. The Trailer Jack is heavy. You will need assistance to properly mount this product to the trailer tongue. If you are not accustomed to doing this type of work, the Trailer Jack should be set-up by a qualified service technician.

7. See mounting hardware below

Rotating Plate (6) and two Back Plates (4) surround the beam of trailer tongue.

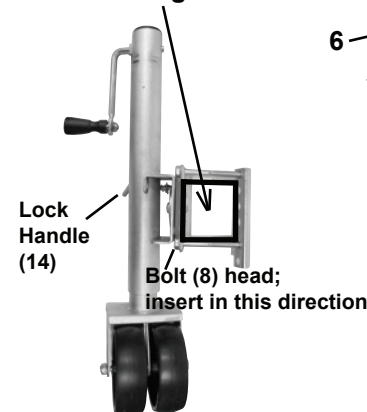

Note: Pull up on the Lock Handle (14) to disengage the Rotating Plate (6) so it can be moved to vertical, or horizontal position.

8. Attach the Trailer Jack to the trailer tongue by securing Rotating Plate to the two Back Plates; use Mounting Hardware Set (8). With the Trailer Jack in place, fine tune its position by using a mallet to tap it into the

ideal position. Now firmly tighten all hardware.

9. Now test the Trailer Jack. Crank the Handle (3) to raise (clockwise) and lower (counterclockwise) the Trailer Jack. Make sure both Wheels (5) can be lowered to the ground.

Pull the Lock Handle (14) to disengage the Rotating Plate (6) so that the Trailer Jack can be moved to the up (horizontal position).

Engage the Lock Handle with the Trailer Jack in both the vertical and horizontal positions, to make sure the Trailer Jack locks in place.

Make any needed adjustments and go back and check again that all hardware is securely tightened.

Using the Trailer Jack

To mount trailer to tow vehicle:

1. Rotate the Handle clockwise to raise the trailer tongue to a level slightly above the trailer's hitch. Move trailer so that the trailer's hitch is directly over the tow vehicle's hitch ball.
2. Turn the Handle counterclock to lower the tongue hitch onto the vehicle's hitch ball. Secure the trailer with the hitch retainer.
3. Keep turning the Handle counterclockwise to fully retract the Trailer Jack.
4. Pull the Lock Handle and swing the Trailer Jack to the up, horizontal position. Align holes in Rotating Plate (6) and push Lock Handle back in place to secure Trailer Jack in this up position before moving the trailer. Always attach safety chains.

To dismount trailer from tow vehicle:

1. Chock wheels of trailer.
2. Pull on Lock Handle (14) and swing the Trailer Jack down to the vertical position. Align holes in Rotating Plate (6) and push Lock Handle back in place to secure Trailer Jack in this position.
3. Turn the Handle (3) clockwise to raise the Trailer Jack so that Wheels (5) touch the ground. Then raise the Trailer Jack slightly so that the weight of trailer tongue is supported by the Trailer Jack; this will make it easier to disconnect the tongue hitch.
4. Disconnect safety chains and any electrical wiring connecting the trailer to the tow vehicle. Chock the wheels of the Trailer Jack.
5. If needed, raise the Trailer Jack slightly so the trailer tongue hitch completely clears the hitch ball, and disconnect the trailer.
6. Carefully drive the vehicle away from the trailer.

Caring for the Trailer Jack:

Frequently check to make sure all hardware is tight. Inspect the Trailer Jack periodically for cracked or broken components. Do not continue to use the Trailer Jack if damage is noted. Grease all moving components.

SPECIFICATIONS

Maximum Capacity	1500 Lbs.
Lift Range	11-1/2"
Wheels	Dual, 6" Diameter

Parts List

Part #	Description	Qty	Part #	Description	Qty
1	Tube	1	14	Lock Handle	1
2	Inside Frame	1	15	Spring	2
3	Handle	1	16	Hardware (Axle Bolt, Nut, Washer)	1 set
4	Back Plate	2	17	Bushing	2
5	Wheel	2	18	Threaded Rod	1
6	Rotating Plate	1	19	Washer	1
7	Top Plate	1	20	Bearing (d32*D13*T11 mm)	1
8	Hardware (Bolt, Nut, Spring Washer, Washer)	4 sets	21	Washer	1
9	Pin	1	22	Gear B	1
10	Lock Nut, M10	4	23	Gear A	1
11	Plate A	1	24	Bushing	1
12	Front Plate	1			
13	Screw	4			

Assembly Diagram

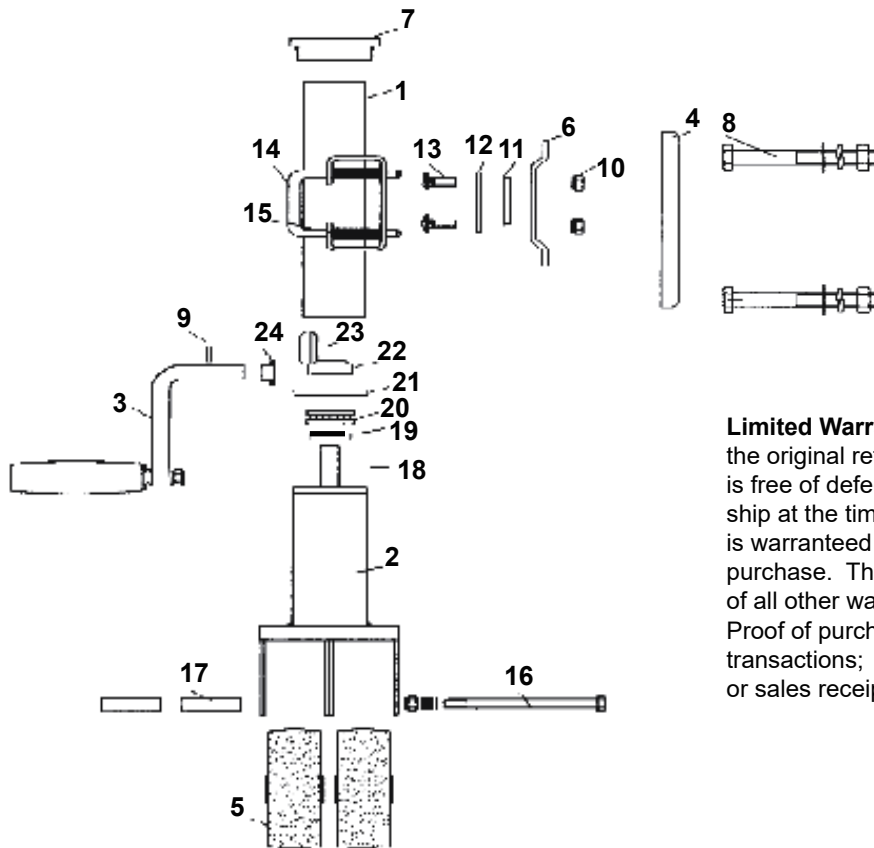

Limited Warranty. AVITEC warrants to the original retail purchaser that the product is free of defects in material and workmanship at the time of shipment. This product is warranted for 90 days from the date of purchase. This warranty is expressly in lieu of all other warranties, express or implied. Proof of purchase is required for warranty transactions; a copy of the original invoice or sales receipt is required.

Note: The Parts List and Assembly Diagram is provided as a reference tool only. Some parts are listed and shown for illustration purposes only, and are not available as replacement parts. All repairs to this tool (including replacing parts) should only be done by a qualified service technician.