



**OWNER'S MANUAL**

**4" HANDHELD FAN**

---



---

MODEL 1VAFHAND

# DIAGRAM

PLEASE SAVE THESE INSTRUCTIONS

**⚠ WARNING** READ THIS OWNER'S MANUAL CAREFULLY BEFORE USE.

## PRODUCT DIAGRAM

---

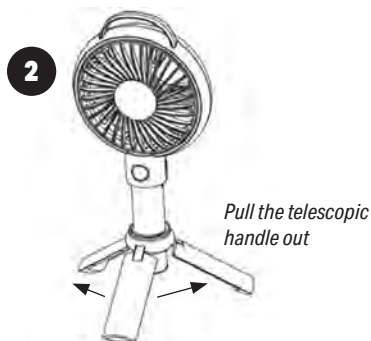
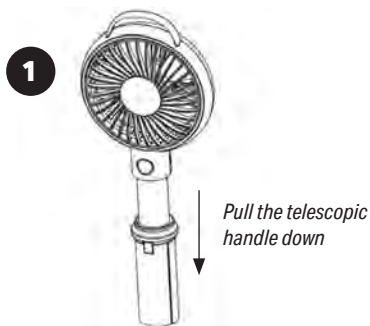
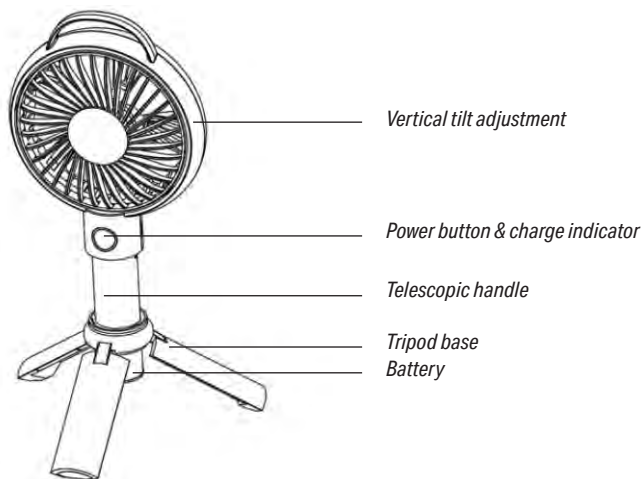

### OPEN THE TRIPOD BASE

1. Pull the Telescopic handle downwards. (Picture 1)
2. Pull the Telescopic handle out to make it stand on a flat surface. (Picture 2)
3. Place the fan on a flat surface to operate.

# FAN OPERATION

## CHARGING STATUS

1. Connect the fan with power through USB cable
2. A RED LED light represents charging status
3. When the LED light turns BLUE, it is fully charged
4. When the fan is in use status, the LED light will turn WHITE color.

## OPERATING THE FAN

1. Push power button once, and the fan starts operating at its highest speed
2. Push power button a second time, and the fan operates at its medium speed
3. Push power button a third time, and the fan operates at its lowest speed
4. Push power button a fourth time, and the fan will turn off.
5. Vertical tilt can be manually adjusted.

## WORKING HOURS - when fully charged

- At the lowest fan speed, the fan works for about **5 hours**
- At the middle fan speed, the fan works for about **3 hours**
- At the highest fan speed, the fan works for about **2 hours**

## WARNING

- Don't disassemble the product by yourself
- Don't put the product in wet place
- Don't put the product near hot place
- Don't put the product near any liquid
- Children should be supervised by adults when using

## SPECIAL ATTENTION:

1. When operating, the fan blade revolves at a high speed. Please don't put a finger or other objects in the fan blades.
2. Please don't use the fan in humid and wet weather or wet environment, as it could cause the product damage or to malfunction.
3. Please charge the fan with standard DC 5V voltage. Remove the USB cable when charging is completed.
4. Don't place the fan on flammables when charging.
5. If the fan gets too hot or out of shape, or if the battery is leaking while charging, please stop charging immediately.
6. Please keep the product at 32°F-104°F degrees Fahrenheit.
7. Please don't place the product in a fire, otherwise the battery will explode.
8. Please don't hit or smash the product. Repeated hitting may damage the product.
9. Please don't dismantle, change or repair the product by yourself.
10. Please don't replace battery by yourself, and replace followed by professional guidance.

# WHAT'S IN THE BOX

---

- Fan (1)
- USB Cable (1)
- User Manual (1)

# PRODUCT SPECIFICATIONS:

---

**Input:** DC 5 Volts – 1 Amp

**Speed Level:** 3 Speeds – High / Medium / Low

**Battery capacity:** 2000 mAh

For your records, staple your sales receipt to this manual and record the following:

**Date of Purchase:** \_\_\_\_\_

**Place of Purchase:** \_\_\_\_\_

**NOTE:** Proof of purchase is required for all warranty claims.

**NOTE:** As a result of continual improvements, the design and specifications of the product within may differ slightly to the unit illustrated on the packaging.



4560 W. 160th Street  
Cleveland, OH 44135

833-950-1185 | [support@visionairproducts.com](mailto:support@visionairproducts.com)  
[www.visionairproducts.com](http://www.visionairproducts.com)