

## REPLACEMENT PARTS

<http://www.caravancanopy.com/replacement-parts>  
(877)-922-6679



- |    |              |                                      |
|----|--------------|--------------------------------------|
| 1  | #30008501000 | Dome Cap                             |
| 2  | #33608536000 | Upper Rising Truss Bar Set           |
| 3  | #33608539000 | Lower Rising Truss Bar Set           |
| 4  | #30008511000 | Outer Leg                            |
| 5  | #30008503000 | Inner Leg                            |
| 6  | #33608536001 | Cathedral Upper Bar                  |
| 7  | #33608536000 | Cathedral Lower Bar                  |
| 8  | #33608530000 | Cathedral Support Bar Bracket        |
| 9A | #30008505000 | Joint Bolt & Nut                     |
| 9B | #30008506000 | Joint Bolt Washer & Cap              |
| 10 | #30008507000 | Outer joint bolt, washer nut and cap |
| 11 | #30008508000 | Peak joint bolt, washer nut and cap  |
| 12 | #30008509002 | Corner Bracket (2-way)               |
| 13 | #30008509000 | Slider Bracket (3-way)               |
| 14 | #33608536002 | Cathedral Support Bar                |
| 15 | #30008509001 | Slider Bracket (2-way)               |
| 16 | #33608517001 | Truss Bar Set                        |
|    | #33608508020 | Skybox Blue Top                      |
|    | #33608514010 | Skybox Blue half wall                |
|    | #33608519000 | Skybox Carry bag                     |

rev.01/01/2021

## WARRANTY

Caravan® Global warrants that each part of this product will be free from defects in material and workmanship for two (2) year period from date of purchase.

Note: Custom graphic tops have a six (6) month manufacture defect warranty.



This warranty is void :

- If product is used under other than normal use and maintenance conditions.
- If the product is modified or altered.
- If product is subject to abuse or neglect.
- If product damage is accidental or deliberate or caused by rain, wind or other forces of nature.
- If product use does not conform to product instructions.
- If product is repaired by someone other than Caravan® Global or its authorized representative.

The sole obligation of Caravan® Global under this warranty or any other legal obligation, with respect to the product, is replacement, by Caravan® Global or its authorized representative, of the missing or defective parts causing malfunction with new parts after review and examination by Caravan® Global.

Under no circumstances will the retail customer, user, authorized representative or other person be entitled to any direct, special, indirect, consequential or exemplary damages for breach of contract or otherwise. Under no circumstances will any person be entitled to a sum greater than purchase price of the malfunctioning part.

No Caravan® Global authorized representative or person other than an officer of Caravan® Global may extend or modify this warranty. There are no other warranties from either Caravan® Global or its representatives which extend the face of this warranty. All other warranties, expressed or implied, including the warranties of merchantability, fitness for a particular purpose and fitness for use are excluded.

Please contact Caravan® Global for specific shipping instructions before returning any part. All shipping costs must be pre-paid. Caravan® Global will not be responsible for any products damaged in transit.

## CLEANING AND STORING THE CANOPY

Wash using only warm water and mild soap. Don't use detergent, as this can be abrasive and otherwise damage the canopy cover material. Don't use bleach or harsh chemicals.

To speed up drying time and prevent tear and fraying, leave the canopy and frame open after cleaning.

Make sure the canopy is completely dry before breaking the canopy down for storage. This will prevent mildew from forming and growing within the canopy cover's folds and creases.

Over time, small leaks and tears across the canopy may become inevitable. But this doesn't have to make the canopy unusable! Spray the leak or tear with a seam sealer, available at most hardware and sporting goods stores. Seal the hole or tear as soon as possible to keep it from spreading. Be sure to follow the sealer's instructions exactly. If the leak or rend is too big, use a patch kit available from Caravan® Canopy Int'l.

This product is covered under one or more patents.  
Patents: <http://www.caravanglobal.com/patents/>  
Additional US and foreign patents may be pending.

Made in China | 2021 / Ver.1

# SKYBOX

## REFERENCE MANUAL



**IMPORTANT:**  
Carefully read and follow the instructions provided with this product.

**WARNING:**  
Keep all flame and heat sources away from this canopy top and sidewall fabric. This canopy top and sidewall is made with flame resistant fabric which meets CPAI-84 specification. It is NOT FIRE PROOF. The fabric will burn if left in continuous contact with any flame source. The application of any foreign substance to this fabric may render the flame resistant properties ineffective.

**WARNING:**  
Do not set-up or leave the canopy unattended in the following conditions: gusty wind, rain, hail, sleet, snow, drizzle, or any other harsh weather conditions. Doing so may cause damage to the entire canopy and will void the warranty. Please call Caravan® Global for any questions or inquiries.



Copyright © Caravan® Global.  
All Rights Reserved.  
14600 Alondra Blvd, La Mirada, CA 90638  
TEL: 877-922-6679 FAX: 714-367-3050  
[www.caravancanopy.com](http://www.caravancanopy.com)

## THANK YOU

Our mission is to design and manufacture the finest canopies in the world. From raw materials to finished products, our focus is to deliver years of enjoyment to every owner of a SkyBox. Your new SkyBox requires very little care or maintenance. Following these simple guidelines will insure a lifetime of satisfaction.

**WARNING: NOT COMPLYING WITH THESE WARNINGS WILL VOID YOUR SKYBOX WARRANTY!**

- **DO NOT** set-up or leave your SkyBox assembled in the rain, hail, sleet, snow, drizzle, lightning, wind, or any harsh weather conditions.
- **DO NOT** allow water of any kind to accumulate on the canopy top.
- ALWAYS use stakes and weight bags to secure your SkyBox.
- Never set-up your SkyBox over barbecue or near open flame. Although the canopy top is fire retardant, serious injury or damage to canopy can still occur.
- Always follow directions when setting-up your SkyBox. Be aware of hands and fingers when expanding or collapsing frame.
- It is recommended to remove canopy top from frame after take-down. Storing top on frame may result in fabric tears or other damage requiring repair or re-purchase.
- Never clean the canopy top in a washing machine - serious damage will result. If cleaning is required, set-up the SkyBox and use light detergent on a cloth and gently clean top by hand, then rinse off with a wet cloth.
- **DO NOT** use detergent or hand cleaner if top has custom silk-screened graphics.
- Allow top to dry completely before storing.
- Keep your canopy off of steep slopes and inclines
- **DO NOT** use your SkyBox as a permanent shelter. It is designed for temporary use only!
- **DO NOT** use in any windy condition.
- **NEVER** leave your SkyBox unattended.

## ABOUT CARAVAN® GLOBAL

Our story began in 1999. Caravan® Canopy started manufacturing instant canopies and custom graphic products based on three values:

### DURABILITY, PORTABILITY, & EASE OF USE

Today, Caravan® Canopy continues to actively reinforce these values in every product we design, engineer, and manufacture. Through durable, portable, and easy to use products, our ultimate goal is to enhance the lives of our customers by providing comfort, quality and convenience.

When you purchase a Caravan® product, you are guaranteed the highest quality product manufactured by a motivated and knowledgeable organization dedicated to being the best. In addition to outdoor leisure products, Caravan® also maintains a full-service custom graphics department that offers a wide variety of custom shelters and promotional tools, creating an ideal advertising tool.

Caravan® Canopy continues to be a leading manufacturer of outdoor and customized merchandise that provides consumers with the products they desire through functional and innovative designs. Our commitment to service and timely delivery makes us the preferred manufacturer for outdoor products.

## 10% OFF COUPON

GET 10% OFF ON YOUR NEXT PURCHASE  
ON CARAVANCANOPY.COM  
USE COUPON: SKYBOX10

\*Disclaimer: Online only. Management reserve all rights. Coupon does not apply to items on sale.

## SET UP

(1) Place the SkyBox frame in the center of the desired location. Stand on the opposite side of your partner and lift frame off of the ground while walking backwards away from your partner.

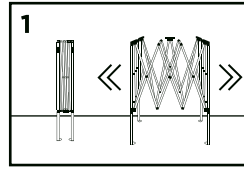

(2) Place the canopy top over the partially opened frame. Align the corners of the top to the frame and attach it to the legs of the frame

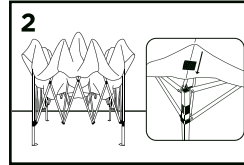

(3) Open frame completely.

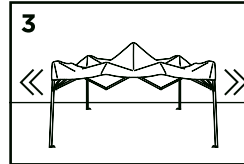

(4) Engage the slider at each corner by placing one hand on the truss and one hand on the leg and pushing up until the slider "clicks" in place.

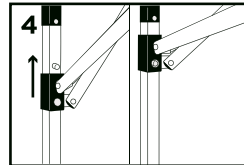

(5) Extend inner leg to raise canopy to the desired height.

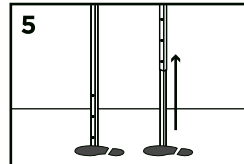

(6) Attach wall using zipper. Attach the Velcro loops located on the walls to the legs.

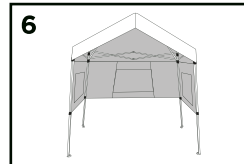

(7) To roll up windows, start from the bottom and slowly roll upwards. Secure with hook and loops.



## TAKE DOWN

(1) Remove wall using zipper.



(2) Raise a leg off the ground and depress snap button. Repeat until all legs have been lowered.

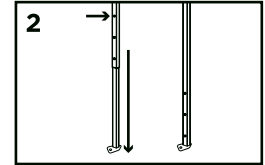

(3) Depress snap button on the slider at the corner bracket to disengage the frame and allow it to close.

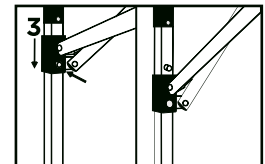

(4) Stand opposite a partner and grasp the lower truss bar. Lift the frame off the ground and slowly walk toward partner being careful not to pinch fingers.

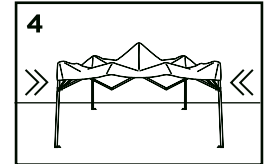

(5) Remove canopy top and completely close frame. SkyBox recommends storing canopies without the tops to avoid mildew and pinch tears.

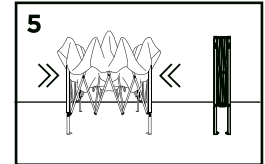

(6) Store frame and top in the bag.

