

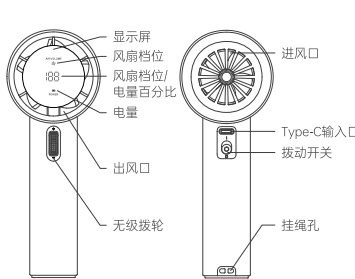

手持风扇 Handheld Fan Pro1 说明书

使用前请仔细阅读本说明书，严格按照说明书要求正确使用，并妥善保存说明书以备后用。

外观说明



使用前注意事项

- 1. 请检查产品、电源线是否有损伤... 2. 给产品充电前请检查所用电源电压是否和产品标签一致... 3. 请勿私自分解、改造、修理...

使用方法

A. 拨动开关使用及开关机/风速切换

- 拨动开关: 上拨接通电源, 下拨断开电源。无级拨轮: 短按: 开/关机循环切换... 快速双击: 显示当前电量百分比... 拨动: 调节风速...

B. 显示屏状态说明

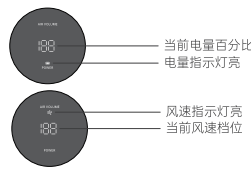

Table with 2 columns: Operation/Status and Content of Digital Screen Display. Rows include Power On, Adjust Wind Speed, Power Off, Power Display, Low Battery, and Full Charge.

C. 产品清洁

- 1. 对产品进行清洁前, 请确保电源已被切断。2. 产品面罩无法拆除, 清洁时可用干净的抹布擦拭扇罩表面及进风口栅格。3. 禁止用水或其他液体清洗电器部分...

取出电池

- 在废弃产品前, 必须将电池从产品中取出。取出电池前, 产品必须关闭电源。1. 用工具撬开后壳装饰件及后壳, 拧出内部螺丝... 2. 撬开后壳装饰件及底部螺丝盖, 拧出内部螺丝... 3. 用镊子拔出拨动开关与无级拨轮小板插线端子... 4. 取出拨动开关小板, 拔出电池插线端子...

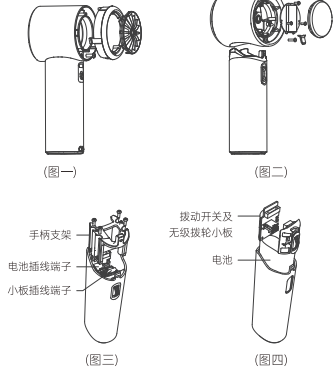

安全注意事项

- 为了保证使用安全, 避免对您和他人造成伤害和财产损失, 请遵守以下安全注意事项: 1. 本产品使用锂离子电池, 无记忆功能... 2. 本产品不预期提供生理、感知、心智能力、经验或知识不足之使用者... 3. 请勿挤压、拆解电池或将电池长期置于高温环境... 4. 使用时, 请勿放入手指、尖锐物及金属物等...

产品中有害物质的名称及含量

Table listing hazardous substances (Lead, Mercury, Cadmium, etc.) and their content levels in various components.

本表格依据SJ/T11364的规定编制。表示该有害物质在该部件所有均质材料中的含量均在GB/T 26572规定的限量要求以下。

全球USB小风扇专家与领导者* The World's No.1 Portable Fan Brand*

*注册: 按2021年全球销售额统计... *Explanatory note: in terms of global sales revenue in 2021. *Data source: Euromonitor International Shanghai Co. Ltd., measured in terms of global sales revenue of portable fans in 2021 of the brands that authorize others to use their trademarks...

Appearance Description

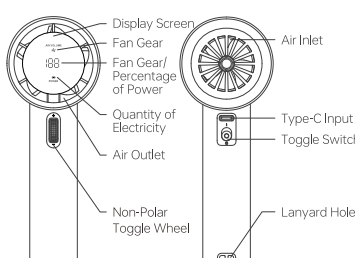

Precautions Before Use

- 1. Please check the product and power cord for any damage and make sure they are in good condition... 2. Before charging the product, please check whether the voltage of the power supply used is consistent with the product label. 3. Please do not disassemble, modify or repair the product to

avoid electric shock and fire accidents, and ask the service station designated by the original seller or manufacturer for repair.

How to Use

A. Toggle switch use and switch on/off/wind speed switching

- Toggle Switch: The upper dial turns on the power, the lower dial turns off the power. Non-polar Toggle Wheel: Short press: on/off cycle switching... Quick double-click: display the current power percentage... Toggle: adjust the wind speed, from 1 to 100 gears.

Upper Dial

- 1. Before turning on the fan, toggle the switch up to make the fan in the power-on state. 2. When put away, you must turn the toggle switch down to turn off the power... 3. Please do not disassemble, modify or repair the product to

B. Status Description of the Display Screen

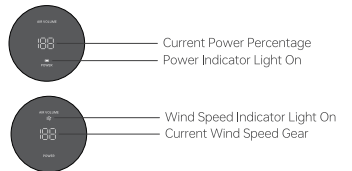
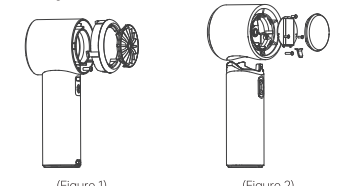

Table with 2 columns: Operation/Status and Content of Digital Screen Display. Rows include Power On, Adjust Wind Speed, Power Off, Power Display, Low Battery, and Full Charge.

Take Out the Battery

Before disposing of the product, the battery must be removed from the product. Before removing the battery, the product must be powered off. The battery should be disposed of safely according to the regulations of the place of sale.

- 1. Pry open the back case trim and back case with a tool and unscrew the internal screws... 2. Pry open the front case trim and the bottom screw cover, unscrew the internal screws... 3. Use tweezers to pull out the toggle switch and induction paddle wheel small board plug wire terminals... 4. Remove the toggle switch small board, pull out the battery plug wire terminal...



Safety Precautions

- To ensure the safety of use and to avoid injury and property damage to you and others, please observe the following safety precautions: 1. This product is not a child's toy... 2. This product is not intended for use by users (including children) with inadequate physiology... 3. Please do not blow directly on the human body for a long

- time, especially the elderly and children, to avoid physical discomfort. 04. When using, please do not put fingers, sharp objects and metal objects, etc., which will cause product failure... 05. When using, prohibit the use of wet hands, wet towels and other plugging power to avoid electric shock... 06. This product is not waterproof... 07. Do not cover the air outlet and air inlet... 08. Prohibit the use and storage in high temperature... 09. Do not squeeze, disassemble the battery... 10. If consumers use the power adapter to charge, the power adapter input rated voltage and current should be within 5V=2.5A...

Product Parameters

Brand: Jisulife Product Model: Handheld Fan Pro1 Product Name: Handheld Fan Pro1 Rated Voltage: Current: 5.0V=2.5A Battery Capacity: 3600mAh Product Weight: about 215g Charging Time: 2-3h Operating Time: 2-12h... Product Size: 59(L)x61(W)x157(H)mm

Packing Accessories

- Handheld Fan Pro1 *1 USB-A to USB-C Cable *1 Rope *1 Manual *1

The contents in this user manual and the technical specification of the product will be changed without prior notice.