

手持风扇 Handheld Fan Pro1 S

— 说明书 —

使用前请仔细阅读本说明书，严格按照说明书要求正确使用，并妥善保存说明书以备后用。

外观说明

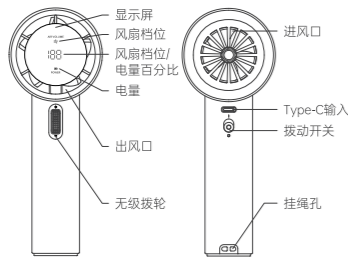

使用前注意事项

- 1. 请检查产品、电源线是否有损伤，确认完好并按说明书的组...
2. 给产品充电前请检查所使用电源电压是否和产品标签一致。
3. 请勿私自分解、改造、修理以免造成触电、着火等事故...

使用方法

A. 拨动开关使用及开关机/风速切换

- 拨动开关 上拨接通电源，下拨断开电源。
无级拨轮 短按：开/关机循环切换（开机默认开启最低风速）；
快速双击：显示当前电量百分比(5s后熄灭或跳转其他状态)；
拨动：调节风速，由1-100档之间调整。上拨加大风速，下拨减小风速。

B. 显示屏状态说明

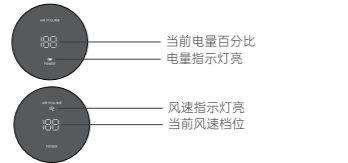

Table with 2 columns: Operation/Status and Content of Digital Screen Display. Rows include Power On, Adjust Wind Speed, Power Display, Power Off, Low Battery Reminder, and Fully Charged.

C. 产品清洁

- 1. 对产品进行清洁前，请确保电源已被切断。
2. 产品面罩无法拆除，清洁时可用干净的抹布擦拭扇罩表面及进风口栅格。
3. 禁止用水或其他液体清洗电器部分（如电机、电源开关等）。
4. 禁止用湿润的手或抹布触碰电源及电器部件。

取出电池

- 在废弃产品前，必须将电池从产品中取出；取出电池前，产品必须关闭电源；
1. 用工具撬开后壳装饰件及外壳，拧出内部螺丝（图一）；
2. 撬开前壳装饰件及底部螺丝盖，拧出内部螺丝，取出主板，并拔出手柄（图二）；
3. 用镊子拔出拨动开关及无级拨轮小板插线端子，拧出手柄支架上的螺丝，取出手柄支架（图三）；
4. 取出拨动开关小板，拔出电池插线端子，再取出无级拨轮小板，最后取出电池，将其依照销售地法规安全的处置（图四）。

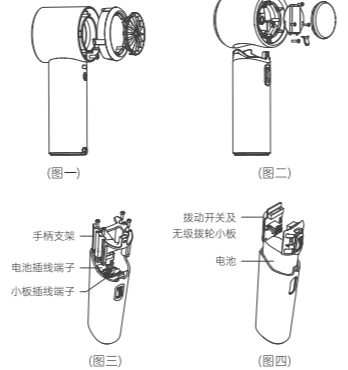

安全注意事项

- 为了保证使用安全，避免对您和他人造成伤害和财产损失，请遵守以下安全注意事项；
01. 本产品非儿童玩具，请确保婴幼儿不将此产品作为玩具玩耍；
02. 本产品不预期提供生理、感知、心智能力、经验或知识不足之使用者（包含孩童）使用；
03. 请勿直接对着人体长时间吹拂，尤其老人与小孩，以免造成身体不适；
04. 使用时，请勿放入手指、尖锐物及金属物等，会造成产品故障及触电、受伤的危险；
05. 使用时，禁止用湿手、湿毛巾等进行插拔电源，以免触电；
06. 本产品不防水，请勿用水直接冲洗产品或在浴室、湿气重、有储水的地方来使用；
07. 请勿盖住出风口及入风口，如披挂衣物、毛巾、布匹等物品，以免造成产品故障；
08. 禁止在高温（高于60°C）环境和密闭空间使用 and 存储，如温室、建筑工地、火炉、暴晒的车室等环境，会造成塑胶变形、火焰随风飘散造成火灾、电池爆炸等故障及事故；
09. 请勿挤压、拆解电池或将电池长期置于高温环境（60°C及以上），否则可能会有漏液或爆炸危险；
10. 如果消费者使用电源适配器充电，其电源适配器输入额定电压、电流应在5V=2A/9V=2A/12V=1.5A范围内，并获

产品中有害物质的名称及含量

Table showing substance names and their content levels in different parts of the fan.

本表格依据SJ/T11364的规定编制
O：表示该有害物质在该部件所有均质材料中的含量均在GB/T 26572规定的限量要求以下。
X：表示该有害物质至少在该部件的某一均质材料中的含量超出GB/T 26572规定的限量要求。

本标识内的数字表示产品在正常使用状态下的环保使用期限为10年

三包凭证

- 1. 请妥善保管保修卡，以作维修时的凭证。
2. 保修期为产品购买之日起一年内。
3. 保修期内，本产品在正常使用的情况下发生故障，经本公司查验属实，将免费提供维修和换新服务。

以下情况恕不提供免费维修

- 1. 设备或部件已经超出了有效的保修期；
2. 客户未按照说明书的要求，错误的安装、保管以及使用而造成的设备故障或损坏；
3. 非由本公司授权机构或人员拆卸而造成的设备故障或损坏；
4. 因意外因素或人为原因（包括但不限于操作失误、刮伤、搬运、碰撞、输入不合适的电压电流等）导致的设备故障或损坏；
5. 因自然灾害等不可抗力（如地震、火灾等）原因造成的设备故障或损坏。

产品参数

品牌：几素
产品型号：Handheld Fan Pro1 S
产品名称：手持风扇
额定电压、电流：5.0V=2.0A / 9.0V=2.0A / 12.0V=1.5A
电池容量：5000mAh
电芯：锂离子电池
产品重量：约260g
充电时间：1.5-2h(18W快充输入) / 2.5-3.5h(5.0V=2.0A输入)
工作时间：3-15h(根据不同档位/使用场景而定)
产品尺寸：59(L)×61(W)×157(H)mm
执行标准：GB4706.1-2005 GB4706.27-2008

包装配件

- 手持风扇 \* 1
USB-C to USB-C充电线 \* 1
挂绳 \* 1
说明书 \* 1



本说明书的内容及产品的规格技术说明如有变更，恕不另行通知

产品保修卡

(本卡仅适用中国地区)

产品名称 联系电话
产品型号 购买地点
用户姓名 经销商名称
购买时间

制造商：深圳市几素科技有限公司
生产地址：深圳市龙岗区园山街道荷坳社区长江埔二路8号A栋301
办公地址：深圳市龙岗区坂田街道永香路坂维园C栋4楼
服务电话：400-011-8812

全球USB小风扇专家与领导者\* The World's No.1 Portable Fan Brand\*

Appearance Description

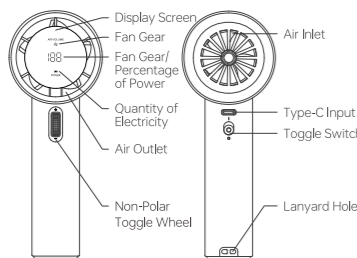

Precautions Before Use

- 1. Please check the product and power cord for any damage and make sure they are in good condition and assemble them according to the instructions before powering them on.
2. Before charging the product, please check whether the voltage of the power supply used is consistent with the product label.
3. Please do not disassemble, modify or repair the product to

avoid electric shock and fire accidents, and ask the service station designated by the original seller or manufacturer for repair.

How to Use

A. Toggle switch use and switch on/off/wind speed switching

- Toggle Switch The upper dial turns on the power, the lower dial turns off the power.
Non-polar Toggle Wheel Short press: on/off cycle switching (power on default on the lowest wind speed)
Quick double-click: display the current power percentage (5s after extinguished or jumping to other states)
Toggle: adjust the wind speed, from 1 to 100 gears. Up dial to increase the wind speed, and down dial to reduce the wind speed.

Upper Dial

- 1. Before turning on the fan, toggle the switch up to make the fan in the power-on state.
2. When put away, you must turn the toggle switch down to turn off the power, so that the fan is in the off state to avoid accidentally touching the power on.

B. Status Description of the Display Screen

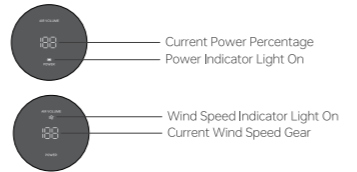

Table with 2 columns: Operation/Status and Content of Digital Screen Display. Rows include Power On, Adjust Wind Speed, Power Display, Power Off, Low Battery Reminder, and Fully Charged.

C. Product Cleaning

- 1. Before cleaning the product, please make sure the power is disconnected.
2. The product cover can not be removed. When cleaning, use a clean cloth to wipe the surface of the fan cover and air inlet grille.
3. Do not use water or other liquids to clean the electrical parts (such as the motor, power switch, etc.).
4. Prohibit touching the power supply and electrical parts with wet hands or rags.

Take Out the Battery

Before disposing of the product, the battery must be removed from the product. Before removing the battery, the product must be powered off. The battery should be disposed of safely according to the regulations of the place of sale.

- 1. Pry open the back case trim and back case with a tool and unscrew the internal screws (Figure 1);
2. Pry open the front case trim and the bottom screw cover, unscrew the internal screws, and remove the motherboard, and pull out the handle (Figure 2);
3. Use tweezers to pull out the toggle switch and induction paddle wheel small board plug wire terminals, unscrew the screws on the handle bracket, and remove the handle bracket (Figure 3);
4. Remove the toggle switch small board, pull out the battery plug wire terminal, then remove the induction paddle wheel small board, and finally remove the battery and dispose of it safely following the regulations of the place of sale (Figure 4).

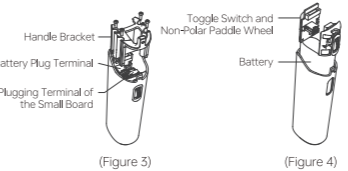
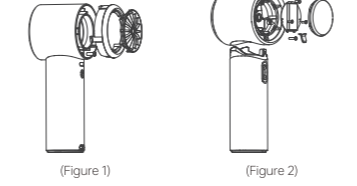

Safety Precautions

- To ensure the safety of use and to avoid injury and property damage to you and others, please observe the following safety precautions;
01. This product is not a child's toy, please ensure that infants and children do not play with this product as a toy;
02. This product is not intended for use by users (including children) with inadequate physiology, perception, mental ability, experience, or knowledge, unless used safely under the supervision or knowledge of a person responsible for their safety.
03. Please do not blow directly on the human body for a long

- time, especially the elderly and children, to avoid physical discomfort.
04. When using, please do not put fingers, sharp objects and metal objects, etc., which will cause product failure and the risk of electric shock, or injury.
05. When using, prohibit the use of wet hands, wet towels and other plugging power to avoid electric shock.
06. This product is not waterproof, please do not use water to directly rinse the product or in the bathroom, heavy moisture, water storage places to use; surface water, please dry in time to dry before trying to turn on the use; completely soaked and internal water into the prohibition of re-use.
07. Do not cover the air outlet and air inlet, such as hanging clothes, towels, cloths and other items, so as not to cause product failure.
08. Prohibit the use and storage in high temperature (higher than 60 °C) environments and confined spaces, such as greenhouses, construction sites, fireplaces, exposed car rooms and other environments, which will cause plastic deformation, flame with the wind to cause fire, battery explosion and other failures and accidents.
09. Do not squeeze, disassemble the battery or place the battery in a high-temperature environment (60°C and above) for a long time, otherwise there may be a risk of liquid leakage or explosion.
10. If consumers use the power adapter to charge, the power adapter input rated voltage and current should be within 5V=2A/9V=2A/12V=1.5A, and the national mandatory

- safety certification before use.
11. This product uses a lithium-ion battery, with no memory function, overcharge or over-discharge will affect the product's life, please charge and disconnect the power supply after full charge in time.
12. If there is smoke, fire and other failures in use, please immediately turn off the power to stop using, and send it to the dealer or manufacturer to deal with, do not disassemble themselves to avoid danger.
13. Do not bend or pull the power cord in use to avoid poor contact.

Product Parameters

Brand: Jisulife
Product Model: Handheld Fan Pro1 S
Product Name: Handheld Fan Pro1 S
Rated Voltage、Current: 5.0V=2.0A / 9.0V=2.0A / 12.0V=1.5A
Battery Capacity: 5000mAh
Cell: Li-ion Battery
Product Weight: about 260g
Charging Time: 1.5-2h(18W fast charging input) / 2.5-3.5h(5.0V=2.0A input)
Operating Time: 3-15h(depending on different gears/use scenarios)
Product Size: 59(L)×61(W)×157(H)mm

Packing Accessories

- Handheld Fan Pro1 S \* 1
USB-C to USB-C Cable \* 1
Rope \* 1
Manual \* 1



The contents in this user manual and the technical specification of the product will be changed without prior notice.

\*注：根据2021年全球销售额统计，数据来源千欧睿信息咨询（上海）有限公司，报告品牌于2021年而全球品牌中全球品牌中“销量第一”，不包含以品牌名称或品牌名称的USB小风扇品牌超过50%的USB小风扇品牌。USB小风扇专家品牌品牌USB小风扇品牌全球品牌名称排名前10日占比超过品牌所有产品总销量的50%；于2022年9-10月完成调研。

\*Explanatory note: In terms of global sales revenue in 2021.
\*Data source: Euromonitor International Shanghai Co., Ltd., measured in terms of global sales revenue of portable fans in 2021 of the brands; brands that authorize others to use their trademarks for sales, marketing and distribution of the products are excluded; portable fan is defined as a miniature fan that is powered through USB cable; portable fan specialist means that one brand's sales of portable fan rank top 10 in the world, and the proportion of sales from portable fans exceeds 50% of the brand's overall sales revenue; research conducted between Sept.—Oct. 2022.\*