

项目名称	PLAF203 视频款WIFI喂食器-双食盆-快速指南-英文		
成型尺寸	130*80 mm	材 质	128g铜版纸
印刷工艺	四色印刷		
备 注	三折页		

ENABLE THE VIDEO RECORDING

To enable the video recording function, insert a TF card (not included) first, then enable the Local Recording option in the APP: tap  icon in the upper right corner → Recording Settings → Local Recording.

Note:

For the first time with the feeder, please use APP to format the TF card in settings.

1) Open the battery compartment, the TF card slot is in the middle of the battery compartment.

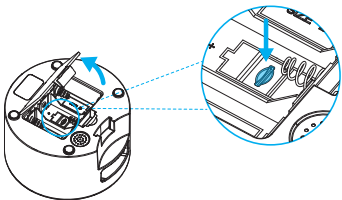

2) Insert the TF card in the direction shown. Slide it in until it clicks into place.

Do not force or apply excess force when inserting the TF card.

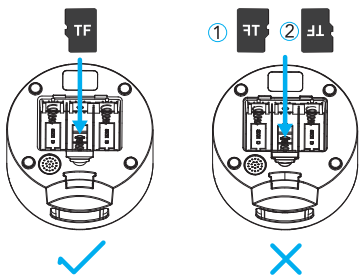

Note: Insert the TF card correctly. Not doing so can cause a malfunction.



Model: PLAF203

QUICK GUIDE

Granary Automatic Pet Feeder - Camera Monitoring 5L Double Food Tray

- If the feeder is only powered by batteries, the WiFi function and camera function will be turned off and the user will not be able to remotely control the feeder through the App.
- Keep the feeder close to the router. The recommended distance is within 6 meters without obstacles and walls. Make sure the network signal is good.
- If the configuration fails, please restart and reset the feeder (press and hold the reset button for 5s) until the WiFi indicator keeps flashing.
- The feeder supports 2.4GHz and 5GHz WiFi.
- System requirements: iPhone on iOS 10.0 or later; smartphone on Android 5.0 or later.
- We support TF card capacity 16-256GB, speed Class10 or above, and suggest brands like Samsung and SanDisk.
- Please contact our after-sales team via email: support@petlibro.com for any help.

ADD THE FEEDER VIA BLUETOOTH MODE

1. Install the APP & Log in

1. Scan the QR code below or search "PETLIBRO LITE" in App Store  or Google Play  to download the App.
2. Sign up and log into your account.



2. Open the App, select Home page, tap "Add Device" or "+" in the upper right corner.

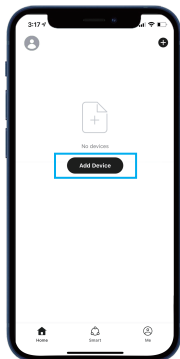

3. Choose PLAF203 Camera Feeder.
4. Tap the icon in the top right corner and choose **Bluetooth mode**.

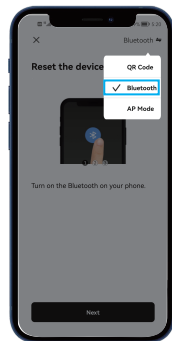
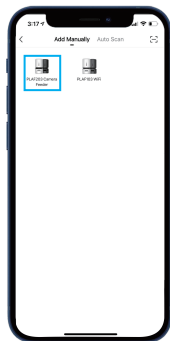

5. Follow the instructions on the screen, and **confirm the WiFi indicator on the feeder is flashing**.

(Note: If the WiFi indicator on the feeder is not flashing, hold the Unlock Button for 5s to unlock, the lock indicator goes out. Keep holding the reset button until the WiFi indicator keeps flashing.)



6. Add the device PLAF203 by entering WiFi account and password.

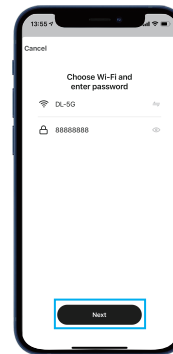
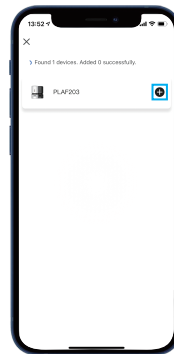

7. Feeder connected, start to set the feeding time and portions, record the voice of meal call and set the number of times this voice is played.

Note:

If Bluetooth mode sometimes fails, you can try adding feeders in QR code or AP mode.