

# User manual

VP-130

## Product specs

Rated voltage	110-120V
Rated frequency	50Hz/60Hz
Product usage	Removes pollutants such as particulate matter, gas pollutants and microorganisms in the air.
3-in-1 filter	Pre-filter + HEPA + carbon
Rated power	55W
Particulates CADR	130 ft <sup>3</sup> /min
Energy efficiency index	Qualified (particulates)
Noise	60 dB(A)
Room size	150-280 ft <sup>2</sup>
Product size	8.7 (l) x 8.7 (w) x 13.1 (h) in
Weight	7.2 lbs

Includes 1x air purifier, 1x air filter, & 1x product manual.

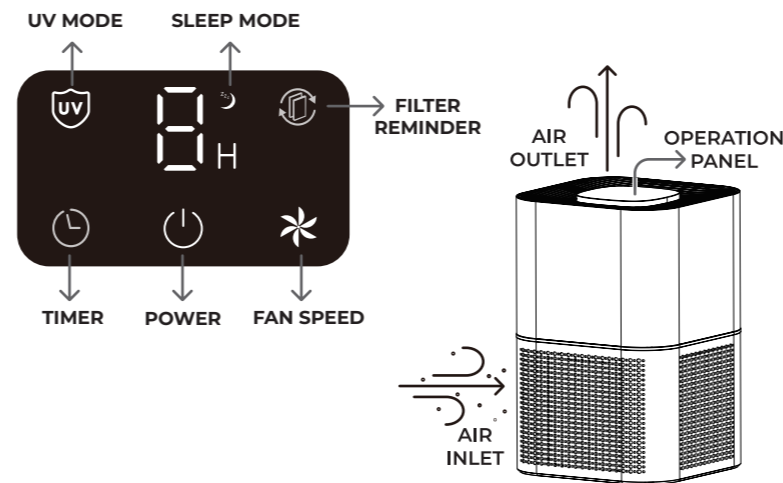

## Filter installation & removal

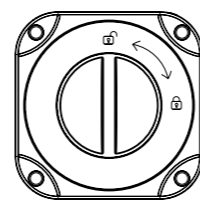

Figure 1

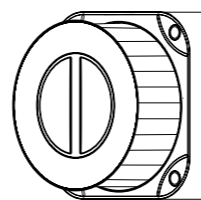

Figure 2

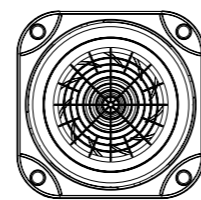

Figure 3

### INSTALLATION

Insert the filter at the machine's bottom (figure 2), twist clockwise to tighten (figure 1).

*Note: Remember to remove the plastic bag from the filter before installing.*

### REMOVAL

Twist counterclockwise (figure 1) from the machine's bottom to rotate and pull out the filter (figure 2 & 3).

## Operations & controls



**Power ON/OFF**  
Press the power icon to alternate between on (white icon) and off (red icon). After power is started, the UV light will automatically turn on and the fan runs on speed 2.



**Fan speed**  
Press the fan icon to cycle through speed 1, 2, 3, and sleep mode.



**Timer**  
Press the timer button to adjust the run time within the range of 1-8 hours. Hold the button for 2 seconds to cancel the timer. The screen will show the selected run time.



**UV light**  
Press the UV icon to turn the UV mode on/off. The icon is illuminated when the function is activated and dims when turned off.



**Filter reset indicator**  
The filter icon flashes blue when it's time for replacement. Reset the reminder by holding the icon for 3 seconds after changing the filter.



**Sleep mode**  
Press the fan speed icon to enter and exit sleep mode. Under sleep mode, the moon icon is illuminated and other icons are off. Press on the screen to wake up the display.

## Maintenance

Disconnect the power plug before cleaning and maintenance. Non-professionals are prohibited from disassembling the machine to avoid the risk of electric shock.

### FILTER REPLACEMENT REMINDER

Approximately every 1500 hours (around 2 months), the filter icon will flash blue slowly, indicating that it's time to replace the filter. To reset the replacement prompt, simply long-press the icon for 3 seconds. Note that resetting the replacement prompt doesn't alter the current cumulative time; instead, after the reset, the time will continue to accumulate, and the replacement reminder will be triggered again after the next 1500 hours.

### Tips

- DO NOT operate without the filter to avoid equipment failure.
- The filter may need to be replaced more frequently if used in an area with heavy air pollution. Promptly replace if filtration effectiveness is diminished.
- Immediately discard used filters.
- *DO NOT WASH THE FILTER WITH WATER.*

### PURCHASING REPLACEMENT FILTERS

Replacement filters can be purchased on [verapure.com](http://verapure.com). Compatible filter #: VP-130-F



### CAUTION

Disconnect the power before performing any maintenance on the appliance.

# Placement Guidelines

For optimal air circulation, place the purifier at least 1 foot away from walls, furniture, curtains, and other objects.

## Place on a flat and stable surface

Ensure the stability of your air purifier by placing it on a flat and stable surface. The machine must not move or shake during operation. Avoid precarious positions to prevent the risk of the product falling over, which could lead to injury, electric shock, or fire hazards.

## Combating indoor dust (pollen)

Place purifier on the ground since pollen and dust are likely to fall near the floor.



## CAUTION

Keep water and flammable detergents/liquids away from the product to prevent electric shock or fire.

## RESTRICTIONS

### Avoid wet, humid & hot environments

Do not use in wet or hot environments such as bathrooms.

### Avoid direct sunlight

Direct sunlight and heat may cause deformation, deterioration, discoloration, and failure.

### Avoid locations emitting soot

Do not use near gas appliances, heating devices, or stove accessories.

## Do not use with incense, incense-based insecticides & mosquito coils

Never use air purifiers with incense-based insecticides; allow thorough ventilation after insecticide use before operating the air purifier.

It is not recommended to use the air purifier during the burning of incense or mosquito coils, as it may leave unwanted odors in the filter.

*Note: The machine may collect chemical residues, which can later be released from the air outlet, posing a threat to your health.*

## Avoid placing directly next to TVs and radios

Keep a minimum distance of 3 feet between the air purifier and TVs or radios to prevent electrical interference, which may cause image distortion or noise. If using the same socket as a TV or radio results in image problems or noise, move the air purifier to a different outlet.

## PRODUCT SAFETY STANDARDS

### International electrotechnical commission (IEC)

This device is not intended for use by individuals (including children) with reduced physical, sensory, or mental capabilities, or those lacking experience and knowledge, unless they are under the supervision or have received instructions regarding its safe use from a person responsible for their safety. Children should be supervised to ensure they do not play with the device.

### European norm (EN)

This device is suitable for use by children 8 years and older and individuals with reduced physical, sensory, or mental capabilities or lack of experience and knowledge, provided they have received supervision or instructions on safe usage and understand the associated hazards. Children must not play with the device. Cleaning and user maintenance should not be performed by children without supervision.

# Safety Guidelines

Use this air purifier only as described in the manual. If the directions are not followed, an electric shock or fire may result causing property damage, personal injury or death.

## Intended use

This product is not a substitute for regular ventilation equipment, vacuum cleaners, or kitchen range hoods.

## Water exposure precaution

Prior to connecting the power cord, ensure both the plug and your hands are dry to mitigate the risk of electric shock.

## AIR OUTLET & INLET SAFETY

- Do not block the air inlet & outlet.
- Do not place any objects on or in front of the unit.
- Do not insert fingers or metal objects into the air outlet gap.
- Do not allow water, flammable detergents or other liquids to enter the product to avoid electric shock or fire.

## POWER CONNECTION GUIDELINES

Do not damage, cut, excessively twist, or pull on the power cord. If the power cord is damaged, seek professional assistance for replacement to avoid danger and the risk of electric shock.

## Plug securely into the power outlet

Do not use a damaged plug or a loose power outlet.

## Pull power plug from the base, not the cord

Unplug the purifier by pulling from the plug base. Avoid pulling the power cord to prevent short circuits, damage, and potential fire or electric shock hazards.

## Power supply limits

Do not use power supplies or universal sockets that exceed the rated value (110V ~ 5A AC power) to prevent overheating and fire hazards.

## Clean the power plug regularly

Dusty power plugs are a fire hazard. Wipe off the plug regularly with a dry cloth.

## Standby power consumption

Unplug the power cord during extended idle periods to prevent standby power consumption.



## CAUTION

Promptly power off the device and request maintenance if experiencing any of the following:

- Non-functional switch
- Unusual sound or vibration
- Excessive heat in cord or device
- Burnt odor
- Any other abnormalities or malfunctions

# 1-year limited warranty

The manufacturer warrants this product and included accessories against defects in materials and workmanship under normal use for a period of ONE (1) YEAR from the date of retail purchase by the original end-user purchaser.

For exceptions and warranty redemption instructions, visit our website at [verapure.com](http://verapure.com).

# Troubleshooting guide

## Won't turn on/non-functional button

- Confirm the power cord is plugged in.
- Verify that nothing is blocking the air inlet/outlet.
- Replace the filter if needed.

## Strange odor

Ensure the filter is removed from the plastic bag and installed correctly before use. Installation instructions can be found on the reverse side of this manual.

## Inadequate air quality improvement

Check the filter alarm light. If the filter reminder is illuminated, it signals that it is time for a filter replacement. Reset the filter reminder after replacing the filter.

*Note: Regularly replace the filter when it becomes dirty to ensure optimal air quality improvement. If prolonged operation doesn't significantly enhance air quality, consider replacing the filter.*

# 30 day return policy

- Product must be in new condition.
- Packed in the original box with packing material.
- Original manuals and accessories included.

*Note: After 30 days from the purchase date, the buyer is responsible for all freight/shipping charges associated with exchanges, refunds, or warranty claims for the purchased product.*

# Need help?

435-752-6611

[support@verapure.com](mailto:support@verapure.com)

[verapure.com](http://verapure.com)