



DIY
series



CHICKEN WATERER KIT

Horizontal Nipples
with Patented Dribble Dishes



TABLE OF CONTENTS

How to Install	...	1
How to Train Your Chickens	...	3
How to Fix a Leak	...	4
How to Clean	...	5

INSTALLATION INSTRUCTIONS

NOTE: Install a minimum of one nipple for every four chickens or three chickens if in a hot climate.

1. Measure one inch from the bottom of the container and drill holes using a $\frac{3}{8}$ " drill bit.

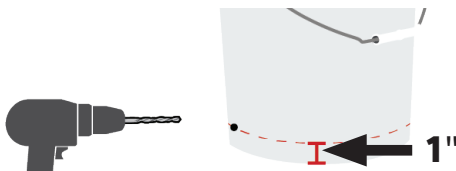

2. Prepare the installation helper by attaching the installation helper to the drill bit and then placing the front of the horizontal nipple into the installation helper.

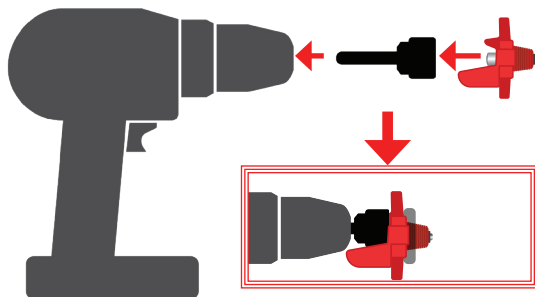

3. Screw the horizontal nipple into the container using the drill and the installation helper. Make sure the gasket is positioned at the end of the threads before installing. Do not over-tighten horizontal nipple using the drill bit.

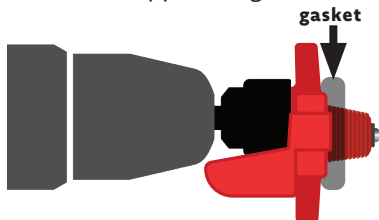

4. Twist by hand until the washer is flush against the back of the nipple and the container. Make sure the lip of the horizontal nipple is correctly positioned at the bottom.

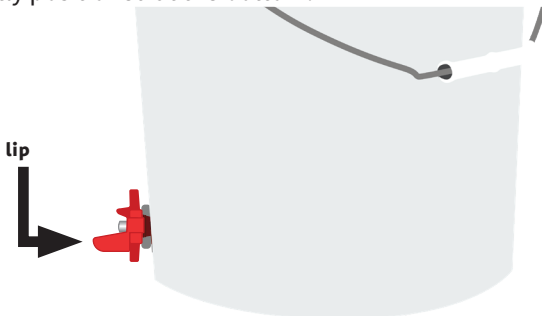

TRAINING YOUR CHICKENS

You **MUST** remove the old water source before introducing a new watering system. Place the new waterer in the same area where the old previous waterer used to be.

Mimic pecking by tapping on the nipple multiple times in front of your chickens so that they can see where to get water.

Leave a drop of water on the **lip** of the horizontal nipple for your chickens to notice.

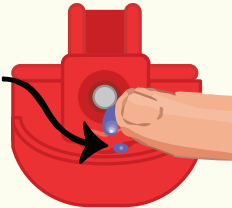

When one chicken learns how to use it, the other ones will always follow suite.

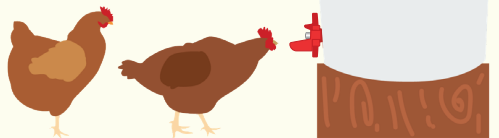

WATERER HEIGHT INFORMATION:

For full-grown chickens, place waterer on a prop so that the waterer is six to 12 inches off of the ground. The nipples should be at mouth or eye level of your smallest chicken.

For chicks two weeks and older, place the waterer directly on the ground.

LEAKY NIPPLE? **Fixing it is fast and easy!**

Problem

The water is leaking from between the bucket and the threads of the nipple.



Cause

The horizontal nipple is not screwed on tight enough.

Solution

Tighten the horizontal nipple by turning it clockwise for one rotation.

The water is leaking from the metal part.

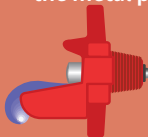

Debris is stuck between the black washer and the red plastic which creates an opening for water to escape.

Clean the nipple by following the cleaning instructions on the next page.

CLEANING INSTRUCTIONS

1. Unscrew the leaking horizontal nipple by hand from the container.

2. Push in the metal part of the nipple and hold.

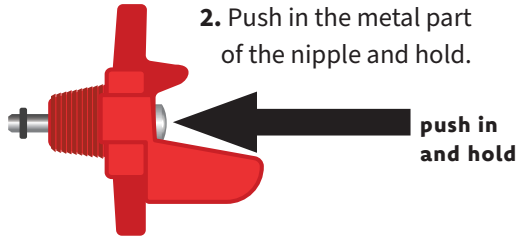

3. While pushing in the metal nipple, run the threaded end where the small black washer is under water or swish it in a container filled with water for five seconds.

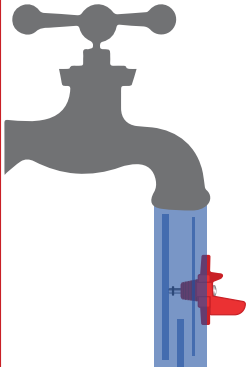

4. Screw the nipple back into the bucket by hand until washer is tight.

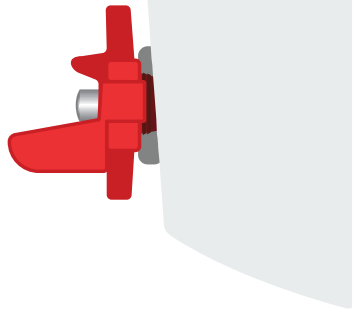



RentACoop®

QUESTIONS?

CONTACT OUR
EGG - S P E R T S

info@rentacoop.com

1 800-642-3571

M-F 9-5 EST

Help others by sharing your experience in the form of a review.

amazon.com/ryp

“Review Your Purchase”



RentACoop.com



**rentacoop
#rentacoop**