



Get Started!



Outlast™ Pet Fountain

with HydroSpin™ technology

Before we start: Care Instructions

To keep providing fresh, clean water for your pet, remember these simple tasks:

Refill often.

Remember to check the water level often and add water as needed.

The fountain's status light will glow red if the water level is getting low. If the fountain runs dry, the status light will continue glowing red, and the fountain's motor will stop. To restart the fountain, just add water up to the max fill line. The status light will turn off, and the motor will restart.

Clean your fountain.

Clean the fountain every two to four weeks or as needed. Remove the filter before cleaning the fountain. The bowl, lid, cone, spout and tray are all dishwasher safe.

Important: Always remove the bowl from the fountain base before rinsing or cleaning the bowl. The fountain base contains the fountain's motor and electronic components and is not waterproof; do not rinse it or submerge it in water.

Replace the filter.

The status light will blink blue every three weeks to remind you to change the filter. We recommend cleaning the fountain at the same time.

Important: Always unplug the fountain or remove the bowl from the fountain base before replacing the filter.

After replacing the filter, press and hold the status light/button for 10 seconds to reset the three-week timer.

For a happy, healthier best friend: Just add water.

What you have:

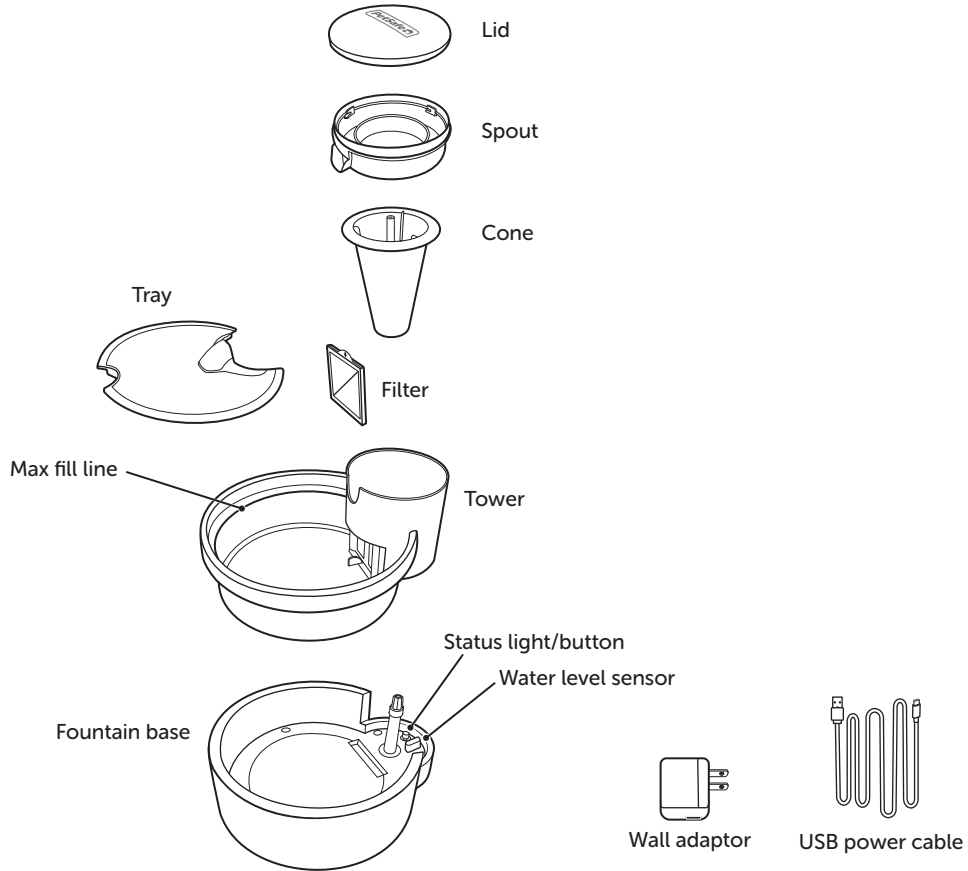

Setup instructions

1

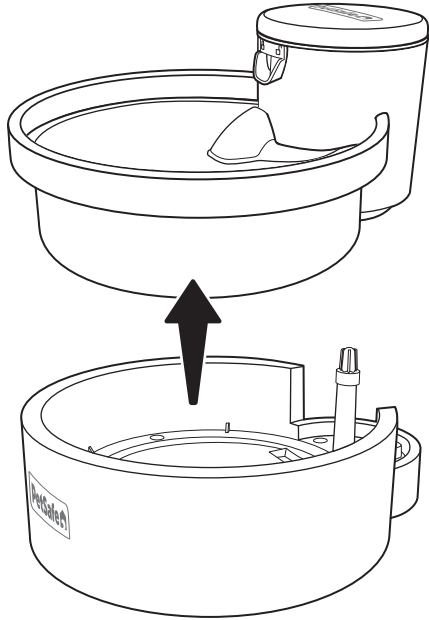

Lift the bowl off the fountain base.

Important: Always remove the bowl from the fountain base before rinsing or cleaning the bowl. The fountain base contains the fountain's motor and electronic components and is not waterproof; do not rinse it or submerge it in water.

2

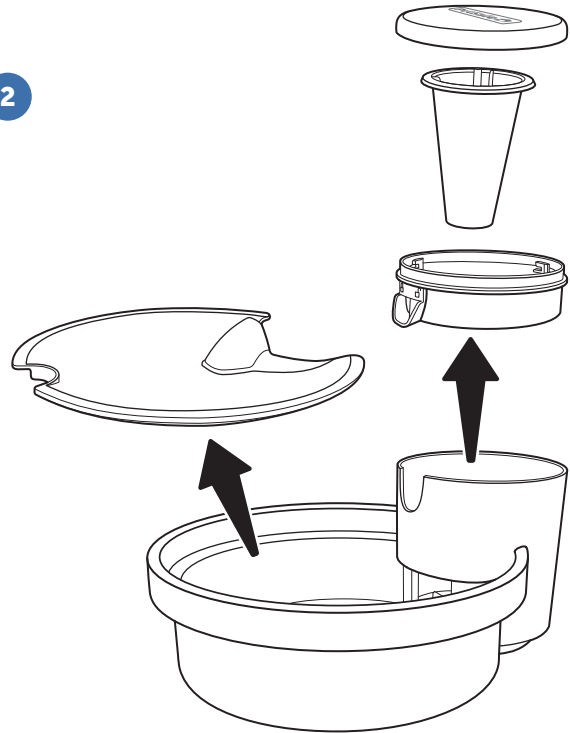

Remove the lid, spout, cone and tray from the bowl.

Rinse the bowl, lid, spout, cone and tray with water to remove any dust or residue left over from manufacturing.

3

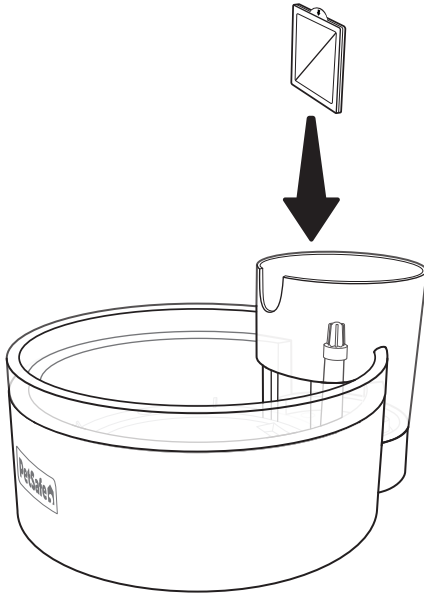

Once all parts are clean and dry, place the bowl back on the fountain base and press it down firmly to ensure it is fully seated.

Rinse the filter with water. Holding the filter with the tab on top, insert it into the slot inside the front of the tower. The filter is reversible; it doesn't matter which side (light or dark) faces the front.

4

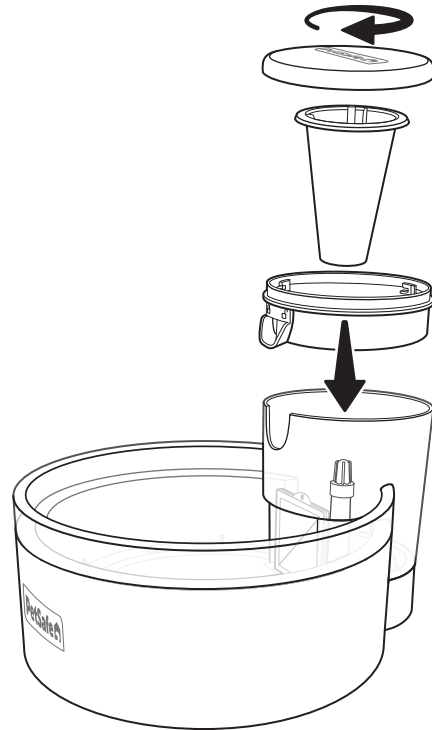

Fit the spout into the top of the tower.

Place the cone onto the stem in the center of the tower, making sure it is fully seated.

Place the lid on the tower and rotate it clockwise to secure it. Keep this lid in place whenever the fountain is running.

Use instructions

5

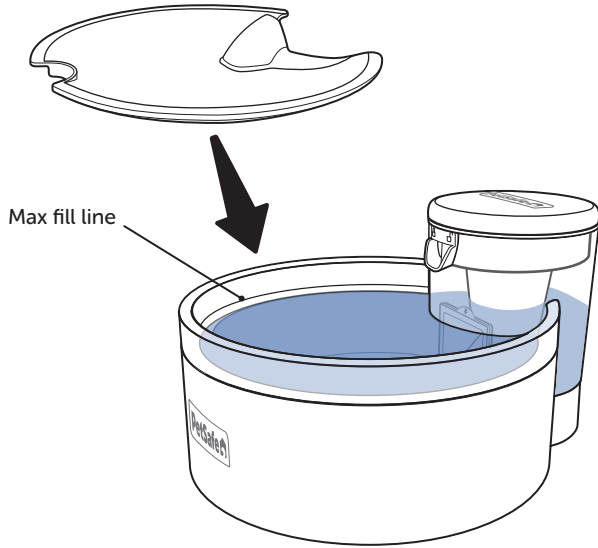

Place the fountain where your pet will use it (within 6 feet of a power outlet).

Fill the bowl with water up to the max fill line and then fit the clear tray onto the top of the bowl.

6

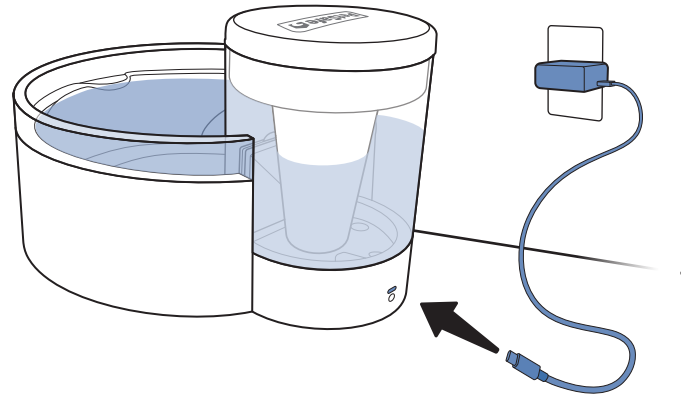

Make sure your hands are dry, then connect the USB cable to the type C power jack on the back of the fountain. Connect the other end of the USB cable to the wall adaptor and then plug it into a standard power outlet.

The cone will begin rotating to bring the water up to the top of the tower; water should begin flowing from the spout within 30 seconds.

If your pet is hesitant to drink from the fountain at first, try leaving it unplugged until your pet is comfortable drinking from it.

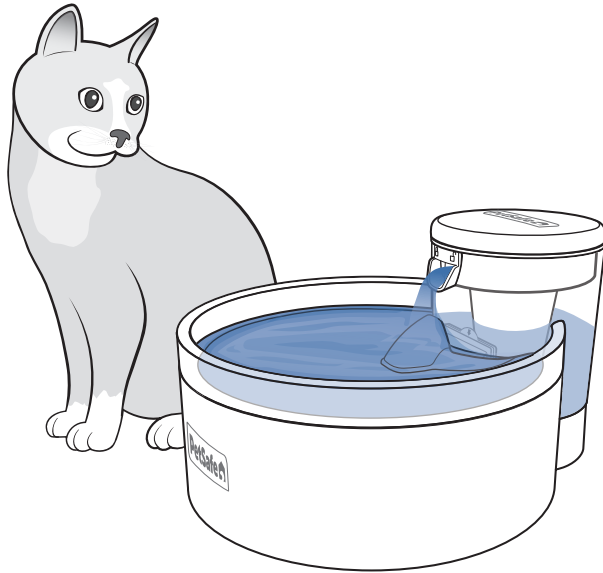

As your pet uses the fountain, keep an eye on the water level and add more water as needed.

The status light will alert you when the water level is low, the filter needs to be replaced, or if there is an issue with the fountain motor. Note that the status light is also a button; you can use this button to reset the filter reminder or change the status light default settings (see full details in the table at right). The status light/button is on the fountain base underneath the tower; you will need to remove the bowl to access it.

To conserve power and motor life, the fountain motor will slow down slightly at night when the room is dark and will speed up again during the day.

Status light color	Meaning
Off (with water flowing from the fountain) or Blue, solid	The fountain has sufficient water and is operating normally. If desired, you can set the status light to glow blue whenever the fountain is powered on. To turn the status light on, press and release the status light/button. The status light will flash blue one time to confirm it is turned on. To turn the status light off again, press and release the status light/button. The status light will flash blue one time to confirm it is turned off.
Blue, blinking	It is time to replace the filter. Always unplug the fountain or remove the bowl from the fountain base before replacing the filter. The filter reminder is on a 21-day timer. After replacing the filter, reset the timer by pressing and holding the status button until the status light turns off (10 seconds). To turn off the automatic filter reminder, press and hold the status light/button until it flashes red three times (30 seconds). To turn the filter reminder back on, press and hold the status light/button until it flashes blue three times (30 seconds).
Red, solid	The water level is low; refill the fountain up to the max fill line. If the fountain runs dry, the status light will continue glowing red and the motor will stop. To restart the fountain, refill it up to the max fill line. The status light will turn off and the motor will restart. Important: The status light will also glow solid red any time you remove the bowl from the fountain base.
Red, blinking	Make sure the bowl and cone are fully seated and that the fountain has sufficient water. Recalibrate the fountain by unplugging it for 10 seconds and then plugging it back in. If the status light continues blinking red, please contact Customer Care for assistance.

Outlast™ Pet Fountain



We're here to help!

For questions or additional tips:
support.petsafe.com

1-Year Limited Warranty | ©2024 Radio Systems Corporation | Model: PWW00-17258 | SFE400-2510
For important safety instructions, please see the customer care guide.