

12-24VDC

## WIRING

To **+VDC** to activate Warning Mode (fuse @ 3A) ..... **RED**

Apply **+VDC** to **RED** wire for High Power Operation in ECE R65 Class 2\*.

To Chassis Ground ..... **BLACK**

For Low Power Operation ..... **WHITE**

Apply **+VDC** to **WHITE** wires while **RED** wire is activated for Low Power Operation in ECE R65 Class 1\*.

To **+VDC** to activate Cruise Mode (fuse @ 3A) ..... **GREEN**

Precedence: Warning Mode > Cruise Mode

For Synchronization and Flash Pattern ..... **YELLOW**

Connect **YELLOW** wires of all lightheads together for synchronization.

(All lightheads should be set to the same pattern)

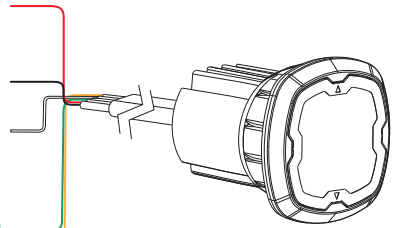

\*Actual approval will be based on the model purchased.

## OPERATION

### For Simultaneous or Alternating Flash

1. Apply **+VDC** to **RED** and **YELLOW** wires simultaneously to enter *GROUPING MODE*;  
lighthead will display short (single or double) flashes:
  - Single flash = Group 1
  - Double flash = Group 2
2. Remove **YELLOW** wire from **+VDC** then momentarily apply **+VDC** to change Groups:
  - Lightheads of the same Group will flash together.
  - Lightheads of different Groups will flash alternately.
3. Save and Exit the *GROUPING MODE* by powering off the lighthead.

### For Flash Pattern Selection

While in Warning Mode, momentarily apply **+VDC** to **YELLOW** wire:

- once to next pattern
- quickly three times to FP#1

FLASH PATTERNS		
1	Double	
2	Single	[2Hz]
3	Triple	[2Hz]
4	Quad	[2Hz]
5	Random	
6	Steady EF**	
7	Single	[SAE][CA13]
8	Double	[SAE]
9	Triple	[SAE]
10	Quad	[SAE]
11	Quint	[SAE]
12	Mega	
13	Giga	
14	Ultra	[SAE]
15	Single-Quad	
16	Single H/L	
17	Single-Triple-Quint	

\*\* For use with external flasher controller.

## Pop-n-Lock

Recommended Surface thickness @1.5~4.0mm

12-24VDC

- 1 Select a mounting location and drill an 1.14" (29mm) cut-out, and then install the LIGHTHEAD onto the cut-out.

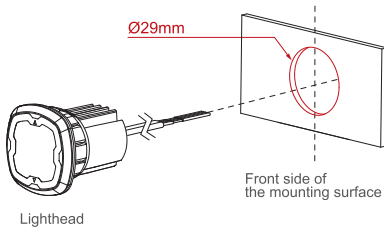

**NOTE:** To install more efficiently, use a rotating motion to guide the LIGHTHEAD when installing onto the cut-out.

- 2 Ensure that the optical stripes are aligned vertically.

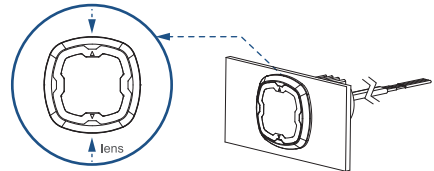

**NOTE:** Optical stripes must align vertically to meet regulation.

- 3 Where necessary, apply silicone around the reverse side to prevent from rotating.

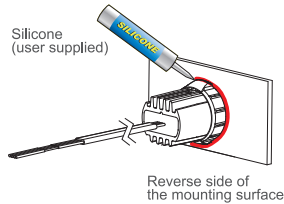

## Bracket Mount\* (sold-separately)

- 1 From the front, install the LIGHTHEAD onto the BRACKET.

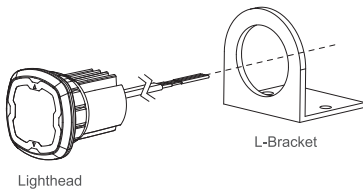

**NOTE:** To install more efficiently, use a rotating motion to guide the LIGHTHEAD when installing onto the BRACKET.

- 2 Ensure that the optical stripes are aligned vertically.

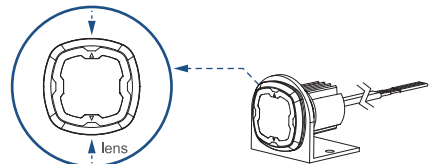

**NOTE:** Optical stripes must align vertically to meet regulation.

- 3 Secure the BRACKET onto the desired mounting surface with screws.

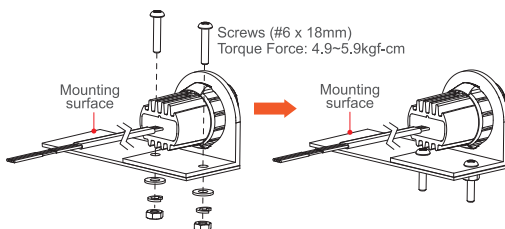

- 4 Where necessary, apply silicone around the reverse side to prevent from rotating.

