



# ORACLE LIGHTING

## REVERSE LED MODULES

ORACLE PART #5915-FB-023

### INSTALLATION GUIDE

**TOOLS NEEDED:**  
PHILLIPS SCREWDRIVER  
NEEDLE NOSE PLIERS

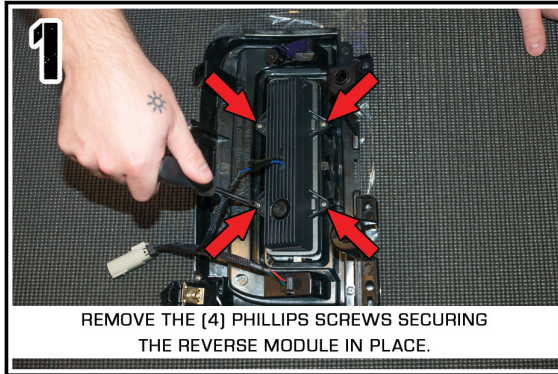

REMOVE THE (4) PHILLIPS SCREWS SECURING THE REVERSE MODULE IN PLACE.



UNPLUG THE REVERSE MODULE FROM THE TAIL LIGHT HARNESS.

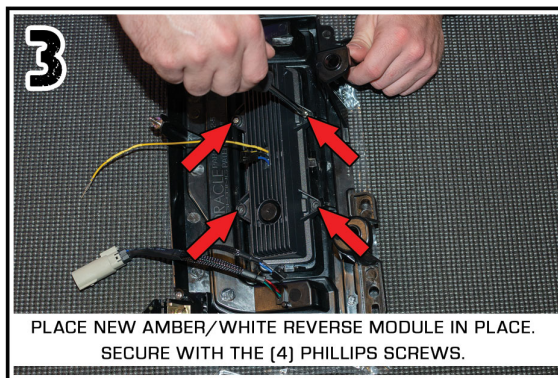

PLACE NEW AMBER/WHITE REVERSE MODULE IN PLACE. SECURE WITH THE (4) PHILLIPS SCREWS.

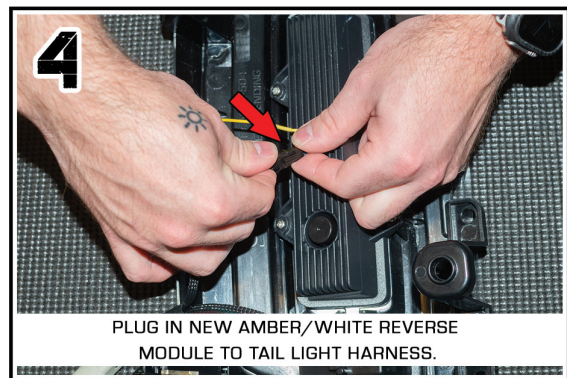

PLUG IN NEW AMBER/WHITE REVERSE MODULE TO TAIL LIGHT HARNESS.

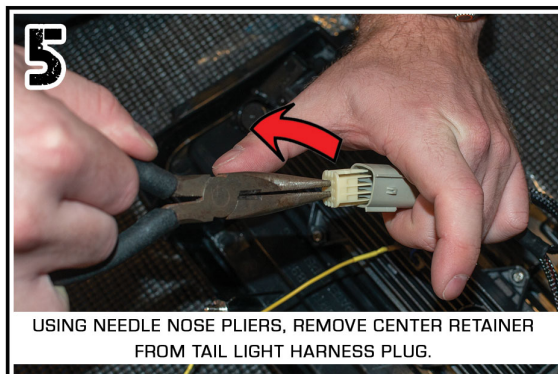

USING NEEDLE NOSE PLIERS, REMOVE CENTER RETAINER FROM TAIL LIGHT HARNESS PLUG.

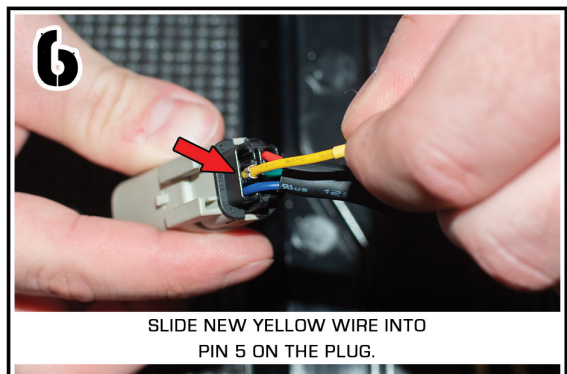

SLIDE NEW YELLOW WIRE INTO PIN 5 ON THE PLUG.

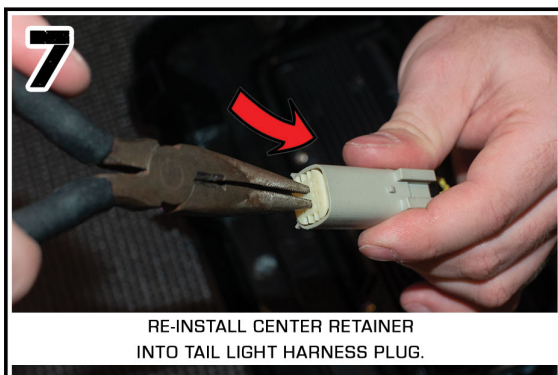

RE-INSTALL CENTER RETAINER INTO TAIL LIGHT HARNESS PLUG.

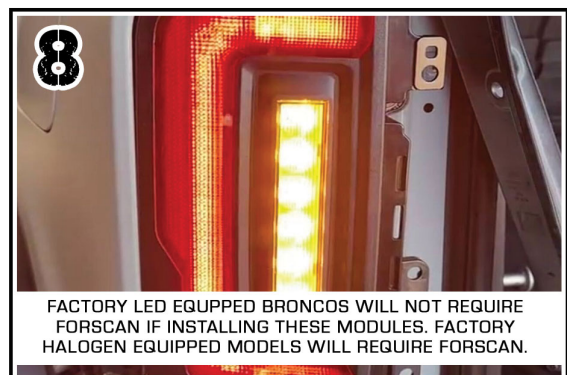

FACTORY LED EQUIPPED BRONCOS WILL NOT REQUIRE FORSCAN IF INSTALLING THESE MODULES. FACTORY HALOGEN EQUIPPED MODELS WILL REQUIRE FORSCAN.