



PORTABLE OUTDOOR SINK WITH HOSE ADAPTER

HCCHH7701B

Thank you for purchasing the Hike Crew™ Portable Outdoor Sink with Hose Adapter. This User Guide is intended to provide you with guidelines to ensure that operation of this product is safe and does not pose risk to the user. Any use that does not conform to the guidelines described in this User Guide may void the limited warranty.

Please read all directions before using the product and retain this guide for reference. This product is intended for household use only.

This product is covered by a limited one-year warranty. Coverage is subject to limits and exclusions. See warranty for details.

Safety Precautions

- Please always make sure to assemble this sink according to the instructions contained herein. Do not attempt to modify this unit.
- The base tank can be anchored to the ground if you put ground stakes through the four holes at each corner. Stakes are not included.
- Do not attempt to set up this unit in an area prone to heavy vibrations if you are not anchoring it to the ground with stakes. Otherwise, it may fall over.
- The water from this sink is intended for handwashing or dishwashing only. Please don't drink the water.

Product Overview



Assembly Instructions

1. Screw the stand column into the base tank.
2. Seat the washbasin on top of the stand column, making sure both connections are firmly locked and secured in place.

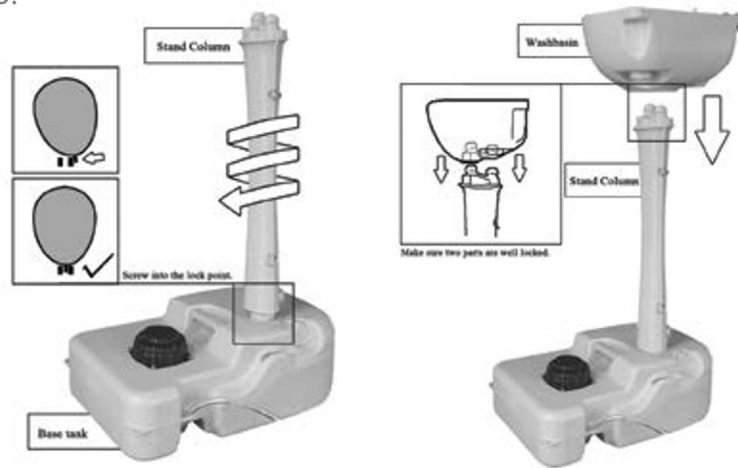

3. Install the faucet on the washbasin by placing it into the designated slot. Fasten the included washer underneath the faucet so that it locks securely into place.



4. Connect the faucet to the adapter for your garden hose via the threading underneath the washer.

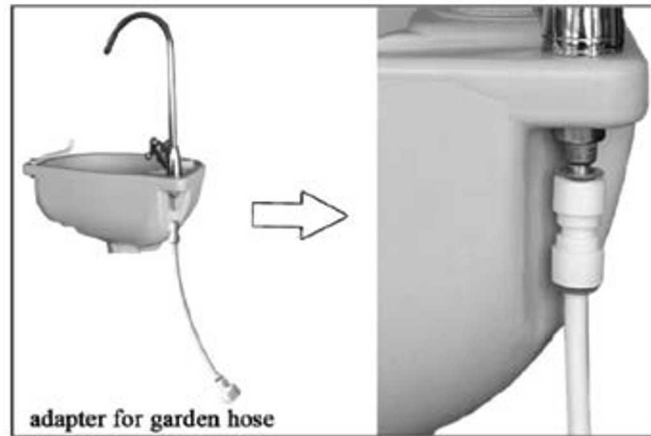

5. Pour up to 3.2 qt. (3L) of liquid soap (not included) into the tank next to the faucet, then screw the dispenser pump into place.



6. Attach the flexible drain hose to the washbasin at the top, and into the drainage hole in the base tank for used water collection. You can also fasten it to a portable water tank or outdoor toilet (not included).

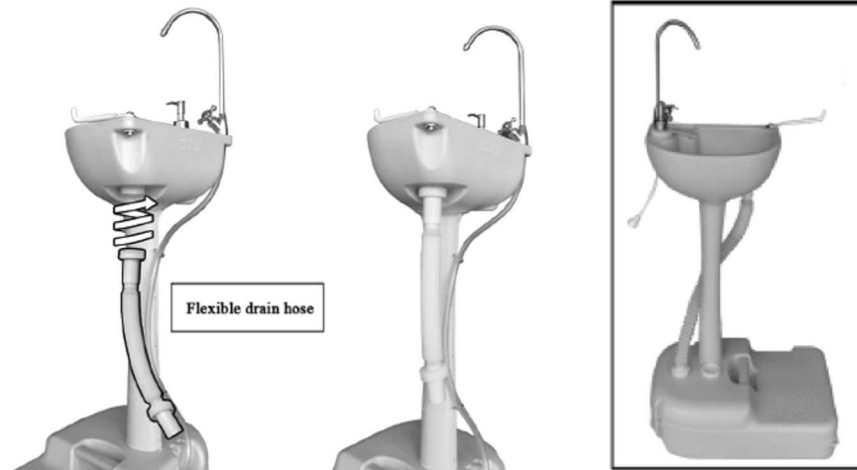

Using Your Portable Outdoor Sink

1. Follow the assembly instructions to set up your outdoor sink, using stakes to secure it in place if necessary.
2. Once the hose is attached to the faucet and the drainage hose is connected to the base water disposal tank, make sure the water supply to the hose is turned on.
3. Turn the knob on the faucet to control the flow of water. You can now use the liquid soap dispenser to wash hands or dishes in the sink. The faucet will provide a continuous flow of water until you turn the knob back or shut off the water supply to the hose.
4. The base tank can collect 5 gal. (19L) of used water drained from the basin. Once this tank fills up, you'll need to disconnect it from the stand column and empty it. Always empty the base tank before storing the sink.

Specifications

Base Tank Capacity: 5 gal. (19L)

Liquid Soap Dispenser Capacity: 3.2 qt. (3L)

Questions? Concerns? Contact Hike Crew™

Should you experience any problems with your product, please contact us before returning the item to the place of purchase. We're here to help!

info@supportcbp.com

1-833-665-2122

Hike Crew is a trademark of C&A IP Holdings, LLC, in the U.S.

All other products, brand names, company names, and logos are trademarks of their respective owners, used merely to identify their respective products, and are not meant to connote any sponsorship, endorsement or approval

Distributed by: C&A Marketing Inc. 114 Tived Lane East Edison, NJ 08837 USA. Made in China.

© 2018. C&A IP Holdings, LLC. All Rights Reserved.