

Item No.		Color	Code
4991	Eden Wall Mounted Cat Lounge	grey/white	2
		grey/brown	3

Description	Measurement	Quantity	Item No.	Item No.
Eden Lounge, small cave	45 x 28 x 30 cm 17,7 x 11 x 11,8 in.	1	49912-10	49913-10
Eden Lounge, big cave	48 x 30 x 33 cm 18,8 x 11,8 x 12,9 in.	1	49912-11	49913-11
Wall mounting step	ø 8,5 x 22 cm ø 3,3 x 8,6 in.	3	49912-12	49913-12
Hardware Set		1	49912-60	

### Mounting wooden wall small and large cat lounge and stairs

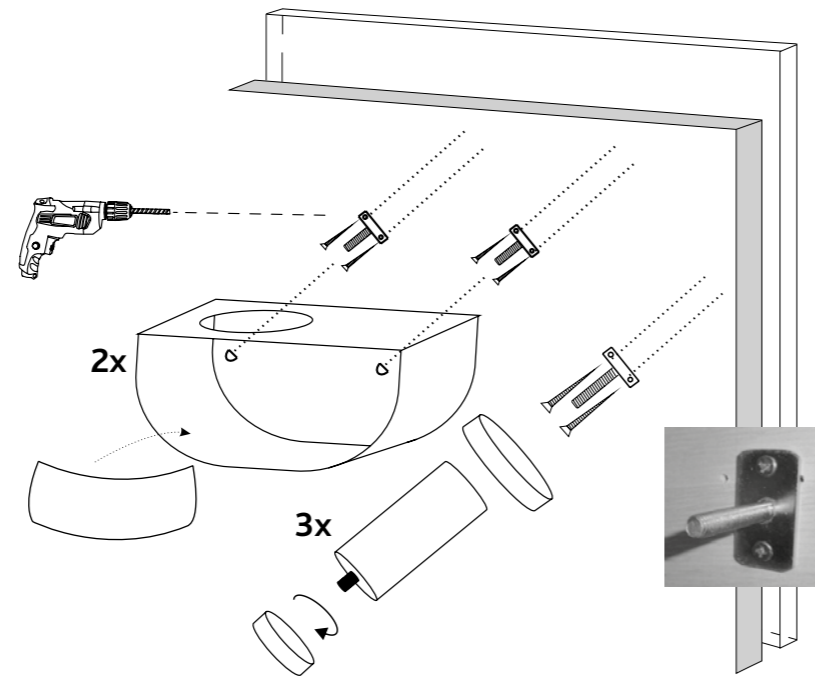

#### EN Work steps for wooden wall.

##### First Step

Bring the product in final position and mark the screw-points in desired location. Use a spirit level or have someone eyeball to make sure the holes are levelled.

##### Second Step

Use your drill and the 1/16" bit to make pilot holes for maximum 2 inch to all markings.

##### Third Step

Mount the holder with attached screws to the wall through pilot holes. Be careful to not damage the drywall panel.

##### Final Step

Connect the stairs to the metal holder and attach cap. Mount the condo to the metal holder tighten with enclosed nut.

##### Advice:

Please note the secure assembly and mounting requires one adult person.

### Mounting stonewall with anchors small and large cat lounge, stairs

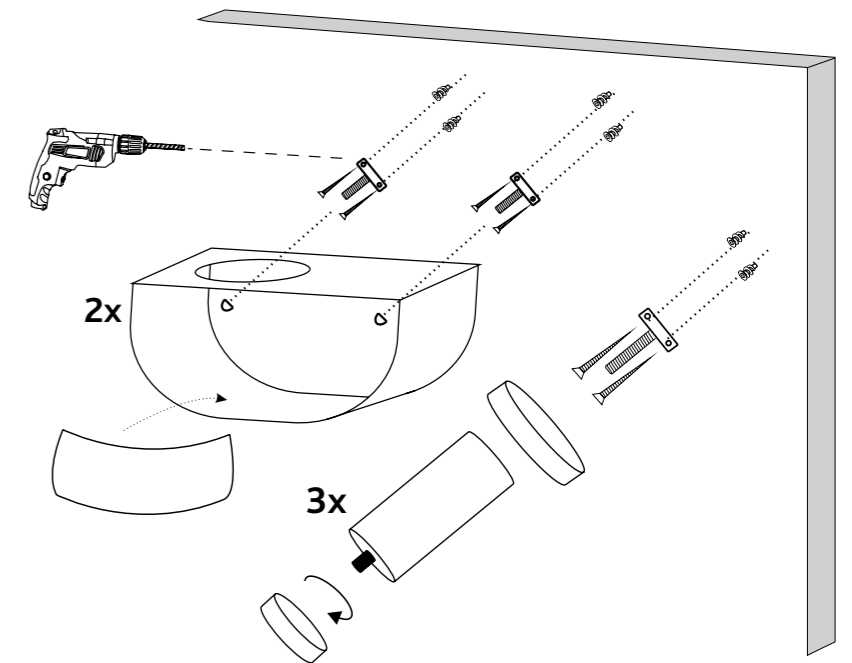

#### EN Work steps for stone wall

##### First Step

Bring the product in final position and mark the screw-points in desired location. Use a spirit level or have someone eyeball to make sure the holes are levelled.

##### Second Step

Drill 3/16" holes, be sure to keep the drill level.

##### Third Step

Insert 3/16" wall anchors (not included) into drilled holes (some anchors might require a hammer).

##### Fourth Step

Mount the metal holder with screws matching wall anchor (not included) to the wall.

##### Final Step

Connect the steps with the metal holder and attach cap. Mount the condo to the metal holder tighten with enclosed nut.

##### Advice:

Please note the secure assembly and mounting requires one adult person.

### Mounting with drywall anchor small and large cat lounge

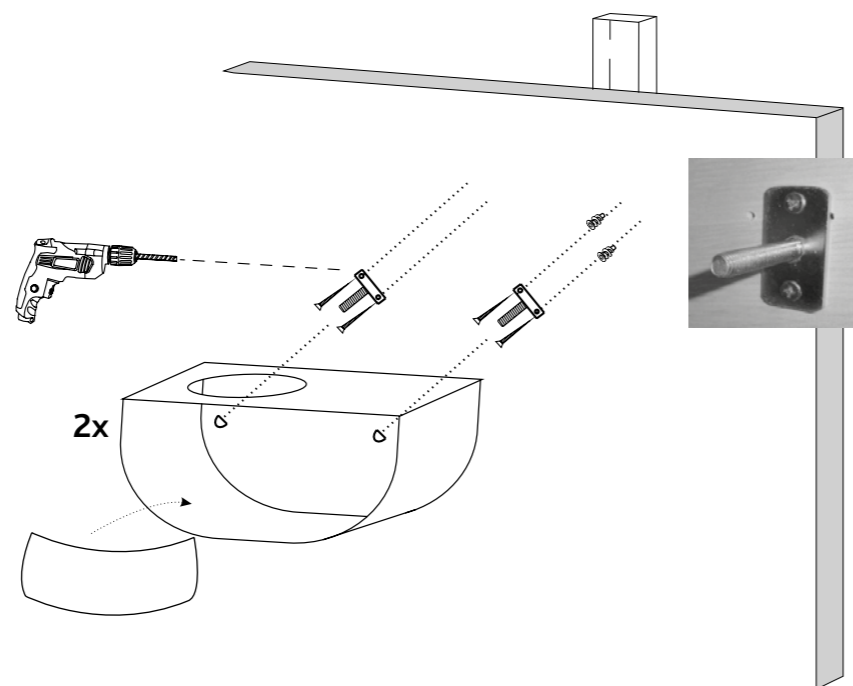

### Mounting 16" wooden stud and Mounting steps for stairs

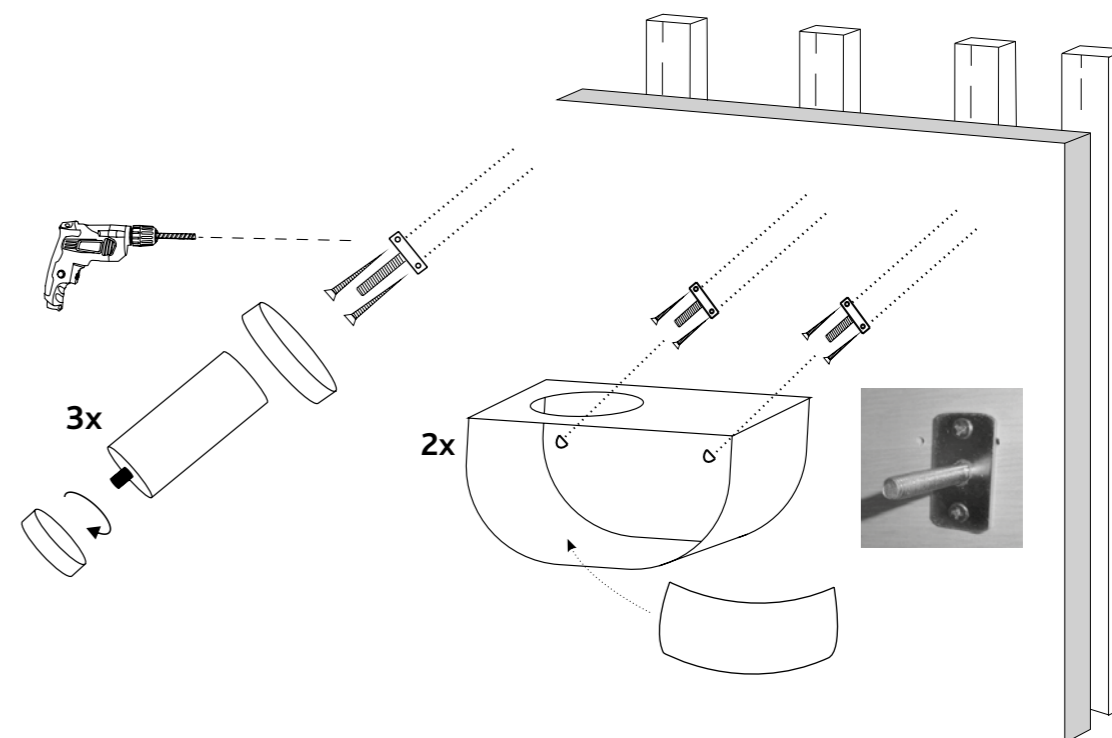

#### EN Work steps for drywall with wooden drywall stud

When using drywall anchors, we strongly recommend combining the drywall connection with at least one screw to a stud for a more solid connection. Be careful not to break the sheetrock.

##### First Step

Please use a pencil. Bring the products in final position and mark the screw-point on the center of the wall. Use a spirit level or have someone eyeball to make sure the holes are levelled.

##### Second Step

Use your drill and the 1/16" bit to make pilot holes for maximum 2 inch to stud markings. Insert self-drilling wall anchors (not included).

##### Third Step

Mount the metal holder with enclosed screws to the stud and wall anchor make sure the screws are fastened securely. Be careful not to break the drywall panel.

##### Final Step

Mount the condo to the metal holder tighten with enclosed nut.

##### Advice:

Please note the secure assembly and mounting requires one adult person.

#### EN Work steps for drywall with wooden drywall stud

##### First Step

Please use a pencil. Bring the products in final position and mark the screw-point on the center of the wall. Use a spirit level or have someone eyeball to make sure the holes are levelled.

##### Second Step

Use your drill and the 1/16" bit to make pilot holes for maximum 2 inch to all markings.

##### Third Step

Mount the metal holder with enclosed screws to the stud and make sure the screws are fastened securely. Be careful not to break the drywall panel.

##### Final Step

Mount the condo to the metal holder tighten with enclosed nut. Connect the steps to the metal holder and attach cap.

##### Advice:

Please note the secure assembly and mounting requires one adult person.