

Thank you for choosing Richell's Product. Please read this instruction manual carefully before using this product, and keep it for future reference. If you give this product to someone else, please also give this instruction manual to the new owner. Please note some parts of the figures shown below may be slightly different from the actual product, for your better understanding of the structure and proper use.

## Features

- Surrounded High Wall and Anti-tracking Grate Step keep litter and spray inside!
- Designed to be used with clumping cat litter.
- Includes Litter Scoop.

## Use

- This product is designed for use as indoor cat litter box.

## Instructions of Proper Use

### **Warning**

- Do not use this product for any other use.
- Do not place near fire.

## Before use

(1) Put in the clumping cat litter.

※ For the amount of cat litter usage, please follow the instruction manual for cat litter.

(2) Insert Anti-tracking Grate Step to the Main Unit by attaching Pin and Pin Receivers.

※ The Litter Scoop can be hung on the edge of the Main Unit.

<Transition to this product with ease>

- Please start by mixing up to new cat litter and used cat litter from previous cat litter box. And pour into this product. It makes an easier transition for your cat to understand this as their own bathroom.

## How to clean

- Use a mild detergent and water and clean with a soft sponge.
- Cleaning with a scrub brush and/or using a polishing powder may cause scratches.
- Do not use harsh chemicals such as thinner, benzene or alcohol.
- Use cresole or other disinfectants in accordance with the instructions for each disinfectant.
- After wash, dry in the shaded area away from direct sunlight.

## Specification

UPC	803840 60001-6 / 803840 60002-3 / 803840 60003-0
Dimension	16.1"W x 19.7"D x 12.4"H
Material	Polypropylene
Appropriate Cat Weight	Up to 17.6 lbs.

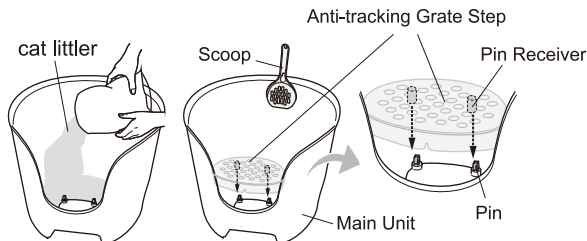

- Please note that product specifications and design may change without prior notice for the purpose of quality improvement.
- If you have any comments regarding the product, please contact us using the contact information below.



Designed by:  
 Richell Corporation, Japan  
 Distributed by:  
**Richell USA, Inc.**  
 Grand Prairie, Texas 75050  
 Phone (972) 641-9795 Fax (972) 641-8495  
 Visit us at [www.richellusa.com](http://www.richellusa.com)  
 MADE IN JAPAN