

Distributed By:

TRACTOR SUPPLY COMPANY

5401 VIRGINIA WAY,

BRENTWOOD, TN37027

For customer support, call:1-888-376-9601

www.TractorSupply.com

MADE IN CHINA



TravellerX 7500LBS Trailer Winch **User Manual & Operating Instructions**

Performance Specifications

Max Line Pull

7500lbs.(3401kgs)

Gear reduction ratio

280:1

Motor

12V DC. 1.6HP Permanent magnetic motor

Overall Dimensions

19.7in.(500.5mm) L ×7.9in.(201mm) W × 6.26in.(159mm) H

Drum size

2.28 IN./ 5 IN. (58 MM X 127 MM)

Synthetic rope

42 FT. (12.8 M) L of .354 IN. (9 MM) D

Net weight

46.69lbs.(21.18kgs)

Product Overview

This winch is equipped with a permanent magnetic motor and is designed for intermittent duty general use. This winch is not to be used for industrial lifting or moving people.

Improper operation could damage the winch and void the warranty.

Clutch knob is operated by open and close to disengage or engage the gearbox

Line speed and Motor current (First layer)

Line Pull lbs.(kgs)	Line Speed ft./min(m/min)	Motor Current Amps
0	14.77(4.5)	25
2500(1134)	8.2(2.5)	95
5000(2268)	5.9(1.8)	200
7500(3401)	3.6(1.1)	260

Line Pull And Cable Capacity

Layer	Rated line pull lbs (kgs)	Total rope on the drum ft (m)
1	7500(3401)	7.9 (2.4)
2	5795(2629)	16.7(5.1)
3	4722(2142)	27(8.3)
4	3984(1807)	38.7(11.8)
5	3449 (1563)	42(12.8)

WARRANTY

3 YEAR LIMITED WARRANTY

Tractor Supply Company, makes every effort to assure that its products meet high quality and durability standards, and warrants to the original purchaser that this product is free from defects in materials or workmanship for the period of 3-year limited from the date of purchase through normal use.

This warranty does not apply to damage due directly or indirectly to misuse, abuse of the product, improper installation, or to lack of maintenance. Some states do not allow the exclusion or limitation of incidental or consequential damages, so the above limitation of exclusion may not apply to you.

THIS WARRANTY IS EXPRESSLY IN LIEU OF ALL OTHER WARRANTIES, EXPRESS OR IMPLIED, INCLUDING THE WARRANTIES OF MERCHANTABILITY AND FITNESS.

In order to obtain this service, you should contact ACS(American Customer Service), pls call **1-888-376-9601**.

This warranty gives you specific legal rights and you may also have other rights which vary from state to state.

SAFETY PRECAUTIONS

- Never lift people or hoist loads over people. Do not lift items vertically, this winch is designed for horizontal use only.
- Never overload. Be sure all equipment used meets the winch's maximum line pull rating. When double-lining, pulley blocks should be rated for a minimum of two times the winch's line pull rating.
- Do not attempt prolonged pulls with heavy loads. The electric winch is designed for intermittent use only, and should not be used in a constant duty application. Never pull for more than one minute or exceed the rated load. If the winch motor becomes hot to the touch, stop the winch and allow it to cool down for several minutes.
- Never operate winch with less than 5 turns of cable around the winch drum since the cable end may not withstand full load.
- Avoid continuous pulls from extreme angles because this will cause the cable to gather on one end of the drum and damage the cable. Be aware that the winch's line pull capacity is the max line pull of the first layer. Never operate winch pulling a load that exceeds the rated capacity.
- Never hook the cable back to itself because it could damage the cable.
- Be sure the winch is mounted securely on the vehicle or bracket before operation.
- Before moving a load, inspect the cable. Prevent kinks and uneven cable layer before they occur. Apply proper tension to loads under 100lbs.
- Do not move your vehicle to assist the winch in pulling the load. It will be easy to overload, and cause cable damage. Be aware of the danger zone. Keep away from the danger zone during the operation. The danger zone is the area of the winch drum, the fairlead (if fitted), the cable, the pulley block (if used), the hook, and the motor.
- Never approach or span the cable when the winch is under load.
- When using the winch to move a load, place the vehicle transmission in neutral, set vehicle brake, and chock all wheels. The vehicle engine should be running during winch operation so that battery has fully electricity. Never use the winch when there is a lack of voltage.
- Never disconnect free spool clutch when there is a load on the winch.
- Always stand clear of the cable, hook and winch. You should disconnect the clutch first, then use the hand saver bar to hitch the hook to pull the cable.
- Inspect winch, cable, hooks and other accessories frequently. A frayed cable with broken strands should be replaced immediately. Use heavy leather gloves when handling the cable. Do not let the cable slide through your hands. Inspect the cable before use. Mashed, pinched, frayed or kinked areas severely reduce the load-carrying capability. Replacement cables must be re-spooled under 100lbs.
- To keep stated tensile, re-spool the cable around the drum tightly after operation.
- Do not operate winch when under the influence of drugs, alcohol or medication. Always stay alert during operation.
- Wear eye protection and personal protective equipment while operating winch.
- For loads over 50% of rated line pull, the use of the pulley block/snatch block to double the cable is recommended.
- Do not operate around potentially flammable liquids, gases, or debris. Sparks may occur, resulting in the ignition of fire.

INSTALLATION

Correct installation of the winch is required for proper operation. Mount the winch on the vehicle or other fixed installation by using provided screw (M10×1.5mm×65mm), M10 nut (see Fig 1)

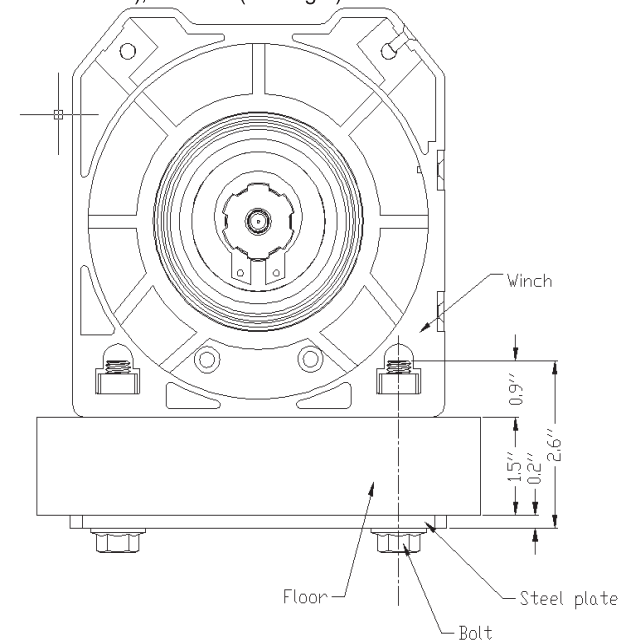

Fig 1

The winch must be mounted to a solid work surface. Mounting the winch to a trailer floor made from expanded metal is not recommended and serious injury/death could occur if winch is not properly installed.

WARNING: This winch must be mounted with the cable in an under wound direction. Improper mounting could damage the winch and void the warranty. Connect the red battery cable to the positive terminal and the black battery cable to the negative terminal of the battery. (See Fig. 2).

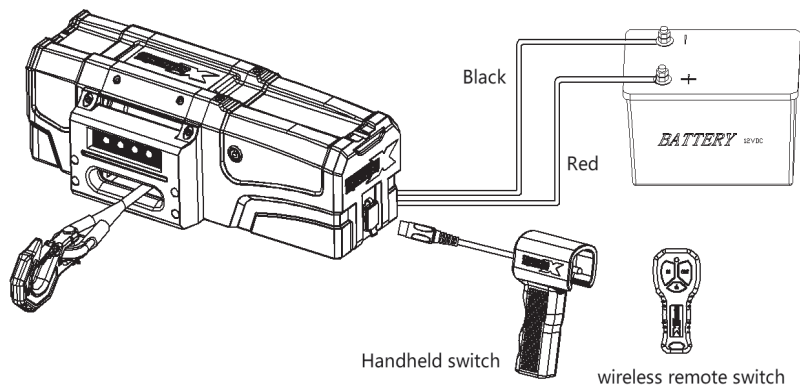
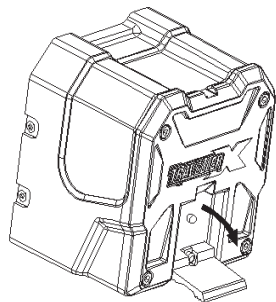

Fig. 2

- Check the rotation direction of the drum. When you open the clutch, the drum can be turned by hand, when you close the clutch, it can not be turned by hand .

OPERATION

- Open the clutch knob, the drum is disengaged and can turn freely by hand. (See Fig 3)
- Attach the hook to the cable, use hand saver to tie up the hook and pull cable to the load.
- Close the clutch knob, so the drum is engaged. (See Fig. 4)



Disengage

Fig 3

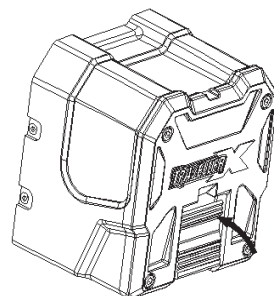

Engage

Fig 4

37	4	Hexagon socket countersunk head screws
38	1	LED light switch
39	1	Fairlead assembly
40	1	Synthetic rope $\phi 9 \times 12.8 \text{m}$
41	1	3/8 Hook
42	1	Hand saver strap
43	1	Clutch base
44	1	O-ring
45	1	Clutch pin
46	1	Clutch spring
47	2	The positioning paper
48	2	Metal plate
49	2	Hexagon flange bolts
50	4	M10 Square nut (M10)
51	4	Handheld switch
52	1	Wireless remote switch

WINCH PART LIST

No.	Qty	Description
1	1	Clutch cross pin
2	1	Clutch knob
3	4	Hexagon socket head cap screws(M6X20)
4	1	Gearbox end cap
5	1	Oil bearing
6	1	1 st stage planetary gear assembly
7	1	Ring gear
8	1	2 nd stage planetary gear assembly
9	1	3 rd stage planetary gear assembly
10	1	Remaining ring
11	1	Remaining ring(φ28)
12	1	Spline shaft
13	1	Ring gear
14	1	Transmission shaft
15	10	Hexagon socket head cap screws(M6X16)
16	1	Gear box
17	1	Seal
18	2	Bearing
19	2	Spacer
20	1	Drum cover
21	8	Hexagon socket countersunk head screw
22	2	Tie bar
23	1	Drum
24	1	Junction plate
25	1	Brake assembly
26	1	Permanent magnet motor
27	2	Solenoid connector bar
28	1	Solenoid & wireless radio receiver
29	1	Hexagon socket cap screw (M6X12)
30	1	Power cable 16X1.8 red
31	1	Power cable 16X1.8 black
32	1	Power cable protector
33	1	Motor cover
34	1	Switch socket
35	1	Cross recessed countersunk head screw (M3X8)
36	1	Socket cover

WARNING: Check that there are at least 5 turns of cable remaining on the drum before operation. Ensure the clutch knob is in the engaged position.

CAUTION: Clutch must be fully engaged before winching. Never operate the clutch while drum is turning. Do not readjust clutch knob as it has been adjusted and permanently locked in place with a thread-locking compound in the factory.

- Operation of handheld switch: press the “IN” button on the switch to re-spool the cable (see Fig 5). Press the “OUT” button to reverse directions (see Fig 6). Wait until the motor stops before reversing directions.

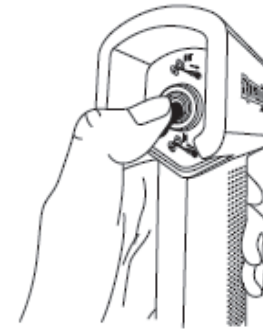

Fig 5



Fig 6

- Re-spool the cable after completing the operation.
- Operation of wireless remote switch: activate the wireless remote by pressing the power switch button for 3 seconds until the blue LED lights up.(see Fig 7)

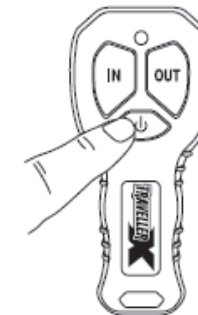

Fig 7

- Press the “IN” button on the switch to re-spool the cable (see Fig 8). Press the “OUT” button to reverse directions (see Fig 9). Wait until the motor stops before reversing directions.

WINCH ASSEMBLY

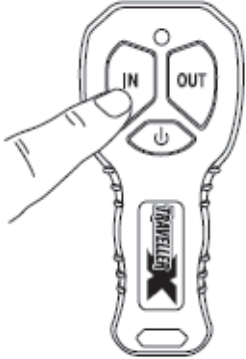

Fig 8

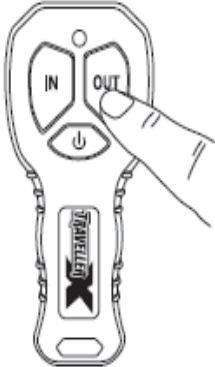

Fig 9

- To turn off the wireless remote switch, keep pressing the power button for 3 seconds until the blue LED light turns off (see Fig 7). The wireless remote switch will automatically power off in 2 minutes if it is not used.

WARNING: Duty cycle (duration of use)

Avoid damage to the winch by not winching for more than prescribed duty cycle time. This winch with a 5% duty cycle, at its maximum load must be allowed to rest for at least 14 minutes 15 seconds after every 45 seconds of continuous operation.

CAUTION: Hook onto the object using a pulling point, tow strap, tree strap, or chain. Do not wrap the synthetic rope around the object and hook onto the synthetic rope itself.(see Fig 10)

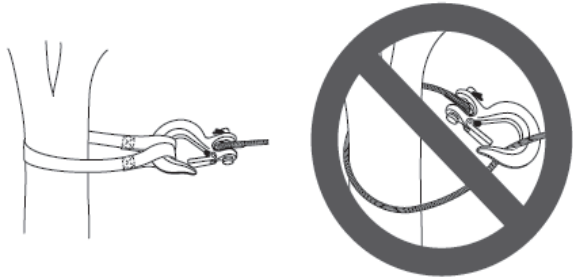

Using a strap anchor point

Fig 10

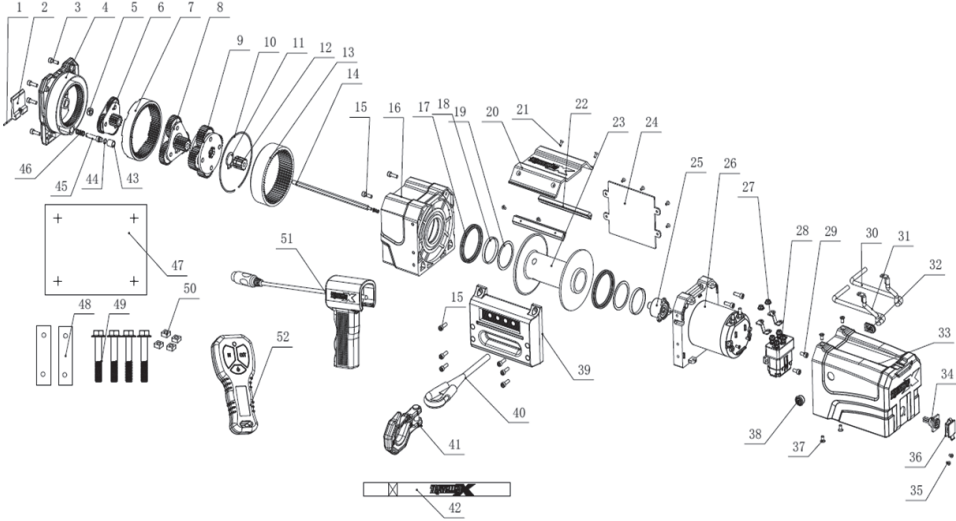

MAINTENANCE

- Periodically check tightness of mounting bolts and electrical connections. Remove all the dirt or corrosion and always keep clean.
- Do not attempt to disassemble the gearbox. Repairs should be done by the manufacturer or authorized repair center.
- The gearbox has been lubricated using high temperature lithium grease in the factory. No internal lubrication is required except when being repaired.

TROUBLE SHOOTING

SYMPTOM	POSSIBLE CAUSE	SUGGESTED ACTION
Motor does not turn on	-Switch Assembly not connected properly	-Insert switch assembly all the way into the connector.
	-Loose battery cable connections	-Tighten nuts on all cable connections.
	-Defective switch assembly	-Replace switch assembly.
	-Defective motor	-Check for voltage at armature port with Switch pressed. If voltage is present, replace motor.
	-Water has entered motor	-Allow to drain and dry. Run in short bursts without load until completely dry.
Motor runs but cable drum does not turn	-Clutch not engaged	-Close the clutch knob. If problem persists, a qualified technician needs to check and repair.
Motor runs slowly or without normal power	-Insufficient current or voltage	Battery has insufficient charge. Run winch with vehicle motor running. -Loose or corroded battery cable connections. Clean, tighten, or replace.
Motor overheating	-Winch running time too long	-Allow winch to cool down periodically.
Motor runs in one direction only	1. Defective or stuck solenoid 2. Defective switch assembly	1. Tap solenoid to loosen contacts, repair or replace solenoid. 2. Replace switch assembly
Winch braking malfunction.	Defective brake	Replace the brake

CAUTION: Do not operate the winch at extreme angles. Do not exceed the angles shown in Figure 11 for a roller fairlead (or a hawse fairlead), the angle should be as close to straight as possible.

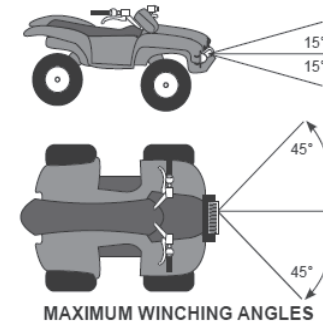

Fig 11

REPLACING THE CABLE

- Engage the drum by close the clutch knob to the “ENGAGE” position.
- Use the switch, power out the damaged rope, remove it from the drum.
- When inserting the new rope into the drum, insert it into the correct end of the hole provided. Tighten the screws.
- Operate the winch, re-spool the cable on the drum tightly.

CAUTION: To keep the proper tension, be sure the cable is wrapped on the drum tightly.

WARNING: Always replace damaged cable with manufacturer's identical replacement part.

REPLACING THE WIRELESS SWITCH

- When the transmitter is replaced, the same type of transmitter is required for pairing. The pairing steps are as follows:

Step 1: Disconnect the winch power cables at the battery.(See Fig 12)

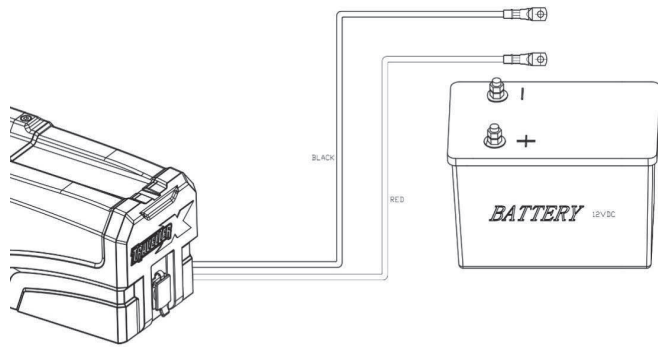

Fig 12

Step 2: Turn on the wireless remote by pressing the power switch button for 3 seconds until the blue LED lights up. (Fig 13)

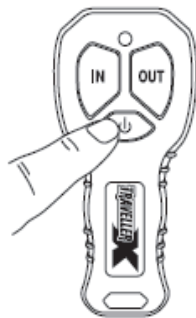

Fig 13

Step 3: Reconnect the power cables to the battery. (Fig 14)

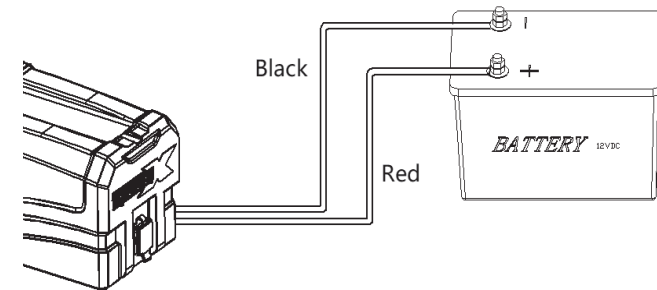

Fig 14

CAUTION: Step 2 and step 3 must be completed within 50 seconds of the completion of step 1.

Step 4: Press the IN and OUT buttons of the wireless sender at the same time (see Fig 15), the indicator light start to blink. Keep holding the buttons until the indicator stops blinking. Release both fingers, the wireless remote switch pairing is completed.

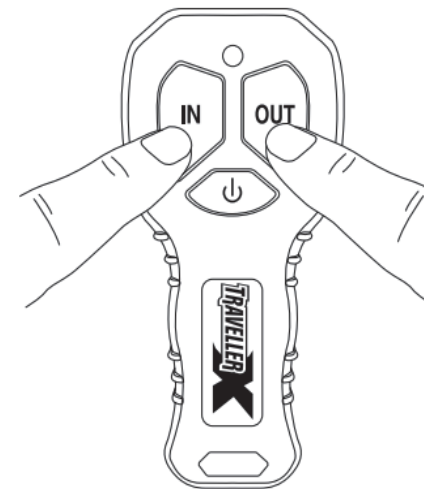

Fig 15